

# ZARAFKA CAMP

SELINDA RESERVE | NORTHERN BOTSWANA

GREAT PLAINS

CONSERVING AND EXPANDING NATURAL HABITATS

ESTABLISHED 2004

With its four well-appointed tented suites, Zarafa Camp is an intimate camp located on the private Selinda Reserve in northern Botswana, an area linking the Okavango Delta and the Chobe/ Savute corridors.

Few camps rival the location of this little gem, which together with Duba Plains, Sitatunga Private Island and Selinda Camps, is one of only four Relais & Chateaux properties in Botswana. Overlooking the crystal waters of Zibadianja Lagoon, the source of the famous Savute Channel, every area of camp has a magnificent view. The lagoon is also the water source for a tremendous population of wildlife – dry season sightings boast buffalo and elephant by the hundreds.

This exquisite camp is the brainchild of the founders of Great Plains Conservation, who pooled their collective experience on safari to create what they deemed to be the best and most environmentally innovative camp. Only recycled hardwoods and canvas were used in the construction and all the camp's electricity comes from its solar farm while 'bio gas' plants recycle waste into usable cooking gas. Zarafa Camp has no equal in terms of its environmental credentials and its careful appointments.

Selinda Reserve, at the crossroads of some of northern Botswana's most prolific wildlife areas, boasts staggering wildlife populations year-round. Home to some of the classic species, such as leopard, lion, elephant, buffalo, Red lechwe, zebra and giraffe, it is also a refuge for some of the more uncommon species such as African wild dog (which usually den each dry season near camp), cheetah, roan and sable. And for birders, it will not disappoint. Our nearby African skimmer colony is a highlight, as are the antics of the Black egret on the shores of Zibadianja Lagoon. From camp, hippos are visible in the Lagoon and elephant wander through regularly. Night noises will either lull you to sleep or wake you from a deep slumber. It is an exciting area, and guests are in the heart of a wilderness wonderland.





# ZARAFKA CAMP

SELINDA RESERVE | NORTHERN BOTSWANA

## CAMP FEATURES:

Zarafa Camp can accommodate a maximum of 8 guests (excluding the Dhow Suite at Zarafa).

### Total Number of Bedrooms:

4 double or twin configuration suites;

Separate 2-bedroom Dhow Suite at Zarafa is available for guests to reserve;

1 guide room with 2 three-quarter beds and a shared en-suite bathroom.

### Type of Lodge

Réserve Collection Safari Camp

### Lodge Season & Opening

Year Round

### Ideal length of stay

3 - 4 Nights

## CAMP CO-ORDINATES

18°35'21.9"S 23°31'51.0"E

## ACCESS DIRECTIONS

- Light aircraft transfers from Kasane (55 mins) and Maun (45 min) airports;
- Private Air charter access available;
- Zarafa Camp is a 45-minute drive from its airstrip;
- Airstrip co-ordinates: 18°34'41.9"S 23°29'16.8"E;
- Airstrip length: 1000m.



## ACTIVITIES

With a maximum of just eight guests sharing in 4 suites, Zarafa Camp offers complete flexibility.

### Safari drives

Early morning, late afternoon/ evening or even full-day safari drives occur in some of the most luxurious wildlife-viewing vehicles. Each Toyota Land Cruiser is open-sided, canopied, and customised for photographers with fold-down screens, raised roofs, photographic bars, and multi-plug invertors, all in keeping with the origins of Dereck & Beverly Joubert as National Geographic photographers. We choose to accommodate four guests (or two couples) on a safari vehicle; however, if a family or group travels together, we would easily accommodate up to six guests. Our vehicles also have fridges stocked with drinks and snacks, ready for longer days out if the wildlife viewing is exciting and just too hard to leave.

Every day is different on safari. Safari Drives often start at sunrise, returning to camp for a late breakfast and departing again mid-afternoon after tea before returning just after sunset. However, guests can often spend the entire day out in the veld with a packed breakfast, lunch, and beverages if they wish. Our safaris will often continue into the night in search of nocturnal species. Night drives are incredibly prolific, and while they take patience, sightings commonly include lesser-known nocturnal mammals and even lion and hyena hunts.



# ZARAFA CAMP

SELINDA RESERVE | NORTHERN BOTSWANA



Our schedule is flexible, and guests are encouraged to create their own itinerary according to their interests with guidance and recommendations from our professional guides.

Enjoy wildlife viewing from this property on our online HD hide-cam 24 hours a day. Visit [greatplainsconservation.com/live-african-wildlife-webcam/#twin-pans](http://greatplainsconservation.com/live-african-wildlife-webcam/#twin-pans) for more information.

## Guided walks

Guided walks can also be arranged and are led by licensed guides with firearm training.

## Photography

- The camp has two custom built Land Cruisers specially designed for our conditions and photography (fold-down screens, raised roofs, photographic bars, multi-plug invertors) with seven individual bucket seats.
- Each of Zarafa Camp's guest suites has a professional camera set, including a camera body and lenses. Photos will be downloaded to a USB flash stick on guest's departure. Each suite comes with a pair of high-quality binoculars for guest use as well.

## Boating

- Zarafa offers guests a unique pontoon experience. The pontoon is known as H.E.S. Zib. The pontoon provides a 275 sq. foot deck complete with couches, a dining area and a bar where guests can comfortably enjoy floating brunch or sundowners while watching hippos and elephants in the water.

It is also an exceptional platform for birding;

- There is also a flat-bottomed aluminium power boat to explore the lagoon and channels around the area.

## Fishing

Fly-fishing and rod/reel kit is available between March and December for those who want to try their cast at the local bream on a catch and release basis.

## Private vehicle option

Available for more flexibility upon request at extra cost, not compulsory for families travelling with children.

## Private Guides

Private guides are encouraged and welcomed.

## Scenic Flight and Champagne Stop

Enjoy an aerial viewing experience with great scenery across the Linyanti/Savuti and Selinda Spillway. Add a 15-minute champagne stop on palm island en route. Must be booked in advance and is subject to extra cost and availability.

# ZARAFa CAMP

SELINDA RESERVE | NORTHERN BOTSWANA

## CENTRAL FACILITIES

- Central Lounge, library, dining room, wine cellar;
- Coffee/tea station;
- Expansive deck with fire pit & seating;
- Great Plains Safari Boutique selling locally and regionally produced crafts, many of which support local community projects in the nearby Okavango panhandle. The Boutique also stocks the d&b clothing line: Dereck and Beverly Joubert have inspired this bespoke range of clothing they typically wear, and which is perfect and cool while on safari yet elegant when in the city. All materials are responsibly sourced. Visit [dbexplorercollection.com](http://dbexplorercollection.com)

## FOOD AND BEVERAGE

- Our world-class meals are Relais & Chateaux recognised;
- All meals included and prepared by our Executive Chefs and their teams;
- All drinks and beverages are included, including imported spirits and champagnes;
- Group meals and/or individual tables, a la carte (menu options);
- Indoor and outdoor dining;
- Private dining on guest's private verandah available on request;
- All dietary requirements are catered for from regular to vegan to children; prior notice required;
- We are extremely flexible on timings. Picnic breakfasts or lunch (or both) are the norm due to very active safari drives, often delivered to the bush!

## ACCOMMODATION DETAILS

### Bedroom features

- Four 100m2 Marquee style tented suites of canopied beige canvas on raised wood decks of 100-year-old teak railroad ties.
- Private decking leading to a private plunge pool;
- Lounge has couch, chairs and writing desk;
- Bar fridge with drinks of choice;
- Tea/Coffee station;
- Suites are ideally appointed for Honeymooners;
- Mosquito netting on all tented suite sides and over beds;
- Standing fans, and environmentally friendly air-conditioner over the guest's bed area;
- Gas fireplace for winter;
- Either twin or double bed configuration;
- The Dhow Suite at Zarafa is a separate 2-bedroom private accommodation unit with private pool - separate fact sheet available.

### Bathroom features

- En-suite from the bedroom, there is an open-air concept bathroom with indoor shower, claw foot deep copper tub and double vanities;
- Outdoor shower;
- Hot and cold running water;
- Separate flush loo room;
- Soap, shampoo, conditioner and lotion and hairdryers provided.





# ZARAFKA CAMP

SELINDA RESERVE | NORTHERN BOTSWANA

## ACCOMMODATING CHILDREN AND SHARING ACCOMMODATION

- Children are accommodated from a minimum age of 6 years;
- Triples for children sharing with adults can be arranged upon request;
- Child rates are applicable for one child aged 15 and younger sharing with two adults in a suite;
- Children 16 and older will pay applicable adult rates and be accommodated in a separate suite. Alternatively, families should consider booking the Dhow Suite at Zarafa;
- Families will be combined with other guests on all activities unless a private vehicle is booked and paid for;
- Scheduled wildlife viewing activities, including safari drives, guided walks, and power boating, are available to guests from 6 years when accompanied by their parents or guardians. Where available, canoe and mokoro activities specifically welcome guests aged 8 years and above;
- Young children must be supervised as the camp is open with high predator densities in and around camp and there is water surrounding camp. The camp also features raised decks, pools which are not covered;
- Great Plains Young Explorers program – thoughtfully designed to explore a range of experiences and topics from birding to cooking to art to tracking wildlife.



## SPA

The Spa at Zarafa, located between suite 4 and the Dhow Suite, offers guests two treatment areas and with a range of treatments available. Spa treatments are at an additional cost.

## FITNESS

The camp features an open-air gym where guests can make use of the following equipment:

- Treadmill;
- Spinning bike;
- Rowing machine;
- Orbital walker;
- Yoga mats;
- A selection of various weights and dumbbells.

In addition to this, there are also yoga mats and weights for guests to enjoy in their suite.

## LAUNDRY

Included in nightly tariff - next day service, weather permitting;

# ZARAFA CAMP

SELINDA RESERVE | NORTHERN BOTSWANA



## POWER AND COMMUNICATION

### Power

- The camp is run by an impressive solar farm of 170 panels with generator back-up;
- This system produces 220V, 24-hour electricity to the suites and main area;
- Universal plug points in each suite.

### Internet & Mobile

- Wi-fi available in guest suites;
- No mobile signal.

## HEALTH AND SAFETY

### Health

- Malaria: Minimal exposure risk – Malaria prophylaxis are recommended if guests are concerned; however, this is a remote area with little occurrence.
- Guests must hold comprehensive medical insurance and emergency evacuation insurance.
- Senior staff all has first aid training.
- Nearest decent medical facility is in Maun, and then Johannesburg.

### Possibility of Disabled access

- The camp layout is not conducive to wheelchair bound guests due to dirt pathways and uneven terrain.
- There are two suites closest to the main area, each with minimal steps, which are perfectly located for guests with walking challenges.

## Safety

- This remotely located camp is unfenced to wild animals that do move through the property especially at night.
- Fire extinguishers in every suite.

## MONEY MATTERS

### Safes

Provided in every suite.

### Accepted Payment on Location

- Staff gratuities can be paid in Botswana Pula, US Dollars, Euro and GB Pounds - preferably in cash - to the staff member concerned who has truly exceeded expectations in terms of hospitality, service, and experience;
- Guest extras and curio sales can be settled by Visa and MasterCard credit card (No Amex or Diners).

The Team

Lodge Owners

**Great Plains Conservation**



# ZARAFKA CAMP

SELINDA RESERVE | NORTHERN BOTSWANA



## FOUNDATION INITIATIVE

### Great Plains Earth Academy

Conservation is only successful when communities living alongside wildlife and protected areas are afforded opportunities to learn, interact, and benefit from these conserved areas. In Ngamiland, in the upper reaches of the Okavango Delta, there is a community we care deeply about and want to support in their journey to prosperity, with strong links to the environment. In support of that community, the Great Plains Foundation has launched the Great Plains Academy to provide personal and community enrichment opportunities for individuals living alongside wildlife. The goal of the Great Plains Academy is to provide vocational training, supplemental education and scholarships with a conservation and tourism focus to those living alongside Botswana's Okavango Delta. All programs seek to invest in the skill and capacity of the individual while imparting respect for natural heritage and a solid conservation ethic. Learn more at - [www.greatplainsfoundation.com](http://www.greatplainsfoundation.com)

In addition to our own programs Great Plains Foundation keeps a list of school needs in the countries where we work. Needed items can be hand-carried by travelers or we can help purchase them locally. To learn more or to help support students and educators as part of your trip please reach out [info@greatplainsfoundation.com](mailto:info@greatplainsfoundation.com)





# GUEST SUITE

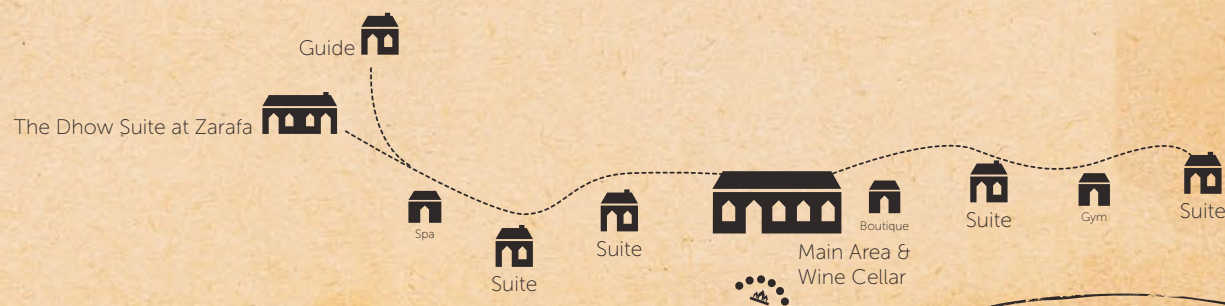
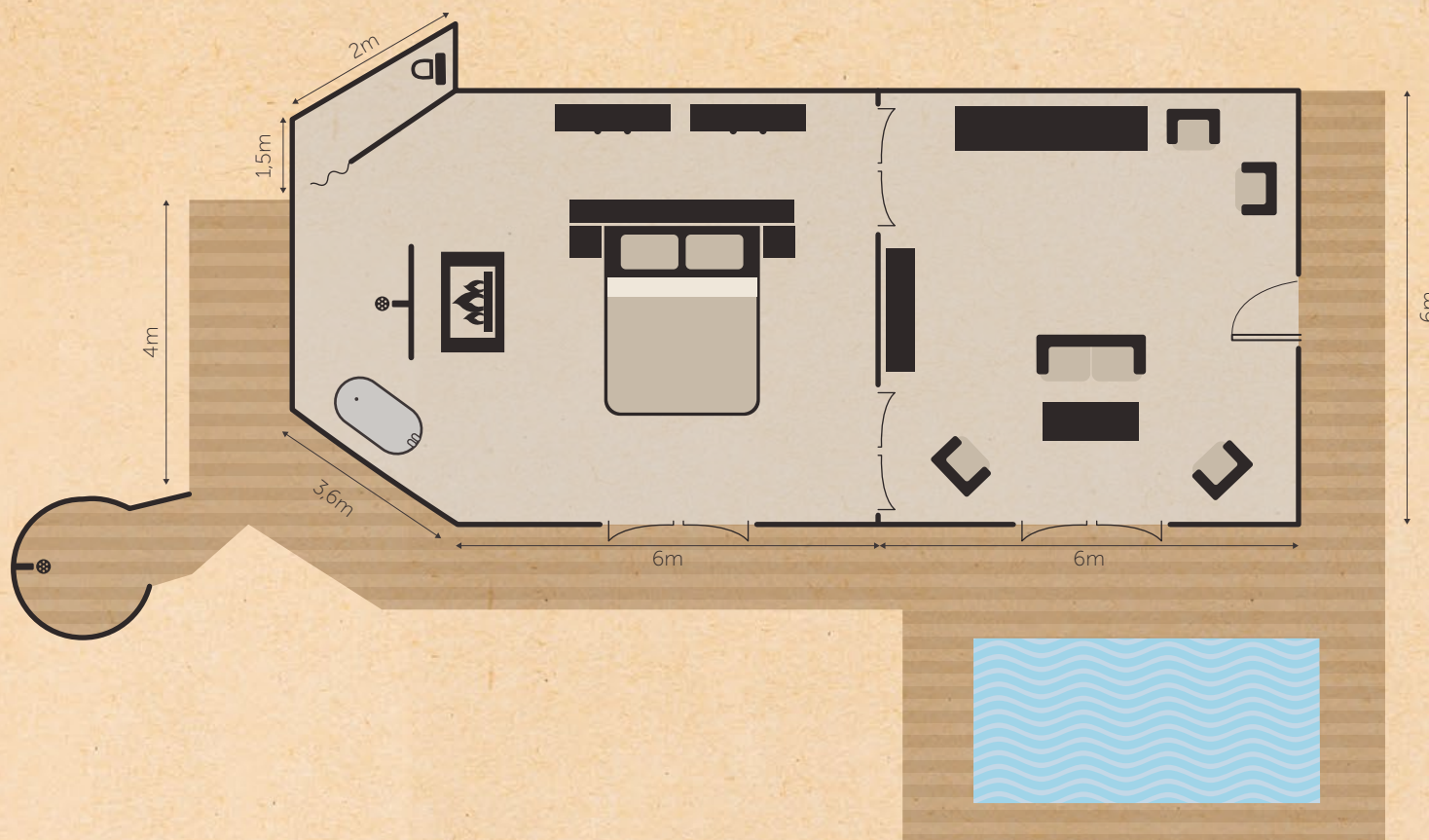



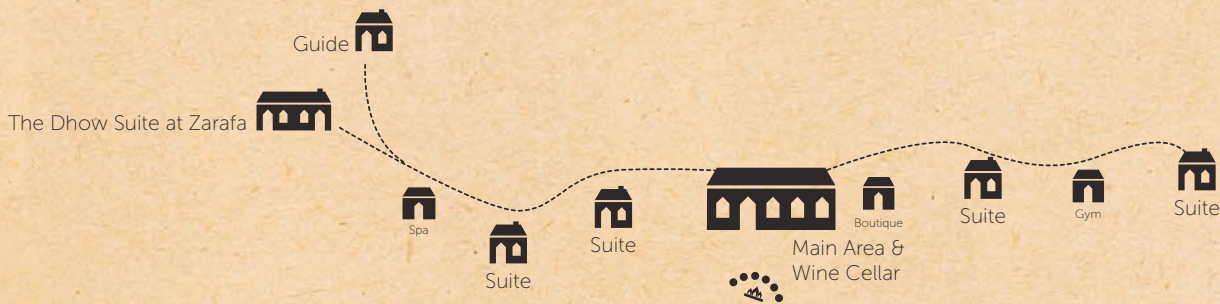

BOTSWANA

# GREAT PLAINS

THE DHOW SUITE AT ZARAFI

## THE DHOW SUITE AT ZARAFI

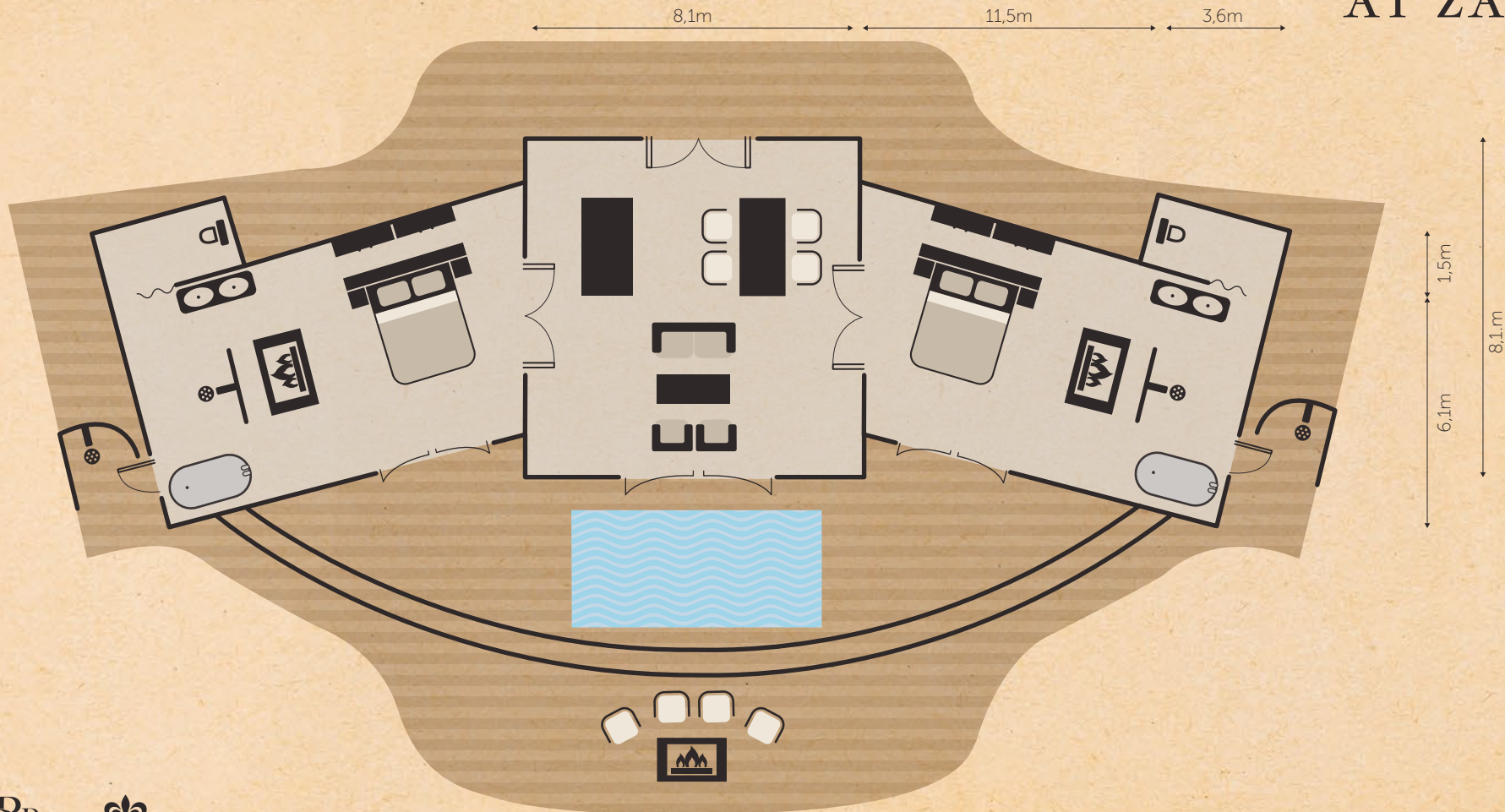





*Namibia*

*Bwabwata  
National Park*

*Mudumu  
National Park*

*Chobe Forest Reserve*

*Chobe National Park*

Selinda Explorers Camp

Selinda Camp &  
Selinda Suite

Zarafa Camp &  
The Dhow Suite at Zarafa

Okavango Explorers Camp

Sitatunga Private Island &  
Sitatunga Private Island Suite

Duba Explorers Camp

Duba Plains &  
Duba Plains Suite

Moremi Game Reserve  
*Okavango Delta*

*Botswana*

Maun

Kasane

## GREAT PLAINS

CONSERVING AND EXPANDING NATURAL HABITATS



GREAT PLAINS CONSERVATION  
STRIVES TO FIND THE RIGHT FORMULA OF  
CONSERVATION, COMMUNITIES AND COMMERCE  
THAT MAKES A LASTING, SUSTAINABLE DIFFERENCE  
TO THE WORLD'S ICONIC WILDLIFE  
AND WILDERNESSES.

*Nxai Pan  
National Park*



# GREAT PLAINS CONSERVATION

## QUICK CAMP FACTS



### BOTSWANA CAMPS

ACTIVITY	ZARAFA CAMP & THE DHOW SUITE AT ZARAFA	SELINDA CAMP & SELINDA SUITE	DUBA PLAINS CAMP & DUBA PLAINS SUITE	SITATUNGA PRIVATE ISLAND & SITATUNGA PRIVATE ISLAND SUITE
Camp Classification	Réserve Collection	Réserve Collection	Réserve Collection	Réserve Collection
Location	Selinda Reserve	Selinda Reserve	Duba Concession	Sitatunga Private Reserve
Number of Suites / Tents	4 Suites	3 Suites	5 Suites	2 Suites
Family Accommodation	The Dhow Suite at Zarafa	The Selinda Suite	The Duba Plains Suite	The Sitatunga Private Island Suite
Children can be accommodated from:	6 Years	6 Years	6 Years	6 Years
Day and Night Safari Drives	Yes	Yes	Yes	n/a
Private Activities (at an additional charge)	Yes (Included for Dhow Suite)	Yes (Included for Selinda Suite)	Yes (Included for Duba Plains Suite)	Private boating
Guided Walks	Yes	Yes	Yes	Yes
Boating (*water level dependent)	*Yes	*Yes	Yes	Yes
Mekoro and/or Canoeing (*water level dependent)	n/a	n/a	Mekoro	*Mekoro
Fishing (Seasonal and *water lever dependent)	*Yes	*Yes	Yes	Yes
Scenic Flights and Champagne Stops	Available at an additional charge	Available at an additional charge	Available at an additional charge	Available at an additional charge
Main Swimming Pool / Private Plunge Pools	Private Plunge Pool	Private Plunge Pool	Private Plunge Pool	Private Plunge Pool
Shower	Indoor & Outdoor	Indoor	Indoor & Outdoor	Indoor
Bath	Yes	Yes	Yes	Yes
Hairdryers (low-voltage)	Yes	Yes	Yes	Yes
Mosquito Nets	Yes	Yes	Yes	Yes
Over-bed air-conditioning	Yes	Yes	Yes	Yes
Fan	Yes	Yes	Yes	Yes
Wi-Fi – in-room (complimentary)	Yes	Yes	Yes	Yes
Safe - In-room	Yes	Yes	Yes	Yes
Spa treatments (at an additional charge)	Yes	Yes	Yes (In-room only)	Yes (In-room only)
Fitness	Gym & In-Room Equipment	In-Room Equipment	In-Room Equipment	In-Room Equipment
Boutique on site	Yes	Yes	Yes	Yes



# GREAT PLAINS CONSERVATION

## QUICK CAMP FACTS



### BOTSWANA CAMPS

ACTIVITY	SELINDA EXPLORERS CAMP	OKAVANGO EXPLORERS CAMP	DUBA EXPLORERS CAMP
Camp Classification	Explorers Collection	Explorers Collection	Explorers Collection
Location	Selinda Reserve	Selinda Reserve	Duba Concession
Number of Suites / Tents	3 Tents	6 Tents	5 Tents
Family Accommodation	1 Family Tent	n/a	n/a
Children can be accommodated from:	6 Years	6 Years	6 Years
Day and Night Safari Drives	Yes	Yes	Yes
Private Activities (at an additional charge)	Yes	Yes	Yes
Guided Walks	Yes	Yes	Yes
Boating (water level dependent)	n/a	n/a	*Yes
Mekoro and/or Canoeing (water level dependent)	Canoeing	Canoeing	Mekoro
Fishing (Seasonal and water lever dependent)	Yes	Yes	Yes
Scenic Flights and Champagne Stops	Available at an additional charge	Available at an additional charge	Available at an additional charge
Main Swimming Pool / Private Plunge Pools	Main Swimming Pool	n/a	Main Swimming Pool
Shower	Indoor	Indoor	Indoor
Bath	n/a	n/a	n/a
Hairdryers (low-voltage)	n/a	n/a	n/a
Mosquito Nets	On All Tent Sides	Yes	Yes
Over-bed air-conditioning	n/a	n/a	Yes
Fan	Yes	Yes	Yes
Wi-Fi – in-room (complimentary)	Yes	Yes	Yes
Safe - In-room	Yes	Yes	Yes
Spa treatments (at an additional charge)	n/a	n/a	n/a
Fitness	Yoga Mats	Yoga Mats	In-Room Equipment
Boutique on site	n/a	n/a	Yes