

# DUBA EXPLORERS CAMP

DUBA CONCESSION | NORTHERN BOTSWANA

GREAT PLAINS

CONSERVING AND EXPANDING NATURAL HABITATS

ESTABLISHED 1981

**Duba Explorers Camp in Northern Botswana is tucked away in the northeast corner of the Duba Concession, a reserve in the Okavango Delta.**

Due to its location at the northern reaches of the Okavango Delta, the surroundings are dominated by permanent floodplain, interspersed with seasonal floodplains and grasslands and pockets of mopane and acacia woodlands. Under a canopy of mature jackalberry, leadwood, mangosteen and sycamore fig trees the camp has year-round shade. The camp's location provides clear, unobstructed views across the surrounding water channels and allows cool breezes through the camp and guest tents.

The camp, part of our Explorers Collection and designed by Dereck and Beverly Joubert, explorers themselves, embodies the golden age of safaris and the spirit of exploration. The camp consists of five tents of airy canvas on raised decking stylishly furnished with campaign writing desk, private verandah and en-suite facilities. Guests wake up to panoramic views of the Delta floodplains and, during the flood season, the water channels link to open water filled with flowering water lilies and tall papyrus. The main area is set under sweeping marquee canvas, on raised decking with an open-concept dining and lounge area. Being part of a floodplain for most of the year, the camp is on an island surrounded by beautiful landscapes and water courses. The camp is accessible only by two, gum pole bridges. During your siesta, lounge on the daybed on your veranda, absorbing the peacefulness and tranquillity of your surroundings. During the flood season you might even be lucky to catch sight of spotted neck otters swimming and eating. Listen out for the prolific birdlife. At night, let the hippos sing you a to sleep. Sometimes, the roar of a lion cracks through the night as he calls out to his pride.

During a stay at Duba Explorers Camp guests step into the shoes of the early adventurers. Explore the water channels associated with the Ngoga River system by boat or traditional canoes (mekoro), meandering through channels created by hippos and elephant. The mekoro allows you to glide silently through the channel systems and experience an undisturbed water world around you. With over 400 bird species, birding is unsurpassed, with spectacular species like the malachite kingfisher zipping past you in a burst of colour. Vehicle safaris in this paradise allow for exciting encounters with the predators who are resident in the area. On guided walks explore the islands, wetlands and plains, following the tracks and interpreting the signs of the wild. Guests might even be lucky enough to get a glimpse of a rare sitatunga or an elusive leopard. Enjoy the excitement of catch and release fishing where one can study the various delta fish species up close.





# DUBA EXPLORERS CAMP

DUBA CONCESSION | NORTHERN BOTSWANA

## CAMP FEATURES

Duba Explorers Camp can accommodate a maximum of 10 guests.

### Total Number of Bedrooms:

5 double or twin configuration tents;  
1 guide room with 2 three-quarter beds and a shared en-suite bathroom.

### Type of Lodge:

Explorers Collection Safari Camp

### Lodge Season & Opening:

Year Round

### Ideal length of stay:

3 to 4 nights is highly recommended

## CAMP CO-ORDINATES

18°57'34.48"S 22°40'28.19"E

## ACCESS DIRECTIONS

- Light aircraft transfers from Kasane (1hr 25 mins) and Maun (40 min) airports;
- Private Air charter access available;
- Duba Explorers Camp is a 5 min helicopter transfer from Duba Airstrip;
- Duba Plains airstrip co-ordinates are:  
S19° 1' 3.45" E22° 42' 11.90;
- Airstrip length: 1000m



## ACTIVITIES

### Wildlife Viewing

Duba Explorers Camp is a combination activity-based camp. Wildlife viewing activities centre around guests predominantly exploring the surrounding Okavango Delta's permanent channels by guided walks, drives, mokoro, and boating (when water levels allow). The mokoro and boating activities are truly invigorating yet peaceful experiences, allowing for wildlife and birding viewing from unique perspectives.

Guided wildlife walks, Duba Explorers Camp's specialist wildlife viewing activity, are available with licensed, armed guides. There is simply no better way to experience the magic of this unique destination, and these walks are ideally combined with wildlife-viewing activities such as heading out on a mokoro or boat.

Early morning, late afternoon/ evening or even full-day safari drives are done in our custom-built, open Toyota Land Cruisers specially designed for our conditions and photography, including fold-down windscreens, raised roofs, photographic bars, and multi-plug inverters. Each Land Cruiser is fully stocked with reference books, drinks, and snacks. While our wildlife viewing focus remains on the most comfortable times of the day (early to mid-morning and late afternoon to evening), spending a full day out in the wilderness is not uncommon. Duba Explorers Camp does have access to shared traversing areas north of the Duba Concession and often includes these exciting areas in guests' safari drives.



# DUBA EXPLORERS CAMP

DUBA CONCESSION | NORTHERN BOTSWANA



Our safaris will often continue into the night in search of nocturnal species. Night drives are incredibly prolific, and while they take patience, sightings commonly include lesser-known nocturnal mammals and even lion and hyena hunts. Our schedule is flexible, and guests are encouraged to create their own itinerary according to their interests with guidance and recommendations from our professional guides

## Fishing

A rod/reel kit is available for those who want to try their cast in the Delta between March and December on a catch and release basis - water level dependant.

## Private vehicle option

Available for more flexibility upon request at extra cost, not compulsory for families travelling with children.

## Private Guides

Private guides are encouraged and welcomed.

## Scenic Flight and Champagne Stop

Enjoy an aerial viewing experience with great scenery across the northern part of the Okavango Delta. Add a 15-minute champagne stop on palm island en route. Must be booked in advance and is subject to extra cost and availability.

## CENTRAL FACILITIES

- Main marquee canvas area with lounge and dining;
- Coffee/tea station;
- Outdoor fire pit;
- Unique swimming pool near the main area for guests to enjoy;
- Great Plains Safari Boutique selling locally and regionally produced crafts, many of which support local community projects in the nearby Okavango panhandle. The Boutique also stocks the d&b clothing line: Dereck and Beverly Joubert have inspired this bespoke range of clothing they typically wear, and which is perfect and cool while on safari yet elegant when in the city. All materials are responsibly sourced.

Visit [dbexplorercollection.com](http://dbexplorercollection.com) for more information.

## FOOD AND BEVERAGE

- All meals included and prepared by our Executive Chefs and their teams;
- Three delicious meals a day are included. We are extremely flexible on timings. Picnic breakfasts or lunch (or both) are the norm due to very active safari drives, often delivered to you whilst in the bush!
- All drinks and beverages are included, including imported spirits and champagnes;
- Individual dining;
- Indoor and outdoor dining locations;
- All dietary requirements are catered for from regular to vegan to children - prior notice required.

# DUBA EXPLORERS CAMP

DUBA CONCESSION | NORTHERN BOTSWANA

## ACCOMMODATION DETAILS

### Bedroom features

- Stone coloured canvas tents with zipper double doors that lead to mid-sized tented rooms;
- Private verandah with views of floodplains;
- High quality binoculars in every guest tent;
- Mosquito nets over beds as well as netted windows and doors;
- Tea/Coffee station;
- Standing fan;
- Either twin or double bed configuration;
- Environmentally friendly air-conditioning over the guest's bed area;
- Writing desk.

### Bathroom features

- En-suite with flush toilet, shower (with hot & cold running water), double basins;
- Soap, shampoo, conditioner and lotion provided.

## ACCOMMODATING CHILDREN AND SHARING ACCOMMODATION

- We look forward to having children stay with us that are 6 years and older;
- Triples for children sharing with adults can be arranged upon request;
- Families with children could be accommodated in the same vehicle as other guests;

- Scheduled wildlife viewing activities, including safari drives, guided walks, and power boating, are available to guests from 6 years when accompanied by their parents or guardians. Where available, canoe and mokoro activities specifically welcome guests aged 8 years and above;
- Young children must be supervised as the camp is open with high predator densities in and around camp and there is water surrounding camp;
- Great Plains Young Explorers program – thoughtfully designed to explore a range of experiences and topics from birding to cooking to art to tracking wildlife.

## FITNESS

Yoga mats and light weights are provided in each tent.

## LAUNDRY

Included in nightly tariff - next day service, weather permitting.

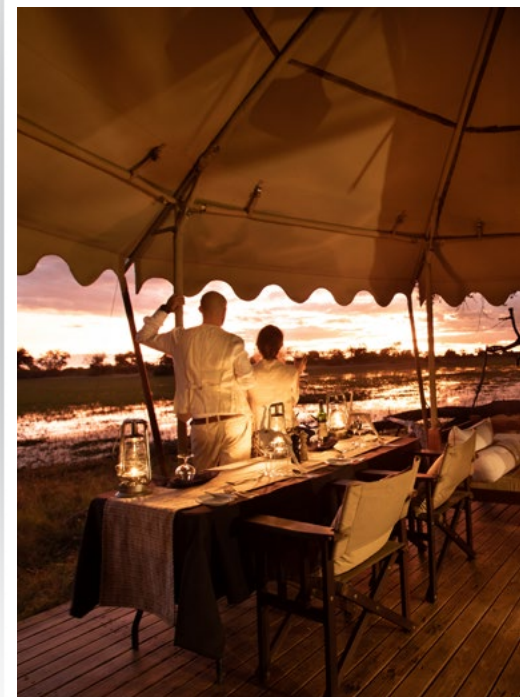



# DUBA EXPLORERS CAMP

DUBA CONCESSION | NORTHERN BOTSWANA

## POWER AND COMMUNICATION

### Power

- The camp is run by solar power;
- The system produces 220V, 24-hour electricity to the tents and main area;
- Universal plug points in each tent.

### Internet & Mobile

- Limited Wi-Fi available in guest tents;
- No mobile reception.

## HEALTH AND SAFETY

### Health

- Malaria: Minimal exposure risk– Malaria prophylaxis are recommended if guests are concerned; however, this is a remote area with little occurrence;
- Guests must hold comprehensive medical insurance and emergency evacuation insurance;
- Senior staff all has first aid training;
- Nearest decent medical facility is in Maun, and then Johannesburg.

### Possibility of Disabled Access

The camp layout is not conducive to wheelchair bound guests due to dirt pathways and uneven terrain.



## Safety

- This remotely located camp is unfenced to wild animals that do move through the property especially at night;
- Fire extinguishers in every tent.

## MONEY MATTERS

### Safes

Safes are provided in every tent.

### Accepted Payment on Location

- Staff gratuities can be paid in Botswana Pula, US Dollars, Euro and GB Pounds - preferably in cash - to the staff member concerned who has truly exceeded expectations in terms of hospitality, service, and experience;
- Guest extras and curio sales can be settled by Visa and MasterCard credit cards (No Amex or Diners).

The Team

Lodge Owners

# DUBA EXPLORERS CAMP

DUBA CONCESSION | NORTHERN BOTSWANA



## Great Plains Conservation

### FOUNDATION INITIATIVE

#### Great Plains Earth Academy

In support of the communities living alongside the Okavango Delta the Great Plains Foundation has launched the Great Plains Earth Academy to provide personal and community enrichment opportunities for individuals living alongside wildlife. The Great Plains Earth Academy provides vocational training and supplemental education with a conservation and tourism focus to youth and adults living alongside Botswana's Okavango Delta. The goals of the Earth Academy are to improve participants' understanding of their local environment and wildlife, promote conservation and sustainability, and invest in the skill and capacity of the local community and workforce. The Great Plains Earth Academy is growing to meet the demand for educational, vocational and hospitality training, as well as community work in northern Botswana.

[www.greatplainsfoundation.com](http://www.greatplainsfoundation.com)

In addition to our own programs Great Plains Foundation keeps a list of school needs in the countries where we work. Needed items can be hand-carried by travelers or we can help purchase them locally. To learn more or to help support students and educators as part of your trip please reach out: [info@greatplainsfoundation.com](mailto:info@greatplainsfoundation.com)





# GUEST TENT

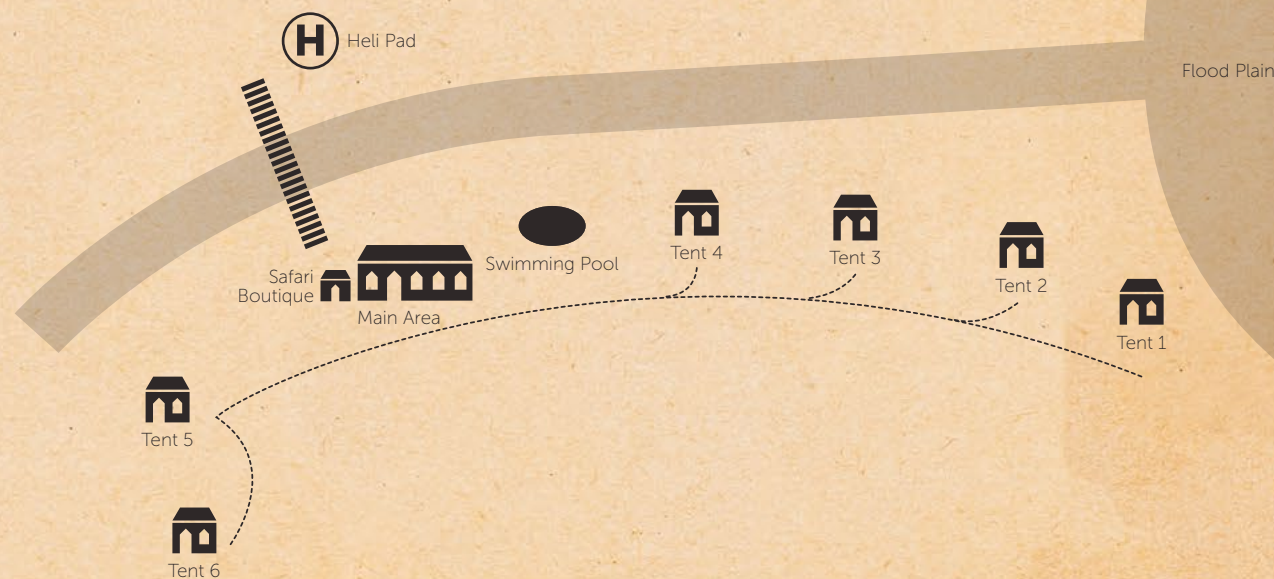
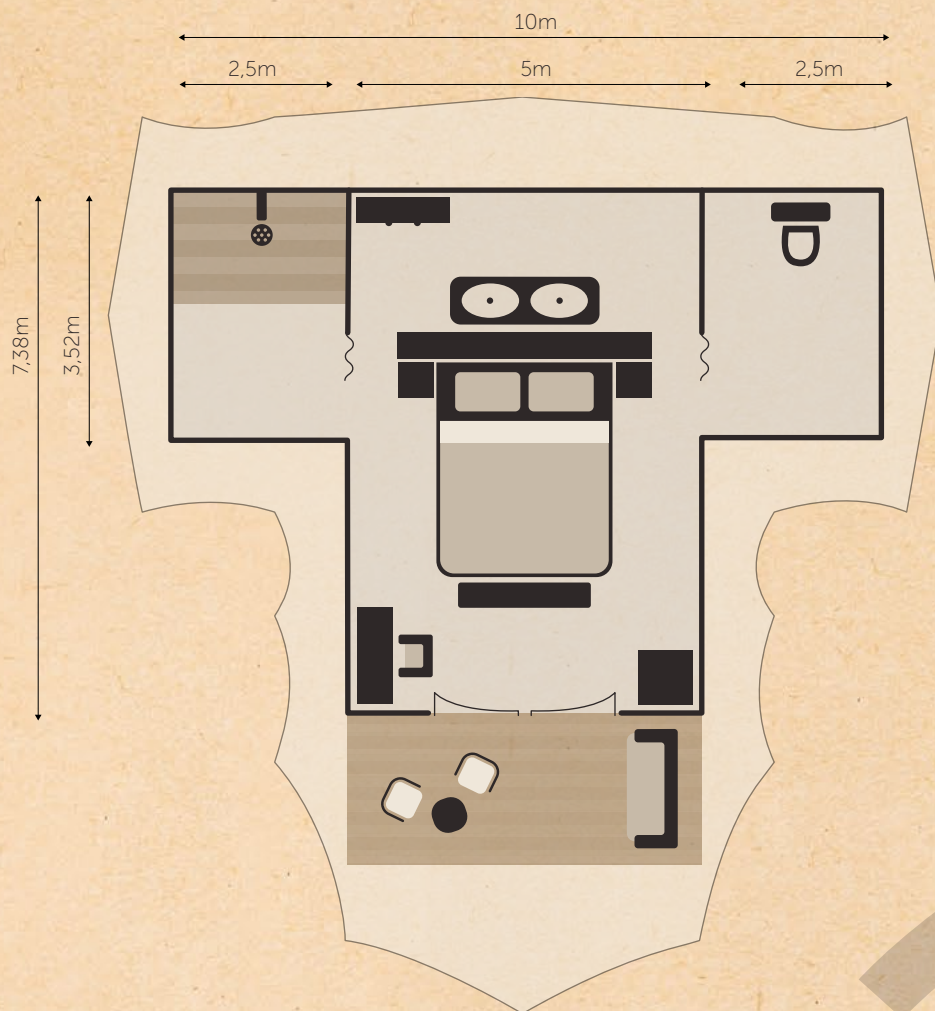





*Namibia*

*Bwabwata  
National Park*

*Mudumu  
National Park*

*Chobe Forest Reserve*

*Chobe National Park*

Selinda Explorers Camp

Selinda Camp &  
Selinda Suite

Zarafa Camp &  
The Dhow Suite at Zarafa

Okavango Explorers Camp

Sitatunga Private Island &  
Sitatunga Private Island Suite

Duba Explorers Camp

Duba Plains &  
Duba Plains Suite

Moremi Game Reserve  
*Okavango Delta*

*Botswana*

Maun

Kasane

## GREAT PLAINS

CONSERVING AND EXPANDING NATURAL HABITATS



GREAT PLAINS CONSERVATION  
STRIVES TO FIND THE RIGHT FORMULA OF  
CONSERVATION, COMMUNITIES AND COMMERCE  
THAT MAKES A LASTING, SUSTAINABLE DIFFERENCE  
TO THE WORLD'S ICONIC WILDLIFE  
AND WILDERNESSES.

*Nxai Pan  
National Park*



# GREAT PLAINS CONSERVATION

## QUICK CAMP FACTS



### BOTSWANA CAMPS

ACTIVITY	ZARAFA CAMP & THE DHOW SUITE AT ZARAFA	SELINDA CAMP & SELINDA SUITE	DUBA PLAINS CAMP & DUBA PLAINS SUITE	SITATUNGA PRIVATE ISLAND & SITATUNGA PRIVATE ISLAND SUITE
Camp Classification	Réserve Collection	Réserve Collection	Réserve Collection	Réserve Collection
Location	Selinda Reserve	Selinda Reserve	Duba Concession	Sitatunga Private Reserve
Number of Suites / Tents	4 Suites	3 Suites	5 Suites	2 Suites
Family Accommodation	The Dhow Suite at Zarafa	The Selinda Suite	The Duba Plains Suite	The Sitatunga Private Island Suite
Children can be accommodated from:	6 Years	6 Years	6 Years	6 Years
Day and Night Safari Drives	Yes	Yes	Yes	n/a
Private Activities (at an additional charge)	Yes (Included for Dhow Suite)	Yes (Included for Selinda Suite)	Yes (Included for Duba Plains Suite)	Private boating
Guided Walks	Yes	Yes	Yes	Yes
Boating (*water level dependent)	*Yes	*Yes	Yes	Yes
Mekoro and/or Canoeing (*water level dependent)	n/a	n/a	Mekoro	*Mekoro
Fishing (Seasonal and *water lever dependent)	*Yes	*Yes	Yes	Yes
Scenic Flights and Champagne Stops	Available at an additional charge	Available at an additional charge	Available at an additional charge	Available at an additional charge
Main Swimming Pool / Private Plunge Pools	Private Plunge Pool	Private Plunge Pool	Private Plunge Pool	Private Plunge Pool
Shower	Indoor & Outdoor	Indoor	Indoor & Outdoor	Indoor
Bath	Yes	Yes	Yes	Yes
Hairdryers (low-voltage)	Yes	Yes	Yes	Yes
Mosquito Nets	Yes	Yes	Yes	Yes
Over-bed air-conditioning	Yes	Yes	Yes	Yes
Fan	Yes	Yes	Yes	Yes
Wi-Fi – in-room (complimentary)	Yes	Yes	Yes	Yes
Safe - In-room	Yes	Yes	Yes	Yes
Spa treatments (at an additional charge)	Yes	Yes	Yes (In-room only)	Yes (In-room only)
Fitness	Gym & In-Room Equipment	In-Room Equipment	In-Room Equipment	In-Room Equipment
Boutique on site	Yes	Yes	Yes	Yes



### BOTSWANA CAMPS

ACTIVITY	SELINDA EXPLORERS CAMP	OKAVANGO EXPLORERS CAMP	DUBA EXPLORERS CAMP
Camp Classification	Explorers Collection	Explorers Collection	Explorers Collection
Location	Selinda Reserve	Selinda Reserve	Duba Concession
Number of Suites / Tents	3 Tents	6 Tents	5 Tents
Family Accommodation	1 Family Tent	n/a	n/a
Children can be accommodated from:	6 Years	6 Years	6 Years
Day and Night Safari Drives	Yes	Yes	Yes
Private Activities (at an additional charge)	Yes	Yes	Yes
Guided Walks	Yes	Yes	Yes
Boating (water level dependent)	n/a	n/a	*Yes
Mekoro and/or Canoeing (water level dependent)	Canoeing	Canoeing	Mekoro
Fishing (Seasonal and water lever dependent)	Yes	Yes	Yes
Scenic Flights and Champagne Stops	Available at an additional charge	Available at an additional charge	Available at an additional charge
Main Swimming Pool / Private Plunge Pools	Main Swimming Pool	n/a	Main Swimming Pool
Shower	Indoor	Indoor	Indoor
Bath	n/a	n/a	n/a
Hairdryers (low-voltage)	n/a	n/a	n/a
Mosquito Nets	On All Tent Sides	Yes	Yes
Over-bed air-conditioning	n/a	n/a	Yes
Fan	Yes	Yes	Yes
Wi-Fi – in-room (complimentary)	Yes	Yes	Yes
Safe - In-room	Yes	Yes	Yes
Spa treatments (at an additional charge)	n/a	n/a	n/a
Fitness	Yoga Mats	Yoga Mats	In-Room Equipment
Boutique on site	n/a	n/a	Yes