



  
AWASI

ATACAMA

THE JOY OF TAILOR-MADE



SAN PEDRO  
DE ATACAMA  
CHILE





## A BIT OF HISTORY...

San Pedro de Atacama has always been an oasis stopover for travelers searching for water, food, shelter and rest to continue on their journey. In an ancient site bounded by a historic wall that historically sheltered shepherds and herders, we erected a house of adobe, stone and wood, in which to continue the noble task of welcoming travelers who wish to live the memorable experience of the Atacama Desert.

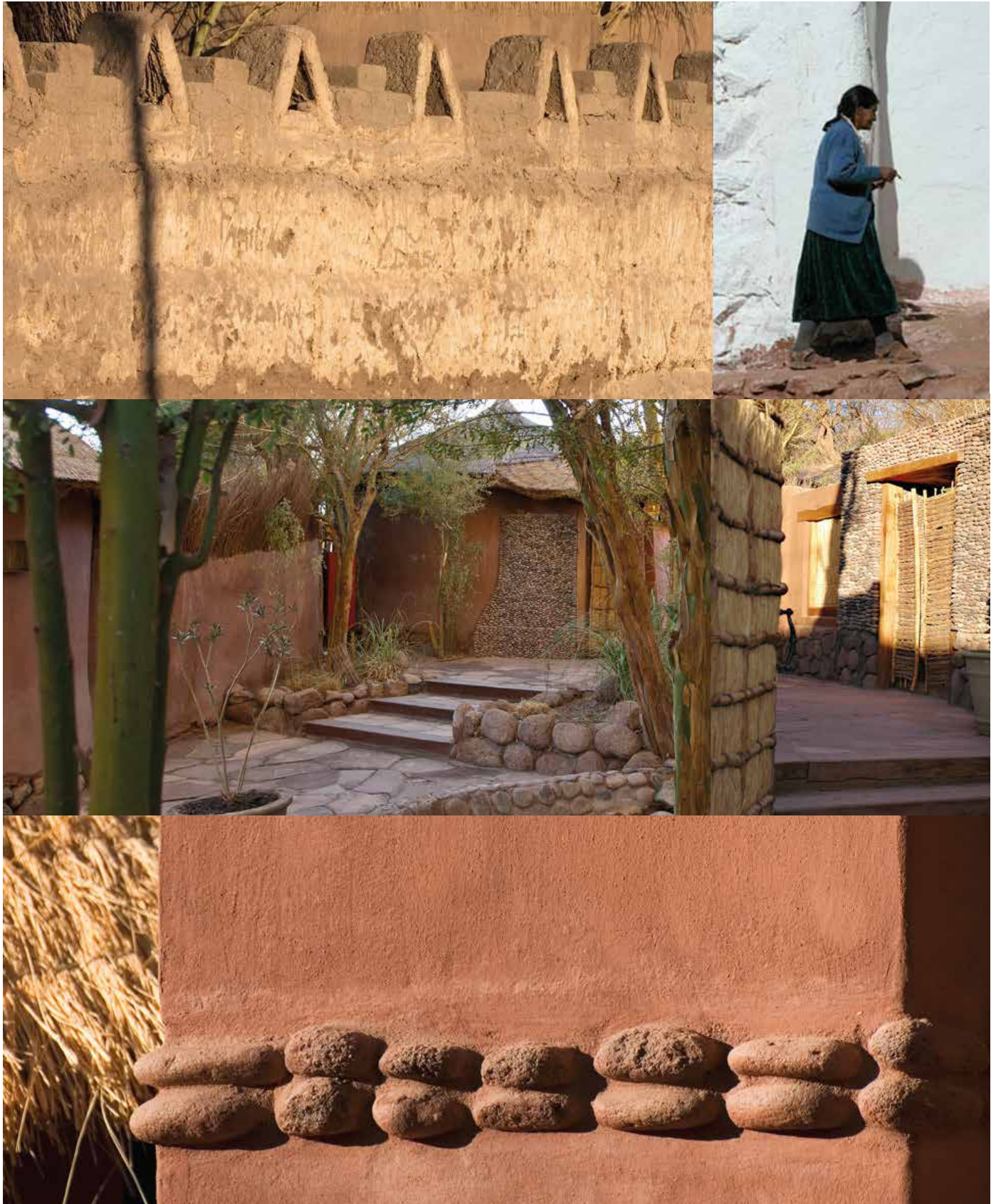



## OUR LOCATION

Awasi is located in the town of San Pedro de Atacama, a few blocks from the historical center, the market, the old church and the Square.

This proximity allows our guests to get to know the authentic "town life", while enjoying their intimacy in our hotel.

Since 2006, we have continued to offer memorable tailor-made experiences, accentuating with details the culture and nature of the Atacama Desert.



AWASI INTERIORS

## WHY AWASI?

- ◆ For the dedication of an entire team committed to catering to your preferences, distinguished by the care we give to each detail.
- ◆ Because Awasi is the only hotel in South America that offers a service that is 100% tailor-made for each guest.
- ◆ Because we focus on making dreams come true for travelers who come to the Atacama Desert attracted by its flora, fauna and landscapes, assigning a private guide and a 4x4 vehicle to adapt our excursions to their preferences and interests.
- ◆ Because our cuisine stands out for its flavors and textures, which feature regional staples and are adapted to the needs of each guest, with the culinary excellence that characterizes us as members of Relais & Chateaux.

## OUR ROOMS



The hotel has 8 rooms built of adobe, stone and wood. Each room has a minimum size of 60 square meters, large bathrooms, private patios and is designed for privacy and relaxation.

Awasi is made up of two areas, adding up to a total of 5,600 square meters, separated by a small and quiet public street. On one side of the street are five circular rooms (including 3 suites), the restaurant, the living room and the pool. On the other side of the street are three rectangular suites and the hotel's reception area.

## MASTERPLAN

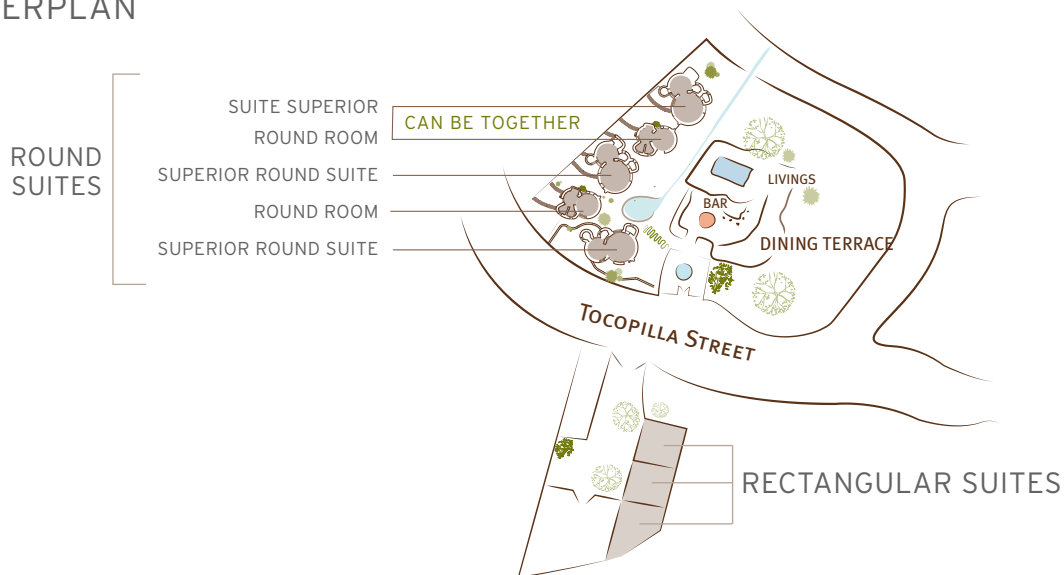

SUPERIOR ROUND SUITE

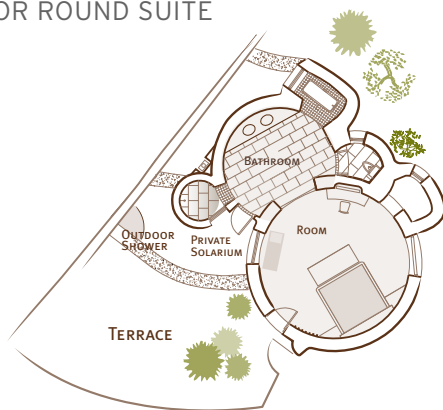

ROUND ROOM

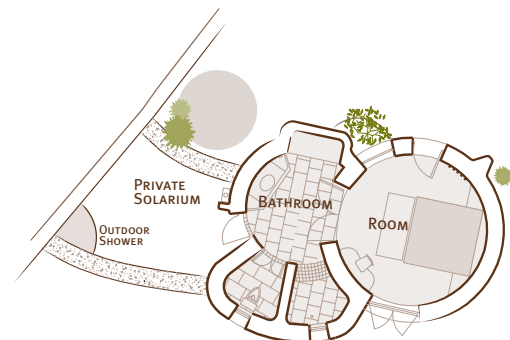

SUPERIOR ROUND SUITE WITH ROUND ROOM

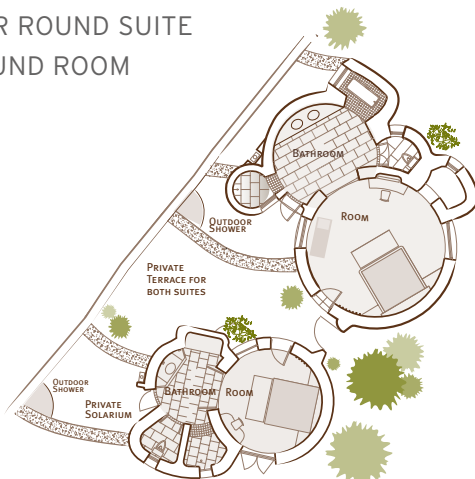

RECTANGULAR SUITE (Example)

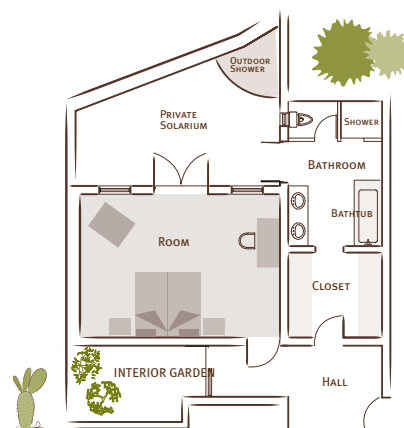





ROOMS





## OUR CUISINE

Our restaurant, for the exclusive use of Awasi guests, offers a daily selection that highlights local gastronomy, adapted to your requirements, and provides the culinary excellence that characterizes us as Relais & Chateaux members.

For over 7 years, Chef Juan Pablo Mardones has headed the Awasi Atacama restaurant team and devotes much of his time to studying and seeking native staples and local producers, using ingredients from the desert such as different varieties of potatoes, the chañar sweet fruit from the Chilean chañar tree, quinoa and algarrobo (carob tree), so that our guests can relish in a true local dining experience: bringing the desert to each one of the dishes that we offer.



## EXPLORING ATACAMA

Prior to your arrival at Awasi, we will ask you to complete a short questionnaire so we can learn your preferences, special interests, physical conditions, food requirements, and in general anything that allows our team to arrange an unforgettable trip, especially designed for you.



## EXCURSIONS

From the moment you arrive, we will assign a private excursion guide and a 4x4 vehicle so that you can experience the magic of the desert through excursions specially tailored to your pace and personal tastes.

You may choose between full-day excursions with lunch included (from 4 to 6 hrs.) or two half-day excursions (between 2 and 5 hrs.) returning to have lunch at Awasi between both excursions.

From pleasant walks to more demanding treks, horseback riding, bicycle riding, bird watching, astronomic tours, visits to archaeological sites, salt flats and geysers, or to incredible valleys hidden in the midst of the desert, the experiences during your stay at Awasi, are endless.

Our guides are professionally trained in archaeology, history, flora, fauna and first aid, so you can enjoy these life experiences in a safe and pleasant way.

We have guides trained in Spanish, German, French and English.

All our vehicles are equipped with GPS and a communication system.





## ALL INCLUSIVE

### OUR RATES INCLUDE:

- Accommodation
- Excursions in 4 x 4 vehicles and private guides
- All meals and alcoholic and non-alcoholic beverages.
- Private transfers to and from Calama

## WEATHER

During the day, annual temperatures fluctuate between 20 ° C and 30 ° C (68° F - 86° F). During the winter months (May to August) temperatures at night can drop several degrees below 0 ° C (32° F). Some early morning trips may experience extreme temperatures

SUMMER	FALL	WINTER	SPRING
Min: 16° Max: 27° 21 Dec - 21 March	Min: 8° Max: 24° 21 March - 21 June	Min: 4° Max: 22° 21 June - 21 Sept	Min: 8° Max: 25° 21 Sept - 21 December

## OUR RECOMMENDATIONS:

### CLOTHING:

Light and summer clothes for the day: t-shirts, shirts, shorts, swimwear.

Warmer clothes for the night: sweater, jacket, fleece jacket, long pants.

Sandals, sunscreen, glasses, hat, warm clothes, comfortable footwear, special shoes for hiking, backpack, windbreaker or fleece jacket.

Medications that you usually take.

### TIPS

San Pedro is situated at 2,450 (8,036 ft.) meters above sea level. To prevent altitude sickness, it is important that you take it easy on the first day; in addition to hydrating (drinking over 3 liters of water) and limiting consumption of alcohol and coffee.





## LOCATION

### ADDRESS

Calle Tocopilla 4, San Pedro de Atacama. Región de Antofagasta.

### LOCATION MAPS



## HOW TO GET THERE

### ♦ FROM SANTIAGO, CHILE:

LAN and SKY offer daily flights to Calama, every two hours.

Your guide will meet you at the airport, from where you will be taken to Awasi. This trip takes approximately 90 minutes.

### ♦ OTHER POINTS OF REFERENCE FROM AWASI:

Due to the proximity of San Pedro de Atacama to the border, land travel is possible to and from other countries such as Argentina, Peru or Bolivia, through various border crossings: Jama, Sico and Socompa.

- Awasi - Salta: approx. 629 km
- Awasi - Bolivia (border): approx. 47 km
- Awasi - Peru (Tacna): approx. 800 km.
- Awasi - Antofagasta: approx. 310 km

### CONTACT:

+(56-2)2233-9641

info@awasi.cl

www.awasi.com

### TOLL FREE

USA: 1-888-880-3219

UK: 0-808-101-6778

BRAZIL: 0-800-892-1347

FRANCE: 0800-915828

AUSTRALIA: 1-800-768-365



WATCH OUR VIDEOS:

<http://vimeo.com/user35032354>