



# KICHAKANI CAMP

AN A&K SANCTUARY



*Serengeti National Park, Tanzania*



*The plains of Serengeti National Park are rich in wildlife*

# A classic mobile sanctuary tracking the Serengeti's Great Migration

Few safari set-ups are as rooted in the East African landscape as Kichakani Camp (“Kichakani” is Swahili for “in the bush”). This extraordinary camp moves between two locations in different parts of Tanzania’s Serengeti National Park, so guests can fully experience two highlights of the famous Great Migration: the Mara River crossing in the north and wildebeest calving season in the south. Nimble and light-touch, Kichakani is a classic tented camp with luxurious touches, where communal areas are pitched just so for suppers and sundowners with panoramic views, and days are filled with the thrill of following the greatest natural show on earth.

# Six Reasons to Choose Kichakani Camp



01



*The panoramic splendor of Tanzania*

The sheer scale, sweep and uplifting beauty of the Serengeti itself.

02



*A classic safari set-up awaits*

Intimate mobile camp following the Great Migration in two locations throughout the year.

03



*Herd of wildebeest graze on the plains*

Puts guests smack bang in the middle of one of the world's most spectacular wildlife events.

04



*Comfort meets authentic camping*

Authentic close-to-nature safari experience – just the canvas, a bucket shower, and the bush (with plenty of cossetting contemporary touches).

05



*Big cats cool off in the shade*

Abundant wildlife with ample opportunity to see the Big Five, and more than 500 bird species.

06



*A fire illuminates the big African skies*

Communal evenings round the fire pit to swap tales of sightings.

# The Camp



Moving between two locations, the northern and southern Serengeti, Kichakani offers the ultimate remote, close-to-nature experience. It also means guests can choose the best time to visit depending on their preferences. The northern location showcases an incredible view of wildebeest crossing the Mara River during the Great Migration from June to November, while the southern location enjoys a prime position for observing wildebeest calves, every December to March.

While experiencing a natural spectacle that has occurred since time immemorial, guests at Kichakani Camp are also transported back to another era – that of roaming 19th-century explorers. Except here the traditional design has luxurious extras, so while there may be old-school bucket showers, they are attached to ensuite bathrooms and filled at the perfect temperature by a dedicated tent attendant. The perfectly portable furniture in the 10 teak-floored guest tents and large open-fronted communal tents is elegant and characterful: handcrafted luggage, mid-century modern chairs and handsome cabinets. And the evening entertainment is authentic and timeless; gathering round the crackling fire to swap tales of wildlife encounters under African skies pinpricked by stars.

*Safari chairs around the fire pit*



*"The perfectly portable furniture is elegant and characterful – what really steals the show is the rolling savannah surroundings."*



*Comfortable seating in the open-sided bar*

# The Camp



## CLASSIC SAFARI TENTS

Equal parts romantic and thrilling, sleeping under canvas with the sounds of the bush as nature's white noise is an African safari highlight.

## STARGAZING DECK

Guests gather at this elevated platform for dinners under the stars or simply to spot the constellations in the clear and inky-dark Tanzanian heavens.

## BAR AND FIRE PIT

The well-stocked bar has comfortable sofas for a scenic sundowner or a nightcap. Beyond it is a fire pit surrounded by classic safari chairs (and blankets) for convivial and cosy evenings.

## DUAL LOCATION

The brilliant mobile set-up of the camp pitches it in the northern Lamai triangle from June to November and in the south December to March to see the wildebeest calves of the Serengeti migration.

## BUCKET SHOWERS

A luxurious touch in a remote camp, bucket showers offer an authentic safari experience and have the added bonus of being eco-friendly.

## ECO CREDENTIALS

The light-touch design of Kichakani Camp incorporates furniture crafted from recycled materials and electricity generated by solar power.



CLOCKWISE FROM LEFT  
*Wildebeest survey the plains*  
*The light-touch camp has a well stocked bar*  
*Epic views are always a thrill*

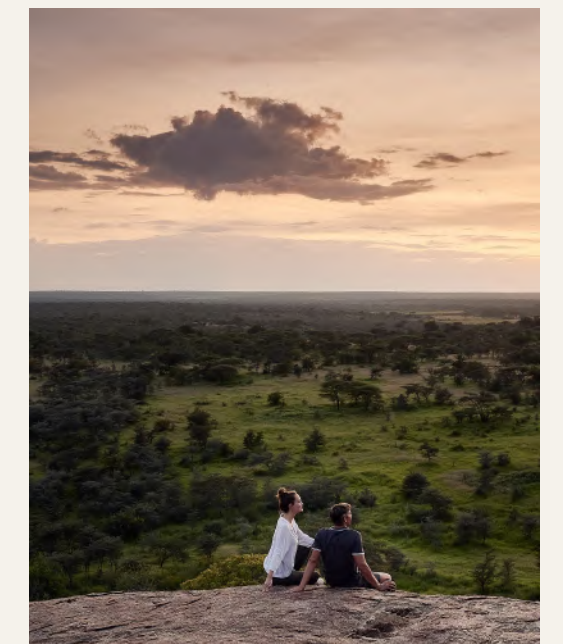

# The Camp



*Each tent has a private deck*

*A fire and blankets for cosy evenings*

GPS Coordinates	GPS 01° 33' 71" S, 34° 42' 55" E - Lamai Airstrip Kusini for Serengeti South Airstrip
Open Year Round	Closed during April and May
Number of Rooms	10
Maximum Number of Guests	20
Child Policy	Children aged 6 and over are welcome. Children under 15 must share with an adult
Guide/Pilot Accommodation	Yes
Wheelchair Accessible	No
Power Supply	Solar power with generator and inverter
WiFi Available	Yes, in all areas
Binoculars Provided	Yes; Leica binoculars provided for every guest
Camp Fenced	No
Credit Cards Accepted	Visa, MasterCard
Currencies Accepted	USD, Pound, Euro, and Tanzanian Shillings

# The Tents



Century-old safari style meets present-day practicality in Kichakani Camp's 10 generously proportioned tents. Teak floors, billowing white curtains and cooling fans, plus vintage washstands and bucket showers in the ensuite bathrooms, make for a characterful feel. Each tent opens onto a small deck with widescreen Serengeti views that are equally timeless.

*Wild luxury: an ensuite bathroom*



*"Nothing beats waking to the sound of birdsong outside your classic canvas tent."*



*The classic tents have a timeless feel*

# The Tents

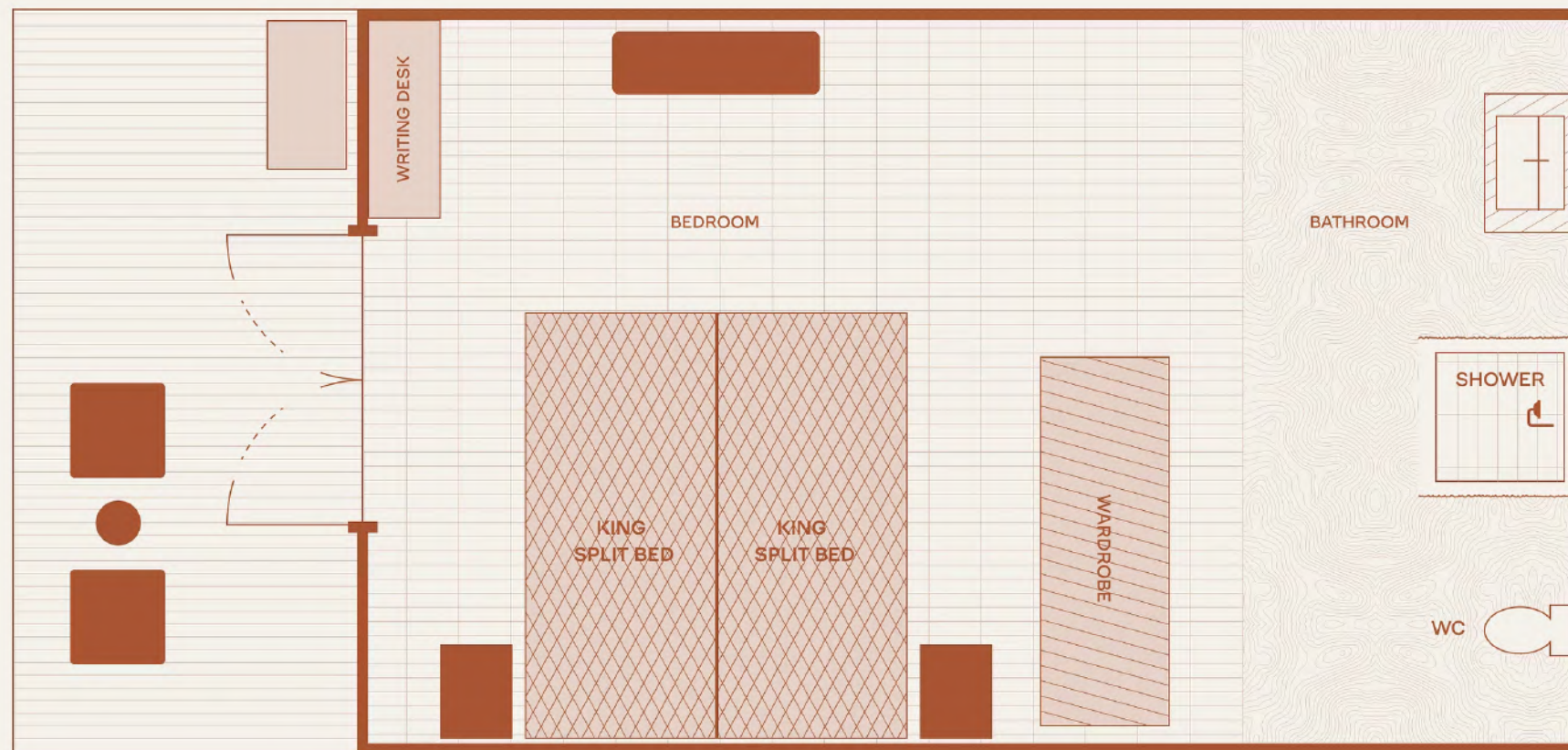

## LUXURY GUEST TENT | SLEEPS 2 | 42 SQM

Each of the tents is large and airy with a private deck and seats overlooking the plains. All have king-size beds and an ensuite bathroom with authentic bucket shower and vintage washstands. A personal tent attendant is on hand around the clock.

Room Size	42m2
Bed Configuration (King or Twin)	All rooms can be converted to a king or twins
Triple Rooms Available	Yes; subject to availability
Mini Bar	No
Tea and Coffee Station	No
Air Conditioning	No
Overhead Fan	A standing fan is provided
Mosquito Net	Yes
Plug Type	Type G Plus, USB and USB Type C
Bath	No
Indoor Shower	Yes, a bucket shower
Outdoor Shower	No
Hairdryer	Yes



*The Serengeti is an unforgettable setting for al fresco dining.*

# Food & Drink



The brilliant bush-kitchen team at Kichakani Camp are adept at magicking up delicious safari-style cuisine in a wild and wonderful setting. Dishes might include soups and salads, grilled meats, fish, and fresh vegetables (and plenty of thoughtful snacks) – all with a local twist. A dining wing of the main tent provides an idyllic setting for meals looking out over the plains, and romantic private dinners can be arranged around the camp on request. Guests gather at the open-sided bar for sundowners or a nightcap, while the fire pit draws stargazers after dark. As with all A&K Sanctuary lodges and camps, food and drink is included.

- A continental or English breakfast is served in camp before the morning game drive.
- Lunch is either back at the camp or picnic-style in the bush if guests are out game-spotting.
- Sundowners are a delightful daily ritual, followed by a three-course dinner in the elegant mess tent, expertly assembled from fresh, locally sourced, seasonal ingredients.
- Picnic lunches can be arranged on request.

*Kichakani Camp's expert chefs*



# Camp Location



Serengeti National Park is widely considered the most magnificent in all of Africa. At 5,700 square miles of grassland plains, savannah, forest and woodlands, it is the largest park in Tanzania and also the oldest – and has been a UNESCO World Heritage Site since 1981. Its diverse habitats harbor elephants, rhinos, giraffes, buffalos, impalas, warthogs and reedbucks, all the likely big cat predators, and more elusive animals such as the African wild dog.

The Serengeti ecosystem is one of the oldest on earth. The essential features of climate, vegetation and fauna have barely changed in the past million years. For the Maasai, who traditionally grazed their herds on the grassy plains, it is Siringitu – “the place where the land moves on forever”. Some patterns of life, death, adaptation and migration are as old as the hills

themselves, and it is the migration for which Serengeti is perhaps most famous. Over a million wildebeest and about 200,000 zebras flow south from the northern hills to the southern plains for the short rains every October and November, and then swirl west and north after the long rains in April, May and June.

In order to maximise the viewing of this extraordinary natural wonder, nimbly designed Kichakani Camp moves between two locations, one in the north, one in the south, to be in pole position for the Mara River crossing during the Great Migration, and for wildebeest calving season. So for guests, the exact coordinates of the camp will depend on the time of year they visit, but the surrounding widescreen, unspoilt, acacia-dotted grandeur is a constant.

*As evening falls the fire pit beckons*



*The camp is perfectly pitched to maximise views*

# Getting There



*A lone lion in the grasslands*



Arusha Airport to Lamai Airstrip (June-November) / Arusha Airport to Serengeti South Airstrip (December-March)

2-hour flight / 1-hour 30-minute flight



Lamai Airstrip to the Camp / Serengeti South Airstrip to the Camp

1-hour drive / 15-minute drive

Please note, luggage restriction for light aircraft is 20kg/44lbs per person in a soft-sided bag, including hand-luggage.

# Experiences



The phenomenal spectacle of the Great Migration will naturally top the must-see list of most guests at Kichakani Camp: one million-plus animals driven by an ancient instinct to move, overcoming drought, gorges and crocodile-infested waters along the way. And while Kichakani's dual locations put visitors front and center for much of the high drama, there is also lots to see beyond the headline act. Due to its grand scale, the Serengeti has a wonderfully diverse habitat, and guests get to discover it on twice-daily game drives. Binoculars at the ready for bountiful birdlife and lots more besides.



*Never miss a sighting in the open-sided 4x4*

## **GAME DRIVES**

Expert-led game drives in the early morning and late afternoon allow guests to see the Serengeti at its breathtaking best. Full-day game drives are also possible.



*Toasting the day's adventures*

## **SUNDOWNERS**

Sipping a refreshing cocktail or chilled glass of wine as the sun sets on the African savannah is an essential component of the safari experience. Sit back and take it all in as the light fades and the nocturnal orchestra tunes up.

# Wildlife & Nature

---

The northern location of Kichakani Camp showcases the sensational spectacle of wildebeest, zebra and antelope crossing the Mara River during the Great Migration (historically from June to November), while the southern location allows guests to witness the next phase of the circle of life, the wildebeest calving (between December and March), during which as many as 8,000 baby wildebeest are born every day.

Unforgettable migration scenes aside, both camp locations offer the chance to spot a thrilling tableau of iconic African animals: giraffes, elephants, rhinos, zebras, gazelles, lions, hyenas, cheetahs and leopards. For keen birdwatchers, Serengeti National Park is also home to about 500 species of bird – from leggy ostriches and marabou storks to colourful pairs of lovebirds chirping in the trees.

*A predator enjoys some downtime*



*The circle of life plays out here*

# Your Kichakani Camp Safari



*Wildebeest and zebra move across the Serengeti*

Days at Kichakani Camp deliver pulse-quickening adventure as well as serene moments to simply soak up the incredible nature all around. The camp's expert team of guides and support staff cleverly choreograph every detail – from action-packed morning game drives to post-dinner drinks on the starlit deck.

#### **A TYPICAL DAY MIGHT INCLUDE:**

- **Wake-Up Call** - Enjoy a tea or coffee on your own deck as the soft morning light illuminates the Serengeti.
- **Breakfast** - A fresh, hearty breakfast served in the dining tent, soundtracked by the cacophony of the bush.
- **Morning Activity** - Set out with binoculars primed to spot giraffes, zebras, elephants, predators and perhaps a rare bird.
- **Lunch** - Return to the camp for a delicious lunch of safari-style dishes, or enjoy a picnic in the bush.
- **Afternoon Activity** - Another opportunity to explore with the expert guides.
- **Drinks and Dinner** - The moment to sit back and swap stories of the day's adventures over cocktails and a three-course dinner.

# The Details



## HONEYMOON, ANNIVERSARIES & SPECIAL OCCASIONS

Romance and luxury are woven into each of our stays, and our Kichakani Camp team adds an extra sprinkling of magic when it comes to special occasions. From a bespoke honeymoon cocktail during sundowners to sparkling wine in guests' tent on the night before departure, the team creates special experiences that celebrate a visit to the unique Serengeti setting.

## FAMILIES WITH CHILDREN

Kichakani Camp welcomes children aged 6 years and older. Children aged 15 years and younger are required to share with an adult.

## INCLUSIONS

- All meals, non-alcoholic and alcoholic beverages (including premium brands)
- Return transfers from/to nearest local airstrip
- Game viewing activities including: game drives
- Emergency medical evacuation
- Laundry services

## EXCLUSIONS

- Park and concession fees
- Tourism development levy
- International and domestic flights, landing fees
- Road transfers to and from other camps and lodges
- Travel insurance, boutique purchases, gratuities, and all other items of a personal nature
- Additional activities not listed



*Morning coffee on a private deck*



*The camp's epic setting never fails to impress*

# Travel Tips



## WHAT TO PACK

Clothing should be cool and comfortable; and colours should blend in with nature as much as possible. Greens, browns and khaki coloured clothing are advisable for safaris. We suggest long sleeves and long trousers for morning and evenings due to mosquitoes; and a fleece, sweater or warm jacket for morning and evening game drives. Sturdy and comfortable shoes are essential. A complimentary overnight laundry service is offered in the camp.

Accessories: Sunscreen, sunglasses and hats are essential. Binoculars and good cameras are an absolute must. The camp provides a torch as well as complimentary mosquito repellent and toiletries.

## HEALTH

Please discuss health precautions for your travel itinerary with a qualified health professional at least six weeks before departure. We also advise all travellers to take precautions against malaria and we recommend speaking to your GP or personal physician four to six weeks before departure. Yellow fever vaccination is required for guests travelling to Tanzania.

## MONEY & CREDIT CARDS

All extras can be paid for with Visa, MasterCard, American Express and traveller's cheques. US dollars, British pounds, Euros are also accepted; however, change will be given in the local currency.

## GRATUITY GUIDELINES

Tipping and gratuities remain entirely at your discretion.

*Lions languishing in a tree*



# Climate



While it's impossible to predict the weather, guests might find it helpful to learn how a visit to Kichakani Camp might differ from one month to the next: from the optimum season for big cat activity to the best time to see the thundering climax of the Great Migration.



*Lions are busy during this season*

## **JANUARY–MARCH**

The ideal time to visit the Southern Serengeti – calving season, when up to 8,000 wildebeest are born in a single day. Peak numbers of big cats are attracted to the area as a result. Note that the camp is closed in April and May.



*Game drives follow the wildebeest herds*

## **JUNE–JULY**

Kichakani Camp opens in the Northern Serengeti, as thousands of wildebeest and other herbivores move north. There are great opportunities to witness dramatic river crossings and interactions between predator and prey. This is prime time for unforgettable wildlife encounters and photography.



*River crossings are a thrill to watch*

## **AUGUST–OCTOBER**

The Great Migration reaches its frenzied peak in the Northern Serengeti, with incredible opportunities to witness river crossings by wildebeest and zebra on the move, plus intense predator action as crocodiles and lions pick off the weakest of the herd.

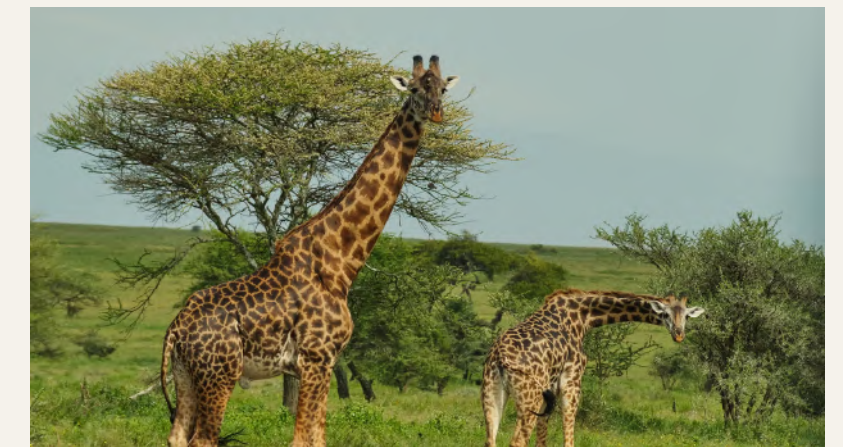

*Giraffes have ample grazing opportunities now*

## **NOVEMBER–DECEMBER**

Kichakani Camp moves back to the Southern Serengeti (at the end of November/early December), following the migration as it moves south. Rejuvenated by the short rains, the landscape becomes lush and pulses with wildlife activity. Another great time for photography.

# A&K Philanthropy Initiatives in Tanzania



*Community connection is at the heart of A&K Philanthropy*

## **JOURNEYS WITH PURPOSE**

The A&K Philanthropy nonprofit network now spans 24 countries on all seven continents, positively impacting hundreds of thousands of lives and helping preserve some of the world's most precious ecosystems. Our initiatives focus on education, enterprise, health and environment, aiming to support and empower local communities to facilitate the protection of their surroundings, and to ensure that the people in the places where we travel are also benefitting directly from tourism.

## **SAFE WATER FOR SCHOOLS**

Since 2017, A&K Philanthropy has partnered with LifeStraw, makers of an accessible water filtering and purification device, to provide safe water to thousands of children in India, Kenya, Tanzania, Uganda, Vietnam and Zambia. AKP has funded and distributed 829 filtration systems in schools, with each filter serving up to 100 children for a period of five years. Guests in the areas where LifeStraw has been installed can see firsthand how this simple device makes a great impact on the community's overall health and wellbeing.

## **EDUCATION ON THE EDGE OF TANZANIA'S WILDERNESS**

Children who attend Gijedabung and Mwikantsi primary schools in Tanzania share their beautiful surroundings with the animals of Tarangire National Park in which the schools are located. Proximity to wild animals can be challenging for local communities, due to the impact on livestock and crops. Part of AKP's educational work is to find ways to support communities to live alongside wildlife so that conservation of the region's special megafauna can continue. At these schools AKP provided new classrooms, educational materials, accommodation for teachers and solar power so that both teachers and students can focus on learning.

# A&K Philanthropy Initiatives in Tanzania



## ILBORU SPECIAL NEEDS EDUCATION UNIT

In 2006, A&K Philanthropy partnered with teaching specialist Loitushui “Loy” and the local community to build the Ilboru Primary School for Children with Special Needs. AKP and Tanzania’s Ministry of Education expanded the primary and opened a secondary school in 2016, and AKP has since updated the school’s kitchen, built a dining hall, constructed a playground and partnered with Bootstrap Africa to build girls’ and boys’ dormitories. In 2024, six classrooms were added to the campus, boosting capacity to 200 students, making it by far the largest school of its kind in the district.

## PROJECT CURE

AKP’s global medical assistance program has been created in collaboration with U.S. nonprofit Project C.U.R.E to bring essential medical equipment and healthcare supplies to resource-limited communities. Funded by AKP, containers are filled with donated medical supplies and equipment in the U.S. and shipped overseas to one of our partner facilities in Zambia, Tanzania, Uganda and Cambodia, where the supplies are then distributed to local hospitals, health centers and clinics.

## KAFIKA HOUSE

AKP partnered with Kafika House to provide disabled children in the Tanzanian city of Arusha with a holistic, transformative healthcare facility. Kafika House affords a safe and loving home for children receiving pre- and post-operative care and rehabilitation for surgically correctable disabilities such as cleft lip and palate, clubfoot, skeletal fluorosis, burn scar contractures, masses and osteomyelitis. Children spend an average of three months at Kafika House, all the while learning, playing and receiving the care they need. Guests at Kichakani Camp are welcome to visit Kafika House for a tour of the facilities and to gain a deeper understanding of the program’s mission.



*Schoolchildren in Tarangire National Park*

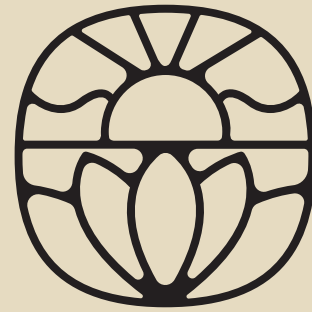

A&K SANCTUARY