



& BEYOND

DISCOVER THE OKAVANGO DELTA

&Beyond Nxabega Under Canvas

A soulful, under-canvas camp where water,
stillness and story shape every safari.



DISCOVER THE OKAVANGO DELTA
&Beyond Nxabega Under Canvas

Why stay?

1 A QUIETER KIND OF INTIMACY

With just three tents and space for only six guests, Nxabega Under Canvas offers solitude in its purest form. This is privacy not just of place, but of pace – where nothing is rushed, and every detail feels personal.

2 STILL WATER, SOFT WONDER

Seasonal mokoro adventures and morning birdwatching replace adrenaline with awe. The landscape reveals itself gently one water lily, dragonfly, or fish eagle call at a time.

3 LUXURY THAT WHISPERS

Each element is there because it should be – not to dazzle, but to feel right. Running water, fans, Wi-Fi, and laundry are delivered with quiet grace. Every comfort held lightly.

4 ROOTED IN RHYTHM

Life here follows the Delta's flow – reflective mornings, golden afternoons, firelight dinners. It's not just about what you see, but how you feel as you see it.

5 STORIES BY STARLIGHT

Meals are shared around the fire or beside the water, under a ceiling of stars. Freshly prepared and unhurried, they become part of the memory layered with laughter, connection, and the calls of the wild.



DISCOVER THE OKAVANGO DELTA
&Beyond Nxabega Under Canvas

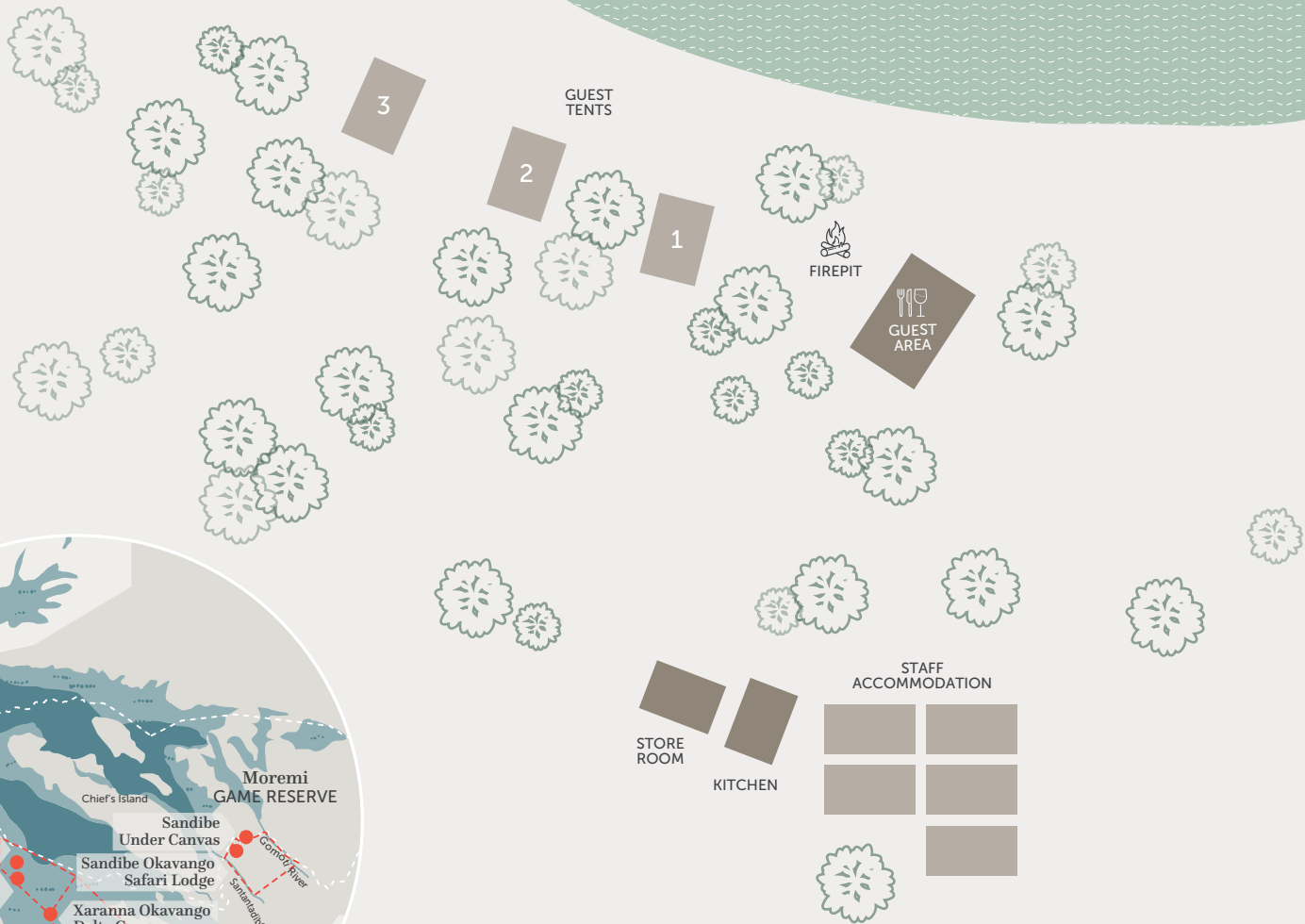

&BEYOND
**Nxabega
Under Canvas**

 Floodplain

DISCOVER THE OKAVANGO DELTA

Beyond Nxabega Under Canvas

Camp amenities



1

A SOFTER KIND OF SAFARI

Open-sided tents welcome the breeze and the birdsong. A personalised butler and well-stocked personal bar ensure quiet luxury, delivered with ease.



2

CURATED SAFARI ESSENTIALS

Every guest receives a complimentary pair of SWAROVSKI OPTIK CL Companion 8x30, along with a Guides' Journal to track birds, wildlife, and reflections along the way.



3

DINING THAT SLOWS YOU DOWN

Meals are cooked over an open fire and served al fresco – unrushed, under stars, and in harmony with the day's pace.



4

STAY CONNECTED, IF YOU CHOOSE

All safari vehicles are fitted with 12V charging units and USB ports, keeping devices ready for capturing beauty – or leaving them behind.

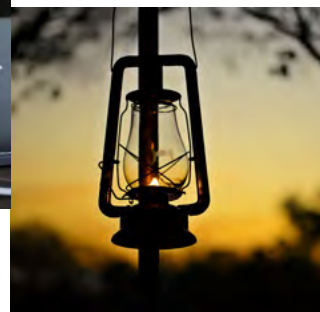

5

A LIGHTER FOOTPRINT

Built for impermanence and designed to leave no trace, the camp runs entirely off-grid, powered by its own solar plant. With no permanent structures and a deliberately light-on-land approach, it's crafted to blend in, not stand out – reflecting deep respect for the land and those who will walk it next.



6

THE QUIET BETWEEN SOUNDS

Sleep to the rustle of reeds, the call of a distant owl, or the gentle lapping of water. At Nxabega, the quiet isn't empty – it's full of meaning.

DISCOVER THE OKAVANGO DELTA
&Beyond Nxabega Under Canvas

Camp overview

CAMP

Maximum number of guests	6
Number of rooms	3
Room types	Tents
Family accommodation	Children 12 years and older only No triple Tents All double Tents can be converted to twin
WILDchild programme	No
Child policy	Children 12 years and older only
Pilot / Guide accommodation	No
Distance between rooms	10 m (32 ft) Tents are located to optimise space available per campsite
Check-in and check-out times	14h00 / 11h00, with early check-in and late check-out on request

DINING

Food / Dietary options	Halal and Kosher food not available
Butler service	Yes
Family-style dining	Yes, shared meals around the fire or dining table
Private dining	Yes, on request

PAYMENT TYPES ACCEPTED

Credit cards accepted	Visa and Mastercard
Currency	All major currencies accepted

FACILITIES

Power	12V charging units and USB ports on 4x4 safari vehicles Solar powered lamps and plug points in tents
Internet access	Yes, Wi-Fi
Running water	Yes
Outdoor dining	Yes
Bar	Yes, well-stocked bar
Wheelchair accessibility	No
Laundry service	Yes, limited Guests are also provided soap suds to do their own laundry
&Beyond Safari Shop	No

OTHER

Vehicle type	Semi-open 4x4 safari vehicle with fridge and 12V charging units and USB ports Max. 6 guests per vehicle
Private 4x4 safari vehicle	No

DISCOVER THE OKAVANGO DELTA
Beyond Nxabega Under Canvas

Inclusions

RATE INCLUDES

Accommodation	✓
Three meals daily	✓
Soft drinks, house wines, local brand spirits and beers, tea and coffee, and refreshments on safari game drives	✓
Safari experiences: Safari game drives, walking safaris, mokoro adventures*, catch-and-release fishing*, stargazing and birding	✓
One complimentary pair of SWAROVSKI OPTIK CL Companion 8x30 per tent to share during your stay	✓
Guides' Journal with illustrations of fauna and flora to record your sightings	✓
Area map with illustrated Star Birds checklist	✓
Emergency medical evacuation insurance	✓
VAT	✓
Limited laundry	✓

RATE EXCLUDES

Administration fees	✗
Telephone calls	✗
All items of personal nature	✗
Gratuities	✗
Champagne, cognacs, fine wines, premium brand spirits and cigars	✗
Landing fees	✗
Travel Insurance	✗
Scenic helicopter flights	✗

*This activity is seasonal as water levels change yearly and weather patterns are unpredictable.

NOTE: Unmanned Aerial Vehicles: Please be advised that the use of unmanned aerial vehicles (drones) is prohibited in the conservation areas where we operate, until such a time as their impact on wildlife and anti-poaching initiatives can be assessed. This rule will apply throughout Africa, as our partners in various countries and regions have adopted a similar stance.





BEYOND

BEYOND NXABEGA UNDER CANVAS

Tents



DISCOVER THE OKAVANGO DELTA
& Beyond Nxabega Under Canvas Accommodation

Where water slows the world.

Set beside a seasonal floodplain in the heart of the Okavango Delta, Nxabega Under Canvas offers an intimate and exclusive safari experience with just three tents. Designed for tranquillity and immersion, the camp invites guests to slow down, unwind, and savour the rare serenity of the wilderness.



SPACIOUS ENSUITE BATHROOM



CANVAS TENT EXTERIOR

DISCOVER THE OKAVANGO DELTA
Beyond Nxabega Under Canvas Accommodation

TENT

3 Tents / Max. 2 guests per Tent

LUXURY, BY NATURE'S DESIGN

Just three canvas tents make up Nxabega Under Canvas, each offering a private veranda, an ensuite bathroom, and a steaming hot shower. Comfort here is subtle, carefully designed to let the sights, sounds, and scents of the Delta take centre stage.

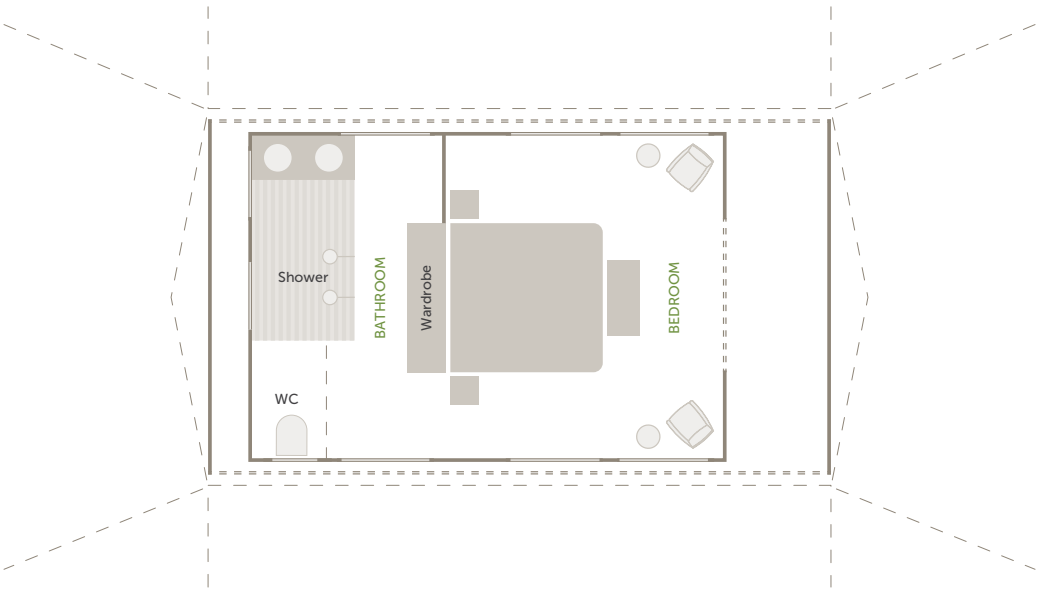

Typical Tent layout

ROOM FACILITIES

Tent size	Approx. 29.16 m ² (314 ft ²)
Private veranda	Yes, 9 m ² (97 ft ²)
Personal bar	No, but the camp has a well-stocked bar
Personal coffee station	No
Air conditioning / heating	No
Standing fans	Yes
Mosquito nets	No, however, tents are fully netted and insect-proof
Bath	No
Indoor shower	Yes
Outdoor shower	No
Separate WC	Yes, separate flushing WC
Telephone	No
Hairdryer	No
Internet access	Yes, Wi-Fi
In-room safe	Yes
Power	12V charging units and USB ports on 4x4 safari vehicles Solar powered lamps and plug points in tents
Triple bed option	No
Twin bed option	Yes, however, beds are within the same bedframe All double tents can be converted to twin
Double bed option	Yes
Wheelchair accessibility	No



BEYOND

DISCOVER THE OKAVANGO DELTA

Adventures of a lifetime

Celebrated for its winding waterways, glassy lagoons and remote islands teeming with wildlife, its no surprise that nature lovers flock to the Delta.

DISCOVER THE OKAVANGO DELTA
Adventures of a Lifetime

Land and sky experiences

A Botswana safari is an experience of a lifetime, and there is so much on offer in the Delta – from twice-daily game drives and walks, to the spectacular star-studded night skies.



1

SAFARI GAME DRIVE

Enjoy twice-daily game drives that set off early in the morning or late in the afternoon (continuing after nightfall), in the company of local career guides who will do their best to ensure that all your wishes are met. You will be encouraged not only to go in search of the Big Five, but also to appreciate the wonderful array of flora and fauna dotted across the Okavango Delta.



2

WALKING SAFARI

If you're looking for a thrilling view from the ground, this is your chance to discover a multitude of natural wonders in the company of your experienced safari guide. Tread in the tracks of the Delta wildlife, breathe in the scent of crushed wild grasses, and feel your senses come alive.

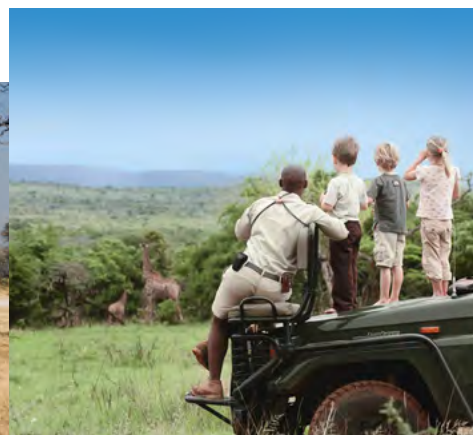

3

FAMILY SAFARI

&Beyond offers a host of entertaining activities for children, bringing alive the magic of Botswana. Whilst on a family safari, you can rest assured that your children will always be safe and well cared for (both during activities and at the lodge). Every minute is supervised by our guides and lodge staff, who provide hours of amusement and invaluable information to the children in their care.

Not available at &Beyond Sandibe or Nxabega Under Canvas



4

PRIVATE SAFARI

Tailored especially for you, this exclusive safari allows you to explore the Delta with your very own dedicated guides and vehicle. Game drives can be as long or as short as you wish, covering your personal interests, from the insect kingdom to great herds of buffalo or prides of lion. Meals can be savoured at the camp, or alternatively, enjoyed away from the lodge.

Not available at &Beyond Sandibe or Nxabega Under Canvas

DISCOVER THE OKAVANGO DELTA
Adventures of a Lifetime

Land and sky experiences



5

PHOTOGRAPHY

Our expert guides will use their extensive experience in wildlife behaviour to try to get you into the best position for the shot of a lifetime. At &Beyond Sandibe Okavango Safari Lodge, our customisable vehicles come with charging points for camera equipment and camera bean bags on clamps, providing excellent support for any camera and lens combination.



6

SCENIC HELICOPTER FLIGHT

Take to the skies for a bird's-eye view over the Okavango Delta's signature of blue waters against the green and brown tapestry of papyrus fringed islands and open floodplains. From these heights, even those far-flung and inaccessible corners of the Delta can be seen, fully showcasing the incredible diversity of landscapes and wildlife.

At an additional cost



7

STARGAZING

Gaze at the Southern Hemisphere's night skies in complete awe. With little to no light pollution in the area, you will be amazed by what is above. Take a closer look at the planets and constellations with your guide while out on a drive, or sit out on your private deck at night and see if you are able to spot a lucky shooting star.



8

BIRDING

Botswana is a top African birding destination, with the waters in the Okavango offering great year-round diversity. Guests flock to the area in search of several specials such as the Pel's fishing owl, African pygmy goose, lesser jacana and slaty egret, to mention just a few. Our knowledgeable guides enjoy the challenge of finding your particular favourites.

DISCOVER THE OKAVANGO DELTA
Adventures of a Lifetime

Seasonal water experiences

Within the Delta, water levels change yearly. Enjoy these seasonal experiences at Nxabega Okavango Tented Camp, Nxabega Under Canvas and Xaranna Okavango Delta Camp.



1

MOKORO ADVENTURE

Pastel-coloured lilies float upon verdant lily pads, butterflies captivate with their iridescent wings and tiny painted frogs cling to the reeds as you take to the tranquil waterways in a traditional mokoro (dugout canoe). Keep a careful look out for the variety of fish darting through the crystal-clear water below you.



2

CATCH-AND-RELEASE FISHING

The best catch-and-release fishing excursions take place from ♾️Beyond Nxabega Okavango Tented Camp and Nxabega Under Canvas due to its proximity to the Panhandle region. Here, the Okavango River feeds into the labyrinth of channels and lagoons that makes up the heart of the Delta wetland. Try your hand at catching a variety of fish, including the predatory tiger fish.



3

MOTORISED BOAT CRUISE

Explore the Okavango Delta's intricate network of winding channels and opaque lagoons on board a sleek, motorised boat that covers great distances, showcasing magnificent views of the watery landscape. The unique perspective from the boat offers great sightings of pods of hippos, wildlife attracted to the water's edge and beautiful birdlife.

Only available at ♾️Beyond Nxabega Okavango Tented Camp and Xaranna Okavango Delta Camp

DISCOVER THE OKAVANGO DELTA
Adventures of a Lifetime

Impact experiences

Everything we do at ♻️Beyond is centred around our core ethos of 'Care of the Land, Wildlife and People' and we strive to provide a truly authentic experience.



1

COMMUNITY VISIT

Enquire about this feel-good community excursion to the Sexaxa Village, outside of Maun. On the day of your departure, go see the work that ♻️Beyond and Wild Impact*, our long-standing community and conservation development partner, have completed at the Sexaxa School. It is with our guests' support that this inspiring project has flourished, and now young children no longer need to walk a total of 10km (6mi.) to get to and from school each day. Please note that this excursion depends on your departure time.



2

BEHIND-THE-SCENES SUSTAINABILITY TOUR

We would love to show you our sustainability story. From installing the first solar power plant in the Delta at ♻️Beyond Sandibe in 2014, to using a solar photovoltaic (PV) hybrid system at ♻️Beyond Xaranna, the first of its kind in Botswana, with Tesla Powerpack Battery Energy Storage System technology. Audits, heating systems, water bottling plants, wastewater management - we're committed to reducing our direct carbon footprint.



3

LOCAL CRAFTS

Browse through our Safari Shops at ♻️Beyond Sandibe Okavango Safari Lodge, Nxabega Okavango Tented Camp and Xaranna Okavango Delta Camp and expect to find a range of quality, handpicked handicrafts and fashion wear that showcases the very best of Botswana. Peruse their range of excellent eco-souvenirs; a portion of your purchase will support local community or conservation initiatives.

DISCOVER THE OKAVANGO DELTA
Adventures of a Lifetime

Seasonal
highlights

YEAR-ROUND ACTIVITIES

✓ Safari game drive	✓ Photography	✓ Wellness treatments*
✓ Walking safari	✓ Scenic helicopter flight*	✓ Wild Impact community visit
✓ Family safari	✓ Stargazing	✓ Back-of-house sustainability tour
✓ Private safari*	✓ Birding	

*This activity is at an additional cost



TIMING IS EVERYTHING

	JAN	FEB	MAR	APR	MAY	JUN	JUL	AUG	SEP	OCT	NOV	DEC
Mokoro adventure	Nxa & NUC	Nxa & NUC	Nxa & NUC	Nxa & NUC	Nxa, NUC & Xar	Nxa, NUC & Xar	Nxa, NUC & Xar	Nxa, NUC & Xar	Nxa, NUC & Xar	Nxa, NUC & Xar	X	X
Motorised boat cruise	Nxa	Nxa	Nxa	Nxa	Nxa & Xar	Nxa & Xar	Nxa & Xar	Nxa & Xar	Nxa & Xar	Nxa	Nxa	Nxa
Catch-and-release fishing	X	X	X	Nxa & NUC	Nxa & NUC	Nxa, NUC & Xar	Nxa, NUC & Xar	Nxa, NUC & Xar	Nxa, NUC & Xar	Nxa & NUC	Nxa & NUC	Nxa & NUC

- KEY
- Nxa: BEYOND Nxabega Okavango Tented Camp
 - NUC: BEYOND Nxabega Under Canvas
 - Xar: BEYOND Xaranna Okavango Delta Camp
 - X: Not available

This information is given based on data and can only be used as a reference because water levels change annually. Weather patterns are unpredictable.

It is fair to say that we have been
mind-blown by the overall experience.
We loved it all and really felt like family.

BEYOND GUEST

DISCOVER THE OKAVANGO DELTA
Adventures of a Lifetime

A day in the life

OF A GUEST

From the moment you wake up, your &Beyond experience is tailored to your interests and needs. Your butler and guide will discuss the day with you, including times and experiences, to ensure your day is as extraordinary as the location you are visiting. Here’s what to expect on a typical day in the Okavango Delta.

TIMING

EXPERIENCE

Early morning	Early wake-up call from your butler with your favourite morning beverage of choice Once you’re ready for day, your guide will collect you from your suite or tent for breakfast in the main guest area
Morning to midday	Head out for a morning game drive with a tea and coffee stop
Midday to mid-afternoon	Back at the lodge or camp, tuck into lunch in the main guest area Afterwards, take time to relax and soak in the atmosphere of the lodge or camp at your own pace
Mid-afternoon	Savour High Tea at the lodge or camp
Late afternoon to early evening	Head out on an afternoon to early evening game drive with sundowners and snacks
Evening	Sip on your preferred pre-dinner drink of choice before eating dinner in the main guest area

*Timings and guest experiences are guidelines only.
All experiences are subject to availability and weather dependent. Some experiences are at an additional cost.*



Sustainability initiatives

In partnership with Wild Impact*, our long-standing community and conservation development partner.



CARE OF Land

- 155 856 plastic water bottles eliminated per year in Botswana as a result of on-site lodge bottling plants
- 2 670 tons of concrete removed from the Okavango Delta
- Hybrid solar power plant systems in operation at our Botswana lodges have the capacity to supply up to 80% of the lodges' energy requirements.
- Our Sandibe solar power plant (installed in 2014) was the first of its kind in Botswana, and the second on the African continent
- Nxabega and Xaranna lodges utilise the cutting edge Tesla Powerpack system
- All our Botswana lodges have sophisticated, environment-friendly above-ground wastewater treatment systems
- Progressive reduction of our direct carbon footprint through a system of Group goals, measured by annual lodge audits



CARE OF Wildlife

- Long-term support of the WildCRU Trans-Kalahari Predator Programme, based out of the University of Oxford, which aims to identify and protect wildlife corridors in Botswana
- Support of the Botswana Predator Conservation Trust with their African Wild Dog Dispersal Study – a project that is fundamental to the management and conservation of this endangered species
- Rhinos Without Borders – a collaboration between &Beyond and Great Plains Conservation – has translocated 93 rhino from South Africa to Botswana, with the new source population now numbering well over the target of 100. The significant number of calves born is testimony to the success of this conservation initiative.



CARE OF People

- 94% of our staff complement are local Botswana citizens; an average of over 100 training interventions annually
- 89% of our Botswana lodge operational expenses currently support local businesses
- The phased development of the Sexaxa Primary School, 2012 – 2020, a long-term commitment by Wild Impact and &Beyond to a community-identified project
- Wild Impact's CLEF (Community Leaders Education Fund) tertiary bursary programme was introduced in 2019, with 6 bursaries granted to 5 rural students to date.
- Two new boreholes installed, providing a stable source of clean water to the isolated communities of Gogomoga and Tsutsubega
- Our COVID-19 impact and response: total of BWP 393,073 raised to support water access, food relief and masks for school children

DISCOVER THE OKAVANGO DELTA

Travel Botswana and beyond

Botswana has an excellent travel network that makes it easy to reach any destination, by air or by road.



GETTING TO THE OKAVANGO DELTA

SA Airlink offer daily scheduled flights from Johannesburg or Cape Town to Maun

Air Botswana have a flight from Johannesburg to Maun

Get around the Delta with Mack Air on a shared or private charter fixed-wing transfer flight

Helicopter transfers are also available with Helicopter Horizons

Access is via air from Maun into the Okavango Delta, followed by a road and or boat transfer to camp if not arriving in a helicopter

TRAVEL TIMES

JOHANNESBURG					
✈️	14hrs 14mins (1 397.8 km) 2hrs 10mins	CAPE TOWN			
✈️	14hrs 14mins (1 397.8 km) 2hrs 05mins	14hrs 13mins (1 478.3 km) 2hrs 10mins	WINDHOEK		
✈️	14hrs 17mins (1 197 km) 1hr 40mins	Not recommended 2hrs 50mins	14hrs 10mins (1 427.4 km) N/A	VICTORIA FALLS	
✈️	13hrs 47mins (1 189.1 km) 1hr 50mins	Not recommended No direct flight	13hrs 3mins (1 346.1 km) No direct flight	1hr 9mins (81.9 km) 20mins	KASANE
✈️	12hrs 18mins (1 123.8 km) 1hr 50mins	Not recommended 2hr 35mins	8hrs 21mins (810 km) 2hrs 25mins	8hrs 43mins (680 km) No direct flight	6hrs 25mins (607.6 km) 1hr MAUN

&BEYOND LODGES

OKAVANGO DELTA

- 1 Sandibe Okavango Safari Lodge
- 2 Sandibe Under Canvas
- 3 Nxabega Okavango Tented Camp
- 4 Nxabega Under Canvas
- 5 Xaranna Okavango Delta Camp

CHOBE NATIONAL PARK

- 6 Chobe Under Canvas



andBEYOND



@andbeyondtravel
#seewhatliesbeyond

andBeyond.com