

# MARA EXPEDITION CAMP

MAASAI MARA NATIONAL RESERVE



**“Mara Expedition Camp is positioned in a grove of typical East African acacia trees overlooking a valley in the Maasai Mara National Reserve.**

It is on private land, so very exclusive yet providing access to some of the region’s best wildlife. The camp tells the story of early day explorers with touches of campaign furniture and open-air space under light canvas. It is an ideal camp from which to start your safari looking for big cats such as cheetah and lion. Most days you don’t even have to go very far!” - Dereck Joubert, CEO.

The camp is a magical revisiting of the past, drawing from Africa’s original explorers’ designs and designed for those who search for East Africa’s romantic safari era. While most explorations take place in the Maasai Mara National Reserve, Mara Expedition Camp also enjoys access to the Mara North Conservancy for occasional drives in a more exclusive setting. Mara Expedition Camp is a stylish experience and adventure camp unique to the industry and fits the service levels, specialised guiding and design that has become associated with Great Plains Conservation.

It is safari chic with five light and airy, spacious canvas tents, plus one two-bedroom family tent. It is set down low, hidden from lights and noise from other camps or properties or any sign of mankind. Under the grove of African acacia trees, its humble main area is lit by lantern and candlelight, simple in design, but just enough for all the comforts. This camp’s ambience and ‘back-to-classic’ safari design will be a sure hit with private groups and safari enthusiasts alike.

The camp is locally famous for its leopard residents wandering nearby and is positioned to take the best advantage of two migrations – the famous annual Serengeti migration and the green season migration from Loita Plains, an additional 50,000 wildebeest and over 100,000 zebras vying for grazing rights. Mara Expedition Camp is a place for the ardent safari-goer. Full days, with picnic breakfast (and often lunch, too), traverse some of Africa’s richest wildlife country, renowned for extraordinary predator density and frequent hunts.



# MARA EXPEDITION CAMP

MAASAI MARA NATIONAL RESERVE

## CAMP FEATURES

Mara Expedition Camp can accommodate up to 12 adult guests.

### Total Number of Bedrooms:

- 5 twin or double guest tents
- 1 two-bedroomed family tent
- 1 Guide tent with a bed and bathroom

### Type of Lodge:

Explorers-Collection Safari Camp

### Lodge Season & Opening:

Year Round

### Ideal length of stay:

3 / 4 Nights

## CHECK OUT TIME

We maintain a high level of flexibility when it comes to check-out times at our camps. However, due to certain air transfer schedules, there are instances where we may kindly request guests to check out of their rooms by 9:00am. In such situations, our lodges and camps are set up to ensure that guests can utilise the facilities located in the central area. This includes access to Wi-Fi, the provision of complimentary drinks and lunch in the event of any unexpected delays, and access to hides or other activities if available.

## CAMP CO-ORDINATES

1°22'03.0"S 35°11'38.0"E



## ACCESS DIRECTIONS

### Scheduled flights:

- Daily scheduled light aircraft transfers to the ol Kiombo Airstrip;
- Flight Time from Nairobi's domestic Wilson Airport is approximately 1 hour;
- The camp is a 45-minute drive from the airstrip;
- ol Kiombo Airstrip coordinates: S1°24'31.0" E35°06'38.0";
- ol Kiombo Airstrip length: 1,200 m.

### Private Charters:

- Private charters can land at the nearby Weavers Airstrip;
- Weavers Airstrip coordinates : S01°21'48.85" E035°11'18.67";
- Weavers Airstrip length: 800 m;
- Mara Expedition Camp is a 3-minute drive from the airstrip often with wildlife viewing opportunities en route;
- It is an unmanned airstrip, and landing fee applies.

## ACTIVITIES

### Wildlife viewing

Early morning, late afternoon and early evening safari drives take place in the Maasai Mara National Reserve, with occasional drives in the more exclusive Mara North Conservancy. Mara Expedition Camp's specially designed Land Cruisers are totally open-sided (a rarity in the region), offering 300-degree views, which provide ideal photography opportunities. Each vehicle is fully stocked with reference books, drinks, and snacks.

# MARA EXPEDITION CAMP

MAASAI MARA NATIONAL RESERVE

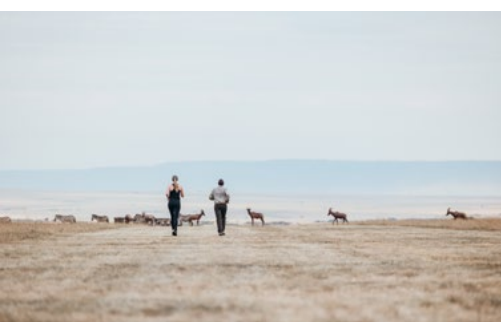

Every day is different on safari. Safari drives often start at sunrise, returning to camp for a late breakfast and departing again in the mid-afternoon after tea before returning just after sunset.

The Maasai Mara National Reserve and surrounding conservancies are ideal for some of Africa's most spectacular wildlife and birding scenes. Every safari vehicle has a pair of high-quality binoculars available for guests' complimentary use during their stay.

Our schedule is flexible, and guests are encouraged to create their own itinerary according to their interests with guidance and recommendations from our professional guides.

## Hot Air Ballooning

Hot air ballooning over the Maasai Mara is available at additional cost, and is a truly stunning way to experience the landscape and an unforgettable sunrise.

## Bicycling

Mara Expedition Camp offers guests a guided bicycle experience to exercise after their morning safari drives. The riding takes place on open plains and the landing strip. Besides just exercising, riding among plains game, gazelles, topis, impalas, and warthogs is also fun.

These bicycles are available upon request, and a safari vehicle is always on standby during the riding activity.

## Great Plains Foundation Guest Experiences

Guests at Mara Expedition Camp can engage with local communities through experiences supported by the Great Plains Foundation. Visit a Great Plains Bridge that reconnects remote communities during the rains; enjoy a school visit, meeting students and learning about Great Plains' education initiatives; or contribute to Conservation Roots by planting an indigenous tree. A visit to a local women's group completes the experience, offering guests the chance to meet Maasai women and discover the stories and skills behind their traditional beadwork.

## Photography

Each guest tent is equipped with a pair of high-quality binoculars and a professional camera set, including a camera body and lenses, for guests to use during their stay at Mara Expedition Camp. Photos will be downloaded to a memory stick upon guests' departure.

## Private vehicle option

Available for more flexibility upon request at extra cost, not compulsory for families travelling with children.

## Private Guides

Private guides are encouraged and welcomed.

# MARA EXPEDITION CAMP

MAASAI MARA NATIONAL RESERVE

## CENTRAL FACILITIES

- Central lounge and dining room;
- Coffee and tea station;
- Bar/drinks area;
- Unique swimming pool near the main area for guests to enjoy;
- Interactive kitchen;
- Outdoor fire area with seating;
- Great Plains Safari Boutique: Selling locally and regionally produced crafts, many of which support local community projects in the nearby Maasai communities. The Boutique also stocks the d&b clothing line: Dereck and Beverly Joubert have inspired this bespoke range of clothing they typically wear, and which is perfect and cool while on safari yet elegant when in the city. All materials are responsibly sourced.

Visit [dbexplorercollection.com](http://dbexplorercollection.com)

## FOOD AND BEVERAGE

- Three delicious meals a day are provided;
- We are incredibly flexible on timings. Picnic breakfasts or lunch (or both) are the norm due to very active safari drives;
- All drinks and beverages are included, including imported spirits and champagnes;
- Group meals or private dining in separate locations under the trees on decks;
- Private dining in guest's rooms on request;
- All dietary requirements are catered for - from regular to vegan to children's meals - with prior notice required.

## ACCOMMODATION DETAILS

### Bedroom features

- Uniquely designed custom tents on slightly raised platforms;
- Large bedroom with attached bathroom;
- Either twin or double bed configuration;
- Classic in style, the shaded tents are of light tan canvas with plenty of netted windows and high ceilings;
- Tea and coffee station;
- Standing fan;
- Mosquito net;
- One two-bedroom family custom-designed canvas tent on a slightly raised platform consisting of two bedrooms, each with their own separate bathroom and dressing area;

### Bathroom features

- En-suite with flush loo, double brass basins and a campaign-styled indoor shower;
- Hot water is provided;
- Soap, shampoo, conditioner and lotion provided;
- The power system does not support hairdryers, shavers or any high-wattage device. Low-voltage hairdryers are provided;
- Guests can enjoy a delightful surprise with a romantic bath set up on the private verandah of their tent, thanks to the availability of two mobile baths.

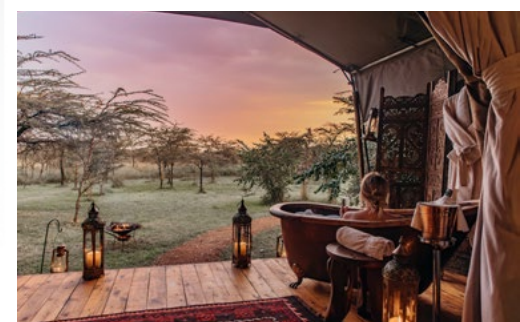

# MARA EXPEDITION CAMP

MAASAI MARA NATIONAL RESERVE

## ACCOMMODATING CHILDREN AND SHARING ACCOMMODATION

- We look forward to welcoming children aged six years and older;
- The family tent can accommodate a family of 4 guests;
- No triples possible;
- Families with children may be accommodated in the same vehicle as other guests unless a private vehicle is booked and paid for;
- Young children must be supervised as the camp is open, with high predator densities in and around camp;
- Great Plains Young Explorers Kid's programme is available – thoughtfully designed to explore various experiences and topics from birding to cooking to art to tracking wildlife.

## SPA TREATMENTS

Locally inspired wellness spa treatments are available for in-room treatments.

## FITNESS

- Yoga mats are provided in each tent;
- Exercise bikes are available on request.

## LAUNDRY

Included in nightly tariff - next-day service, weather permitting.



## POWER AND COMMUNICATION

### Power

- The camp is run by an impressive solar farm;
- This system produces 240V, 24-hour electricity to the tents and main area;
- Plug points in each tent;
- Type of plug: large British three-pin; converters available for most international plugs;
- The power system does not allow hairdryers, shavers or any high-wattage device.

### Internet & Mobile

- Mobile reception is generally reliable;
- Complimentary Wi-Fi is available in each guest tent;
- To maintain the peaceful safari atmosphere, we ask that cell phones and computers not be used in public areas or on safari vehicles. Phones may be used for photography only.

## HEALTH AND SAFETY

### Health

- Malaria: Minimal exposure risk– Malaria prophylaxis is recommended if guests are concerned; however, this is a remote area with little occurrence;
- Kenya is considered a Yellow Fever Zone. Consult your medical practitioner prior to travel;
- Guests must hold comprehensive medical insurance and emergency evacuation insurance;
- All senior staff have first aid training;
- Nearest decent medical facility is in Nairobi.

# MARA EXPEDITION CAMP

MAASAI MARA NATIONAL RESERVE



## Possibility of Disabled Access

The camp layout is not always conducive to guests who use wheelchairs (in the wet season), but many wheelchair-bound guests feel quite comfortable in this camp.

## Safety

- The camp is unfenced, allowing wildlife to move through the property, especially at night. Security guards are armed with traditional spears;
- Fire extinguishers are available in each tent.

## MONEY MATTERS

### Safes

Safes are provided in every room.

## Accepted Payment on Location

- Staff gratuities can be paid in Kenyan Shillings, US Dollars, Euro and British Pounds - preferably in cash - to the staff member concerned who has truly exceeded expectations in terms of hospitality, service, and experience;
- Credit card facilities are available in camp (except American Express), subject to 3.5% charge, for payments of additional items.

The Team

Lodge Owners

**Great Plains Conservation**

## FOUNDATION INITIATIVE

### Conservation Roots

Great Plains is on a mission to restore ecosystems, improve food security and support climate change mitigation and adaptation through tree planting. Through Conservation Roots, Great Plains is partnering with local communities to plant indigenous trees and, where appropriate, non-native, non-invasive, fruit trees in Kenya, Botswana, and Zimbabwe. Working with local communities, partner organisations and school systems, Conservation Roots plants and distributes trees and teaches their value and critical role in functioning ecosystems. Learn more at

[www.greatplainsfoundation.com/conservation-roots/](http://www.greatplainsfoundation.com/conservation-roots/)

In addition to our own programmes Great Plains Foundation keeps a list of school needs in the countries where we work. Needed items can be hand-carried by travelers or we can help purchase them locally. To learn more or to help support students and educators as part of your trip please reach out [info@greatplainsfoundation.com](mailto:info@greatplainsfoundation.com).

# GUEST TENT

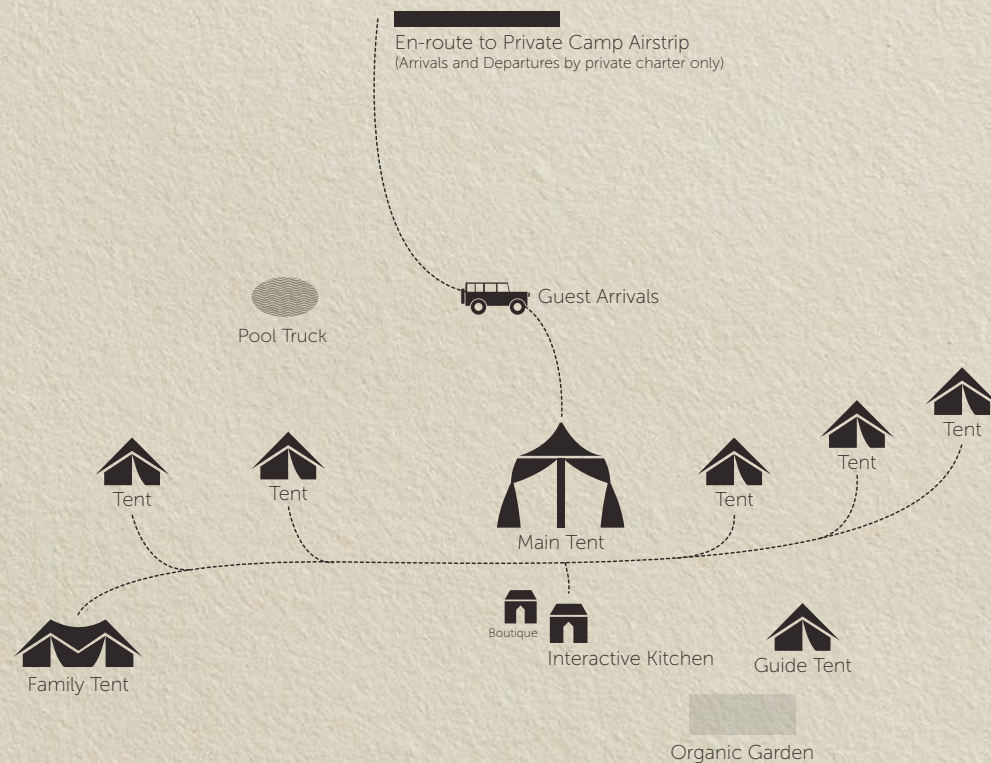
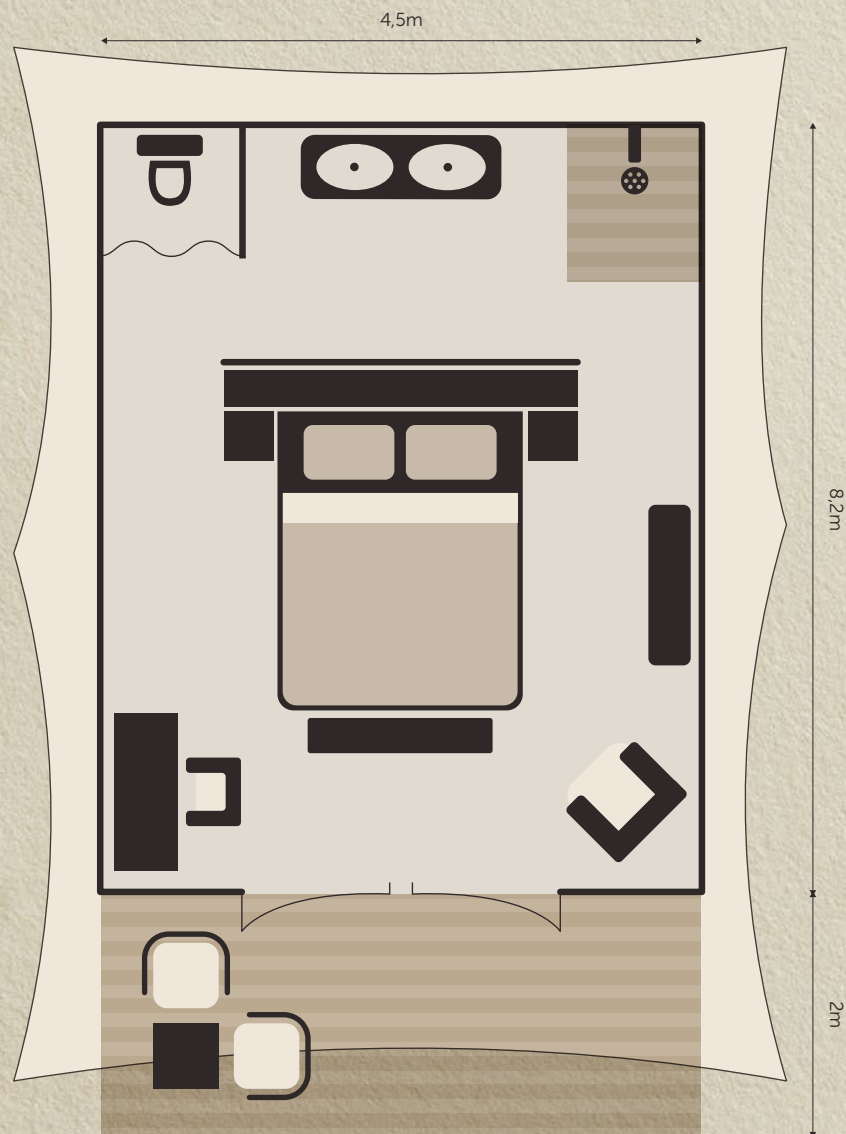

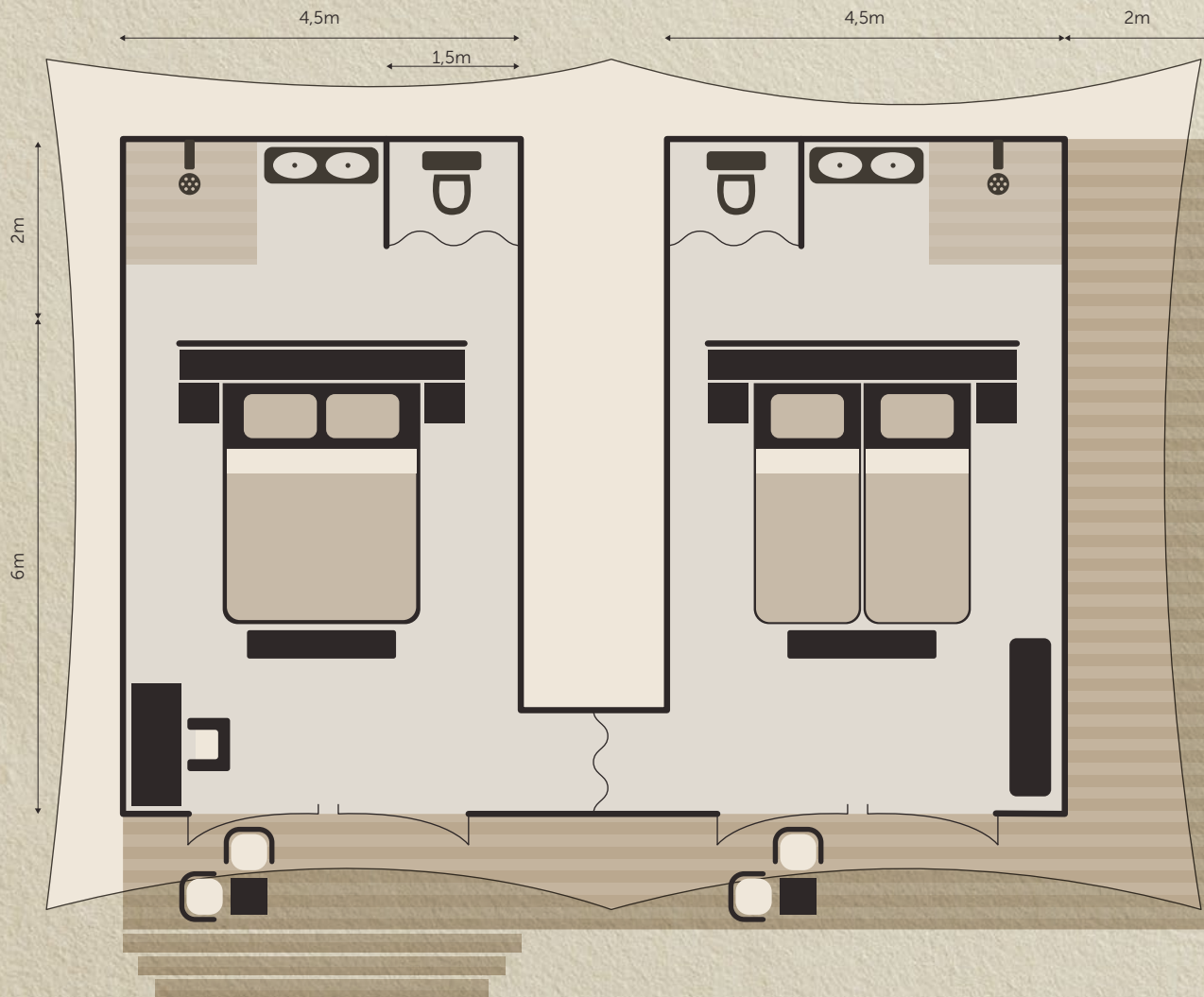

KENYA  
**GREAT PLAINS**

MARA EXPEDITION CAMP

## FAMILY TENT

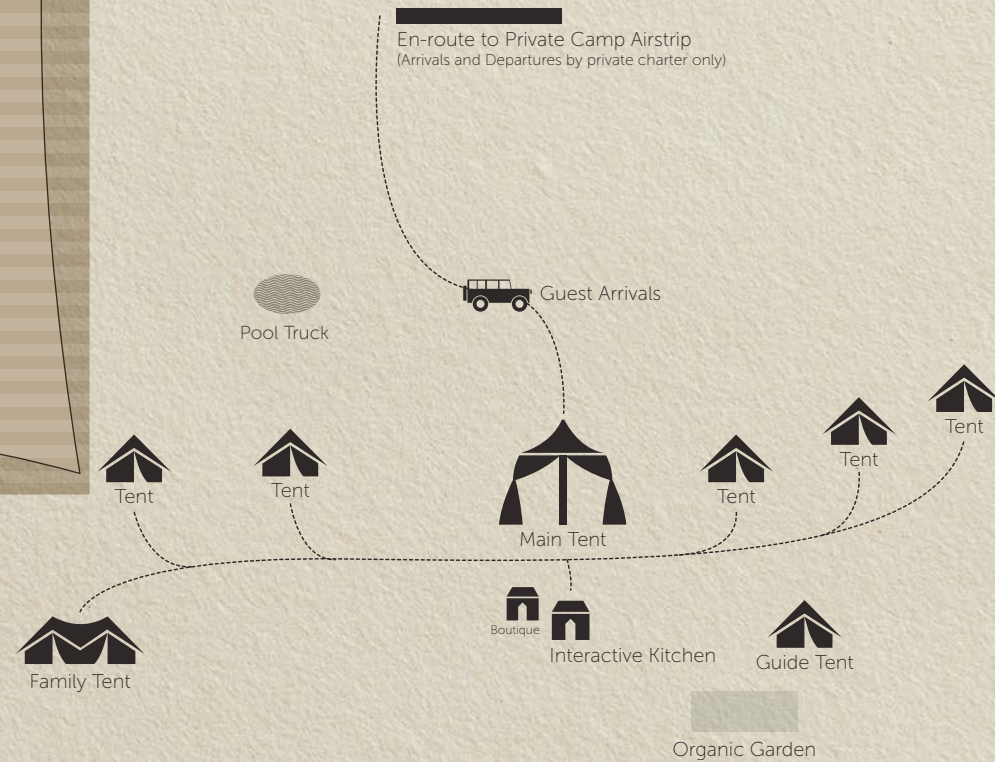

GP  
 GREAT PLAINS  
 EXPLORERS

WWW.GREATPLAINSCONSERVATION.COM / RESERVATIONS@GREATPLAINSCONSERVATION.COM

KENYA  
**GREAT PLAINS**  
 CONSERVING AND EXPANDING NATURAL HABITATS

# GREAT PLAINS

CONSERVING AND EXPANDING NATURAL HABITATS



GREAT PLAINS CONSERVATION  
STIVES TO FIND THE RIGHT FORMULA OF  
CONSERVATION, COMMUNITIES AND COMMERCE  
THAT MAKES A LASTING, SUSTAINABLE DIFFERENCE  
TO THE WORLD'S ICONIC WILDLIFE HABITATS

Mara Toto Tree Camp  
Zamara Private  
Mara Expedition Camp  
Mara Triangle  
Mara Plains Camp & The Jahazi Suite at Mara Plains  
Mara Nyika Camp & The Sambuk Suite at Mara Nyika

Maasai Mara  
Reserve

Serengeti  
National Park

Shompole

ol Donyo Lodge

Tanzania

Mount Kilimanjaro

Tsavo East National Park

Tsavo West National Park

Antelope  
National Park

Chyulu Hills  
National Park

Lake Nakuru

Lake Naivasha

Ngorongoro Crater

# GREAT PLAINS CONSERVATION

## QUICK CAMP FACTS



### KENYA CAMPS

ACTIVITY	OL DONYO LODGE	MARA PLAINS CAMP & THE JAHAZI SUITE AT MARA PLAINS	MARA NYIKA CAMP & THE SAMBUK SUITE AT MARA NYIKA
Camp Classification	Réserve-Collection	Réserve-Collection	Réserve-Collection
Location and size	Mbirikani Group Ranch	Olare Motorogi Conservancy	Naboisho Conservancy
Additional traversing area	n/a	Maasai Mara National Reserve	Maasai Mara National Reserve
Number of Suites / Tents	8 Suites	5 Suites	4 Suites
Family Accommodation	One 2-bedroom suite	The 2-bedroom Jahazi Suite at Mara Plains	The 2-bedroom Sambuk Suite at Mara Nyika. One two-bedroom family suite
Children can be accommodated from:	6 Years	6 Years	6 Years
Day Drives	Yes	Yes	Yes
Night Drives	Yes	Yes	Yes
Cultural Experience	Yes	Yes	Yes
Private Vehicle (at an additional charge)	Yes	Yes	Yes
Guided Walks (to be pre-booked)	Yes	n/a	n/a
Horseback Riding	Yes	n/a	n/a
Hot Air Ballooning (at an additional charge)	n/a	Yes	Yes
Mountain Biking	Yes	n/a	n/a
Hide	Yes	n/a	n/a
Main Swimming Pool / Private Plunge Pools	Yes (Main Pool & Private Plunge Pools)	Yes (Jahazi Suite only)	Yes (Sambuk Suite only)
Shower	Indoor & Outdoor	Indoor	Indoor
Bath	Yes	Yes	Yes
Hairdryers (low voltage)	Yes	Yes	Yes
Mosquito Nets	Yes	Yes	Yes
Fans	Standing fan	Overhead & standing fan	Overhead & standing fan
Wi-Fi – in-room (complimentary)	Yes	Yes	Yes
Safe - In-room	Yes	Yes	Yes
Spa treatments (at an additional charge)	Yes	Yes	Yes (In-room only)
Fitness	Gym & In-Room Equipment	In-room Equipment	In-room Equipment
Boutique on site	Yes	Yes	Yes

# GREAT PLAINS CONSERVATION

## QUICK CAMP FACTS



### KENYA CAMPS

ACTIVITY	MARA TOTO TREE CAMP	ZAMARA PRIVATE	MARA EXPEDITION CAMP
Camp Classification	Réserve-Collection	Réserve-Collection	Explorers Collection
Location and size	Maasai Mara National Reserve	Maasai Mara National Reserve	Maasai Mara National Reserve
Additional traversing area	Mara North Conservancy	n/a	Mara North Conservancy
Number of Suites / Tents	4 Suites	6 Suites	5 Tents
Family Accommodation	n/a	Triple suites	One 2-bedroom family tent
Children can be accommodated from:	6 Years	6 Years	6 Years
Day Drives	Yes	Yes	Yes
Night Drives	Yes (water level dependent)	n/a	Yes (water level dependent)
Cultural Experience	Yes	Yes	Yes
Private Vehicle (at an additional charge)	Yes	n/a	Yes
Guided Walks (to be pre-booked)	n/a	n/a	n/a
Horseback Riding	n/a	n/a	n/a
Hot Air Ballooning (at an additional charge)	Yes	Yes	Yes
Bicycling	n/a	n/a	Yes
Hide	n/a	n/a	n/a
Main Swimming Pool / Private Plunge Pools	n/a	Main swimming pool and Private Plunge Pools at master suites	Main swimming pool
Shower	Indoor	Indoor & Outdoor	Indoor
Bath	Yes	Yes	n/a
Hairdryers (low voltage)	Yes	Yes	Yes
Mosquito Nets	Yes	Yes	Yes
Fans	Overhead & standing fan	Overhead	Standing fan
Wi-Fi – in-room (complimentary)	Yes	Yes	Yes
Safe - In-room	Yes	Yes	Yes
Spa treatments (at an additional charge)	Yes (In-room only)	Yes	Yes (In-room only)
Fitness	In-room equipment	Gym and in-room yoga mats	In-room equipment
Boutique on site	Yes	Yes	Yes