



# A SERENE SANCTUARY

## IN SEYCHELLES

Immerse yourself in the **epitome of luxury** at **Waldorf Astoria Seychelles Platte Island**, where spacious accommodation, unique experiences and unparalleled service harmoniously blend with the **islands lush tropical surroundings**. From curated experiences and fine dining to iconic Waldorf Astoria Spa and vibrant wildlife, Platte Island **promises an unforgettable escape for all**.

From our **thoughtful villa architecture** to the use of locally sourced, seasonal ingredients in our restaurants, every detail reflects our **commitment to sustainable luxury** and a respect for the island's natural ecosystem.

50 private pool villas | 6 food and drink venues  
| Villas with direct access to the beach and featuring expansive gardens | From one to five bedroom villas for multi-generational experiences | World-class spa and wellness facilities | A wide range of watersports and activities | Kids facilities | Personal concierge

### RESTAURANTS AND BARS

Explore our collection of **six restaurants and bars**. At Moulin, embark on an exclusive soil-to-soul journey where, seasonal, freshly harvested ingredients are transformed into a **refined culinary experience**. Immerse yourself in the vibrant flavors and traditions of Creole and Latino cuisine at Maison des Epices. For a more **relaxed ambiance**, enjoy Northern Mediterranean classics with an Asian twist at La Perle.

**Unwind by the pool** at Torti, offering Asian-inspired dishes, or opt for a more **private experience** with one of our in-villa dining menus.

### SPA AND WELLNESS

Inspired by the natural **beauty of Platte Island**, our spa and salon offer personalized wellness experiences, crafted with eco-conscious practices. Explore a range of **traditional and modern treatments**, indoor and outdoor facilities, and tailored wellness programs that provide deeper insights into your well-being, along with customized recommendations for your **future wellness journey**.

### EXPERIENCES

Welcome to a world of **indulgence and adventure** where opulence meets exploration.

Fishing | Snorkeling | Ocean cruises | Food and drink masterclasses | Private dining | Outdoor cinema | Tennis and padel | Wildlife walks





# HAWKSBILL GARDEN POOL VILLA

ONE BEDROOM VILLA



SLEEPS TWO + ONE EXTRA BED



461 SQ M  
141 SQ M VILLA AND 320 SQ M GARDEN

This beautifully designed villa features a **spacious bedroom with a king-sized bed**, separate living room and luxurious bathroom for ultimate comfort. Step outside to your **private deck**, complete with an outdoor dining area and a **private pool**.

The villa also boasts a **lush private garden** and an **invigorating outdoor shower** for a true natural escape.

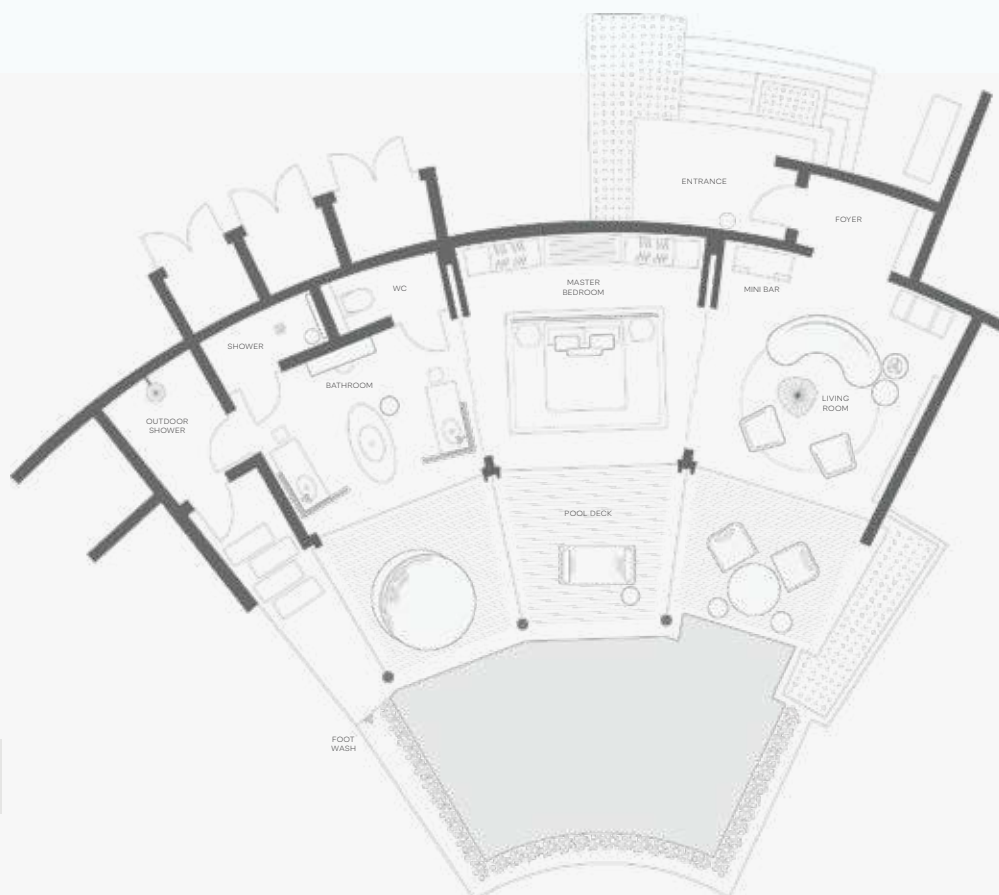

DISCOVER THIS  
VILLA IN 3D





# HAWKSBILL POOL VILLA

ONE BEDROOM VILLA



SLEEPS TWO + ONE EXTRA BED



461 SQ M  
141 SQ M VILLA AND 320 SQ M GARDEN

Relax in this thoughtfully designed villa, which features **one bedroom** with a **king-sized bed**, separate living room and **luxurious bathroom**.

Enjoy outdoor living, as the villa opens onto a **spacious deck** with its own **private pool** and outdoor dining space. Revel in **direct beachfront access** and invigorate your senses with an outdoor shower.

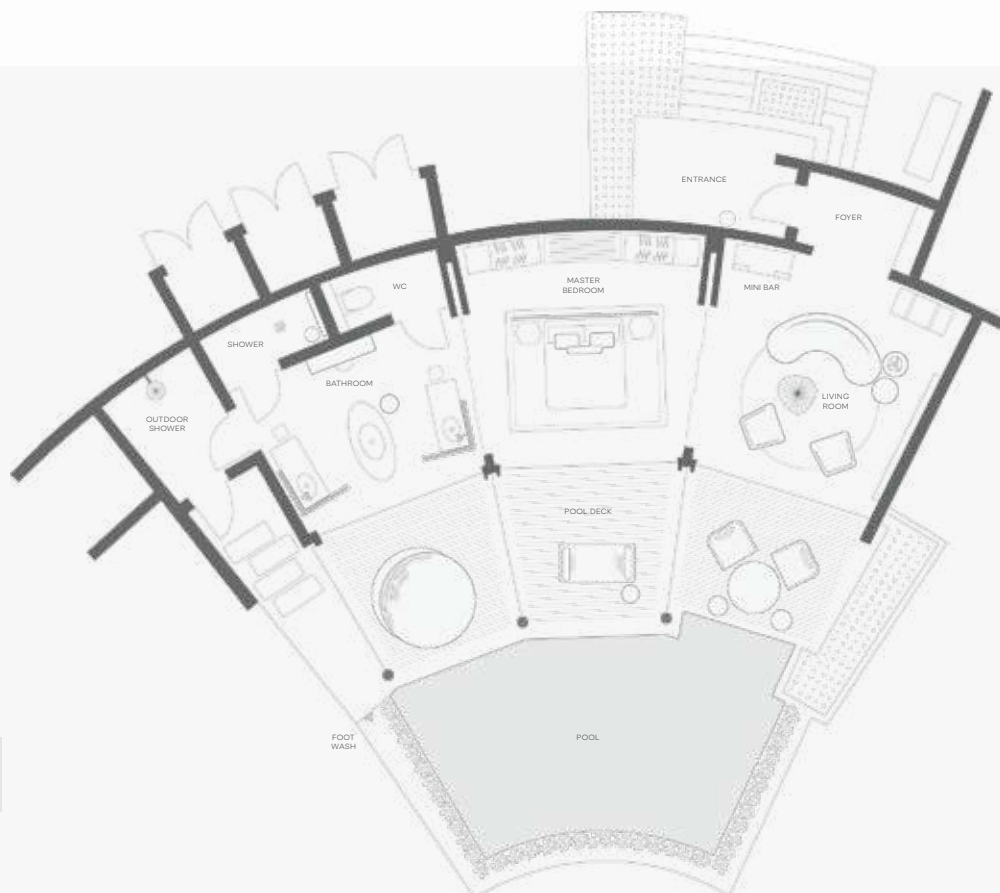

DISCOVER THIS  
VILLA IN 3D





# GRAND HAWKSBILL POOL VILLA

ONE BEDROOM VILLA  
WITH A STUDY ROOM



SLEEPS FOUR



644 SQ M  
194 SQ M VILLA AND 450 SQ M GARDEN

Drawing on our heritage of **timeless elegance** with a modern sensibility our villas are designed to be a **sanctuary of elegance** and comfort.

Featuring a bedroom with one **king-sized bed**, elegant master bathroom and separate living room, the Grand Hawksbill Villa also offers the flexibility of an extra bedroom or study space with en-suite shower room. It also includes, **outdoor deck with dining space**, outdoor shower, private pool and garden with **direct beach access**. A dedicated nanny room with en-suite shower is also available.

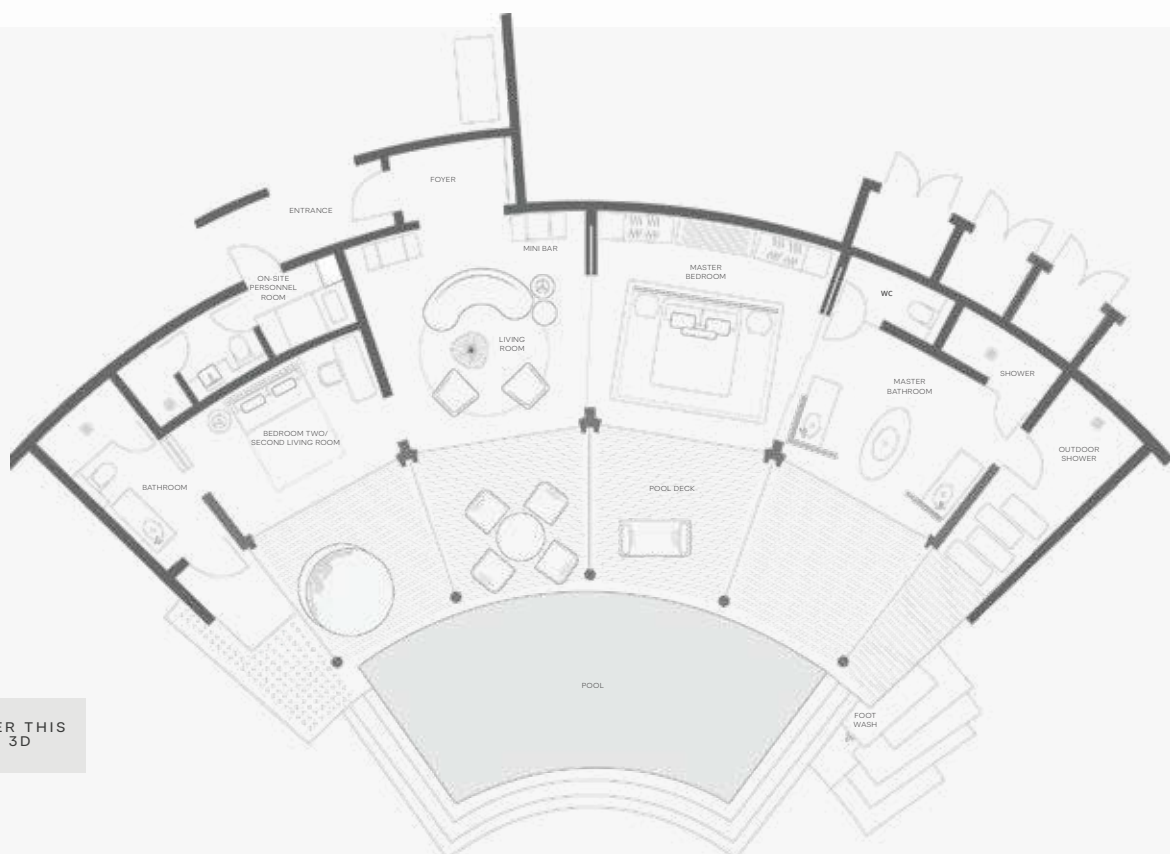

DISCOVER THIS  
VILLA IN 3D





# BLACKTIP POOL VILLA

TWO BEDROOM VILLA



SLEEPS FOUR



1393 SQ M

393 SQ M VILLA AND 1000 SQ M GARDEN

Enjoy the charm of this **spacious villa**, which features **two bedrooms**, one with a **king-sized bed** and the other with **two queen beds**. Each bedroom boasts a spacious bathroom with a bathtub and walk-in shower. This villa also benefits from a **generous outdoor terrace** with its own private pool and outdoor dining space.

Enjoy **direct access to the beach** and outdoor shower to help you cool off. The indoor space features a separate living room. A dedicated nanny room with en-suite shower is also available, as well as a service kitchen.

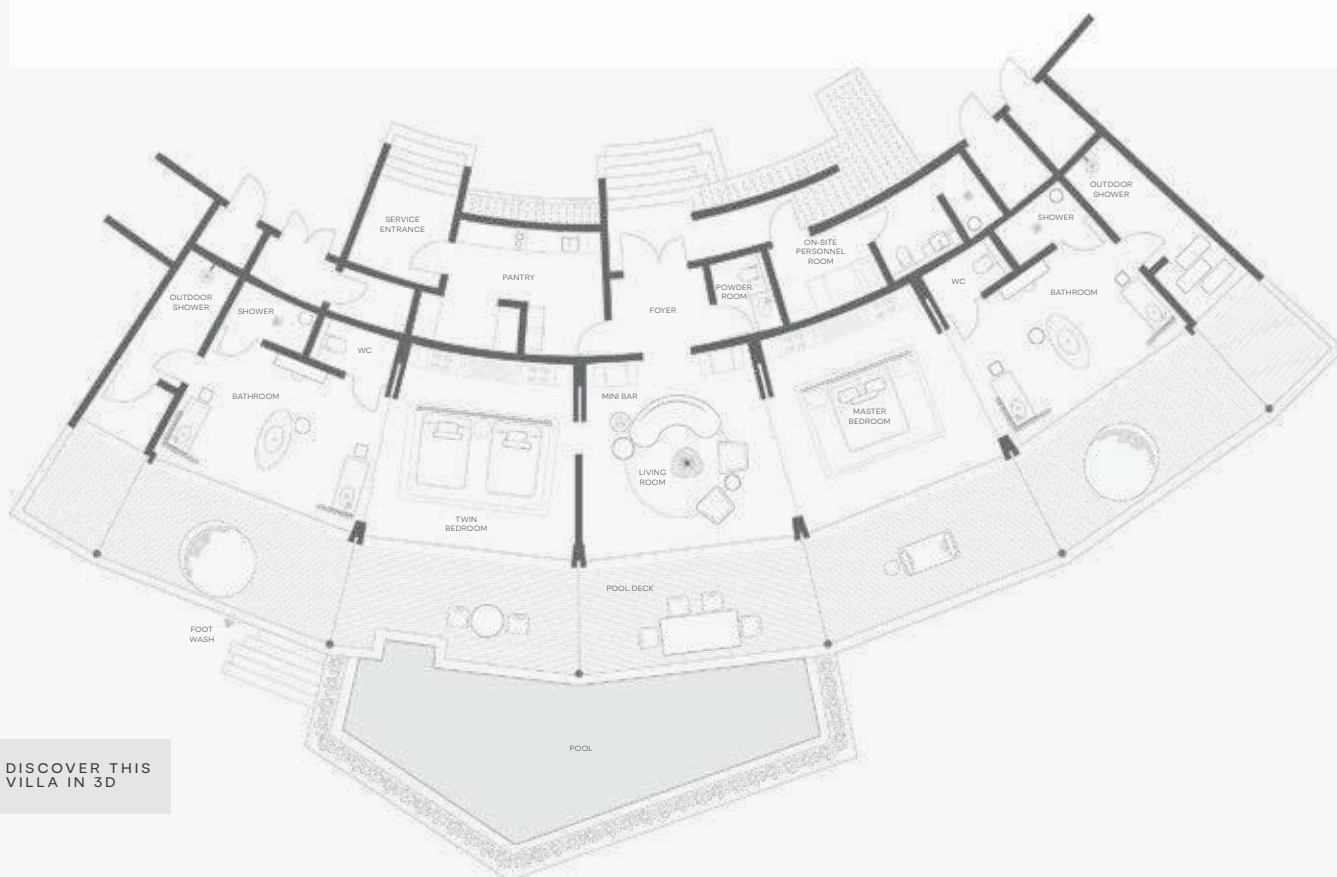

DISCOVER THIS  
VILLA IN 3D





# KINGFISH POOL VILLA

THREE BEDROOM VILLA



SLEEPS SIX



1702 SQ M

472 SQ M VILLA AND 1230 SQ M GARDEN

This **spacious villa** offers flexible options for a family stay. Enjoy either **three king bedrooms** or **two king bedrooms** and one queen twin room. Each bedroom with its own bathroom. The indoor space also benefits from a separate living room, powder room for guests and dedicated nanny room with en-suite shower and a separate entrance, as well as a service kitchen.

Enjoy a **spacious outdoor terrace** with outdoor dining space, private pool and tropical garden with **direct beach access**.

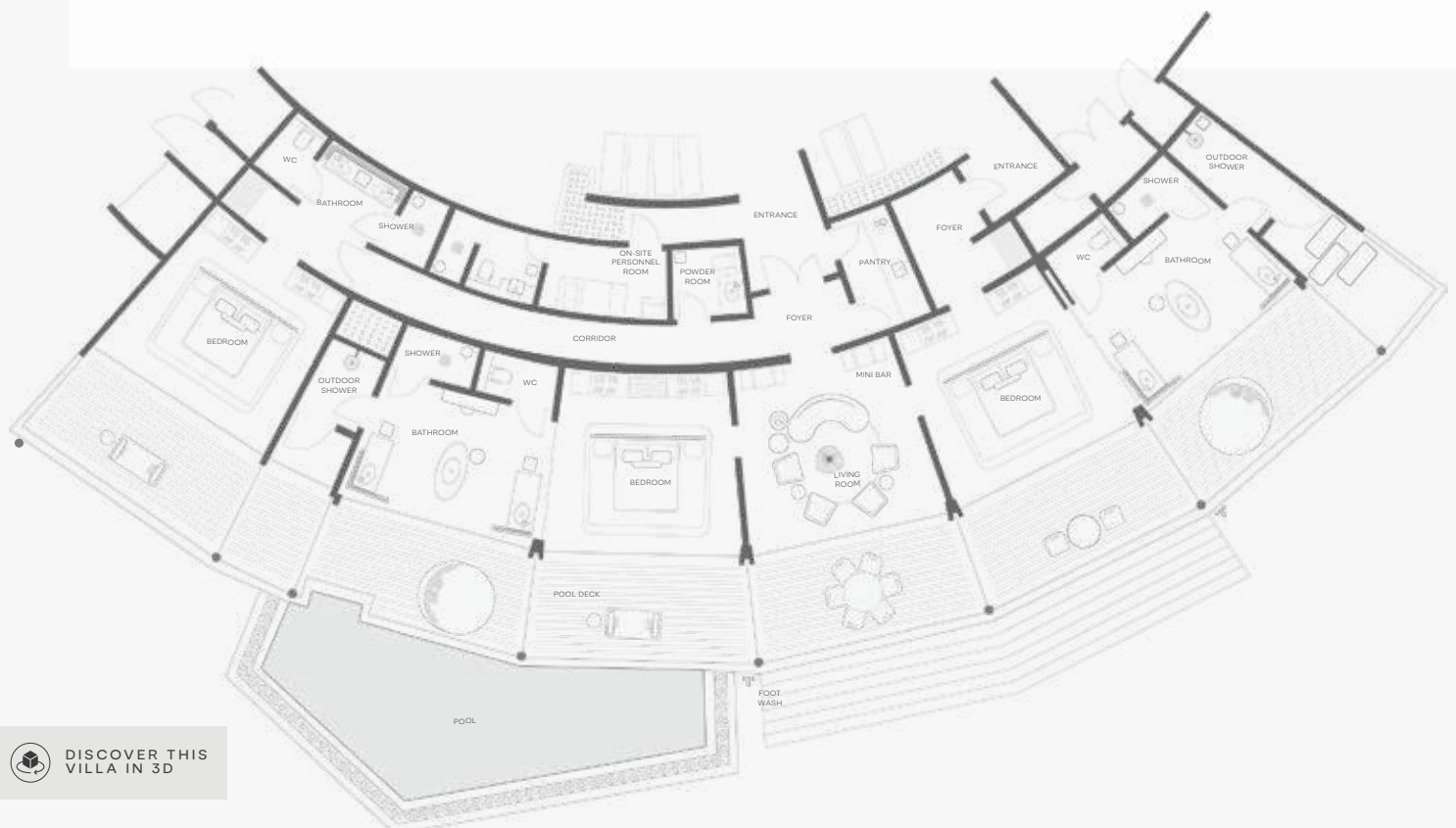

DISCOVER THIS  
VILLA IN 3D





# EAGLE RAY POOL VILLA

FIVE BEDROOM VILLA



SLEEPS TEN



2151 SQ M

751 SQ M VILLA AND 1400 SQ M GARDEN

Enjoy the flexibility of this elegant suite, which is ideally situated in a secluded enclave. With **5 separate bedrooms**, each with one **king-sized bed and en-suite bathroom**.

Relax in the **separate living room**, complete with its own state-of-the-art entertainment system and a powder room for guests. The master suite also features its **own private pool**. The villa further benefits from a dedicated nanny room with an en-suite shower and separate entrance, as well as a service kitchen. An exclusive suite, this villa provides **both space and privacy for the entire family**.

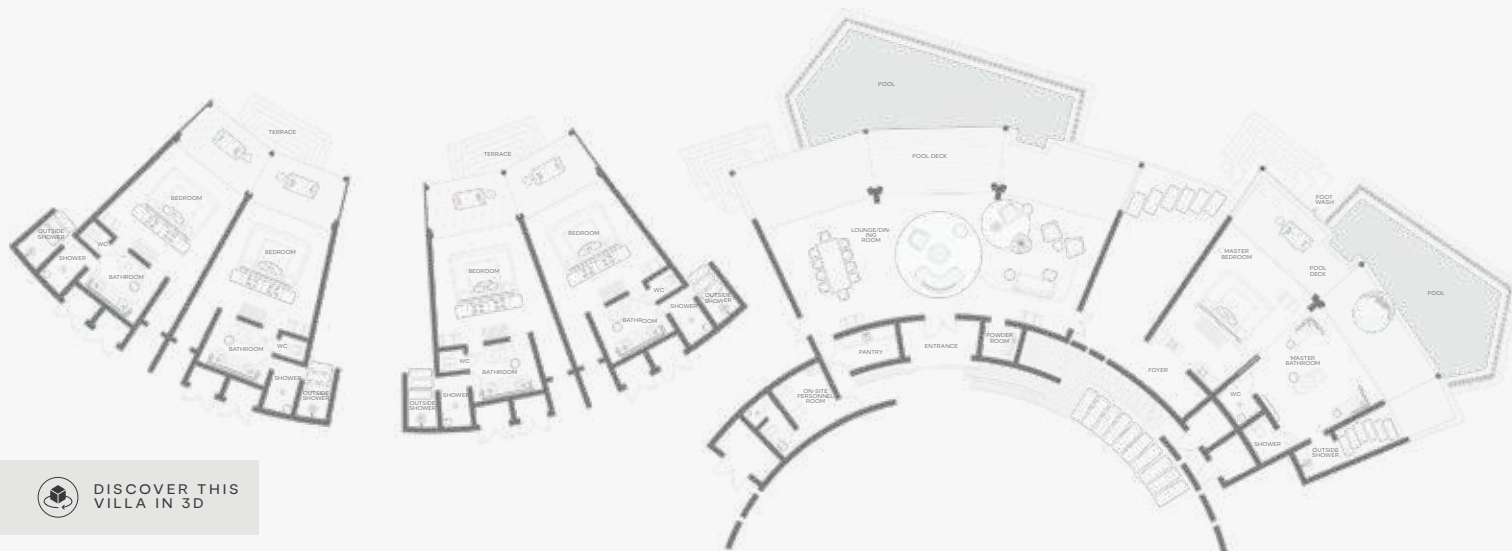

DISCOVER THIS  
VILLA IN 3D



WALDORF ASTORIA®  
SEYCHELLES PLATTE ISLAND

**Contact us to craft an extraordinary  
experience in paradise, tailored just for you.**

+248 439 7141 | [SEZPI.HOTEL@WALDORFASTORIA.COM](mailto:SEZPI.HOTEL@WALDORFASTORIA.COM)

**STAY CONNECTED TO PARADISE – FOLLOW ALONG**

[@WALDORFASTORIAPLATTEISLAND](https://www.instagram.com/WALDORFASTORIAPLATTEISLAND)