



A SERENE SANCTUARY

IN SEYCHELLES

Immerse yourself in the **epitome of luxury** at **Waldorf Astoria Seychelles Platte Island**, where spacious accommodation, unique experiences and unparalleled service harmoniously blend with the **islands lush tropical surroundings**. From curated experiences and fine dining to iconic Waldorf Astoria Spa and vibrant wildlife, Platte Island **promises an unforgettable escape for all**.

From our **thoughtful villa architecture** to the use of locally sourced, seasonal ingredients in our restaurants, every detail reflects our **commitment to sustainable luxury** and a respect for the island's natural ecosystem.

50 private pool villas | 6 food and drink venues
| Villas with direct access to the beach and featuring expansive gardens | From one to five bedroom villas for multi-generational experiences | World-class spa and wellness facilities | A wide range of watersports and activities | Kids facilities | Personal concierge

RESTAURANTS AND BARS

Explore our collection of **six restaurants and bars**. At Moulin, embark on an exclusive soil-to-soul journey where, seasonal, freshly harvested ingredients are transformed into a **refined culinary experience**. Immerse yourself in the vibrant flavors and traditions of Creole and Latino cuisine at Maison des Epices. For a more **relaxed ambiance**, enjoy Northern Mediterranean classics with an Asian twist at La Perle.

Unwind by the pool at Torti, offering Asian-inspired dishes, or opt for a more **private experience** with one of our in-villa dining menus.

SPA AND WELLNESS

Inspired by the natural **beauty of Platte Island**, our spa and salon offer personalized wellness experiences, crafted with eco-conscious practices. Explore a range of **traditional and modern treatments**, indoor and outdoor facilities, and tailored wellness programs that provide deeper insights into your well-being, along with customized recommendations for your **future wellness journey**.

EXPERIENCES

Welcome to a world of **indulgence and adventure** where opulence meets exploration.

Fishing | Snorkeling | Ocean cruises | Food and drink masterclasses | Private dining | Outdoor cinema | Tennis and padel | Wildlife walks



HAWKSBILL GARDEN POOL VILLA

ONE BEDROOM VILLA



SLEEPS TWO + ONE EXTRA BED



461 SQ M
141 SQ M VILLA AND 320 SQ M GARDEN

This beautifully designed villa features a **spacious bedroom with a king-sized bed**, separate living room and luxurious bathroom for ultimate comfort. Step outside to your **private deck**, complete with an outdoor dining area and a **private pool**.

The villa also boasts a **lush private garden** and an **invigorating outdoor shower** for a true natural escape.

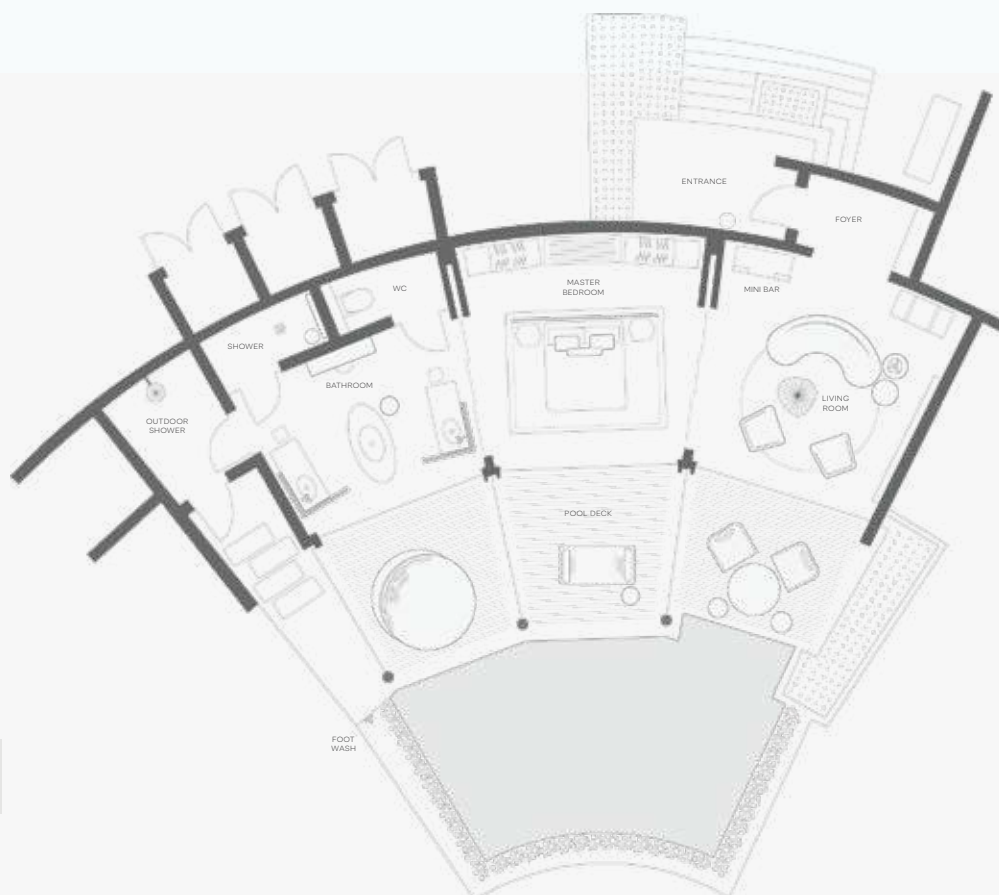

DISCOVER THIS
VILLA IN 3D



HAWKSBILL POOL VILLA

ONE BEDROOM VILLA



SLEEPS TWO + ONE EXTRA BED



461 SQ M
141 SQ M VILLA AND 320 SQ M GARDEN

Relax in this thoughtfully designed villa, which features **one bedroom** with a **king-sized bed**, separate living room and **luxurious bathroom**.

Enjoy outdoor living, as the villa opens onto a **spacious deck** with its own **private pool** and outdoor dining space. Revel in **direct beachfront access** and invigorate your senses with an outdoor shower.

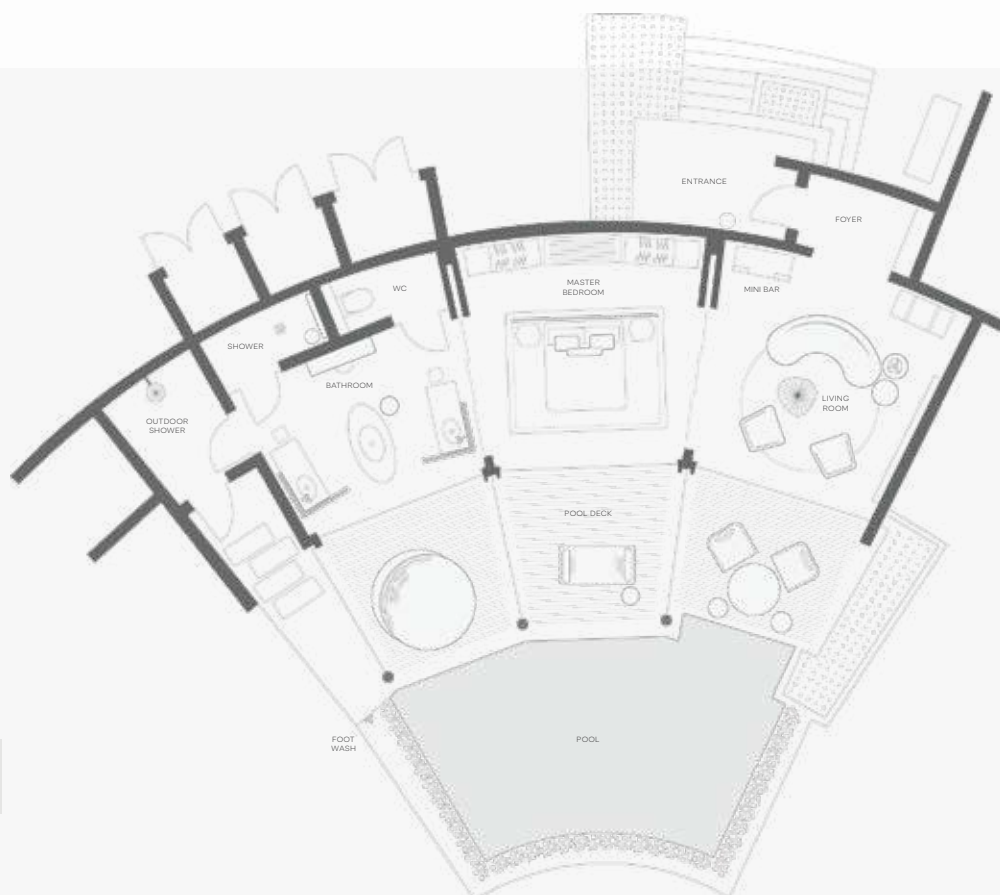

DISCOVER THIS
VILLA IN 3D



GRAND HAWKSBILL POOL VILLA

ONE BEDROOM VILLA
WITH A STUDY ROOM



SLEEPS FOUR



644 SQ M
194 SQ M VILLA AND 450 SQ M GARDEN

Drawing on our heritage of **timeless elegance** with a modern sensibility our villas are designed to be a **sanctuary of elegance** and comfort.

Featuring a bedroom with one **king-sized bed**, elegant master bathroom and separate living room, the Grand Hawksbill Villa also offers the flexibility of an extra bedroom or study space with en-suite shower room. It also includes, **outdoor deck with dining space**, outdoor shower, private pool and garden with **direct beach access**. A dedicated nanny room with en-suite shower is also available.

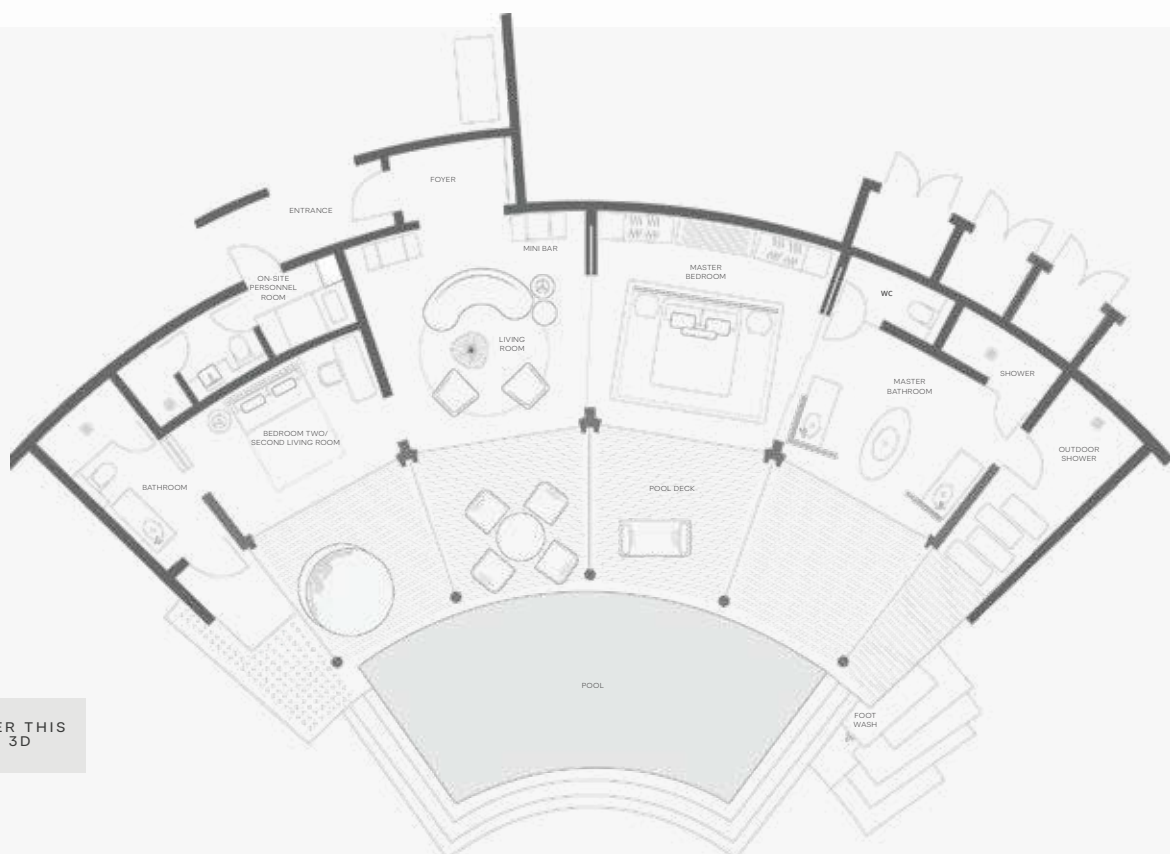

DISCOVER THIS
VILLA IN 3D



BLACKTIP POOL VILLA

TWO BEDROOM VILLA



SLEEPS FOUR



1393 SQ M

393 SQ M VILLA AND 1000 SQ M GARDEN

Enjoy the charm of this **spacious villa**, which features **two bedrooms**, one with a **king-sized bed** and the other with **two queen beds**. Each bedroom boasts a spacious bathroom with a bathtub and walk-in shower. This villa also benefits from a **generous outdoor terrace** with its own private pool and outdoor dining space.

Enjoy **direct access to the beach** and outdoor shower to help you cool off. The indoor space features a separate living room. A dedicated nanny room with en-suite shower is also available, as well as a service kitchen.

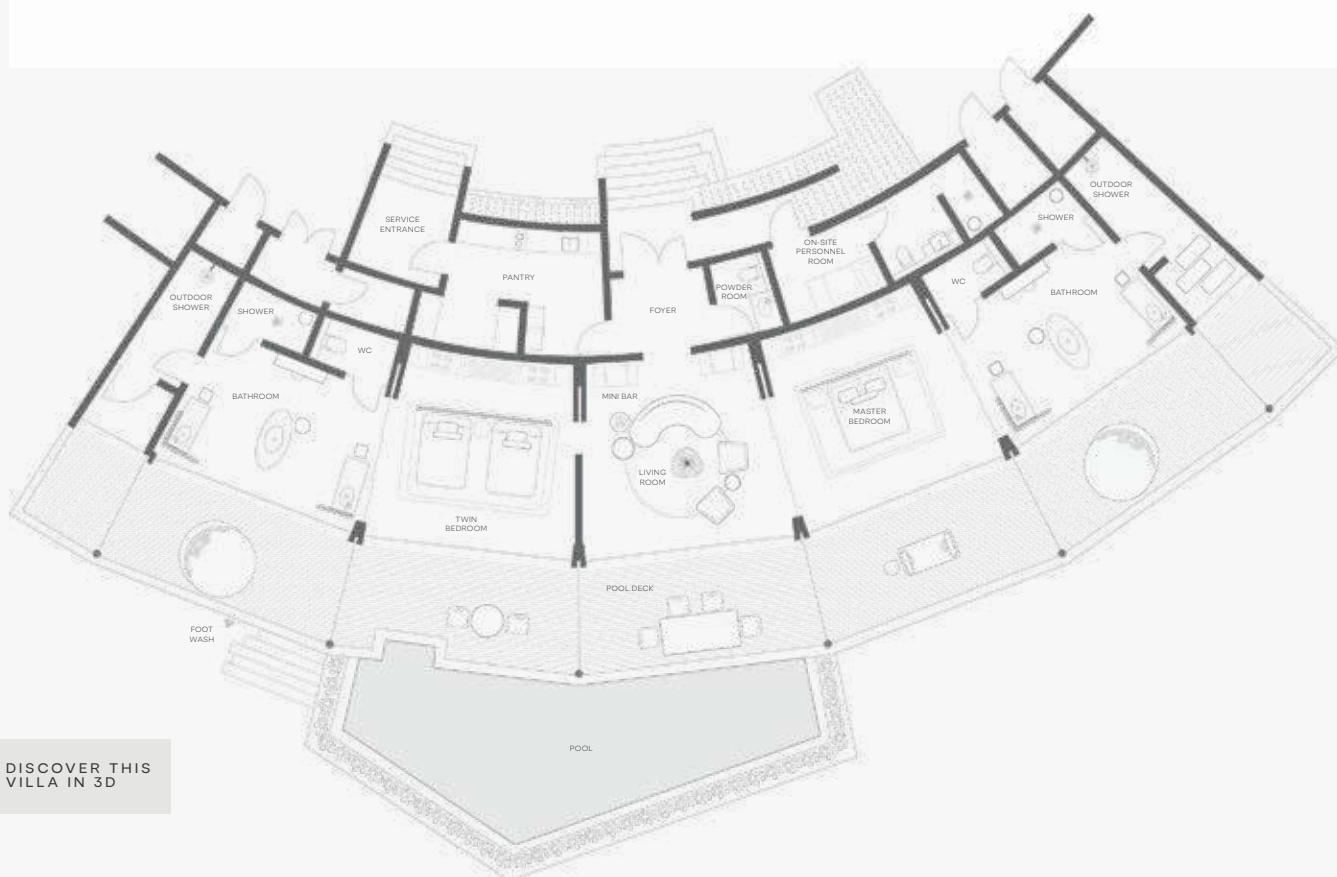

DISCOVER THIS
VILLA IN 3D



KINGFISH POOL VILLA

THREE BEDROOM VILLA



SLEEPS SIX



1702 SQ M

472 SQ M VILLA AND 1230 SQ M GARDEN

This **spacious villa** offers flexible options for a family stay. Enjoy either **three king bedrooms** or **two king bedrooms** and one queen twin room. Each bedroom with its own bathroom. The indoor space also benefits from a separate living room, powder room for guests and dedicated nanny room with en-suite shower and a separate entrance, as well as a service kitchen.

Enjoy a **spacious outdoor terrace** with outdoor dining space, private pool and tropical garden with **direct beach access**.

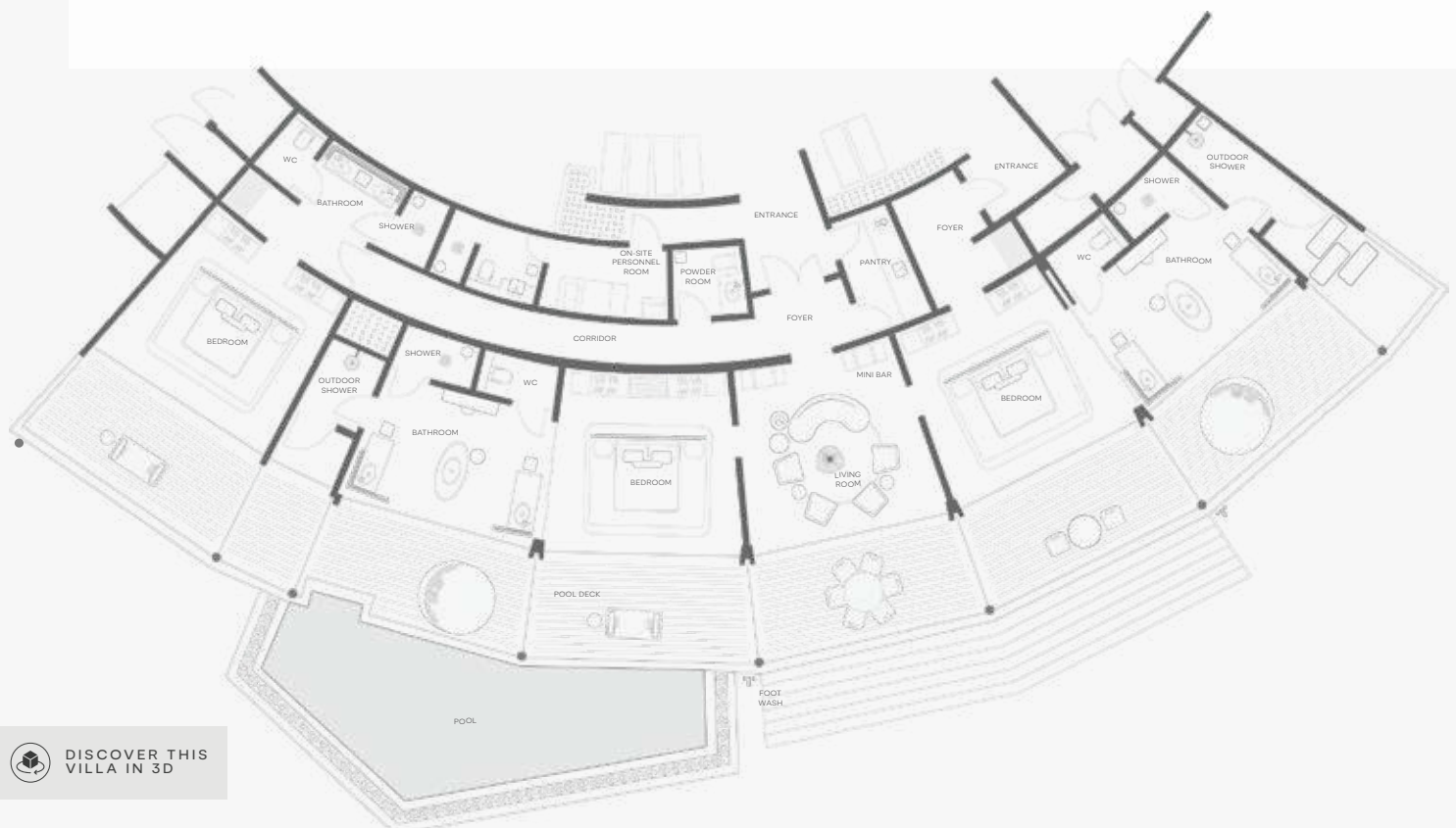

DISCOVER THIS
VILLA IN 3D



EAGLE RAY POOL VILLA

FIVE BEDROOM VILLA



SLEEPS TEN



2151 SQ M

751 SQ M VILLA AND 1400 SQ M GARDEN

Enjoy the flexibility of this elegant suite, which is ideally situated in a secluded enclave. With **5 separate bedrooms**, each with one **king-sized bed and en-suite bathroom**.

Relax in the **separate living room**, complete with its own state-of-the-art entertainment system and a powder room for guests. The master suite also features its **own private pool**. The villa further benefits from a dedicated nanny room with an en-suite shower and separate entrance, as well as a service kitchen. An exclusive suite, this villa provides **both space and privacy for the entire family**.

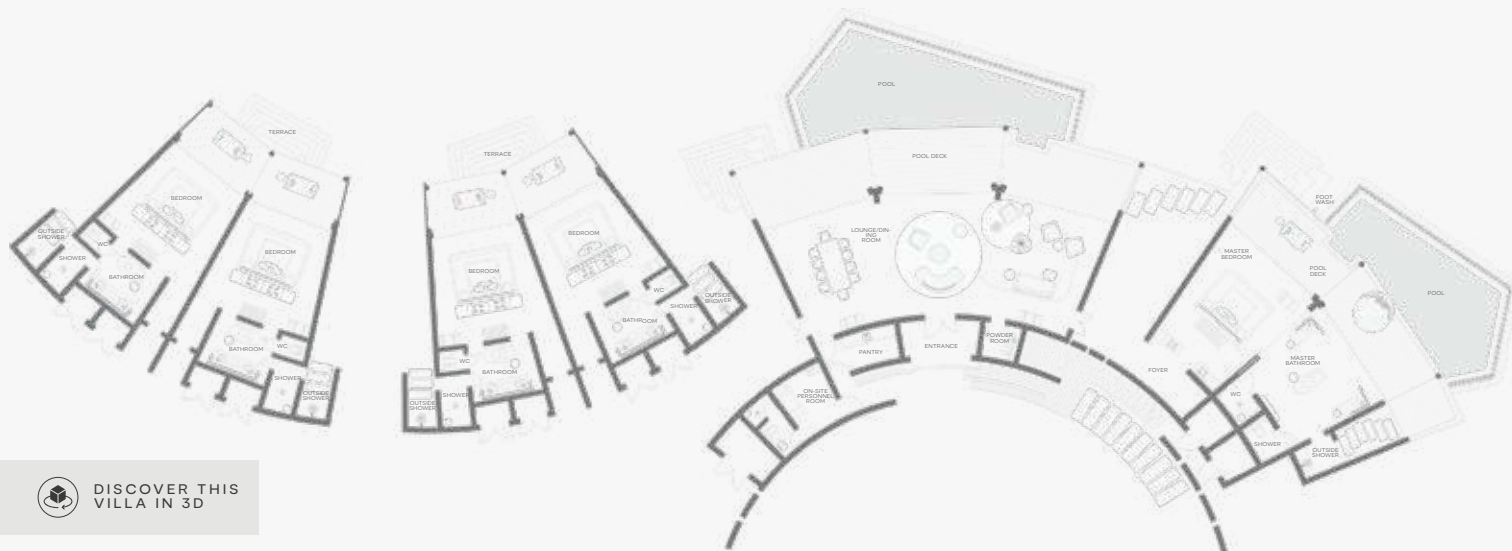

DISCOVER THIS
VILLA IN 3D



MOULIN

SOIL-TO-SOUL

Moulin offers a **soil-to-soul dining experience**, rooted in the philosophy of transforming nature's bounty into a **journey of sustainability** and flavor that also nourishes wellbeing.

The experience begins with seasonal, **locally sourced ingredients**—many freshly harvested from the restaurant's own garden—and crafted into **exclusive menus** that celebrate both the environment and culinary excellence. Each dish is paired with fine wines or teas, **carefully chosen to enhance the natural flavors**. Exclusive to Moulin, also renowned for its award-winning architecture and captivating atmosphere, the Soil to Soul concept creates a holistic, immersive dining experience that **engages all the senses**.





MAISON DES EPICES

CREOLE-LATIN
FUSION

Maison des Epices is a restaurant that **blends Creole and Latino cultures**, celebrating their rich traditions, flavors, and heritage. With an emphasis on authenticity, the restaurant features **open-fire cooking** using sustainable wood, creating a unique and flavorful dining experience.

Handmade spices elevate each dish, while the extensive, curated, liquor collection, unique to Creole and Latino traditions, complements the flavors. The **vibrant atmosphere** is enhanced by music, adding to the ambiance and offering guests a **true taste of cultural fusion**.





LA PERLE

MEDITERRANEAN
BRASSERIE

La Perle is a **vibrant restaurant** inspired by **Northern Mediterranean and Asian cuisines**. By day, it offers a personalized, wholesome breakfast featuring freshly baked artisanal items, a variety of hot and cold dishes, and expertly brewed Tanzanian coffee. At lunch, the restaurant creates a **relaxed atmosphere** with Northern Mediterranean classics, subtly enhanced by Asian influences.

As evening falls, La Perle **celebrates the ocean's bounty** with locally sourced seafood and the freshest daily catch, expertly paired with the rich flavors of the Northern Mediterranean and **inventive global twists**, offering a laid-back dining experience.

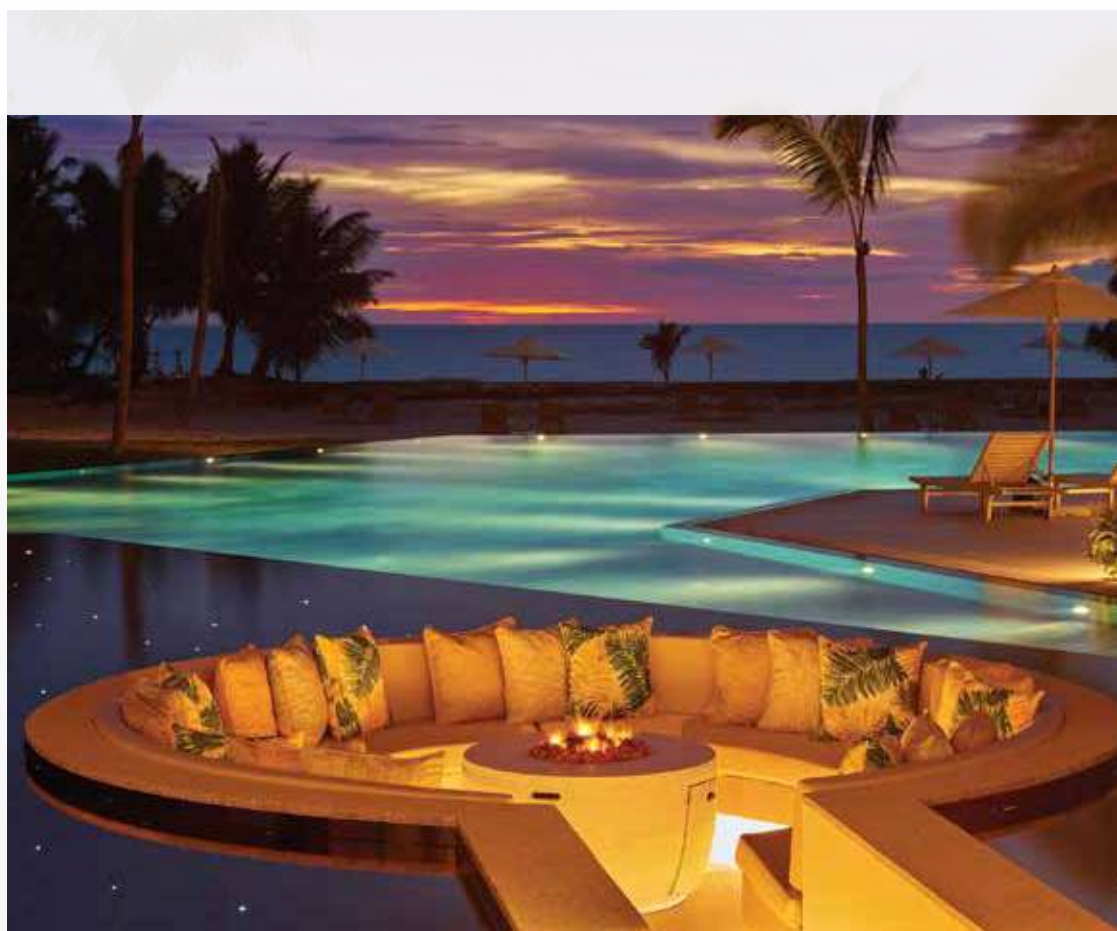



LALIN

CHAMPAGNE BAR

Lalin, named after the **Creole term for the moon**, is a champagne bar with breathtaking views of the ocean. Savor **delightful sunsets** while enjoying your favorite drinks.

Evening stars set the stage for **elegant pre-dinner indulgence** and refined nocturnal sips at Lalin. The vibrant venue showcases an array of inventive **cocktails crafted with artistic flair**.



Torti is a sumptuous retreat where guests can **unwind and rejuvenate** amidst flavorful cuisine and impeccable service. Enjoy attentive hospitality in this tranquil poolside setting.

The bar draws guests into a **vibrant atmosphere** that perfectly harmonizes with the relaxing cabanas and sunbeds arranged in the pool.

TORTI

BEACH BAR



PEACOCK TERRACE

PARISIAN INSPIRED

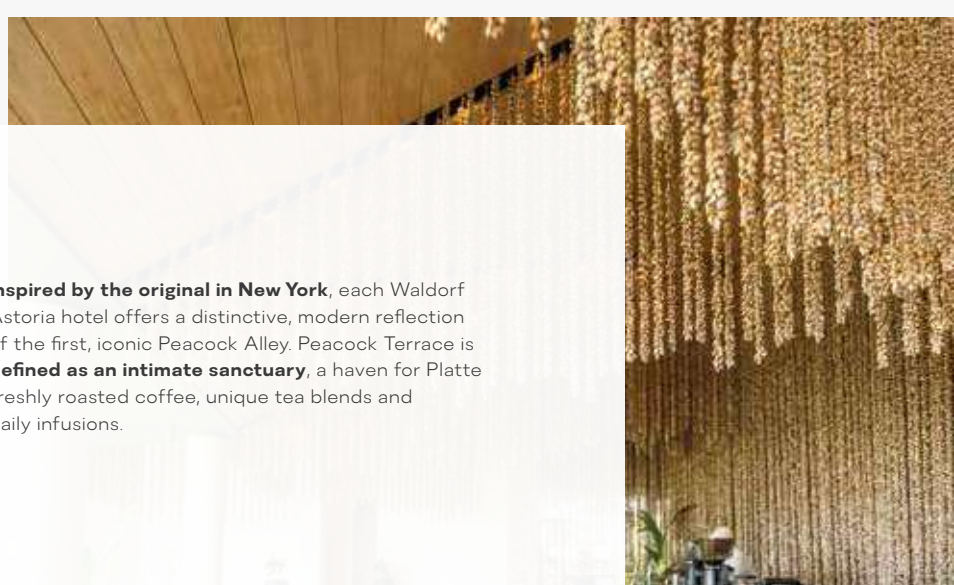

Inspired by the original in New York, each Waldorf Astoria hotel offers a distinctive, modern reflection of the first, iconic Peacock Alley. Peacock Terrace is **defined as an intimate sanctuary**, a haven for Platte freshly roasted coffee, unique tea blends and daily infusions.





WALDORF ASTORIA®
SEYCHELLES PLATTE ISLAND

**Contact us to craft an extraordinary
experience in paradise, tailored just for you.**

+248 439 7141 | SEZPI.HOTEL@WALDORFASTORIA.COM

STAY CONNECTED TO PARADISE – FOLLOW ALONG

[@WALDORFASTORIAPLATTEISLAND](https://www.instagram.com/WALDORFASTORIAPLATTEISLAND)