

# SELINDA EXPLORERS CAMP

SELINDA RESERVE | NORTHERN BOTSWANA

GREAT PLAINS

CONSERVING AND EXPANDING NATURAL HABITATS

ESTABLISHED 2010

**Selinda Explorers Camp is located in the private Selinda Reserve of northern Botswana. It is built on the banks of the Selinda Spillway, about one hour west of its sister camp, Selinda Camp.**

This Explorer-Collection safari camp transports guests back to the time of bygone safaris but with a modern twist and hospitality. The camp's focal point is the Bedouin-style main area, offering a lounge and separate dining room. The four guest tents provide comfort and style but with a magnificently raw spirit. Subtly placed under the shade of the riverine forest, the camp is designed in the style of the early explorers, both in philosophy and practice. Explore the area on an open vehicle safari drives and guided walks and relax in the afternoons under the canopy of African ebony and Mopane tree under the canopy of African ebony and Mopane tree in afternoons. When the Selinda Spillway does flood, which now occurs irregularly in winter, guests could have the opportunity to drift along its quiet waters by canoe.

Selinda Explorers Camp on classic East African safari traditions with beautifully detailed campaign-style furniture made from recycled hardwood and soft furnishings from Zanzibar and the East. This is an unassuming camp, light on its footprint but heavy on its experiential luxury. The atmosphere of the camp is one of bush elegance with a relaxed style, complemented by attentive staff, private, professional service and fabulous food.

This is an ideal African safari camp for those guests who want to experience Botswana's extraordinary wildlife but in the most private setting. It is perfect for individual travellers, couples, families and small groups.

The camp sits in a prime predator habitat, in a location which we handpicked based on exploring this area for years. Lions, leopards, and cheetahs are regularly seen. The opportunity to see wild dogs is also possible when they periodically hunt these parts. Good densities of giraffes, buffalo (in the dry season), and all the antelope - even including roan, sable, and recently spotted eland - are possible sightings.

At the peak of the dry season in late September, the Selinda Reserve has been documented to hold up to 9,000 elephants. There is phenomenal bird life along the Spillway's banks for those looking for some 'lifers'.





# SELINDA EXPLORERS CAMP

SELINDA RESERVE | NORTHERN BOTSWANA

## CAMP FEATURES

Selinda Explorers Camp can accommodate up to 10 guests.

### Total Number of Bedrooms:

3 double or twin configuration guest tents,  
1 x 2-bedroom family tent;  
1 guide room with 2 three-quarter beds and a shared en-suite bathroom.

### Type of Lodge:

Explorers Collection Safari Camp

### Lodge Season & Opening:

Year Round

### Ideal length of stay:

3 - 4 Nights

## CAMP CO-ORDINATES

18°30'45"S , 23°24'28"E

## ACCESS DIRECTIONS

- Light aircraft transfers from Kasane (55 mins) and Maun (45 min) airports;
- Private Air charter access available;
- Selinda Explorers Camp is a 50-minute drive from its airstrip;
- Airstrip co-ordinates: 18°34'41.9"S 23°29'16.8"E;
- Airstrip length: 1000m.



## ACTIVITIES

### Wildlife Viewing

Selinda Explorers Camp focuses primarily on traditional safari activities, such as guided walking adventures with licensed, armed guides. There is simply no better way to experience the magic of this unique destination.

These walks are ideally combined with wildlife-viewing activities such as heading out in your open safari vehicle.

Early morning, late afternoon/ evening, or even full-day safari drives are done in our custom-built, open Toyota Land Cruisers, specially designed for our conditions and photography. These vehicles include fold-down windscreens, raised roofs, photographic bars, and multi-plug inverters. Each Land Cruiser has reference books, drinks, and snacks. While our wildlife viewing focus remains on the most comfortable times of day (early to mid-morning and late afternoon to evening), spending a whole day out in the wilderness is not uncommon.

Our safaris will often continue into the evening in search of nocturnal species. Night drives are incredibly prolific, and while they take patience, sightings commonly include lesser-known nocturnal mammals and even lion and hyena hunts.

Canoeing along the Selinda Spillway may be possible if the Selinda Spillway floods in the winter.

# SELINDA EXPLORERS CAMP

SELINDA RESERVE | NORTHERN BOTSWANA



## Fishing

A rod/reel kit is available for those who want to try their cast in the Selinda Spillway between March and December on a catch and release basis (water level dependent).

## Private vehicle option

Available for more flexibility upon request at extra cost, not compulsory for families travelling with children.

## Private Guides

Private guides are encouraged and welcomed.

## Scenic Flight and Champagne Stop

Enjoy an aerial viewing experience with great scenery across the Linyanti/Savuti and Selinda Spillway. Add a 15-minute champagne stop on palm island en route. Must be booked in advance and is subject to extra cost and availability.

## CENTRAL FACILITIES

- Main tented area with separate lounge and dining areas;
- Coffee/tea/bar station;
- Fire pit with seating;
- Plunge pool;
- Hammocks.

## FOOD AND BEVERAGE

- Three delicious and wholesome meals are provided per day from our 'bush kitchen'.
- We are extremely flexible on timings. Picnic breakfasts or lunch (or both) are commonly enjoyed while out on safari;
- All drinks and beverages are included, including imported spirits and champagnes;
- Dining style: group meals or individual dining;
- Indoor and outdoor dining locations;
- All dietary requirements are catered for from regular to vegan to children; prior notice required.

## ACCOMMODATION DETAILS

### Bedroom features

- Three double Selous style canvas tents at ground level on slightly raised platforms consisting of main bedroom, with separate dressing area and en-suite bathroom;
- One 2-Bedroom Family custom-designed canvas tent on a slightly raised platform consisting of two bedrooms, each with their own separate bathroom and dressing area;
- Private verandah with daybed and view;
- Standing fan;
- Coffee/tea station;
- Writing desk;
- All bedrooms can be either twin or double bed configuration.



# SELINDA EXPLORERS CAMP

SELINDA RESERVE | NORTHERN BOTSWANA



## Bathroom features

- En-suite with flush toilet, shower (with hot & cold running water), double basins;
- Soap, shampoo, conditioner and lotion provided.

## ACCOMMODATING CHILDREN AND SHARING ACCOMMODATION

- We look forward to having children stay with us who are 6 years and older;
- The family tent can accommodate a family of 4 guests;
- Families will be combined with other guests on all activities;
- Scheduled wildlife viewing activities, including safari drives, guided walks, and power boating, are available to guests from 6 years when accompanied by their parents or guardians. Where available, canoe and mokoro activities specifically welcome guests aged 8 years and above;
- Young children must be supervised as the camp is open, with high predator densities in and around camp and there is water surrounding camp;
- Great Plains Young Explorers program – thoughtfully designed to explore a range of experiences and topics from birding to cooking to art to tracking wildlife.

## FITNESS

Yoga mats are provided in each tent.

## LAUNDRY

Included in nightly tariff - next day service, weather permitting.

## POWER AND COMMUNICATION

### Power

- The camp is run by solar power with generator back up;
- The system produces 220V, 24-hour electricity;
- Electrical lighting and universal plug point available in guest tents.

### Internet & Mobile

- Wi-fi available in guest tents;
- No mobile signal.

## HEALTH AND SAFETY

### Health

- Malaria: Minimal exposure risk– Malaria prophylaxis are recommended if guests are concerned; however, this is a remote area with little occurrence;
- Guests must hold comprehensive medical insurance and emergency evacuation insurance;
- Senior staff all has first aid training;
- Nearest decent medical facility is in Maun, and then Johannesburg.





# SELINDA EXPLORERS CAMP

SELINDA RESERVE | NORTHERN BOTSWANA



## Possibility of Disabled access

The camp layout is not conducive to wheelchair bound guests due to dirt pathways and uneven terrain.

## Safety

- This remotely located camp is unfenced to wild animals that do move through the property especially at night;
- Fire extinguishers in every tent.

## MONEY MATTERS

### Safes

Safes are provided in every tent.

### Accepted Payment on Location

- Staff gratuities can be paid in Botswana Pula, US Dollars, Euro and GB Pounds - preferably in cash - to the staff member concerned who has truly exceeded expectations in terms of hospitality, service, and experience;
- Guest extras and curio sales can be settled by Visa and MasterCard credit card (No Amex or Diners).

The Team

Lodge Owners

**Great Plains Conservation**

## FOUNDATION INITIATIVE

### Conservation Education

Engaging youth in local communities living alongside conserved land is critical to long-term conservation. Our conservation education programs engage youth with the natural world at a pivotal time in their lives. Great Plains Conservation believes that through thoughtful engagement, environmental education, fun and mentorship, youth in nearby communities can learn to appreciate the uniqueness of their ecosystems and become champions for conservation. Great Plains Student Conservation Camps are one of our longest-running community programs. Since the program began more than ten years ago, hundreds of children have benefitted from the program in both Kenya and Botswana. For years the annual residential "kids camps" in Botswana were held at Selinda Explorers Camp! Learn more at [www.greatplainsfoundation.com](http://www.greatplainsfoundation.com)

In addition to our own programs Great Plains Foundation keeps a list of school needs in the countries where we work. Needed items can be hand-carried by travelers or we can help purchase them locally. To learn more or to help support students and educators as part of your trip please reach out [info@greatplainsfoundation.com](mailto:info@greatplainsfoundation.com)





# GUEST TENT

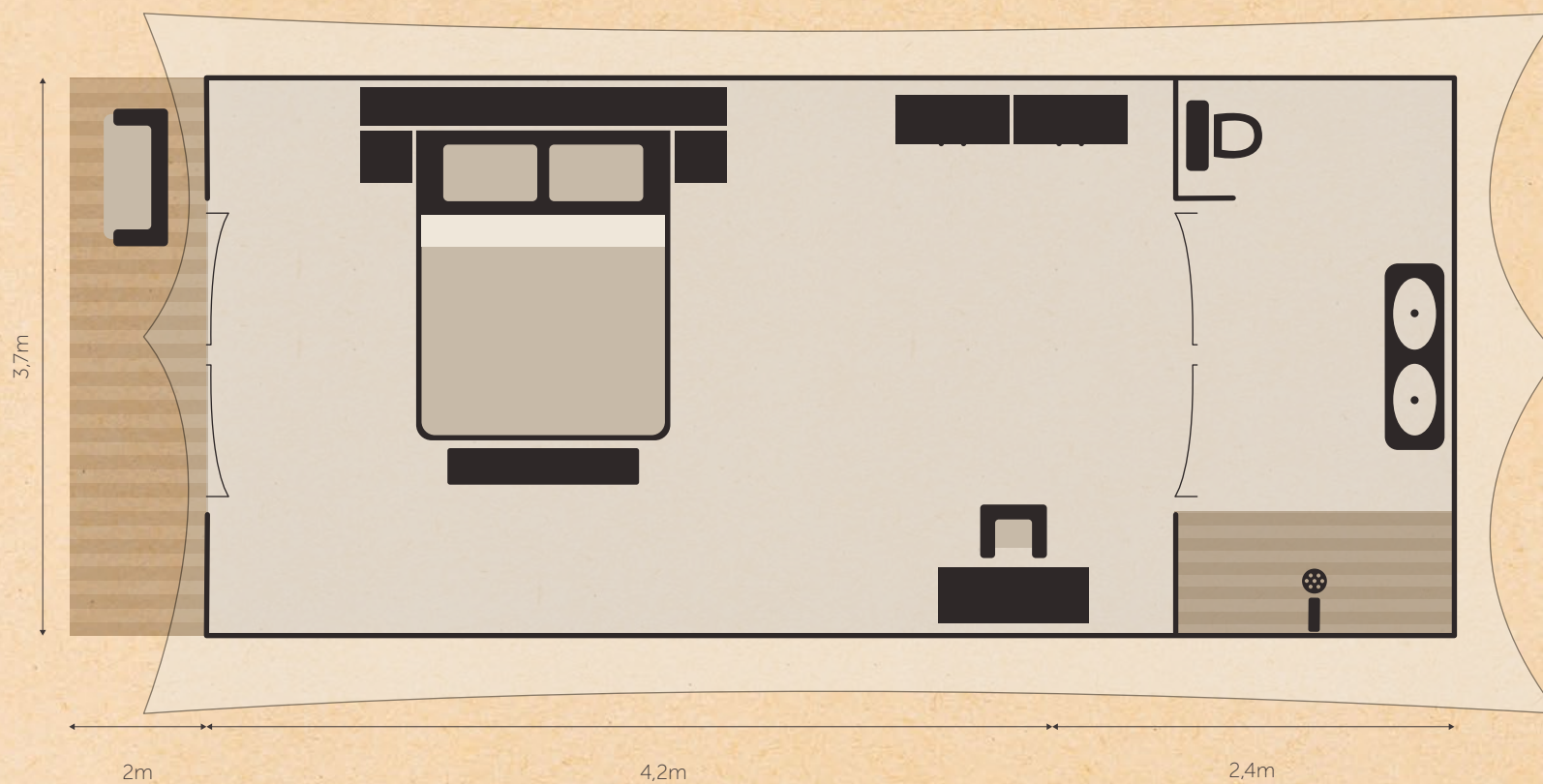





BOTSWANA  
**GREAT PLAINS**  
 SELINDA EXPLORERS CAMP

## 2 BEDROOM FAMILY TENT

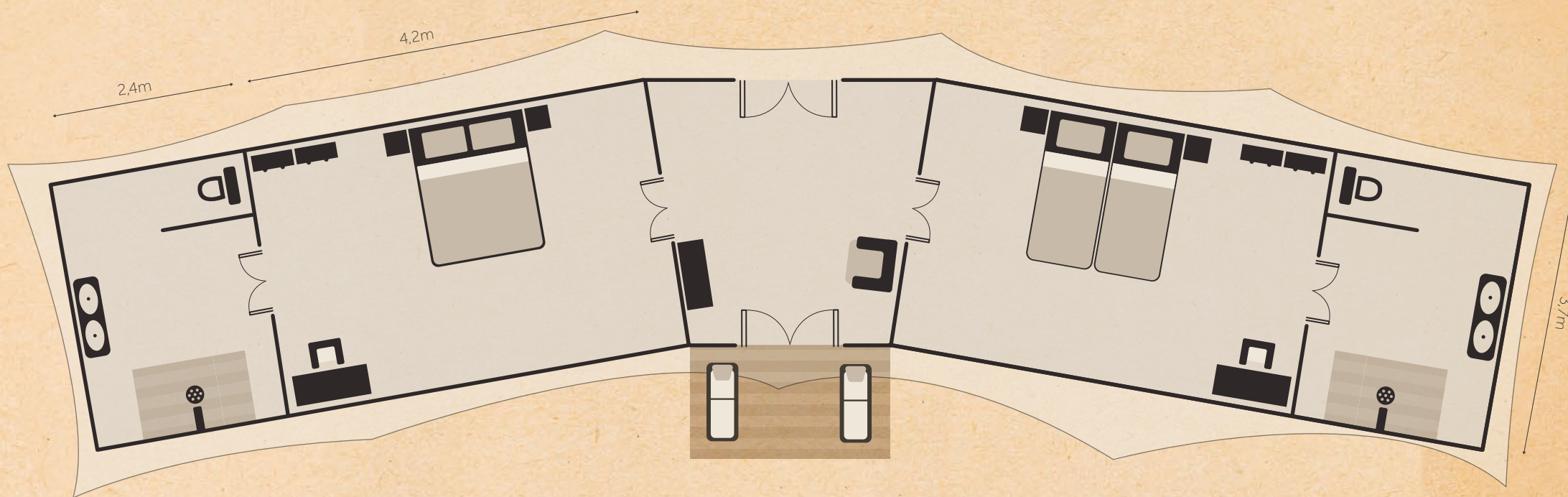





*Namibia*

*Bwabwata  
National Park*

*Mudumu  
National Park*

*Chobe Forest Reserve*

*Chobe National Park*

Selinda Explorers Camp

Selinda Camp &  
Selinda Suite

Zarafa Camp &  
The Dhow Suite at Zarafa

Okavango Explorers Camp

Sitatunga Private Island &  
Sitatunga Private Island Suite

Duba Explorers Camp

Duba Plains &  
Duba Plains Suite

Moremi Game Reserve  
*Okavango Delta*

*Botswana*

Maun

Kasane

## GREAT PLAINS

CONSERVING AND EXPANDING NATURAL HABITATS



GREAT PLAINS CONSERVATION  
STRIVES TO FIND THE RIGHT FORMULA OF  
CONSERVATION, COMMUNITIES AND COMMERCE  
THAT MAKES A LASTING, SUSTAINABLE DIFFERENCE  
TO THE WORLD'S ICONIC WILDLIFE  
AND WILDERNESSES.

*Nxai Pan  
National Park*



# GREAT PLAINS CONSERVATION

## QUICK CAMP FACTS



### BOTSWANA CAMPS

ACTIVITY	ZARAFA CAMP & THE DHOW SUITE AT ZARAFA	SELINDA CAMP & SELINDA SUITE	DUBA PLAINS CAMP & DUBA PLAINS SUITE	SITATUNGA PRIVATE ISLAND & SITATUNGA PRIVATE ISLAND SUITE
Camp Classification	Réserve Collection	Réserve Collection	Réserve Collection	Réserve Collection
Location	Selinda Reserve	Selinda Reserve	Duba Concession	Sitatunga Private Reserve
Number of Suites / Tents	4 Suites	3 Suites	5 Suites	2 Suites
Family Accommodation	The Dhow Suite at Zarafa	The Selinda Suite	The Duba Plains Suite	The Sitatunga Private Island Suite
Children can be accommodated from:	6 Years	6 Years	6 Years	6 Years
Day and Night Safari Drives	Yes	Yes	Yes	n/a
Private Activities (at an additional charge)	Yes (Included for Dhow Suite)	Yes (Included for Selinda Suite)	Yes (Included for Duba Plains Suite)	Private boating
Guided Walks	Yes	Yes	Yes	Yes
Boating (*water level dependent)	*Yes	*Yes	Yes	Yes
Mekoro and/or Canoeing (*water level dependent)	n/a	n/a	Mekoro	*Mekoro
Fishing (Seasonal and *water lever dependent)	*Yes	*Yes	Yes	Yes
Scenic Flights and Champagne Stops	Available at an additional charge	Available at an additional charge	Available at an additional charge	Available at an additional charge
Main Swimming Pool / Private Plunge Pools	Private Plunge Pool	Private Plunge Pool	Private Plunge Pool	Private Plunge Pool
Shower	Indoor & Outdoor	Indoor	Indoor & Outdoor	Indoor
Bath	Yes	Yes	Yes	Yes
Hairdryers (low-voltage)	Yes	Yes	Yes	Yes
Mosquito Nets	Yes	Yes	Yes	Yes
Over-bed air-conditioning	Yes	Yes	Yes	Yes
Fan	Yes	Yes	Yes	Yes
Wi-Fi – in-room (complimentary)	Yes	Yes	Yes	Yes
Safe - In-room	Yes	Yes	Yes	Yes
Spa treatments (at an additional charge)	Yes	Yes	Yes (In-room only)	Yes (In-room only)
Fitness	Gym & In-Room Equipment	In-Room Equipment	In-Room Equipment	In-Room Equipment
Boutique on site	Yes	Yes	Yes	Yes



## BOTSWANA CAMPS

ACTIVITY	SELINDA EXPLORERS CAMP	OKAVANGO EXPLORERS CAMP	DUBA EXPLORERS CAMP
Camp Classification	Explorers Collection	Explorers Collection	Explorers Collection
Location	Selinda Reserve	Selinda Reserve	Duba Concession
Number of Suites / Tents	3 Tents	6 Tents	5 Tents
Family Accommodation	1 Family Tent	n/a	n/a
Children can be accommodated from:	6 Years	6 Years	6 Years
Day and Night Safari Drives	Yes	Yes	Yes
Private Activities (at an additional charge)	Yes	Yes	Yes
Guided Walks	Yes	Yes	Yes
Boating (water level dependent)	n/a	n/a	*Yes
Mekoro and/or Canoeing (water level dependent)	Canoeing	Canoeing	Mekoro
Fishing (Seasonal and water lever dependent)	Yes	Yes	Yes
Scenic Flights and Champagne Stops	Available at an additional charge	Available at an additional charge	Available at an additional charge
Main Swimming Pool / Private Plunge Pools	Main Swimming Pool	n/a	Main Swimming Pool
Shower	Indoor	Indoor	Indoor
Bath	n/a	n/a	n/a
Hairdryers (low-voltage)	n/a	n/a	n/a
Mosquito Nets	On All Tent Sides	Yes	Yes
Over-bed air-conditioning	n/a	n/a	Yes
Fan	Yes	Yes	Yes
Wi-Fi – in-room (complimentary)	Yes	Yes	Yes
Safe - In-room	Yes	Yes	Yes
Spa treatments (at an additional charge)	n/a	n/a	n/a
Fitness	Yoga Mats	Yoga Mats	In-Room Equipment
Boutique on site	n/a	n/a	Yes