

# OKAVANGO EXPLORERS CAMP

SELINDA RESERVE | NORTHERN BOTSWANA

GREAT PLAINS

CONSERVING AND EXPANDING NATURAL HABITATS

ESTABLISHED 1992

**Okavango Explorers Camp is an Explorer Collection safari camp located in the southwest of Botswana's private Selinda Reserve.**

At the intersection of the upper Okavango Delta water system and the famed Selinda Spillway, the camp's location is a unique combination of two iconic ecosystems. This area may be new to guests but has been known to us for many years as one teeming with wildlife.

The Selinda Reserve in northern Botswana is a prime predator and elephant habitat. This location has been handpicked for its access to some of the highest concentrations of wildlife in the region, along the southernmost section of Selinda Spillway. Lion, leopard and wild dogs hunt these parts regularly. There are good densities of giraffes and buffalo, and more recently, rare antelope like roan, sable, and eland. At the peak of the dry season in late September, the Selinda Reserve has been documented to be home to over 9,000 elephants concentrated along this river system. For lovers of elephants, this is the place to be in the dry season. There is phenomenal birdlife in this area for those looking for some 'lifers'.

Okavango Explorers Camp creates a safari experience reminiscent of exploring the unknown African hinterland in a 1920's style. The camp exudes a spirit of the romance of yesteryear whilst ensuring that adventure and discovery are an essential part of the journey.

Enjoy moments where wildlife congregates along the Selinda Spillway to drink and marvel at the setting of the African sun across wildlife-filled plains. The safari experiences include wildlife viewing drives, canoeing and walking because Okavango Explorers Camp is in one of the most remote parts of this private reserve.

Okavango Explorers Camp is the perfect safari camp to combine with its fellow Explorer-Collection safari camps, Selinda Explorers and Duba Explorers Camps. This camp is ideal for friends or families wanting to take the whole camp for extended stays and to make it their own.





# OKAVANGO EXPLORERS CAMP

SELINDA RESERVE | NORTHERN BOTSWANA

## CAMP FEATURES

Okavango Explorers Camp can accommodate a maximum of 12 adults in 6 tents.

### Total Number of Bedrooms:

6 double or twin configuration tents.

1 pilot/guide tent with two three-quarter beds and a shared en-suite bathroom.

### Type of Lodge:

Explorers Collection Safari Camp

### Lodge Season & Opening:

Year Round

## CAMP CO-ORDINATES

18°46'30.31"S 23° 2'26.15"E

## ACCESS DIRECTIONS

- Light aircraft transfers from Kasane (55 mins) and Maun (45 min) airport;
- Private Air charter access available;
- Okavango Explorers Camp is a 5-minute drive from its airstrip;
- Airstrip co-ordinates: 18°46'16.52"S 23° 2'27.86"E
- Airstrip length: 1000m.

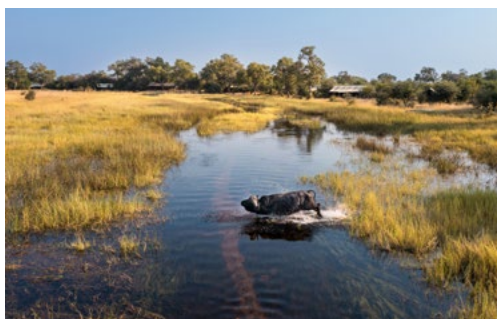

## ACTIVITIES

### Safari Drives

The focus of your stay and safari experience is one of exploration and adventure. As such, a large portion of the wildlife viewing activities involve safari drives in our specially adapted vehicles, guided walking opportunities as well as some canoeing on the Selinda Spillway as it enters the Selinda Reserve from the west, being fed from the upper fringes of the Okavango Delta. Our custom-built, open Toyota Land Cruisers are specially designed for our conditions and photography, including fold-down windscreens, raised roofs, photographic bars, and multi-plug inverters. Each Land Cruiser is fully stocked with reference books, drinks, and snacks.

Guests can experience up-close encounters with elephants, lions, leopards, hyenas, wild dogs, buffalo, eland, zebra and other ungulate species. This is a prime bird-watching country, and opportunities abound for guests to spot resident and migrant species, especially in the early morning and late afternoon.

Our safaris will often continue into the night in search of nocturnal species. Night drives are incredibly prolific, and while they take patience, sightings commonly include lesser-known nocturnal mammals and even lion and hyena hunts.

Our schedule is flexible, and guests are encouraged to create their own itinerary according to their interests with guidance and recommendations from our professional guides.

# OKAVANGO EXPLORERS CAMP

SELINDA RESERVE | NORTHERN BOTSWANA



## Guided Walks

Guided walks, the specialist wildlife viewing activity of Okavango Explorers Camp is available with licensed, armed guides. There is simply no better way to experience the magic of this unique destination.

## Canoeing

Canoeing along the Selinda Spillway channels is a unique and memorable experience when these channels flood, usually during the winter months, a unique experience that cannot be replicated anywhere else in Africa.

## Fishing

A rod/reel kit is available for those who want to try their cast in the Selinda Spillway, on a catch and release basis, between March and December (water level dependent).

## Private vehicle option

Available for more flexibility upon request at extra cost, not compulsory for families travelling with children.

## Private Guides

Private guides are encouraged and welcomed.

## CENTRAL FACILITIES

- Tented safari main area, which includes the lounge and dining area;
- Coffee/tea station;
- Outdoor seating with fire pit.

## FOOD AND BEVERAGE

- All drinks and beverages are included, including imported spirits and champagne;
- Three delicious meals a day are provided;
- We are highly flexible on timings;
- Picnic breakfasts or lunch (or both) are the norms due to wildlife viewing activities;
- Dining style: Group meals or Individual dining;
- Outdoor and under canvas dining locations;
- All dietary requirements are catered for from regular to vegan to children; prior notice is required.

## ACCOMMODATION DETAILS

### Bedroom features

- Six large one-bedroom canvas tents on wooden decking;
- Private verandah and view;
- Canvas is light sand coloured, with netted windows;
- Each bed has a mosquito net, and suites have netted windows;
- Fans in bedrooms and electrical lights;
- Charging facilities;
- Coffee/tea station;
- Writing desk;
- Either twin or double bed configuration.

### Bathroom features

- Each tent has an en-suite bathroom with flush toilet, shower (with hot & cold running water), double basins;
- Soap, shampoo, conditioner, lotion are provided. No hairdryers.



# OKAVANGO EXPLORERS CAMP

SELINDA RESERVE | NORTHERN BOTSWANA

## ACCOMMODATING CHILDREN AND SHARING ACCOMMODATION

- Children are accommodated from a minimum age of 6 years;
- Triples are possible;
- Families will be combined with other guests on all activities unless a private vehicle is booked and paid for;
- Scheduled wildlife viewing activities, including safari drives, guided walks, and power boating, are available to guests from 6 years when accompanied by their parents or guardians. Where available, canoe and mokoro activities specifically welcome guests aged 8 years and above;
- Young children must be supervised as the camp is open with high predator densities in and around camp and there is water close by;
- Great Plains Young Explorers program – thoughtfully designed to explore a range of experiences and topics from birding to cooking to art to tracking wildlife.

## FITNESS

Yoga mats are provided in each tent.

## LAUNDRY

Included in nightly tariff - next day service, weather permitting.

## POWER AND COMMUNICATION

### Power

- The camp is run by portable solar power with generator back up;
- The system produces 220V, 24-hour electricity;
- Electrical lighting and charging facilities in guest tents.

### Internet & Mobile

- Wi-Fi available in guest tents;
- No mobile reception.

## HEALTH AND SAFETY

### Health

- Malaria: Minimal exposure risk– Malaria prophylaxis are recommended if guests are concerned; however, this is a remote area with minor occurrence;
- Guests must hold comprehensive medical insurance and emergency evacuation insurance;
- Senior staff all has first aid training;
- The nearest decent medical facility is in Maun and then Johannesburg.

### Possibility of Disabled access

- The camp layout and experiences are not conducive to wheelchairs due to the terrain.

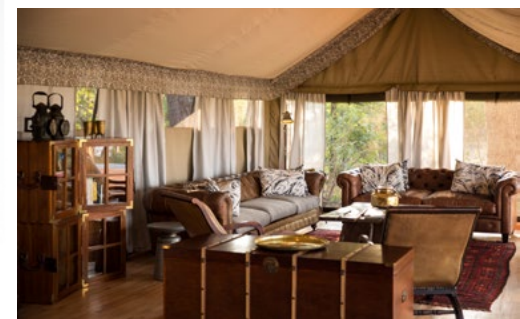

# OKAVANGO EXPLORERS CAMP

SELINDA RESERVE | NORTHERN BOTSWANA



## Safety

- This is a remotely located camp and is unfenced to wild animals that do move through the property, especially at night;
- Fire extinguishers in the main camp areas and every tent.

## MONEY MATTERS

### Safes

Safes are provided in the guest tents.

### Accepted Payment on Location

- Staff gratuities can be paid in Botswana Pula, US Dollars, Euro and GB Pounds - preferably in cash - to the staff member concerned who has truly exceeded expectations in terms of hospitality, service, and experience;
- Guest extras can be settled by Visa and MasterCard credit cards (No Amex or Diners).

### The Team

Lodge Owners

## Great Plains Conservation

### FOUNDATION INITIATIVE

#### Female Rangers

Conservation needs boots (and eyes and ears) on the ground. At the same time, a central mission within the Great Plains Foundation is women's empowerment. These were the twin inspirations behind the establishment of our Female Ranger Units. These all-female units patrol our concessions, gather essential data and act as an early detection force against illegal wildlife crime. Hiring female wildlife and natural resource monitors builds their capacity as individuals, empowers the communities they represent and offers opportunities to shift gender stereotypes and establish strong female role models for young girls. The inaugural all-women unit began their training in 2022 in Botswana and additional teams are being trained and activated in Botswana and Zimbabwe.

[www.greatplainsfoundation.com/female-rangers](http://www.greatplainsfoundation.com/female-rangers)

In addition to our own programs Great Plains Foundation keeps a list of school needs in the countries where we work. Needed items can be hand-carried by travelers or we can help purchase them locally. To learn more or to help support students and educators as part of your trip please reach out [info@greatplainsfoundation.com](mailto:info@greatplainsfoundation.com)



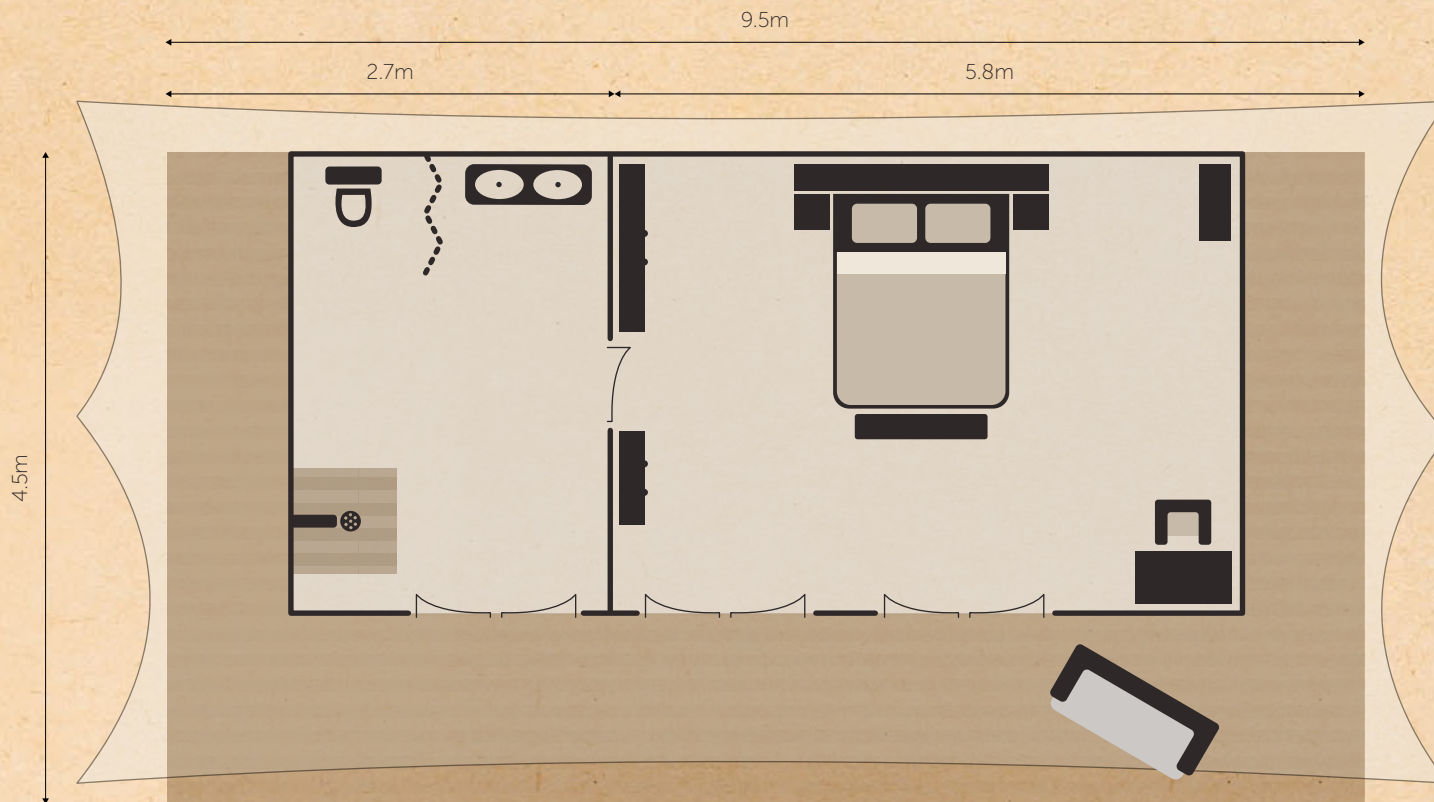

BOTSWANA

**GREAT PLAINS**

OKAVANGO EXPLORERS CAMP

## GUEST TENT

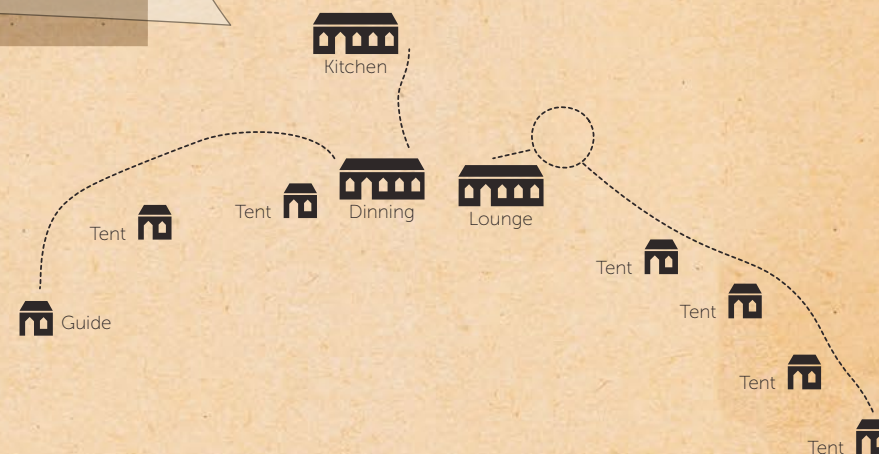



## 2 BEDROOM FAMILY TENT

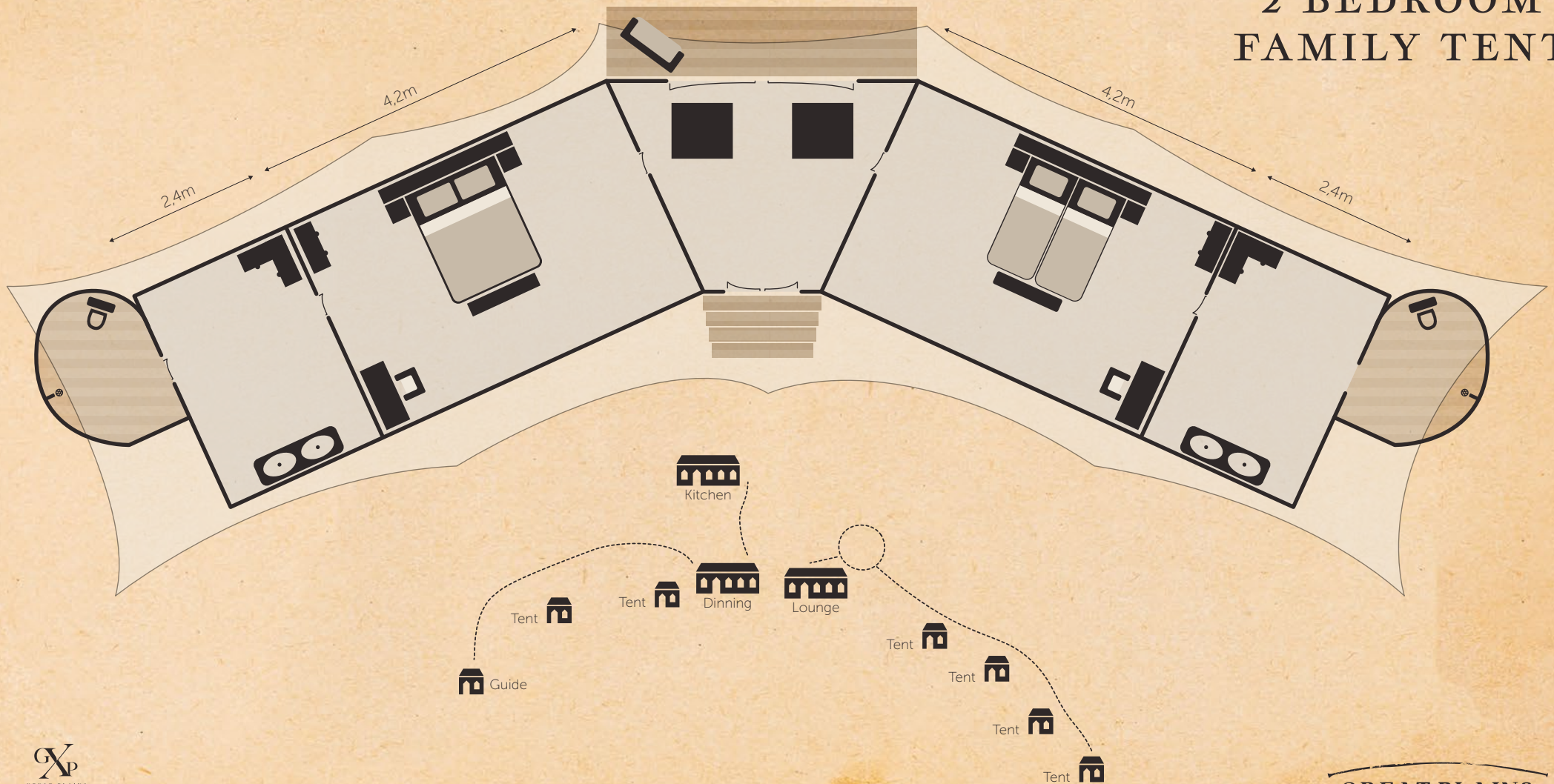





*Namibia*

*Bwabwata  
National Park*

*Mudumu  
National Park*

*Chobe Forest Reserve*

*Chobe National Park*

Selinda Explorers Camp

Selinda Camp &  
Selinda Suite

Zarafa Camp &  
The Dhow Suite at Zarafa

Okavango Explorers Camp

Sitatunga Private Island &  
Sitatunga Private Island Suite

Duba Explorers Camp

Duba Plains &  
Duba Plains Suite

Moremi Game Reserve  
*Okavango Delta*

*Botswana*

Maun

Kasane

## GREAT PLAINS

CONSERVING AND EXPANDING NATURAL HABITATS



GREAT PLAINS CONSERVATION  
STRIVES TO FIND THE RIGHT FORMULA OF  
CONSERVATION, COMMUNITIES AND COMMERCE  
THAT MAKES A LASTING, SUSTAINABLE DIFFERENCE  
TO THE WORLD'S ICONIC WILDLIFE  
AND WILDERNESSES.

*Nxai Pan  
National Park*



# GREAT PLAINS CONSERVATION

## QUICK CAMP FACTS



### BOTSWANA CAMPS

ACTIVITY	ZARAFA CAMP & THE DHOW SUITE AT ZARAFA	SELINDA CAMP & SELINDA SUITE	DUBA PLAINS CAMP & DUBA PLAINS SUITE	SITATUNGA PRIVATE ISLAND & SITATUNGA PRIVATE ISLAND SUITE
Camp Classification	Réserve Collection	Réserve Collection	Réserve Collection	Réserve Collection
Location	Selinda Reserve	Selinda Reserve	Duba Concession	Sitatunga Private Reserve
Number of Suites / Tents	4 Suites	3 Suites	5 Suites	2 Suites
Family Accommodation	The Dhow Suite at Zarafa	The Selinda Suite	The Duba Plains Suite	The Sitatunga Private Island Suite
Children can be accommodated from:	6 Years	6 Years	6 Years	6 Years
Day and Night Safari Drives	Yes	Yes	Yes	n/a
Private Activities (at an additional charge)	Yes (Included for Dhow Suite)	Yes (Included for Selinda Suite)	Yes (Included for Duba Plains Suite)	Private boating
Guided Walks	Yes	Yes	Yes	Yes
Boating (*water level dependent)	*Yes	*Yes	Yes	Yes
Mekoro and/or Canoeing (*water level dependent)	n/a	n/a	Mekoro	*Mekoro
Fishing (Seasonal and *water lever dependent)	*Yes	*Yes	Yes	Yes
Scenic Flights and Champagne Stops	Available at an additional charge	Available at an additional charge	Available at an additional charge	Available at an additional charge
Main Swimming Pool / Private Plunge Pools	Private Plunge Pool	Private Plunge Pool	Private Plunge Pool	Private Plunge Pool
Shower	Indoor & Outdoor	Indoor	Indoor & Outdoor	Indoor
Bath	Yes	Yes	Yes	Yes
Hairdryers (low-voltage)	Yes	Yes	Yes	Yes
Mosquito Nets	Yes	Yes	Yes	Yes
Over-bed air-conditioning	Yes	Yes	Yes	Yes
Fan	Yes	Yes	Yes	Yes
Wi-Fi – in-room (complimentary)	Yes	Yes	Yes	Yes
Safe - In-room	Yes	Yes	Yes	Yes
Spa treatments (at an additional charge)	Yes	Yes	Yes (In-room only)	Yes (In-room only)
Fitness	Gym & In-Room Equipment	In-Room Equipment	In-Room Equipment	In-Room Equipment
Boutique on site	Yes	Yes	Yes	Yes



## BOTSWANA CAMPS

ACTIVITY	SELINDA EXPLORERS CAMP	OKAVANGO EXPLORERS CAMP	DUBA EXPLORERS CAMP
Camp Classification	Explorers Collection	Explorers Collection	Explorers Collection
Location	Selinda Reserve	Selinda Reserve	Duba Concession
Number of Suites / Tents	3 Tents	6 Tents	5 Tents
Family Accommodation	1 Family Tent	n/a	n/a
Children can be accommodated from:	6 Years	6 Years	6 Years
Day and Night Safari Drives	Yes	Yes	Yes
Private Activities (at an additional charge)	Yes	Yes	Yes
Guided Walks	Yes	Yes	Yes
Boating (water level dependent)	n/a	n/a	*Yes
Mekoro and/or Canoeing (water level dependent)	Canoeing	Canoeing	Mekoro
Fishing (Seasonal and water lever dependent)	Yes	Yes	Yes
Scenic Flights and Champagne Stops	Available at an additional charge	Available at an additional charge	Available at an additional charge
Main Swimming Pool / Private Plunge Pools	Main Swimming Pool	n/a	Main Swimming Pool
Shower	Indoor	Indoor	Indoor
Bath	n/a	n/a	n/a
Hairdryers (low-voltage)	n/a	n/a	n/a
Mosquito Nets	On All Tent Sides	Yes	Yes
Over-bed air-conditioning	n/a	n/a	Yes
Fan	Yes	Yes	Yes
Wi-Fi – in-room (complimentary)	Yes	Yes	Yes
Safe - In-room	Yes	Yes	Yes
Spa treatments (at an additional charge)	n/a	n/a	n/a
Fitness	Yoga Mats	Yoga Mats	In-Room Equipment
Boutique on site	n/a	n/a	Yes