

SIMBAVATI

LODGE COLLECTION

Safari

FACT SHEET

SIMBAVATI WATERSIDE

KLASERIE PRIVATE NATURE RESERVE
KRUGER NATIONAL PARK
SOUTH AFRICA

Water is *Life*

Flanking a large dam in the southern Klaserie Private Nature Reserve (just 30 minutes drive from Hoedspruit Eastgate Airport), Simbavati Waterside was conceptualised, designed and built to be a natural extension of the pure utopian Klaserie wilderness from which it draws its inspiration.

Water is the source of life. Throughout the year countless animal species – including predators, elephants, hippo and buffalo - are drawn to the dam to cool off and quench thirst (sometimes in herds numbering hundreds). Here the game viewing never stops, and guests become part of their own private Africa for an utterly immersive and sensory safari experience.

Simbavati Waterside is the perfect environment for every type of traveller. The carefully considered lodge structure affords absolute privacy for couples, as well as sociable spaces for families and friends. Sophisticated décor, sublime cuisine in imaginative settings, and intuitive hospitality enhance an already-perfect safari.

Contact

Reservations

+27 (0)87 151 4520 | res@simbavati.com

simbavati.com

Africalm
IS OUR PROMISE

Location



At a Glance



Number of Rooms

- 8 Rooms



Room Types

- Luxury Suite
- Two-Bedroom Luxury Suite
- Luxury Suite with private KolKol tub



Child Policy

- We welcome children of all ages
- Children of 6 years and older are allowed to participate in game drives



Ideal For...

- Families
- Couples
- Friends
- Solo Travellers
- Explorers
- The Active & Adventurous

UNIQUE SELLING POINTS

Why We *love it*



Location:
Beautiful setting, flanking a huge dam. Just 30 minutes from Hoedspruit Eastgate Airport



Sustainable:
Conservation of natural resources (electricity from coal, fuels and water); waste management and ethical procurement practices



Multi-faceted:
Perfect for couples, families, friends and solo travellers



Dining:
Imaginative settings, around the water, in the bush, on the deck or within the lodge

WHY VISIT?

Klaserie

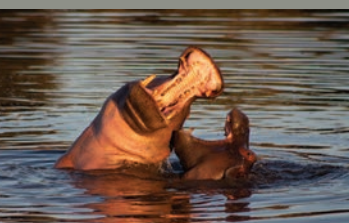

The Klaserie Game Reserve was established in 1972 as part of the greater Kruger National Park. It is one of the largest private reserves in South Africa, being 60,000 hectares (or 148,000 acres). This vast tract of preserved land has some beautiful trees and riverine vegetation near the magnificent Klaserie River. It has an open fenceless border to the Kruger National Park in the north, and the Timbavati to the south-east.

The Klaserie also protects sustainable populations of many endangered species such as wild dog, saddle-billed storks and southern ground hornbills. With limited lodges and vehicles, the Klaserie offers a raw, non-commercialised wilderness experience.



Lodge Facilities

- Main Lodge with expansive views of the dam
- Sitting area, with books and board games
- Complimentary Wi-Fi in rooms and in main guest areas
- Outdoor deck for dining
- Expansive swimming pool
- Exclusive sleepout deck
- Bar
- Safari spa
- 'Beach-Boma', with pizza oven and fire pit (eye level with the dam water's surface)
- Bush boma for dining under the stars
- Wine cellar
- Fully equipped gym
- Safari shop

Room *Types*

2 X LUXURY SUITES

- King bed (convertible to twin) • En suite bathroom with shower, double vanity, and separate toilet • Dressing area with ample storage space • Game viewing deck
- Outdoor shower • Water facing

4 X TWO-BEDROOM LUXURY SUITES

- (Family suites) • Interleaving rooms • King bed (convertible to twin) – main bedroom
- Twin beds (convertible to king) – second bedroom • Open-plan main bathroom en-suite with bath and interconnected indoor and outdoor rain-showers, double vanity and separate toilet • A second separate bathroom en-suite with indoor rain-shower and toilet
- Dressing area with ample storage space • Game viewing deck (both rooms) • Water facing

2 X LUXURY SUITE WITH PRIVATE KOLKOL TUB

- King bed (convertible to twin) • En suite bathroom with shower, double vanity, and separate toilet • Dressing area with ample storage space • Game viewing deck • KolKol tub (outdoor wood-fired tub that can be used both hot and cold)
- Outdoor shower • Bush facing

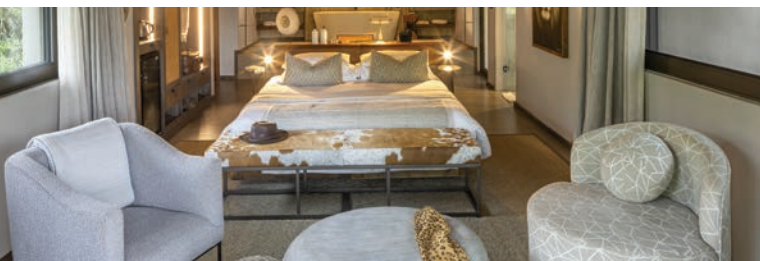



LUXURY, TENTED, FAMILY

In-Room Facilities & Amenities

- Private viewing deck
- Bathroom comprises a bath, double vanity with indoor shower and outdoor shower
- Complimentary eco-friendly amenities
- Minibar
- Coffee and tea-making facilities
- Air-conditioning
- Ceiling fan
- Electric blankets (winter)
- Mini safe for storing valuables
- Hair dryer
- Laundry bag in room
- Room equipped with electronic eco-friendly insect spray (subtly sprayed at 10 minute intervals)



Daily Programme

- Early morning tea/coffee
- Game drive (approximately 3 hours)
- Mid-morning breakfast in the dining area
- Time to relax, enjoy a spa treatment or burn calories in the gym, cool down in the pool or spend some time overlooking the dam and its wildlife
- Lunch
- Afternoon tea
- Afternoon/evening game drive (approximately 3 hours)
- Dinner under the stars, around the fire, on the deck or in a surprise private setting (weather permitting)

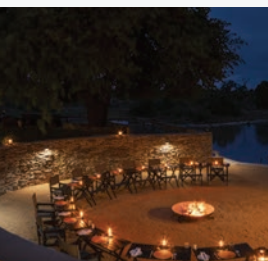



Shilope Sleepout Deck

Illuminated by solar lanterns, the Shilope Sleepout Deck welcomes you with a king-sized bed and a top-level lookout deck, setting the stage for a night of romance and complete immersion in the bush. Elevated above the ground, this unique experience allows you to see the Klaserie Private Nature Reserve and its wildlife from an entirely different perspective. Fall asleep to the mesmerising nocturnal sounds of the bush beneath you, only to awaken to birdsong and the warm, golden glow of sunrise. The sleepout deck is equipped with an en-suite shower and toilet, complete with hot, running water, ensuring the optimal experience.

- Sleepout must be booked in conjunction with a room at Simbavati Waterside
- Bookings subject to availability and must be made in advance
- Includes canape style dinner and continental breakfast. If preferred, meals may be taken at the main lodges
- Due to the nature of the experience, no evening game drive will occur on the night of the stay in order to take advantage of the sunset on the deck
- No children under the age of 16



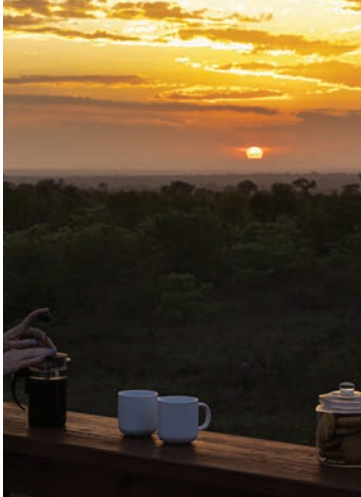

Lodge Layout

KEY

1 & 6: Luxury Suite | 7 & 8: Luxury Suite with private KolKol tub
2-5: Two-bedroom Luxury Suite

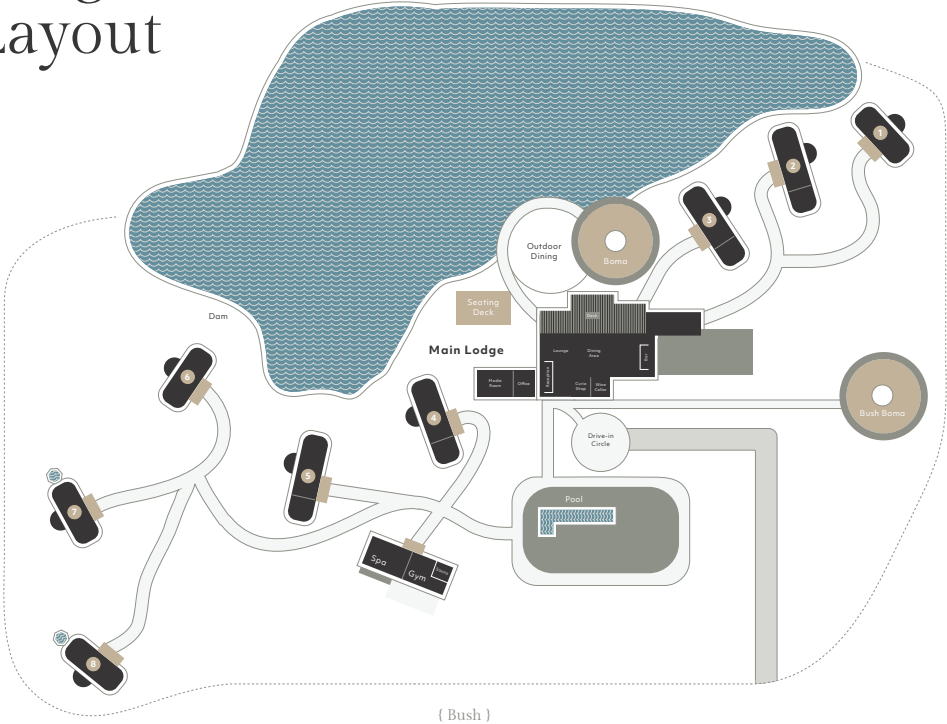

Room Layout

Two-Bedroom Luxury Suite *Layout*



Luxury Suite *Layouts*

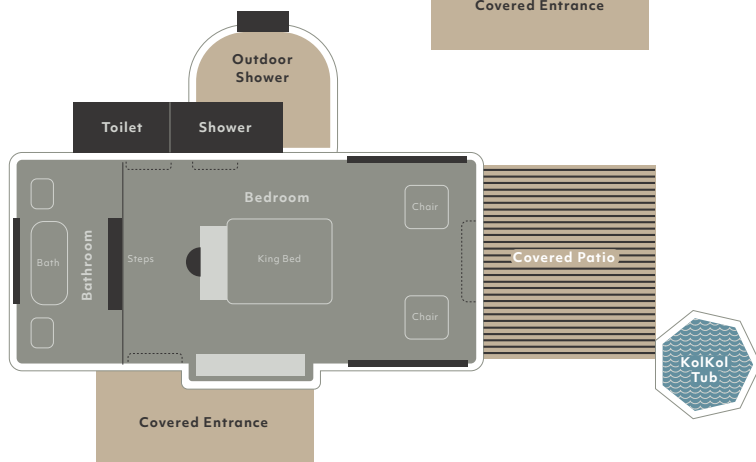
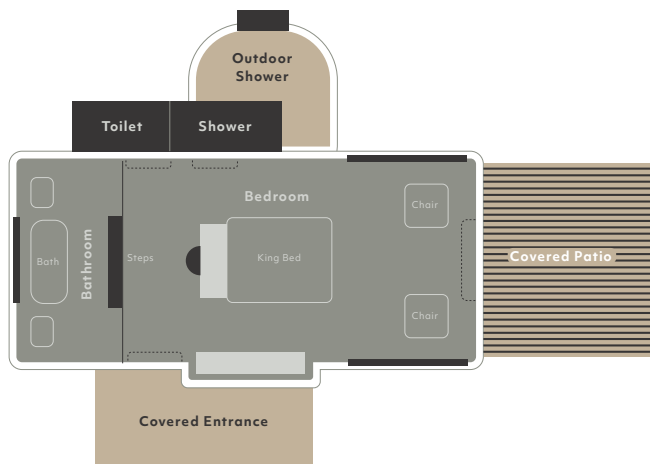

Activities

- Game drives (late afternoon into the evening and early morning)
- Guided walking safaris (subject to availability)
- Star-gazing
- Dining in a variety of settings
- Sundowners
- Spa and gym
- Sleepout deck

GETTING THERE

Travel Options

Simbavati Waterside is just 30 minutes from Hoedspruit Eastgate Airport, and can be accessed by car on gravel roads.
±6.5 to 7 hours' drive from Johannesburg N1 via Polokwane (recommended route) or via Dullstroom, and 2 to 3 hours from Kruger Mpumalanga International Airport or Hazyview.















SIMBAVATI

LODGE COLLECTION

Get in touch with us

Reservations

+27 (0) 87 151 4520 • res@simbavati.com

Sales

sales@simbavati.com

www.simbavati.com

Follow us on Instagram and Facebook

[@simbavatisafari](https://www.instagram.com/simbavatisafari)

Africalm
IS OUR PROMISE