



Chem Chem  
SAFARI

CHEM CHEM LODGE





# Chem Chem Lodge

Chem Chem Lodge is a sanctuary amid a palm-dotted oasis, where every moment of your stay is rooted in our 'Slow Safari' ethos. Here, your schedule is yours to script as you take a moment to slow down and immerse yourself in the Tanzanian wilderness.

Chem Chem Lodge champions sophistication, space and seclusion above all else and each tented suite is a private slice of paradise. The design-led lodge's appeal lies in its seamless cohesion with the surrounding wilderness, from oak up the scenery over a gourmet meal as abundant plains game grazes on your doorstep, and the striking views stretch from the nearby watering hole all the way to the distant shores of Lake Manyara.

## 01 Slow Safari experience

At Chem Chem, every moment of your stay is yours to schedule. Our pioneering Slow Safari philosophy invites you to slow down, attune yourself to nature and savour each moment spent together with your loved ones in the Tanzanian wilderness. Here, you can fill your days with as many – or as few – experiences as you wish.

## 02 Private guide and vehicle

Every booking is allocated a private vehicle with a guide, enabling you to explore the wilderness at your own pace and enjoy a schedule-free experience.

## 03 Culture-infused safari

Whether you're running with a Maasai warrior, exploring the wilderness with a Maasai guide or visiting a Maasai village or Barabaig boma, culture is infused into every aspect of the Chem Chem experience.

## 04 Conservation at our core

Through our conservation association, the Chem Chem Association, Chem Chem plays a vital role in safeguarding our exclusive-use protected wildlife area and the Kwakuchinja Wildlife Corridor. We are also committed to empowering the communities that share the land with us.

## 05 Wellness haven

Chem Chem Lodge champions well-being and aims to curate an experience that leaves you feeling refreshed and revitalised. Our wellness offerings range from a specialised health-centric menu and vitamin-rich wellness shots to walks in nature, a fully-equipped gym and a pampering spa.



### In-room facilities:

#### EN SUITE BATHROOM

Each tented suite features an indoor shower and an outdoor rainfall shower.

#### VANITY

There are 2 vanities per tented suite.

#### MINIBAR AND COFFEE MACHINE

Complimentary minibar in each tented suite. Your preferred drinks will be stocked in the mini bar, e.g. local beers and spirits, soft drinks,

bottled water and kombucha..

#### COFFEE AND TEA STATION

#### AIR-CONDITIONER

Available in each tented suite.

#### FANS

Standing fans are available in each tented suite for extra comfort.

#### MOSQUITO NETS

Each tented suite has a mosquito net and mosquito repellent.

#### SAFE

Personal safe in each tented suite.

#### LAUNDRY

Daily laundry service included.

#### HAIRDRYER

A hairdryer is available in each tented suite.

#### TELEPHONE

Internal calls only.

### 7 x tented suites

Double, twin or triple configurations available (only 4 twins available).

Extra bed available upon request, only for children under the age of 15

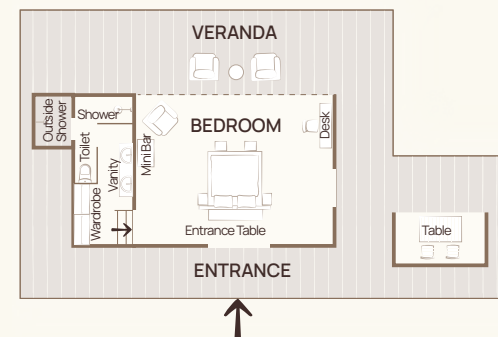

### 1 x family tented suite

Comprising 2 tents: a tented suite and a children's annex each with an en suite bathroom and a wooden walkway connecting them.

Double (main bedroom), children's side: twin or triple

Extra bed available upon request, only for children under the age of 15

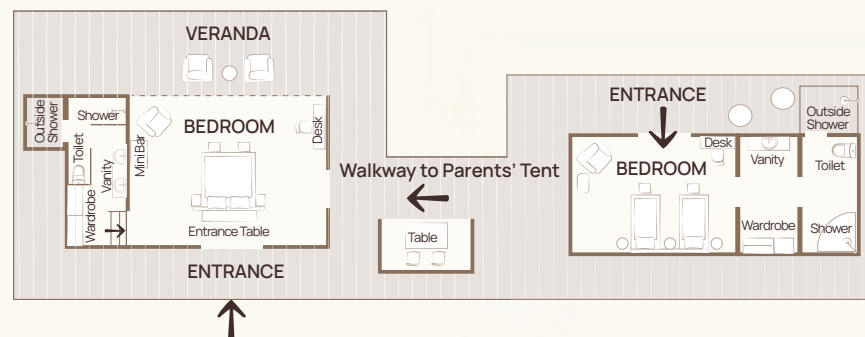

### Children policy

Children 4 years and older are welcome. If the lodge is booked exclusively, all ages are welcome.

Children 14 years and older can stay in their own room.



### Living area and boma

The main lodge has shared lounge areas and two outdoor boma areas featuring a central firepit.

### Dining

Private tables in rotating settings for breakfast, lunch, and dinner.

### Swimming pool

Pool and lounging deck.

### Fitness

Well-equipped gym plus in-room yoga mats available.

### Lodge spa

The spa facilities comprise a treatment room and shower. A range of treatments are available at an additional cost.

### Electricity and plug points

Solar-powered USB charging and multiplug facilities are available in tented suites and main areas. There is a backup generator.

### Wi-Fi

Complimentary Wi-Fi available in the main areas and tented suites.

### Mobile reception

Limited mobile reception depending on your mobile provider and location.

### Payment facilities

Credit card machines are available, as well as a secure online payment portal. Visa and Mastercard accepted.

### Security

As there are no fences and wildlife can pass through the lodge at will, the lodge is patrolled around the clock by askaris (guards) to ensure your safety. Guests are escorted by askaris at night.

### Safari boutique

Shop bespoke gifts, jewellery, and clothing in our lodge boutique.

### Disabled access

The lodge is not wheelchair-friendly due to its setting and the presence of stairs throughout the property.

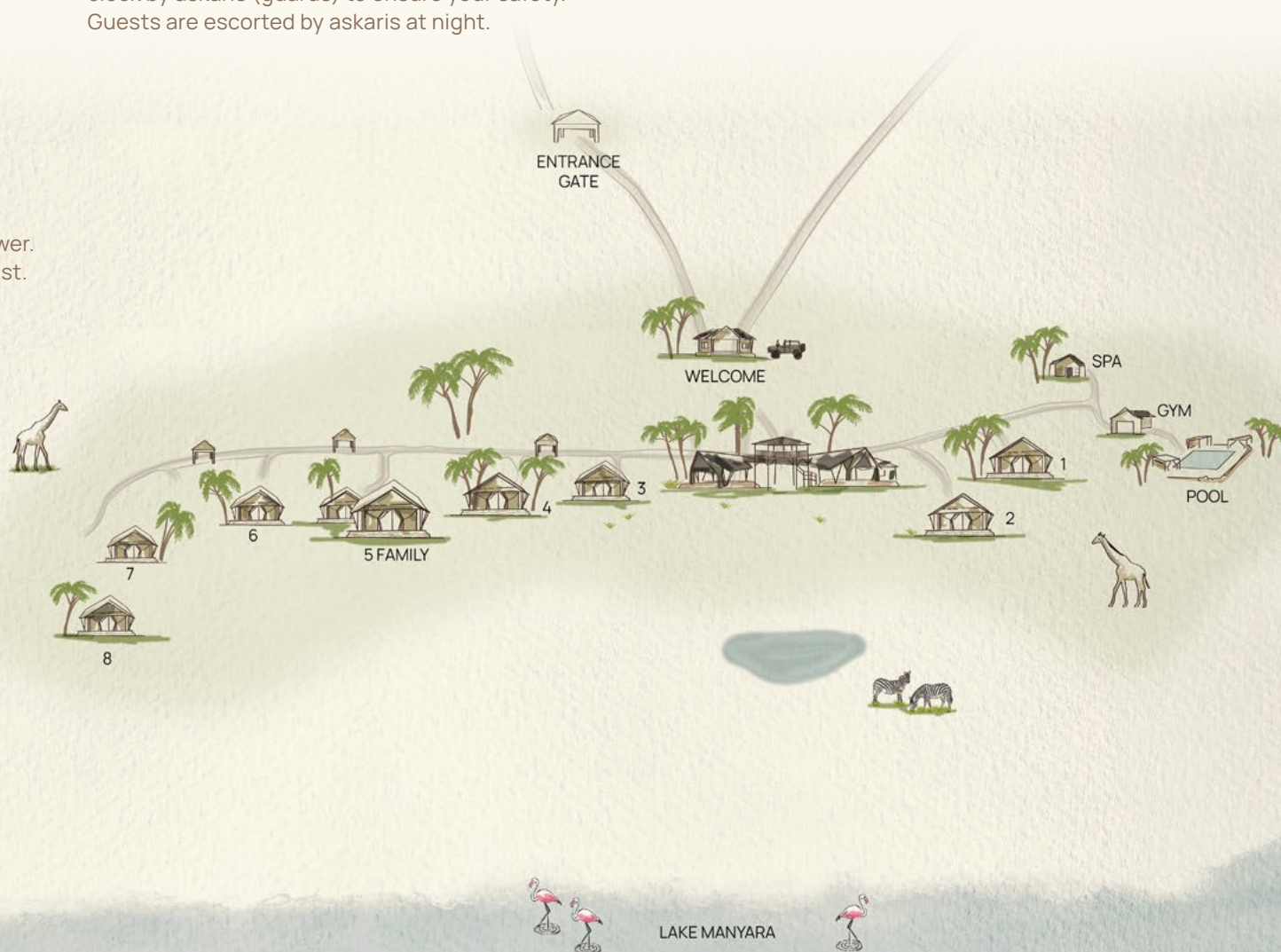





### Breakfast

Enjoy your choice of continental-style fresh fruits, cereals, homemade yoghurt, and freshly baked pastries. We also offer a selection of hot breakfasts.

### Lunch and dinner

Lunch and dinner is a 3-course à la carte menu. Ponya: Our specially designed 'Ponya' (meaning 'to heal' in Swahili) breakfast, lunch and dinner menus spotlight health-centric dishes made from nutrient-rich, freshly sourced ingredients (including herbs from our garden).

### Al-fresco dining

Enjoy lunch, dinner or sundowners in the lodge's al fresco dining areas or the privacy of your tented suite's verandah (weather dependent).

### Picnics

Picnic breakfasts or lunches can be packed in hampers for full-day activities. We also pack hampers for morning coffee stops and sundowners.

### Drinks

House wines, local beers and spirits, soft drinks, bottled water, and hot drinks are included. Connoisseur wine and French Champagne are available at an additional cost.

### Maisha Marefu wellness shots

Our 'Maisha Marefu' (meaning long life in Swahili) wellness shots are designed to offer a range of health benefits, from general well-being, digestion and boosting energy to blood sugar maintenance and a good night's sleep.

### Dietary requirements

We cater to an array of allergies and dietary preferences (Kosher not catered to). Please inform us of them prior to arrival.

### Bush breakfast

Gather for a bush breakfast beneath the dappled shade of a 3,000-year-old baobab tree. Enjoy a steaming hot drink and sit at the table, where you'll be served a hot breakfast cooked on-site by our chefs.

### Bush dinner

Swap the lodge setting for an intimate lantern-lit dinner in the bush. Here, you'll swap stories around the campfire before tucking into a special multi-course Middle Eastern-inspired feast cooked on-site in our bespoke mobile Land Rover kitchen. Included in stays of 4 nights or more or available at an additional cost. We cater to an array of allergies and dietary preferences. Please inform us of them prior to, or on arrival.

### The Eagle's Nest

Enjoy a delicious meal against the backdrop of views stretching to Lake Manyara's shores from our elevated 'Eagle's Nest' dining platform.

### The Termite Mound

An intimate dining experience that takes place in the warm glow of lanterns placed in the crevices of a large termite mound.

### Falling Star Dining

A beautiful dining experience bathed in glittering lantern light and set beneath the star-topped night sky.







### Private guide and vehicle

Each booking includes a private guide and an open safari vehicle (up to 8 seats).

### Game drives (day and night)

Set off on game drives to explore our exclusive-use protected wildlife area or Tarangire National Park with your private guide and vehicle. Night game drives are only available in our exclusive-use protected wildlife area.

### Day trips

Day trips to Tarangire and Lake Manyara national parks as well as the Ngorongoro Crater Conservation Area are available at an additional cost (closed vehicle). Pre-booking is required.

### Sundowner on the shores of Lake Manyara

End your day on a high note with sundowners on the shore of Lake Manyara. Take a moment to reminisce about your time in the Tanzanian wilderness as you sit, drink in hand, and watch the sun paint the sky shades of pinks and oranges as it sinks behind the escarpment.

### Silent walk

Foster a deeper connection with the land on a silent walk through the wilderness, letting your senses take control as you soak up the sights, smells and sounds of nature. Break the silence over a traditional baobab drink with your Maasai guide.

### Nature walk

Set off on a morning or late afternoon walk with your Maasai guide, tapping into their endless knowledge of the landscape and wildlife, before ending with a delicious bush breakfast or sundowners on the shores of Lake Manyara.

### Power walk

Invigorate yourself with a revitalising 6-10km walk through the wilderness with your Maasai guide.

### Run with a Maasai warrior

Get blood pumping as you join a Maasai warrior on an invigorating run across the plains for a one-of-a-kind fitness experience.





### Maasai village visit

Visit a Maasai village for an interactive and engaging glimpse into this proud culture. Learn about the Maasai way of life and share experiences and stories.

### Barabaig boma visit

Explore Tanzania's rich cultural heritage through an interactive visit to a nearby Barabaig boma. Immerse yourself in the Barabaig's pastoral way of life, learning about their vibrant traditions and culture.

### Maasai Blessing Ceremony

Be united in a traditional Maasai 'celebration of togetherness'. Dress in traditional clothing and experience a moving ceremony led by Maasai elders who perform ancestral prayers and songs. Available at an additional cost. For more information, please enquire with our reservations team.

#### Intimate Maasai Blessing

Includes roses, prosecco, and a Maasai choir of 15.

#### Grand Maasai Blessing

Includes roses, French Champagne, and a Maasai choir of 40.

### Maasai Choir

Whether a child's birth, a wedding, or a rite of passage, traditional celebrations with song and dance are integral to Maasai culture. Join us for a vibrant Maasai celebration and listen in awe as the community choir brings their rich culture and stories to life through song.

### Hot air balloon trips

Rise with the dawn and glide over the tops of acacias and ancient baobabs as the sun climbs the sky. Available at an additional cost. Enquire for more information.

### Children's activities

Chem Chem Lodge offers a selection of interactive and engaging activities to keep your children entertained.

- Beading and making a bracelet with Maasai women.
- Decorate safari-themed biscuits.
- Arts and crafts.
- Board games.

### Scenic helicopter flights

Take to the skies to explore the Tanzanian wilderness from above. Enquire for more information on trips and rates. Booking prior to arrival is essential.



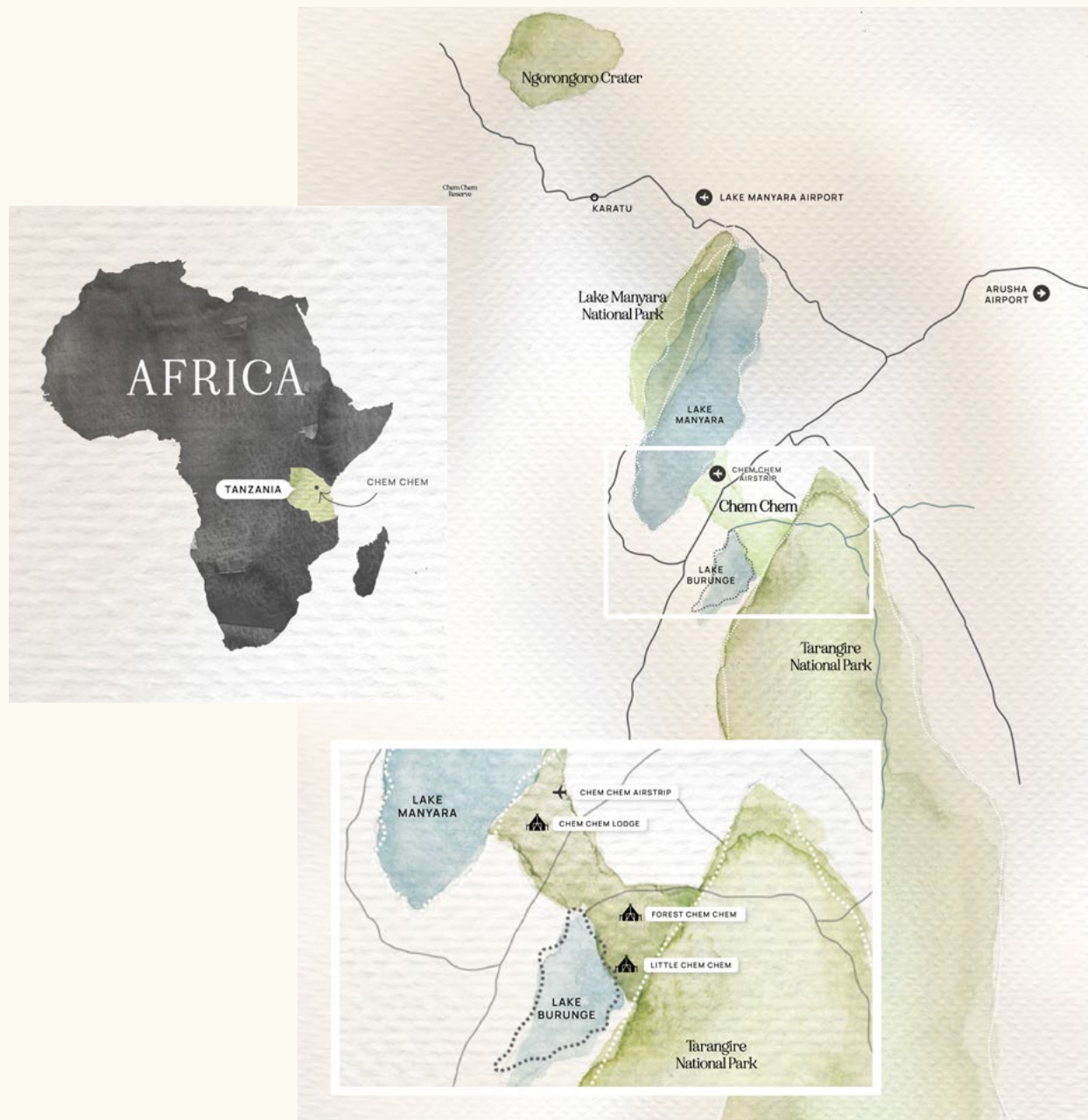

## Location

Chem Chem Lodge lies on the northwestern part of our exclusive-use protected wildlife area (4000ha), adjacent to Lake Manyara.

## GPS coordinates

03° 44' 46" S 35° 50' 38" E

## Access and transfers

±10 minutes' drive to/from Chem Chem Lodge — arrival and departure transfers included.

### Chem Chem Airstrip

If, for any reason, the aircraft is unable to land on Chem Chem Airstrip (such as weather, flooding, earth tremours, etc.), we will divert flights to Lake Manyara Airstrip or Kuro Airstrip and transfer you by road at no additional cost.

### Kilimanjaro International Airport

±3 hours' drive to/from Chem Chem Lodge — arrival and departure transfers not included. Road transfers to/from Kilimanjaro depend on flight times. Please enquire for recommendations.

### Arusha Airport

±2 hours' drive to/from Chem Chem Lodge — arrival and departure transfers not included.

### Lake Manyara Airstrip

2 hours' drive to/from Chem Chem Lodge — arrival and departure transfers not included.

When departing Tanzania, we recommend booking a road transfer to Kilimanjaro International Airport (JRO) to control your arrival time at the airport and connect you with your outbound flight. Alternatively, you can book a road transfer to Chem Chem Airstrip, where you can catch a flight to JRO, depending on connecting flight times. Enquire for recommendations based on flight times.

## Opening dates

The lodge is open year-round, with the exception of a short break between 1 April and 14 May.

## Check-in: 14h00 | Check-out: 11h00

Early check-in is subject to availability. Late check-out can be requested; however, additional charges will be levied. Please arrange for all arrivals and departures to coincide with check-in and check-out.





TRAVEL VISA

Visas are required for most countries. Please review visa arrangements, requirements, and e-services prior to arrival by visiting the Tanzanian Immigration Department’s website.

MEDICAL INSURANCE

We highly recommend that you obtain medical insurance before arrival, with a policy cover including emergency airlift evacuation.

CURRENCY

USD, GBP, EUR, CHF, and Tanzanian shillings are accepted.

Weather

Warm, temperate climate year-round.

	Jan - Mar	Apr-Jun	Jul-Sep	Oct-Dec
Average day	29°C / 84°F	26°C / 79°F	25°C / 77°F	29°C / 84°F
Average night	17°C / 63°F	16°C / 61°F	14°C / 57°F	17°C / 63°F

Rainfall

Chem Chem is located in a relatively dry area, and water can be scarce. The short rains are from November to early December, and the long rains are from April to May. The long dry season is from June to November.

*Please note*

MALARIA

Protection recommended – seek advice from your doctor before travelling.

YELLOW FEVER

A Yellow Fever certificate is not required for Tanzania but may be required if travelling via neighbouring countries.





## *Commitment to conservation*

Chem Chem Safari is committed to protecting the greater Tarangire ecosystem for future generations. This ecologically important area is home to the Kwakuchinja Wildlife Corridor, a critical migratory route linking the Tarangire and Manyara national parks. Due to decades of overgrazing, poaching and deforestation, the Corridor had been declared 'abandoned' by the Tanzanian government. Today, the Corridor's ecosystem is thriving thanks to over a decade and a half of tireless conservation work by our non-profit organisation, the Chem Chem Association (CCA).

Established in 2008, CCA works to preserve this vital ecosystem and the communities that share the land with us through a combination of conservation projects, including anti-poaching, wildlife monitoring and habitat management, as well as community empowerment initiatives.

The path to sustainable conservation lies in uplifting our communities through education and training in alternative income-generating pathways. In doing this, we highlight how protected wildlife areas such as ours can help community members make better lives for themselves and their families, which, in turn, incentivises wildlife protection.