



KISAWA SANCTUARY

## Rates

1 April 2026 – 31 March 2027





## The Kisawa Guest Experience – All Inclusive

THE KISAWA GUEST EXPERIENCE	MINIMUM OCCUPANCY (ADULTS)	CHILDREN MAXIMUM PER RESIDENCE	STANDARD RATE	PEAK SEASONS	FESTIVE RATE
			12 APR – 19 JUN 2026 30 AUG – 16 OCT 2026 08 NOV – 18 DEC 2026 10 JAN – 19 MAR 2027	1 APR – 11 APR 2026 20 JUN – 29 AUG 2026 17 OCT – 07 NOV 2026 20 MAR – 31 MAR 2027	19 DEC 2026 – 09 JAN 2027
			<i>Per person /night:</i>	<i>Per person /night:</i>	<i>Per person /night:</i>
One-Bedroom	2	1	€2,785	€3,000	€3,230
One Bedroom <i>Solo Traveler</i>	1	1	€4,570	€5,000	€5,460
One-Bedroom <i>with Annex</i>	3	1	€2,460	€2,605	€2,740
Two-Bedroom	4	2	€2,665	€2,820	€3,025
			<i>Residence /night:</i>	<i>Residence /night:</i>	<i>Residence /night:</i>
Kisawa Residence • Two-Bed	1–4	2	€12,300	€13,120	€13,735
Three-Bedroom	1–6	3	€15,375	€16,100	€16,915
Minimum stay			2 nights	3 nights	5 nights
Extra bed per night			€460	€460	€460

Subject to 17.6% hotel tax and 10% service charge. All prices are in EUR.  
\*Children aged 0 – 12: free of charge. Children aged 13 – 17: €460.



### INCLUDED IN

#### The Kisawa Guest Experience Rate

- **Private Residence**, including a **private pool** and day area
- **Dedicated service team** and personalised butler service
- **Culinary experiences** across all Kisawa dining venues & in-Residence, including all meals, soft beverages, curated house wines and cocktails served at the Main Terrace, Cove Mussassa and Baracca
- Complimentary laundry and unpacking/packing services
- Tailor-made **honorary bar**
- Signature amenities and complimentary WiFi
- Dedicated Kisawa **electric Mini-Moke** for you to drive or be driven in
- **Iyashi Dome Welcome Treatment** for 60 minutes at the Natural Wellness Center (NWC). For children 14 and under, a 30-minute adaptation will be offered (this experience is non-transferable).
- **Nature powered water sports**: sea kayaking, stand-up paddleboarding, and beach snorkelling
- Select **Kisawa Adventures**: sunset sailing on the Kisawa dhow, island tours (walking and/or 4x4), nature hikes, beach football, dune and sunset cocktails, rock fishing, and tchuva (subject to weather conditions)
- For stays of 7 nights or more, complimentary shared return **helicopter transfers** are provided between VNX Airport and the Kisawa Helipad. Timing is subject to the service provider\*

### ADDITIONAL

#### Chargeable Guest Adventures Includes

- All return Vilankulos airport (VNX) transfers by helicopter are at an additional charge of €620 EUR per person, including service and taxes\*.
- **Vintage wine and cigars from the house cellar, the Wine Room**
- Additional **massages and treatments** at the Natural Wellness Centre, as well as comprehensive wellness packages
- Private yoga courses
- Kisawa Experiences including moonlight celebration and sunset on red dune
- Select **boat excursions, PADI diving, kite surfing, horse riding and helicopter safaris**
- **Babysitting** and extended children activities

\*The helicopter transfer is shared. Private helicopter transfer: €2500 round-trip for up to 4 guests, additional passengers in 6-seater is at €500 per person (6 guests maximum). Private transfers are available for an additional cost. Luggage/weight restrictions apply.



KISAWA BESPOKE OFFER

## Early Bird

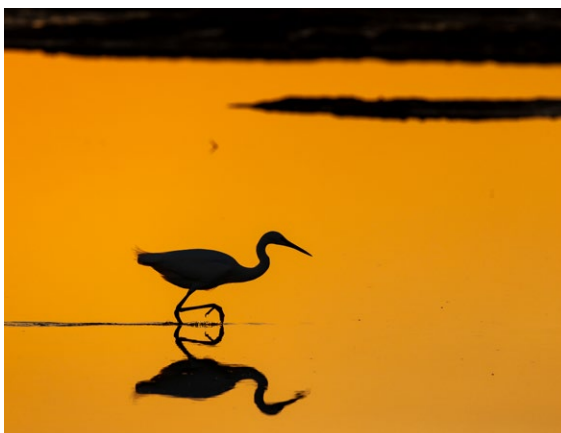

ABOUT

### Early Bird

**20% discount**

Applies to reservations made at least  
**4 months (122 days) in advance**

Full, non-refundable, pre-payment at time of booking





#### KISAWA BESPOKE OFFER

### Island Time



#### ABOUT

### Island Time

#### 4 nights pay 3

Offer can be repeated  
(e.g., stay **8 nights, pay 6**)

For bookings made by January 31<sup>st</sup> 2026

Standard payment and cancellation policy

Black-out dates: Festive Season (19 December 2026 – 9 January 2027)





KISAWA BESPOKE OFFER

## Mozambique Calling



ABOUT

### Mozambique Calling

**5 nights pay 4**

Offer can be repeated  
(e.g., stay **10 nights, pay 8**)

Standard payment and cancellation policy

Black-out dates: Festive Season (19 December 2026 – 9 January 2027)





#### KISAWA BESPOKE OFFER

### Honeymoon



#### ABOUT

### Kisawa Honeymoon

Stays **up to 4 nights or during the Festive Season** (19 December 2026 – 9 January 2027)\*:

- 60-minutes private meditation & sound healing ritual at the Natural Wellness Center

**Stays of 5 nights or more all year round except during the Festive Season** (19 December 2026 – 9 January 2027):

- 5 nights pay 4
- 60-minutes private meditation & sound healing ritual at the Natural Wellness Center
- Private moonlight dinner
- One Cinema night in the privacy of the guests' residence
- Not combinable with other offers

\*Honeymooners are kindly asked to share their newlywed status by marriage license or certificate during the booking process





## Terms & Conditions

- All rates are subject to an additional 17.6% Hotel Tax and 10% Service Charge
- Confirmation of the reservation means acceptance of Kisawa's payment and cancellation policy. Kisawa reserves the right to release the booking without prior notice if payments are not received in due terms
- Kisawa recommends guests purchase a travel insurance prior to confirming a reservation

### CANCELLATION POLICY NON-FESTIVE SEASON

#### Reservations up to three Residences:

- 30% charge between the date the booking is confirmed and 41 days prior to arrival
- 100% charge for cancellation made from 40 days before arrival onwards and in case of no-show or early departure

#### Reservations of four Residences or more and in case of Exclusive Use of the property:

- 30% charge between the date the booking is confirmed and 121 days prior to arrival
- 60% charge between 120 and 41 days before arrival
- 100% charge for cancellation made from 40 days before arrival onwards and in case of no-show or early departure

### PAYMENT POLICY NON-FESTIVE SEASON

#### Reservations up to three Residences:

- A non-refundable 30% deposit is required to confirm the reservation and payable within 7 days from the date the booking is confirmed
- 70% balance is required 40 days before the scheduled arrival date

#### Reservations of four Residences or more and in case of Exclusive Use of the property:

- A non-refundable 30% deposit is required to confirm the reservation and payable within 7 days from the date the booking is confirmed
- Second 30% deposit is required 120 days before the scheduled arrival date
- 40% balance is required 40 days before the scheduled arrival date

### CANCELLATION POLICY FESTIVE SEASON

#### Reservations up to three Residences:

- 50% charge between the date the booking is confirmed and 61 days prior to arrival
- 100% charge for cancellation made from 60 days before arrival onwards and in case of no-show or early departure

#### Reservations of four Residences or more and in case of Exclusive Use of the property:

- 50% charge between the date the booking is confirmed and 121 days prior to arrival
- 75% charge between 120 and 61 days before arrival
- 100% charge for cancellation made from 60 days before arrival onwards and in case of no-show or early departure

### PAYMENT POLICY FESTIVE SEASON

#### Reservations up to three Residences:

- A non-refundable 50% deposit is required to confirm the reservation and payable within 7 days from the date the booking is confirmed
- 50% balance is required 60 days before the scheduled arrival date

#### Reservations of four Residences or more and in case of Exclusive Use of the property:

- A non-refundable 50% deposit is required to confirm the reservation and payable within 7 days from the date the booking is confirmed
- Second 25% deposit is required 120 days before the scheduled arrival date
- 25% balance is required 60 days before the scheduled arrival date





## One-Bedroom Residence (x3)

Bespoke interiors featuring a generous living room, king bedroom, two dressing rooms and a joint bathroom.

Turquoise Cove views.

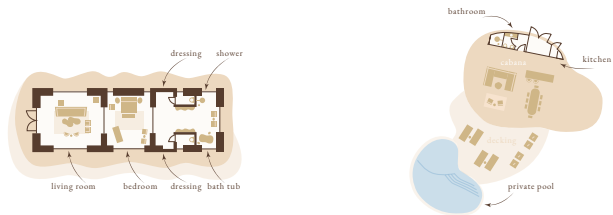

**INTERIOR:**  
150 m<sup>2</sup>

**DAY AREA:**  
165 m<sup>2</sup>

**RESIDENCE PLOT:**  
1 acre

**DECK SPACE:**  
630 m<sup>2</sup>

**POOL:**  
54 m<sup>2</sup>

**CAPACITY:**  
2 adults



**INCLUDED IN  
Your Experience**  
Dedicated Service Team  
Electric Mini Moke



## One-Bedroom Residence *with Annex* (x1)

The same dimensions and features as the One Bedroom Residence, this accommodation includes an additional self-contained annex.

The annex is suitable for young children, support personnel or older children looking for a level of independence. With a choice of twin beds or a king bed, the annex features one dressing room and one bathroom with shower and bathtub. The annex and main bungalow are connected via a joint open-air deck and share the same pool and day area with an outdoor living room, an outdoor shower and an infinity pool.

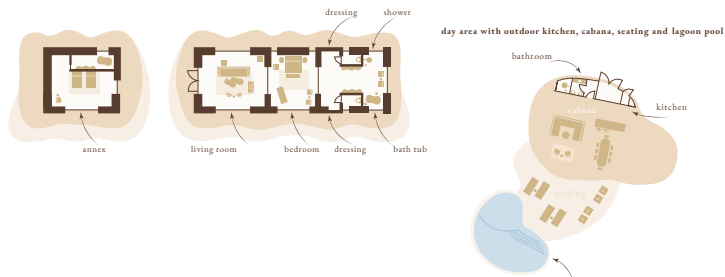

**INTERIOR:**  
210 m<sup>2</sup>

**DAY AREA:**  
165 m<sup>2</sup>

**RESIDENCE PLOT:**  
1.25 acre

**ANNEX:**  
60 m<sup>2</sup>

**DECK SPACE:**  
370 m<sup>2</sup>

**POOL:**  
54 m<sup>2</sup>

**CAPACITY:**  
3 adults





## Two-Bedroom Residence (x2)

Two bungalows are connected via an open-air deck, with each bungalow featuring bespoke interiors, a generous living room, a king bedroom, two dressing rooms and a joint bathroom.

Turquoise Cove views.

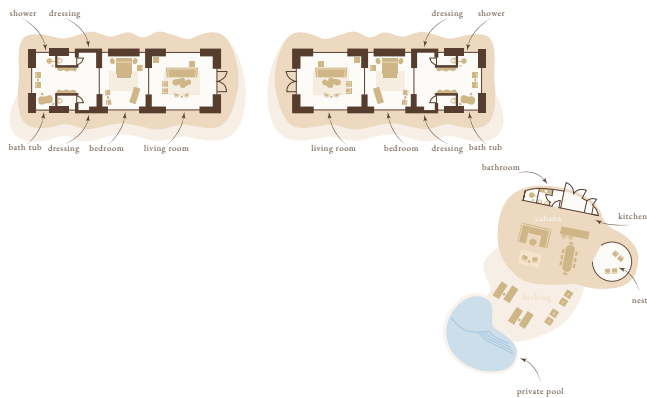

<b>INTERIOR:</b> 300 m <sup>2</sup>	<b>DAY AREA:</b> 210 m <sup>2</sup>	<b>RESIDENCE PLOT:</b> 1.75 acre
<b>DECK SPACE:</b> 492 m <sup>2</sup>	<b>POOL:</b> 54 m <sup>2</sup>	<b>CAPACITY:</b> 4 adults



## Kisawa Residence (x1)

Two bungalows are connected via an open-air deck, with each bungalow featuring bespoke interiors, a generous living room, a king bedroom, two dressing rooms and a joint bathroom.

The founder's residence comes with a unique view of both the ocean and cove sides of the island, a larger private plot and includes personal touches such as a pan-African antiques & art collection.

Turquoise Cove views.

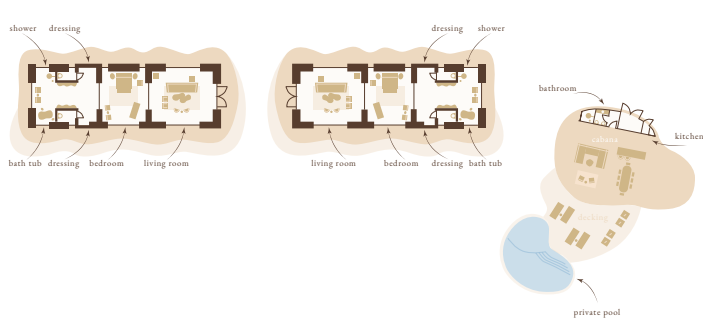

<b>INTERIOR:</b> 300 m <sup>2</sup>	<b>DAY AREA:</b> 210 m <sup>2</sup>	<b>RESIDENCE PLOT:</b> 2.25 acre
<b>DECK SPACE:</b> 492 m <sup>2</sup>	<b>POOL:</b> 54 m <sup>2</sup>	<b>CAPACITY:</b> 4 adults



## Three-Bedroom Residence (x1)

Three individual bungalows, each featuring bespoke interiors, generous living rooms, king bedrooms, two dressing rooms and two bathrooms.

Two bungalows are connected by an open air deck, with the third bungalow positioned close by and easily accessible by a connecting footpath over white sand.

Turquoise Cove views.

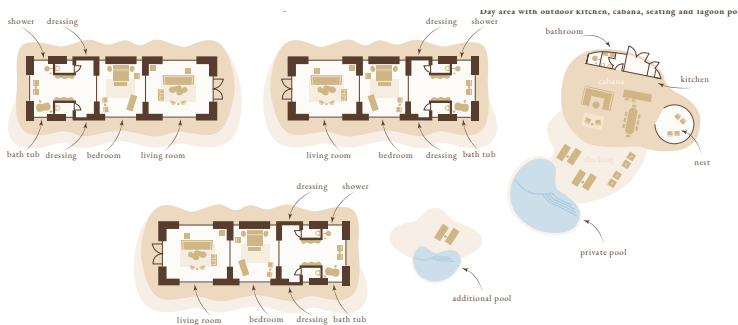

<b>INTERIOR:</b> 450 m <sup>2</sup>	<b>DAY AREA:</b> 375 m <sup>2</sup>	<b>RESIDENCE PLOT:</b> 2.5 acre
<b>DECK SPACE:</b> 800 m <sup>2</sup>	<b>POOL:</b> 108 m <sup>2</sup>	<b>CAPACITY:</b> 6 adults



RESERVE YOUR  
**Island Holiday**



**KISAWA**  
MOZAMBIQUE

+971 4 875 2323  
[reservations@kisawasanctuary.com](mailto:reservations@kisawasanctuary.com)