



5BEYOND

DISCOVER

The Serengeti



The land of the endless plains



A UNESCO World Heritage Site and home to the famed Great Migration, the largest annual movement of wildebeest and other herbivores across the Greater Serengeti-Mara ecosystems, the Serengeti National Park is one of the most remarkable wildlife spectacles on earth.



DISCOVER THE SERENGETI

Why visit the Serengeti?

World-renowned for its vast open grasslands and exceptional wildlife sightings, Tanzania's magnificent Serengeti National Park boasts over 35 species of plains game, as well as prolific birdlife.



1

HOME TO THE GREAT WILDEBEEST MIGRATION

Of all the documented animal movements, East Africa's Great Migration is by far one of the world's most famous, sought-after and photographed wildlife events. It is the astounding, never-ending natural trek of millions of hungry herbivores across the limitless plains of Kenya's Masai Mara and Tanzania's Serengeti that keeps the world engaged.



2

A TAPESTRY OF ENDLESS SAVANNA PLAINS

Known as Siringit, the Maasai word for 'endless plains' or 'the place where the land runs forever', the vast ecosystem of the Serengeti is famous for its untamed landscapes of open grasslands, wooded hills, riverine and acacia forest, mountains and savanna which allow for excellent sightings of abundant wildlife.



3

A CELEBRATED AFRICAN UNESCO WORLD HERITAGE SITE

Large prides of lion, teeming multitudes of wildebeest, zebra, eland and gazelle, as well as the infinite expanses of open grasslands combine to form the most powerful and alluring vision of Africa. Surrounded by rich history, immerse yourself in the culture, meeting the Maasai people or visiting Olduvai Gorge and Lake Victoria.



4

RENOWNED BIG FIVE GAME RESERVE

This vast park offers an extraordinary diversity of ecosystems and wildlife sightings, with big herds of buffalo, elephant, lion, leopard and black rhino throughout the park. Further to the Big Five are the unique species that can only be seen in certain areas, such as topi and black-and-white colobus monkey.

DISCOVER THE SERENGETI

Why travel with &Beyond?

1 TRAVEL WITH HEART

Our core ethos of "Care of the Land, Wildlife & People" drives all that we do. When you travel with us you make a meaningful contribution to the preservation of our world's cultures and wildlife, and leave with an opportunity to gain first-hand experience in some of our conservation and community initiatives.

2 IN OUR HANDS

We are on call 24/7 to assist you throughout your journey. Over 2 000 &Beyonders, including guides and ground logistic teams on three continents, means that you are in our hands from the moment you arrive to the moment you leave. Additionally, we offer a personal concierge service that is only a phone call away should you require any assistance at any point during your trip.

3 FINEST GUIDES

We operate three ranger training schools and are renowned for having the most highly trained, professional and knowledgeable guides, rangers, naturalists and trackers, who offer intriguing cultural insights as well as interpretive wildlife experiences.

4 TRAVEL EXPERTS

Big or small, we are all about tailoring trips around your specific interests and expectations. Our expert travel specialists are able to personalise a range of experiences for individual travellers, groups, families, wedding parties, and special interest groups.

5 PERFECT MOMENTS

With journeys lovingly crafted of perfect moments, you will return from an &Beyond adventure feeling that nothing will take your breath away quite like this ever again. Our collection of signature experiences is often exclusive to &Beyond, ensuring a unique adventure.



What an amazing safari experience in the Serengeti. Best stay ever! We highly recommend it. ”

&BEYOND GUEST

DISCOVER THE SERENGETI

Travel Tanzania and beyond

Visiting East Africa and travelling across this vast landscape requires much thought and attention. Contact your preferred travel specialist to assist with your travel plans.

GETTING TO THE SERENGETI

Coastal Aviation, Auric Air and Regional Air Services offer daily departures from Arusha and Dar es Salaam. These flight networks link all of the major parks, reserves and Beyond lodges.

Daily non-direct flights connect the same parks, reserves and Beyond lodges to Zanzibar.

Flight networks connect to the Masai Mara via two points, one via Kilimanjaro and Wilson Airport in Nairobi, and the other via Tarime and Migori.

The Serengeti, Tarangire and Lake Manyara are accessible by road from Arusha.

Flights connect to Kigali via Mwanza and to Entebbe via Musoma.

TRAVEL TIMES

ARUSHA

✈

Not advised
2hrs 40mins

✈

4hrs 30mins
30mins

✈

2hrs
20mins

✈

2hrs
20mins

✈

Not advised
3hrs 15mins

✈

2hrs 30mins
20mins

✈

Not advised
2hrs

✈

Not advised
5hrs 30mins

✈

Not advised
2hrs 30mins

SERENGETI - KOGATENDE
(FURTHEST POINT)

6hrs
1hr 25mins

7hrs
1hr 25mins

Not advised*
2hrs 15mins

Not advised
5hrs 15mins

8hrs 20mins
1hr 35mins

Not advised
4hrs 15mins

Not advised
5hrs 30mins

Not advised
4hrs 35mins

Not advised
5hrs 30mins

Not advised
4hrs 35mins

NGORONGORO

5hrs
2hrs 35mins

5hrs
35mins

Not available
2hrs

Not advised
5hrs 30mins

Not advised
2hrs 35mins

Not advised
5hrs 30mins

Not advised
5hrs 30mins

Not advised
5hrs 30mins

Not advised
2hrs 20mins

LAKE MANYARA

Not advised*
2hrs

Not advised*
3hrs 45mins

Not advised*
8hrs 25mins**

Not advised*
1hr 45mins

Not advised*
5hrs

Not advised*
2hrs 5mins

Not advised*
5hrs

Not advised*
2hrs 20mins

Not advised*
50mins

KILIMANJARO

Not advised*
2hrs 15mins

Not advised*
3hrs 50mins

Not advised*
5hrs 50mins

Not advised*
3hrs 50mins

Not advised*
2hrs 20mins

Not advised*
1hr 20mins

Not advised*
1hr 20mins

Not advised*
2hrs 5mins

Not advised*
5hrs

SELOUS GAME RESERVE

TARANGIRE NATIONAL PARK

RUAHA NATIONAL PARK

MAHALE MOUNTAINS AND
KATAVI NATIONAL PARKS

DAR ES SALAAM
AND COAST

USUNGU GAME RESERVE

IRINGA

SELOUS GAME RESERVE

MO

Malawi

Mozambique

Zambia

• MBEYA

* Poor connection due to: Layover time / no connection / peak periods only / private charter required. ** Includes flight to Manyara and 2hr road transfer time. Disclaimer: All flights may include multiple stops and scheduling is a guideline – times will vary and scheduling is coordinated mainly by operations teams on the ground. Flight schedules are more limited in off-peak periods. Above times are based on best-practice logistics and exclude transfers to and from lodges.

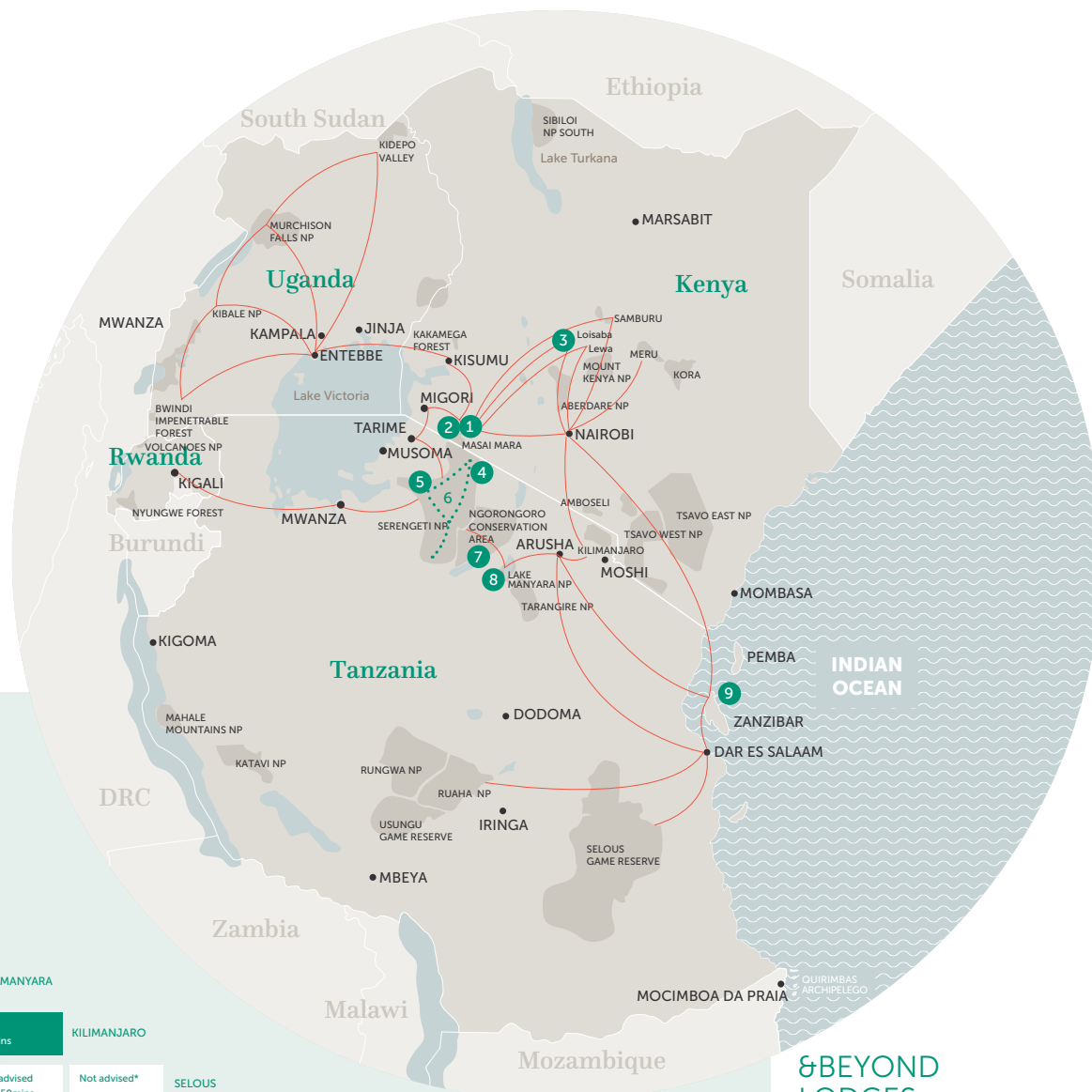

BEYOND LODGES

KENYA

- 1 Bateleur Camp
- 2 Kichwa Tembo Tented Camp
- 3 Suyian Lodge

TANZANIA

- 4 Klein's Camp
- 5 Grumeti Serengeti River Lodge
- 6 Serengeti Under Canvas
- 7 Ngorongoro Crater Lodge
- 8 Lake Manyara Tree Lodge
- 9 Mnemba Island

DISCOVER THE SERENGETI

Great Wildebeest Migration

1 ONE OF THE 7 NATURAL WONDERS OF THE WORLD

Considered the most thrilling spectacle in the animal kingdom, this epic journey migrates from Tanzania's Serengeti to Kenya's Masai Mara.

2 THE WORLD'S LARGEST OVERLAND MAMMAL MIGRATION

The annual movement of wildebeest and other herbivores across the Serengeti-Mara ecosystem consists of more than 1.5 million wildebeest, 500 000 zebra, 200 000 Thompson's gazelle and 18 000 eland.

3 THE ANIMALS MIGRATE OVER 800 KM (500 MI)

Due to the sheer size of the herd, the animals have to move to be able to survive. The herds generally follow the rain, as where there is rain, there is fresh grass. Once grass is depleted in one area, they will move to another grassy area.

It's estimated 500 000 wildebeest calves are born annually.

The annual movement of wildebeest and other herbivores across the Serengeti-Mara ecosystem is rarely the same in terms of precise timing and direction.

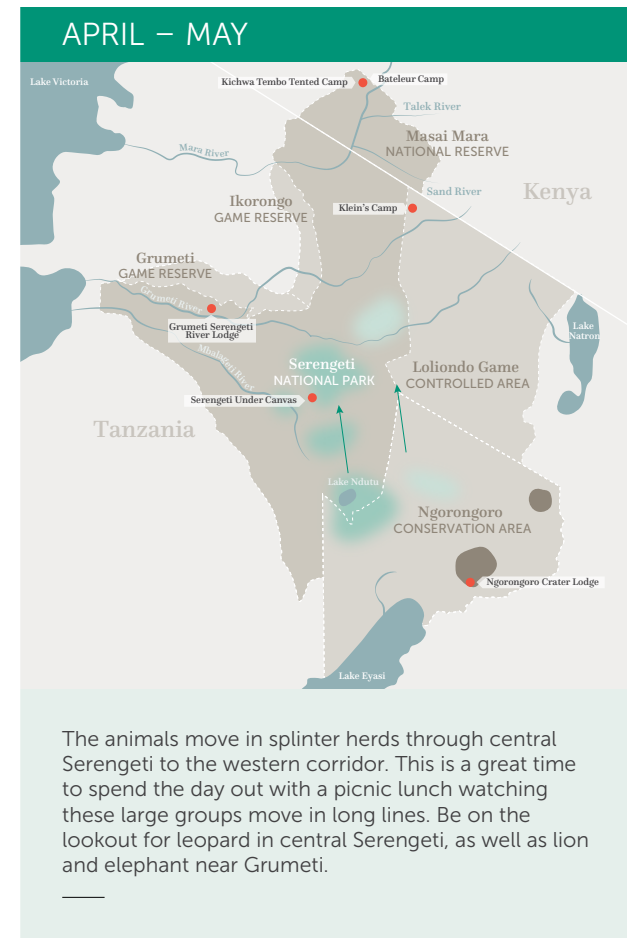
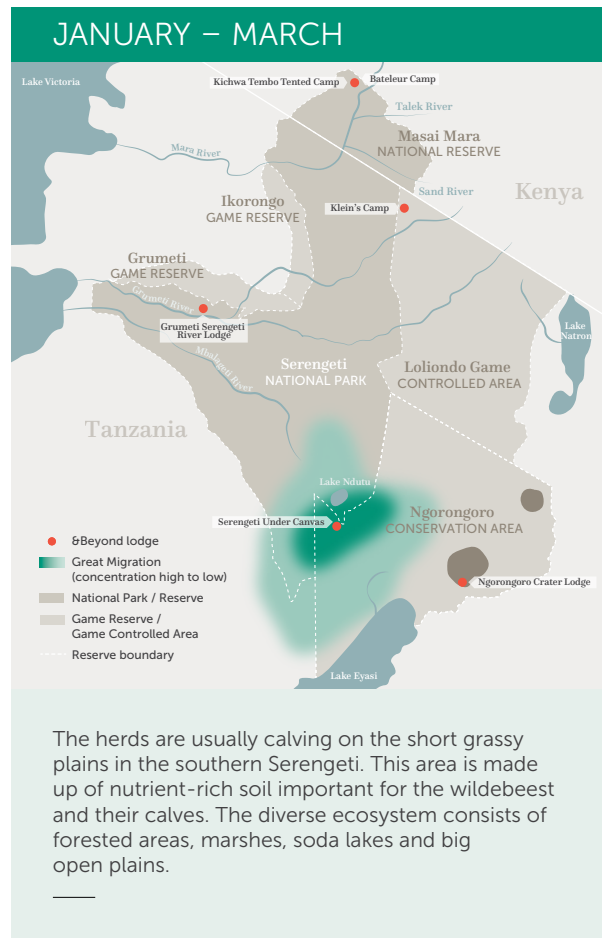

(continues on next page)

DISCOVER THE SERENGETI

Great Wildebeest Migration (cont.)

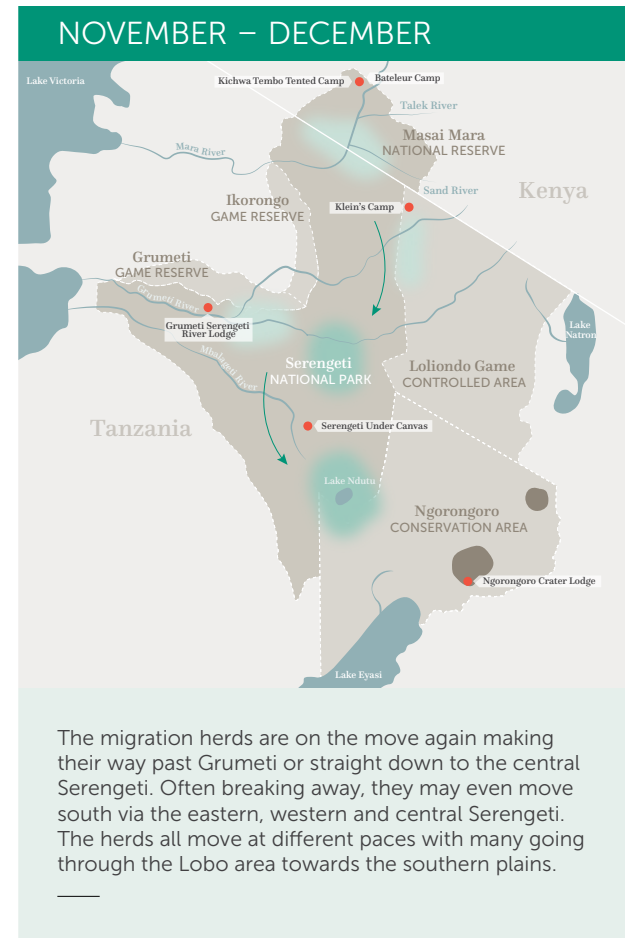
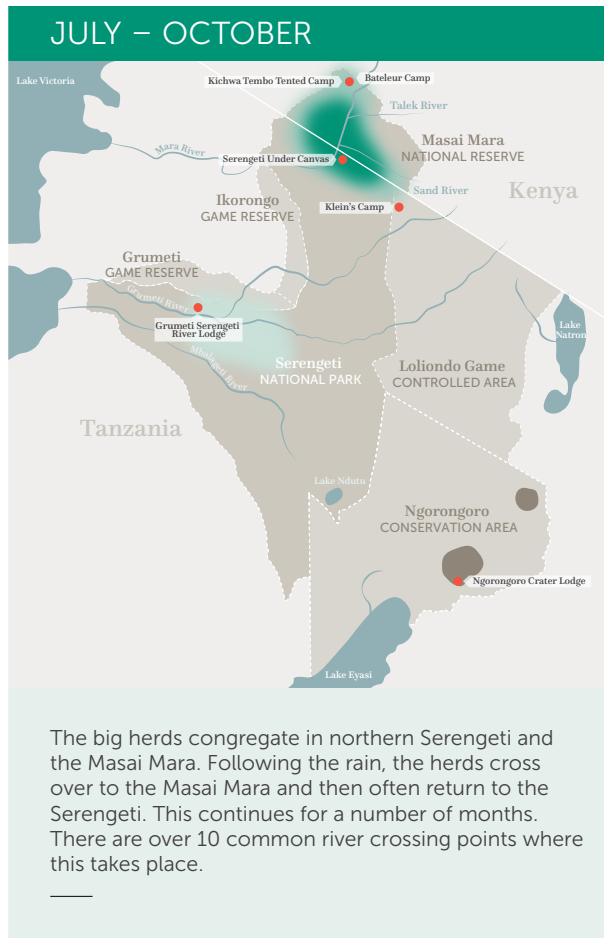
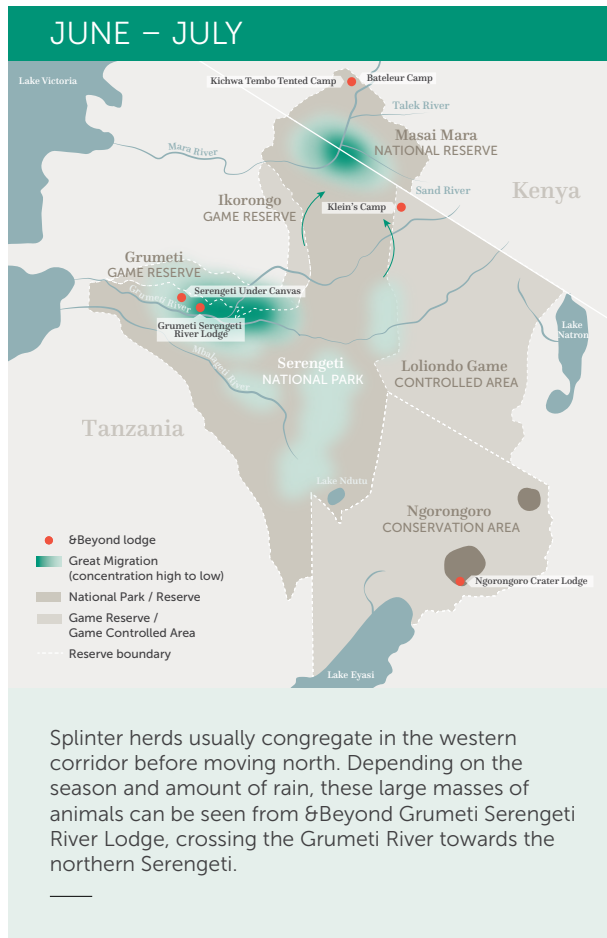

Explore the Serengeti

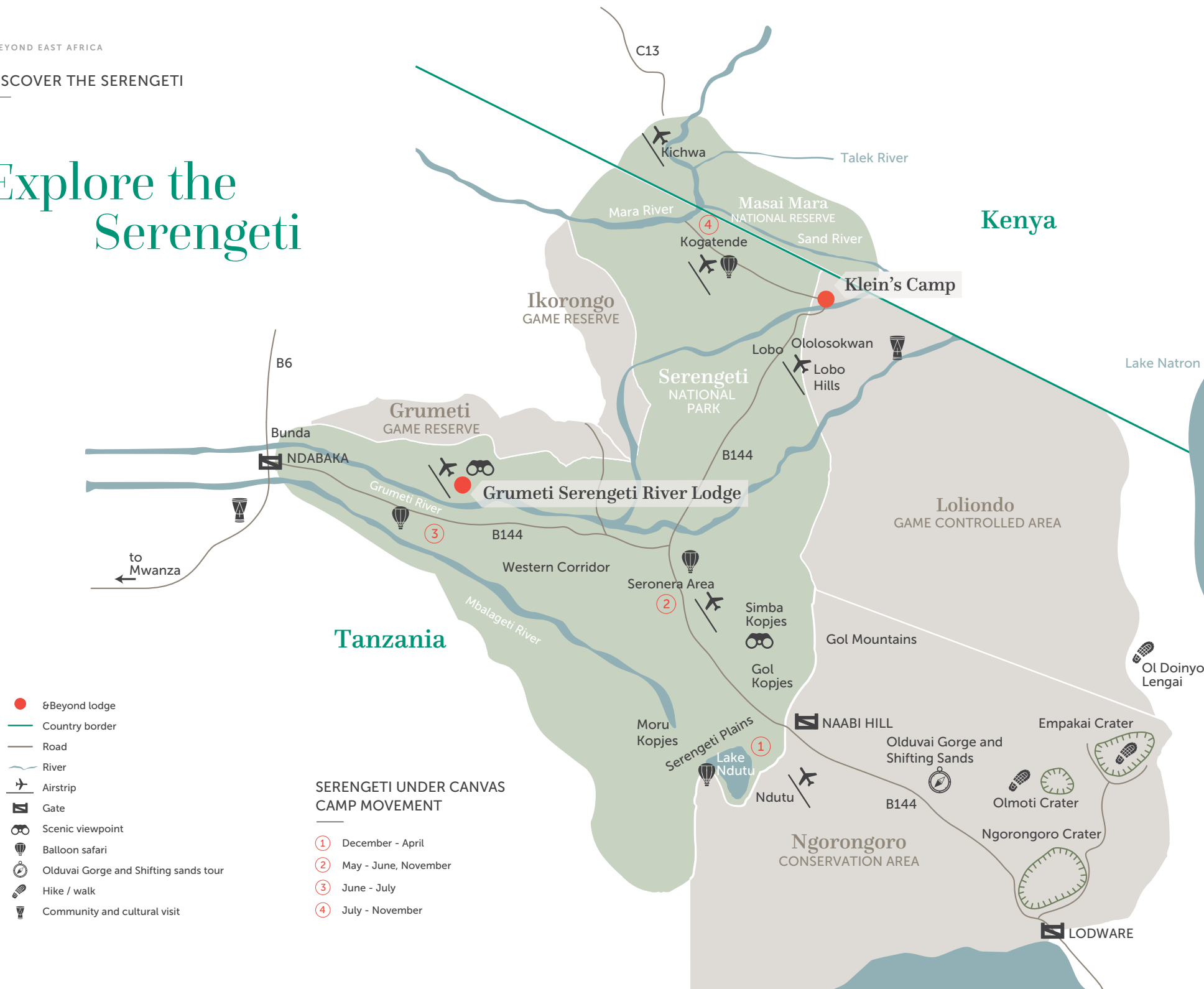

SERENGETI UNDER CANVAS CAMP MOVEMENT

- ① December - April
- ② May - June, November
- ③ June - July
- ④ July - November

DISCOVER THE SERENGETI

Regional information

	GRUMETI SERENGETI RIVER LODGE	KLEIN'S CAMP	SERENGETI UNDER CANVAS
Altitude	1 341 m / 4 400 ft	2 000 m / 6 561 ft	Approximate altitudes of area: Ndutu: 1 646 m / 5 400 ft Seronera: 1 548 m / 5 080 ft Grumeti: 1 341 m / 4 400 ft Kogatende: 1 680 m / 5 511 ft
Malaria area	The Serengeti is situated in a malaria area. Consult your medical professional for advice whether precautions need to be taken.		
Airstrip / Helipad	A number of airlines operate scheduled flights from Arusha to Grumeti airstrip each morning, followed by a 10-minute drive to the lodge Grumeti Airstrip coordinates: 2.1607°S 34.2250°E	A number of airlines operate scheduled flights from Arusha to Lobo airstrip each morning, followed by a leisurely 1-and-a-half to 2-hour drive to the camp, with game viewing en route. Lobo airstrip coordinates: 2.0104°S 35.1608°E	Dependent on current camp location
GPS coordinates	02°09.479'S 034°13.151'E	01°50.089'S 035°14.797'E	Dependent on current camp location
Best time to travel	Year-round with seasonal Great Migration	Year-round with seasonal Great Migration	Year-round, following the Great Migration
Camp closure	Open year-round	Open year-round	Open year-round
Weather	Warm to hot climate year-round due to the proximity to the equator; cool evenings		
Rainfall	Rain generally occurs in April and May and again in November		Primarily from April to May and in November. Camps follow rainfall to optimise migration sightings.
Temperature averages	Summer: 32°C / 90°F to 16°C / 61°F Winter: 27°C / 81°F to 14°C / 57°F	Summer: 29°C / 84°F to 16°C / 61°F Winter: 27°C / 81°F to 14°C / 57°F	Annual temperatures average a minimum of 15°C / 59°F and a maximum of 40°C / 104°F

We had dinner outside under the stars both nights. The staff and food was exceptional, and the view over-looking the Serengeti indescribable.

BEYOND GUEST



Sustainability initiatives

In partnership with Wild Impact*, our long-standing community and conservation development partner.



CARE OF Land

- 228 000 plastic bottles eliminated annually through on-site water bottling plants
- 684 000 litres of water saved (3 litres used to make a 1 litre plastic bottle)
- 4 265 kg plastic eliminated annually
- Zero plastic straws
- All guest amenities recyclable
- 728 000 kg CO₂ per year reduction in our Tanzanian carbon footprint since 2018
- Over 783 million TZS invested to ensure the minimum impact of our lodges



CARE OF Wildlife

- An average 2 100 community children per year receive conservation lessons, creating awareness through education
- USD 50 000 invested as a founding member of the Lionscape Coalition, a joint initiative between members of the ecotourism industry and the Lion Recovery Fund, in a collaboration dedicated to securing a future for Africa's wild lions
- USD 25 000 of the Lionscape Coalition investment has supported two powerful lion conservation programmes in Tanzania: KopeLion and the Serengeti De-Snaring Programme.



CARE OF People

- 101 Star-in-Training lodge trainees from the local community receive on-site training and workplace experience
- 78% of our Tanzania lodges' operational expenses support local procurement
- Over 1.5 billion TZS spent on community-led social infrastructure 2018 - 2020
- 124 tertiary education bursaries awarded to rural learners through Wild Impact's CLEF (Community Leaders Education Fund) programme since 2014
- Over 62.7 million TZS raised to provide COVID-19 support for rural schools and clinics



&BEYOND

DISCOVER THE SERENGETI

Lodge overview

The Serengeti National Park houses three &Beyond lodges; a mobile under-canvas camp, a classic permanent camp, and an intimate river lodge all offering unique sightings, captivating experiences and diverse ecosystems.



DISCOVER THE SERENGETI

Accommodation Overview

Our lodges in the Serengeti

The three lodges have been specifically positioned and designed to capture the essence of the Serengeti in three extremely unique areas of the park, offering not only a varied experience, but also different accommodation options.

&BEYOND SERENGETI UNDER CANVAS

&Beyond Serengeti Under Canvas camps attempt to anticipate the movements of the Great Migration, bringing guests as close as possible to the wildebeest action, as well as exploring magnificent resident game. These camps are mobile and move five times a year. When staying here you will connect to the African bush, sitting round the camp fire at night and showering under the stars.

&BEYOND GRUMETI SERENGETI RIVER LODGE

The lodge is in the remote western reaches of the Serengeti, on the banks of a tributary of the Grumeti River. Due to its far-flung location, there are very few lodges in this pristine section of the park, which means that guests can expect the ultimate in exclusivity. This secluded part of the Serengeti has large resident lion prides and an annual topi migration, making game viewing experiences exceptional.

&BEYOND KLEIN'S CAMP

Deep in a remote corner of the game-rich Serengeti National Park, a 10 000 hectare (24 700 acre) wildlife concession leased from Maasai landlords offers guests the ultimate, exclusive Tanzanian safari. Night drives and walking safaris in the private concession allow guests to explore the nocturnal world of predators or to get an intimate glimpse into the details of the African bush.



MAIN GUEST TENT AT SERENGETI UNDER CANVAS



GRUMETI SERENGETI RIVER LODGE'S GUEST AREA



KLEIN'S CAMP WELCOME



FAST FACTS

Serengeti Under Canvas

- 9 luxurious Safari Tents including a Family Tent per camp (2 camps)
- Moves 5 times a year to follow the Great Migration
- Family-friendly with WILDchild Programme
- Wi-Fi connectivity
- Light-impact, leaving nothing but footprints

Grumeti Serengeti River Lodge

- 10 Suites including a Family Suite
- Private plunge pools
- Fully equipped gym, in-room massage and Safari Shop
- Family-friendly with WILDchild Programme

Klein's Camp

- 10 Cottages including a Family Cottage
- Private concession
- Bar / Lounge with magnificent views
- Family-friendly with WILDchild Programme
- Night drives and nature walks
- Maasai and cultural experiences

DISCOVER THE SERENGETI

&Beyond Serengeti Under Canvas

Follow the wildlife theatre of Serengeti's Great Migration, in unsurpassed under-canvas luxury. Dine under an African night sky, and live the adventure. Leave only footprints.

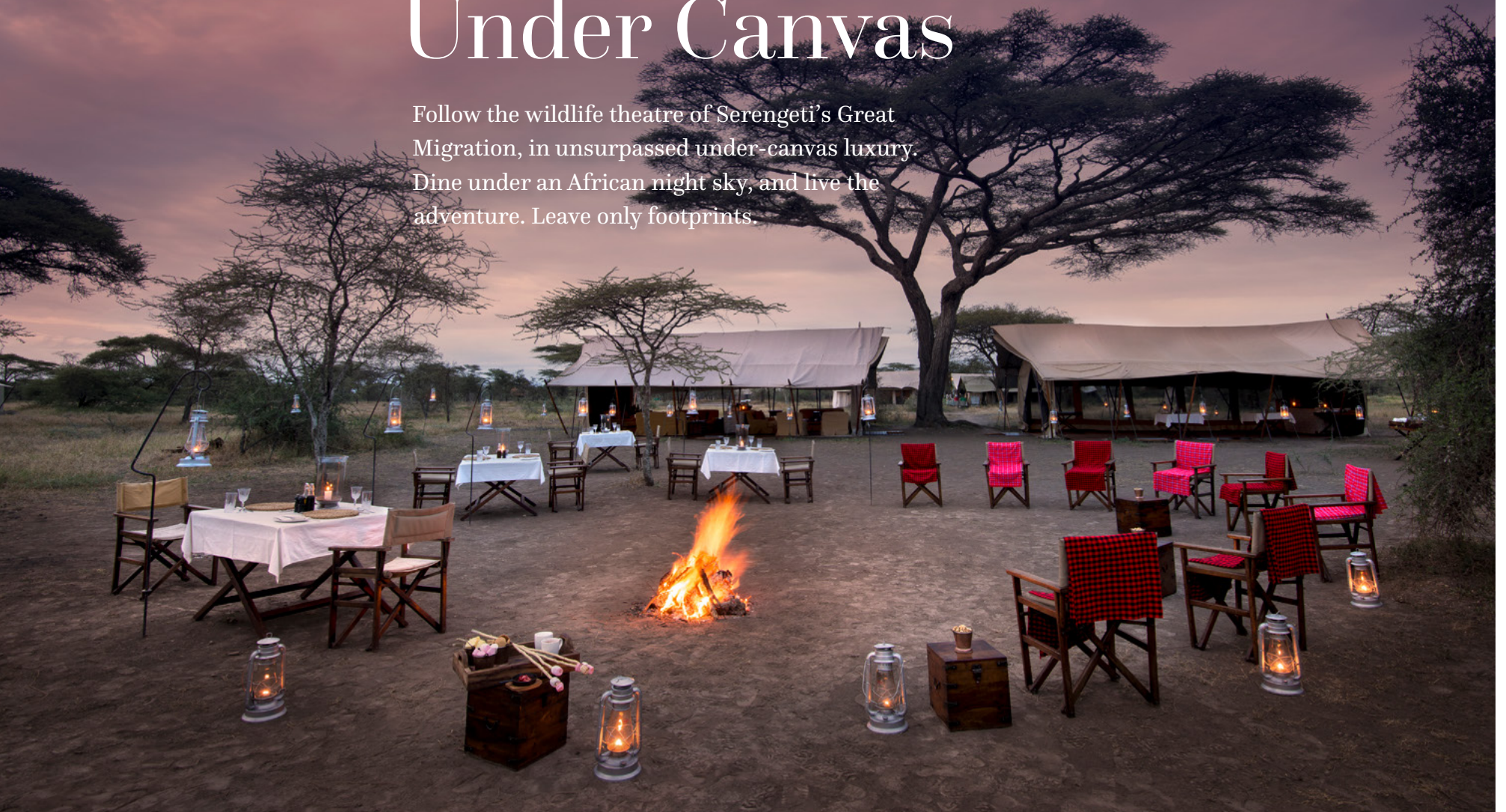

DISCOVER THE SERENGETI

8Beyond Serengeti Under Canvas

Why stay?

1 CLOSE TO THE ACTION OF THE GREAT MIGRATION

The 8Beyond Serengeti Under Canvas camps attempt to anticipate the movements of the Great Migration, bringing you as close as possible to the wildebeest action, as well as observing magnificent resident game. The campsites move five times a year providing you with the opportunity to enjoy a privately-guided Great Migration experience. Explore with our professionally trained guides, among the best in the industry and enjoy the opportunity to customise your daily game viewing activities according to your interests.

2 PRISTINE LANDSCAPES AND ICONIC WILDLIFE

The ultimate remote getaway in the midst of the vast herds. Enjoy seasonal sightings of the Grumeti and Mara River crossings in western and northern Serengeti respectively, and wildebeest calving season at Ndutu in southern Serengeti. There is exceptional resident game year-round, big cat sightings where lion and leopard are frequently seen and unique wildlife, including a topi migration near Grumeti, rhino in the north, excellent cheetah sightings in the south and big elephant herds throughout.

3 MOST LUXURIOUS TENTS IN THE SERENGETI

Old-world glamour with the elegance of classic safari. Unwind in the most extravagant mobile tents in the Serengeti, with sophisticated camping in private campsites close to the annual Great Migration. Experience the theatre and adventure of the African bush in comfort and luxury with a private butler, hot bucket shower, and crystal glassware. Enjoy evening drinks around the camp fire, before dining under the stars and falling asleep to the sounds of lions roaring.



**An out-of-this-world experience!
We ate dinner under the Milky Way
on fine China and crystal. A must
when visiting the Serengeti.**



DISCOVER THE SERENGETI

Beyond Serengeti Under Canvas Experiences

Experiences and highlights

Experience far beyond the expected in the Serengeti with adventures of a lifetime.



1

SAFARI GAME DRIVE

Game drives in the Serengeti are unforgettable due to the abundance of wildlife and the spectacular landscapes. Travellers can expect to encounter large numbers of animals year-round, with big herds of elephant, buffalo and other plains game. It is also common to see predator interaction. Game drives may last from a couple of hours to the whole day, with a picnic breakfast and lunch.



2

THE GREAT MIGRATION

The famous Great Migration is a year-round cycle in which 1.5 million wildebeest, 400 000 zebra, 300 000 Grant's and Thomson's gazelle, and 12 000 eland participate. These animals move from the dryer southern part of the ecosystem, the short-grass plains of the south eastern Serengeti, and head to the moister northern part, the northern Serengeti woodlands and the Masai Mara plains, and back again.



3

AL FRESCO DINING

Revel in the wide open landscapes of Africa as you savour a meal served outside (unless it is raining, in which case you are enjoying your meal in the dining tent). Your butler will always pick the perfect place for you, for example under a tree, next to the camp fire at night or the privacy of dinner for-two outside your tent.



4

HOT AIR BALLOON SAFARI*

Glide in a hot air balloon over the migration herds in the Serengeti on this captivating experience. Float in whichever direction the winds of the morning takes you. Marvel at the views of the sweeping plains below and wildlife dotted across the landscape. End off your experience with a delicious breakfast spread in the heart of the Serengeti plains.



5

STARGAZING

Explore the vast night sky and its stunning constellations gathered around a cosy campfire. Scan the velvet expanse and observe the northern and southern hemisphere stars in one place. Marvel at the infinite sky, which features the Big Dipper in the northern hemisphere and the Southern Cross and Pointers in the southern hemisphere.



6

OLDUVAI GORGE AND SHIFTING SANDS*

When the camp is in Ndutu, in the southern Serengeti, explore the breathtaking surrounds of the archaeological site of Olduvai Gorge, the cradle of mankind, best known as home of the earliest remains of Homo sapiens. Move on to the crescent-shaped volcanic ash dunes known as Shifting Sands, which slowly creep across the desert floor in response to prevailing winds.

DISCOVER THE SERENGETI
&Beyond Serengeti Under Canvas Experiences

Seasonal highlights

TIMING IS EVERYTHING

	JAN	FEB	MAR	APR	MAY	JUN	JUL	AUG	SEP	OCT	NOV	DEC
Big Five game viewing	✓	✓	✓	✓	✓	✓	✓	✓	✓	✓	✓	✓
Migration in the short grass plains of the southern Serengeti	✓	✓	✓	✗	✗	✗	✗	✗	✗	✗	✗	✗
Migration in the central Serengeti Plains	✗	✗	✗	✓	✓	✗	✗	✗	✗	✗	✗	✗
Migration in the Western Corridor / Grumeti River crossing	✗	✗	✗	✗	✗	✓	✓	✗	✗	✗	✗	✗
To view migration in the northern Serengeti	✗	✗	✗	✗	✗	✗	✓	✓	✓	✗	✗	✗
Migration makes the southward journey back to the Serengeti	✗	✗	✗	✗	✗	✗	✗	✗	✗	✓	✓	✓
To view baby animals and interesting predator-prey interaction	✓	✓	✓	✗	✗	✗	✗	✗	✗	✗	✓	✓
Hot air balloon safari	✗	✗	✗	✗	✗	✓	✓	✓	✓	✓	✗	✗
SEASONAL RATES*	\$\$\$	\$\$	\$\$	\$	\$	\$\$	\$\$\$	\$\$\$	\$\$\$	\$\$\$	\$\$\$	\$\$\$

* The \$ / \$\$ / \$\$\$ references are used to indicate rate variation and are not associated with specific values.

Absolutely the most exciting experience ever. Words can't express the magnificence of the landscape and animals. A bucket list trip. ”

&BEYOND GUEST



DISCOVER THE SERENGETI
&Beyond Serengeti Under Canvas

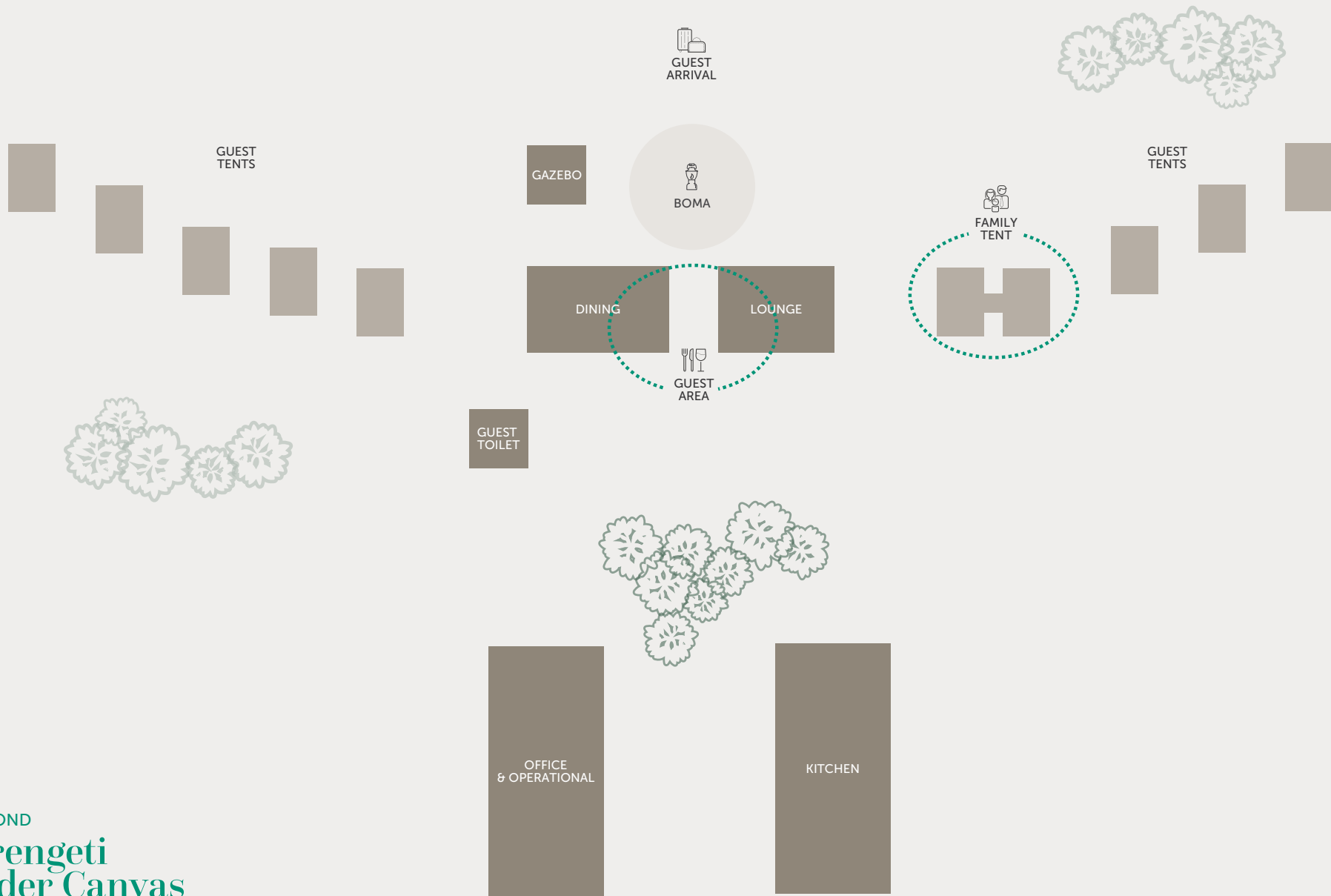

DISCOVER THE SERENGETI
&Beyond Serengeti Under Canvas

Camp overview

CAMP

Maximum number of guests	21 (per camp, including children)
Number of rooms	9 (per camp)
Family accommodation	1 Family Tent is available per camp
Pilot / Guide accomodation	Yes
Room type	Tent
Distance between rooms	Subject to camp location
Check-in / Check-out times	14h00 / 10h00

DINING

Food / Dietary options	Kosher not available. Halaal and other special dietary requests available: please book in advance
Private butler service	Yes
Private dining	Yes

PAYMENT TYPES ACCEPTED

Credit cards accepted	Mastercard and Visa
Currency	USD are widely used, however, notes dated prior to 2006 are not accepted

FACILITIES

Power	With prior notice we are able to provide 24-hour electricity for guests with special medical requirements
Wine store or cellar	No
Boma	Camp fire
Interactive kitchen	Yes
Swimming pool	No
Wellness offering	No
Fitness	No
Conference facilities	No
Wheelchair accessibility	Possible with assistance in certain cases
Complimentary laundry service	Yes
&Beyond Safari Shop	No

OTHER

Vehicle type	4 and 6-seater semi-open safari vehicle
Private 4x4 safari vehicle	Depending on availability and at an additional cost
Private photographic vehicle	No

DISCOVER THE SERENGETI
&Beyond Serengeti Under Canvas

Inclusions

RATE INCLUDES

Accommodation	✓
Three meals daily	✓
Soft drinks, house wines, local brand spirit and beers, teas and coffees	✓
Refreshments on game drives	✓
Laundry (limited)	✓
One complimentary pair of SWAROVSKI OPTIK CL Companion 8x30 binoculars per tent to share during your stay	✓
Emergency medical evacuation insurance	✓
Transfers to / from the camp airstrip	✓
WILDchild programme	✓
Twice-daily game drives	✓

RATE EXCLUDES

Administration fee	✗
Telephone calls	✗
Gratuities	✗
Personal items	✗
Champagne, cognac, fine wines, premium brand spirits, cigars	✗
Park fees (and government charges)	✗
Hot air balloon safaris	✗
Cultural visits to Olduvai Gorge and Shifting Sands when camps are located at Ndutu	✗
Weddings and blessings	✗

Such care was taken with us and the level of authentic, personal attention made us feel so special.

&BEYOND GUEST

NOTE: Unmanned Aerial Vehicles: Please be advised that the use of unmanned aerial vehicles (drones) are prohibited in the conservation areas we manage, until such time as their impact on wildlife and anti-poaching initiatives can be assessed. This rule will apply throughout Africa, as our partners in various countries and regions have adopted a similar stance.



DISCOVER THE SERENGETI

BEYOND Serengeti Under Canvas

WILDchild

Travel to Tanzania is recommended for children eight years or older. Please note that due to the camp not being fenced off children are required to have an adult accompanying them at all times. Please note that no children under six years of age are allowed at BEYOND Serengeti Under Canvas.

BEYOND Serengeti Under Canvas cannot accommodate more than four children at the camp at any given time.

WILDCHILD ADVENTURES AT SERENGETI UNDER CANVAS

Children will have the opportunity to embark on our very exciting WILDchild programme, filled with fun, interactive activities that offer opportunities to learn and discover new experiences and cultures. Our adventures at BEYOND Serengeti Under Canvas include:

- Learn to play Bao
- Bush survival - like the Maasai
- Fashion a traditional Maasai bow and arrow and join a spear throwing competition
- Fire making the Maasai way
- Roasting marshmallows and stargazing

CHILD POLICY*

0 - 5 years	No children under six years of age
6 - 11 years	Game drives at the discretion of the camp manager. Shortened game drives available on request
12 - 15 years	Permitted on game drives
16 years and above	All activities permitted

**A private vehicle can be booked to accommodate families with children aged 6 to 11 years for game drives. Access to wildlife sightings is at the discretion of the guide, based on the behaviour of both the children and the animals. Private vehicles are subject to availability and incur an additional cost.*

Hot air balloon safari

Seronera / Serengeti South / Grumeti regions: Children seven years and older
Kogatende: Children six years and older

CHILDMINDING

While we don't have trained childminders, we can offer the services of certain staff members who are wonderful with children. This will be at an additional cost.

Please note: The camp is not fenced off and children are required to have an adult accompanying them at all times

FAMILY ACCOMMODATION

2 Family Tents, 1 at each campsite
(Two tents in close proximity linked by an enclosed walkway)

Get your children travelling early.
Expose them to the people, the food and
the real culture of your destination. ”

BEYOND GUEST



&BEYOND SERENGETI UNDER CANVAS

A luxurious tented camp

This versatile camp moves around the park year-round, attempting to anticipate the movements of the Great Migration. Using only private campsites, these mobile camps are entirely intimate and exclusive.



&BEYOND



&BEYOND EAST AFRICA

DISCOVER THE SERENGETI

&Beyond Serengeti Under Canvas Accommodation

Under-canvas luxury

&Beyond Serengeti Under Canvas features nine elegant safari Tents per camp, including one Family Tent. Revel in a classic tented safari, with only the canvas walls separating you from the natural wonders of the Serengeti.



PRIVATE BATHROOM VANITY



TENT INTERIOR



HIS-AND-HER AL FRESCO BUCKET SHOWER

DISCOVER THE SERENGETI
Beyond Serengeti Under Canvas Accommodation

TENT

9 Tents per camp / Max. 21 guests per camp including children

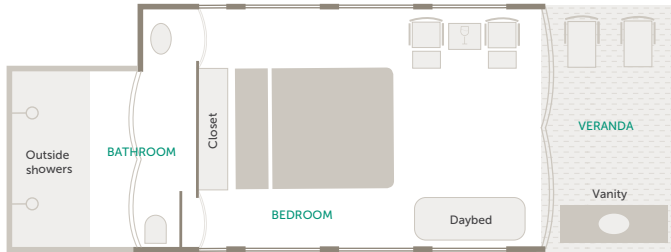

Typical Tent layout

ULTIMATE GLAMPING

Two private camps feature luxurious ensuite safari tents entirely intimate and exclusive, each with a double bed, bathroom and separate WC, as well as an indoor sitting area, personal bar and his-and-her al fresco bucket showers. Redolent of classic safari style, custom-made rugs, crisp linens, sparkling crystal and polished brass lend flair to the simplicity of camping.

ROOM FACILITIES

Room sizes (Square meters)	35 m ² (377 ft ²)
Private veranda	Yes
Personal bar	Yes
Air conditioning / heating	No
Overhead fans	No
Mosquito nets	No, sealed tent
Shower	Outdoor shower only, his-and-her bucket showers
Separate WC	Yes, inside tent without a door
Telephone	No, intermittent mobile reception
Hairdryer	Available in central guest WC tent
In-room safe	Yes
Internet access	Yes, Wi-Fi
Plug type	Plug type G British (220v AC) in tents and vehicles With prior notice we are able to arrange for a generator to provide 24-hour electricity for guests with special medical requirements
Triple tent option	1 Triple Tent available per camp 1 Family Tent with a triple that can be booked on request
Twin bed option	All beds are convertible into twin or double

DISCOVER THE SERENGETI
Beyond Serengeti Under Canvas Accommodation

FAMILY TENT

1 interleading Family Tent per camp / Max. 2 adults & 2 children (3 children on request)



PERFECT FOR FAMILIES
The camp lends itself to family travel in the form of two spacious Tents with an interleading passage that makes up a Family Tent. Each tent has its own ensuite bathroom and a private veranda and seating area.

ROOM FACILITIES	
Room sizes (Square meters)	24 m ² and 35 m ² (258 ft ² and 377 ft ²)
Private veranda	Yes
Personal bar	Yes
Air conditioning / heating	No
Overhead fans	No
Mosquito nets	No, sealed room
Shower	Outdoor shower only, his-and-her bucket showers
Separate WC	Yes
Telephone	No, intermittent mobile reception
Hairdryer	Available in central guest WC tent
In-room safe	Yes
Internet access	Yes, Wi-Fi
Plug type	Plug type G British (220v AC) in tents and vehicles With prior notice we are able to arrange for a generator to provide 24-hour electricity for guests with special medical requirements
Triple bed option	Yes, triple available on request
Twin bed option	All beds are convertible into twin or double
Interleading walkway	Yes

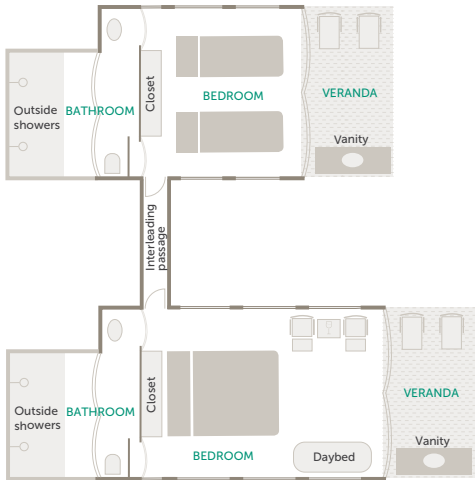

Typical Family Tent layout

DISCOVER THE SERENGETI

&Beyond Grumeti Serengeti River Lodge

Expect a private Serengeti experience on the banks of a river; complete with a seasonal hippo pod, impressive lion prides and meaningful community collaborations.



DISCOVER THE SERENGETI

Beyond Grumeti Serengeti River Lodge

Why stay?

1 EXCLUSIVE AND EXCEPTIONAL YEAR-ROUND GAME VIEWING

Perhaps one of the Serengeti's best-kept secrets, wildlife lovers can enjoy their own private Serengeti in the western parts of the park. Remotely situated with far fewer crowds and vehicles, enjoy having the game-rich plains to yourself. Witness large resident prides of lion and an abundance of predators, hyena clans, buffalo, elephant, hippo and herds of plains game. This secluded area also has an annual topi migration, and the spectacular black-and-white colobus monkeys found nowhere else in the Serengeti.

2 MAGNIFICENT LION SIGHTINGS

Apart from its spectacular natural setting, this part of the Serengeti is known for its big lion prides. There are four resident prides in the area, consisting of between 20 and up to 60 lions. Our team on the ground continuously monitor the lion numbers, and you are assured excellent sightings. Not only are the opportunities for seeing lion a given, but you will more often than not find yourself viewing alone with ample time, as other vehicles are few and far between.

3 SITUATED ON THE BANKS OF A RIVER

The lodge is set in the remote western reaches of the park on a tributary of the Grumeti River. The permanent waters of the Grumeti and seasonal Mbalageti rivers attract an abundance of wildlife. Resident hippo grunt in the tranquil pools in front of the lodge while crocodiles lie, log-like, in the shallows. Meals can be enjoyed on the extensive deck with beautiful river views, while the dining area opens up to a traditional African boma, where dinner is served beneath a billion stars.

4 SUSTAINABLE DESIGN EDGED WITH LUXURY

Using the river's natural bow shape while paying homage to the circular forms of a traditional Masai Manyatta, the cultural homesteads of the Maasai people, the lodge unfolds to reveal an understated sense of luxury entrenched in sustainability. Touching the earth lightly and seemingly floating across the landscape, 10 nostalgically elegant, and very spacious, guest Suites await. Expect the ultimate in exclusivity, taking only beautiful memories home and leaving little to no footprint behind.



DISCOVER THE SERENGETI

&Beyond Grumeti Serengeti River Lodge Experiences

Safari experiences

Set against a backdrop of vast landscapes in a remote corner of the Serengeti, look forward to unforgettable safari experiences offering thrilling year-round wildlife and natural spectacles.



1

HOT AIR BALLOON SAFARI*

Embark on a safari from above, in the comfort of a massive, weaved basket, securely attached to a billowing balloon. The hour-long flight floats over the Serengeti's endless plains, draped with abundant wildlife. Pass over lush patchworks of grasslands and woodland, marvelling at one of Africa's most thriving ecosystems.



2

SAFARI GAME DRIVE

We offer twice-daily game drives, with sunrise and sundowner stops. &Beyond's professionally trained guides will ask you about your favourite wildlife and will do their very best to ensure your expectations are met, whether it's looking for a particular species or spending time at each sighting observing unique animal behaviours.



3

BIRDWATCHING

Keen birders will delight in the opportunity to birdwatch while on game drives. Explore the park in search of its 350 species. We have selected our favourite Star Birds for the reserve and if you find all of them we will celebrate with a bottle of sparkling wine back at the lodge.



4

PRIVATE VEHICLE SAFARI*

Tailored for you, this exclusive safari allows you to explore the bushveld with your very own dedicated guide and vehicle. Game drives can be as long or as short as you wish, covering your personal interests, from the insect kingdom to great herds of buffalo to prides of lion. Meals can be at the lodge or a under towering trees.

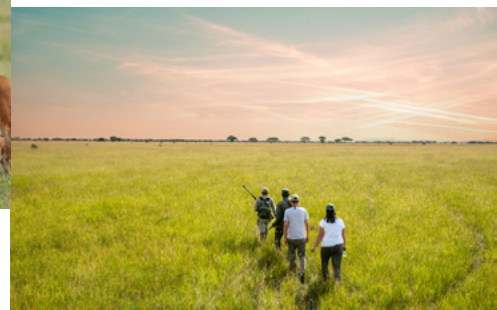

5

NATURE WALK*

The perfect alternative to game drives, a guided nature walk offers the incredible experience of exploring the world-famous Serengeti National Park on-foot. Ideal for avid birders and keen photographers, there's so much to see and learn during a guided walk and the opportunity to get near to plains game is thrilling.

DISCOVER THE SERENGETI

&Beyond Grumeti Serengeti River Lodge Experiences

Other experiences

Safari is just the beginning of the full Grumeti experience. Gain a greater insight into the diverse landscape, wildlife and people through an array of additional journeys.



1

STARGAZING FIESTA

The African night skies are truly a sight to behold. Sit under a blanket of a million stars and enjoy a basic astronomy lesson from your guide, who will teach you how to navigate by means of the stars, chart the skies, and point out famous constellations.



2

WELLNESS TREATMENTS*

&Beyond Grumeti Serengeti River Lodge offers the perfect opportunity to simply unwind and reconnect after a long journey or safari. Pamper yourself with a soul-soothing wellness treatment in the comfort of your Suite. Indulgent therapies are performed using Healing Earth products, made from all-natural local ingredients.



3

PRIVATE YOGA SESSION*

Reawaken your senses amidst the stunning backdrop of Grumeti Serengeti River Lodge. Here, with the grunts of hippo in the distance, you can enjoy a series of yoga movements designed to stretch, strengthen and realign your mind, body and soul.



4

COMMUNITY VISIT*

A visit to the nearby Lukungu community offers a meaningful glimpse into daily life in rural Tanzania. The journey takes three to four hours each way, making it a full-day excursion away from the concession. Guests are welcomed into the community to meet local people and to see the work of Wild Impact, which supports projects that focus on education, healthcare, and access to clean water.

Private vehicle required.

DISCOVER THE SERENGETI
&Beyond Grumeti Serengeti River Lodge Experiences

Seasonal highlights

YEAR-ROUND ACTIVITIES

- ✓ Safari game drives
- ✓ Nature walks
- ✓ Wellness treatments
- ✓ Private yoga sessions
- ✓ Wild Impact community visits

TIMING IS EVERYTHING

	JAN	FEB	MAR	APR	MAY	JUN	JUL	AUG	SEP	OCT	NOV	DEC
Hot air balloon safaris	x	x	x	x	x	✓	✓	✓	✓	✓	x	x
Potential to witness the Great Migration	x	x	x	x	✓	✓	✓	x	x	✓	✓	x
To view the topi migration and calving	✓	✓	x	x	x	x	x	x	x	x	x	✓

Grumeti offers so many possibilities.
This wildlife corridor brims with
rivers, rolling hills and magnificent
migration sightings.



DISCOVER THE SERENGETI

Beyond Grumeti Serengeti River Lodge

Lodge amenities



1

CENTRAL BAR

The central circular bar with woven Kitenge fabrics and glass ball light installations is the hub of the lodge. It is the perfect setting to sip on one of our signature cocktails and enjoy convivial conversation with other guests with stunning views of the river.



2

SAFARI SHOP

Within the lodge's beautiful Safari Shop, expect to find a range of quality, handpicked handicrafts and fashion wear that showcase the very best of Tanzania. These unique items provide the perfect memento of your stay in Africa.



3

LODGE SWIMMING POOL

After a successful morning of game viewing (or perhaps after an afternoon siesta), the lodge's sparkling pool awaits. Grab a cocktail en route as this is the perfect place to watch the resident hippos and wildlife along the river.



4

GYM WITH A VIEW

Keep in shape and work off the delicious lodge cuisine in the lodge's gym well-equipped with Pilates balls, a treadmill, rowing machine, stationary bicycle and weights. Offering beautiful bush views while working out, what more motivation do you need?



5

OUTDOOR BOMA

After your evening game drive, enjoy a pan-African al fresco dinner under the stars and around the open blazing fire in the lodge's traditional boma complete with an outdoor pizza oven encouraging guests to participate in making their own gourmet pizza.



6

INTERACTIVE KITCHEN

The central interactive kitchen brings a cheerful atmosphere to the lodge. Our food is locally inspired, sustainable and wholesome. We continue to push the boundaries in terms of lodge dining. Each dish is packed with flavour.

DISCOVER THE SERENGETI

Beyond Grumeti Serengeti River Lodge

Room amenities



1

PRIVATE PLUNGE POOLS

Each Suite boasts its own glorious private plunge pool for refreshing dips between game drives. Take some time to cool off in the glorious African bush in the comfort of your own Suite.



2

IN-ROOM TREATMENTS

Spoil yourself with one of our signature wellness treatments at a time that suits you. Our talented therapist will happily explain the various options available.



3

PERSONAL BARS

Your Suite also boasts a private mini-bar with a selection of local drinks. Your butler is on hand to customise your selection and keep it stocked for the duration of your stay.



4

COFFEE STATION

Day or night, if you don't feel like coming to the main guest area for a delicious cappuccino, your warm drink of choice can be made in your room.



5

JBL BLUETOOTH SPEAKER

Sync your favourite playlist with this device to get into that holiday spirit or ask the team for some suggestions of local artists.

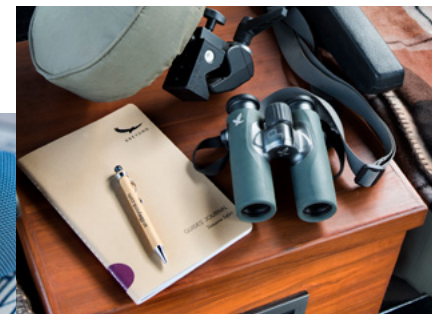

6

SAFARI ACCESSORIES

Each Suite comes with a complimentary pair of SWAROVSKI OPTIK CL Companion 8x30 binoculars for your use during your stay, as well as a take-home Guides' Journal featuring wildlife illustrations and maps.

DISCOVER THE SERENGETI
Beyond Grumeti Serengeti River Lodge

BEYOND
Grumeti Serengeti
River Lodge

- Road
- Footpaths

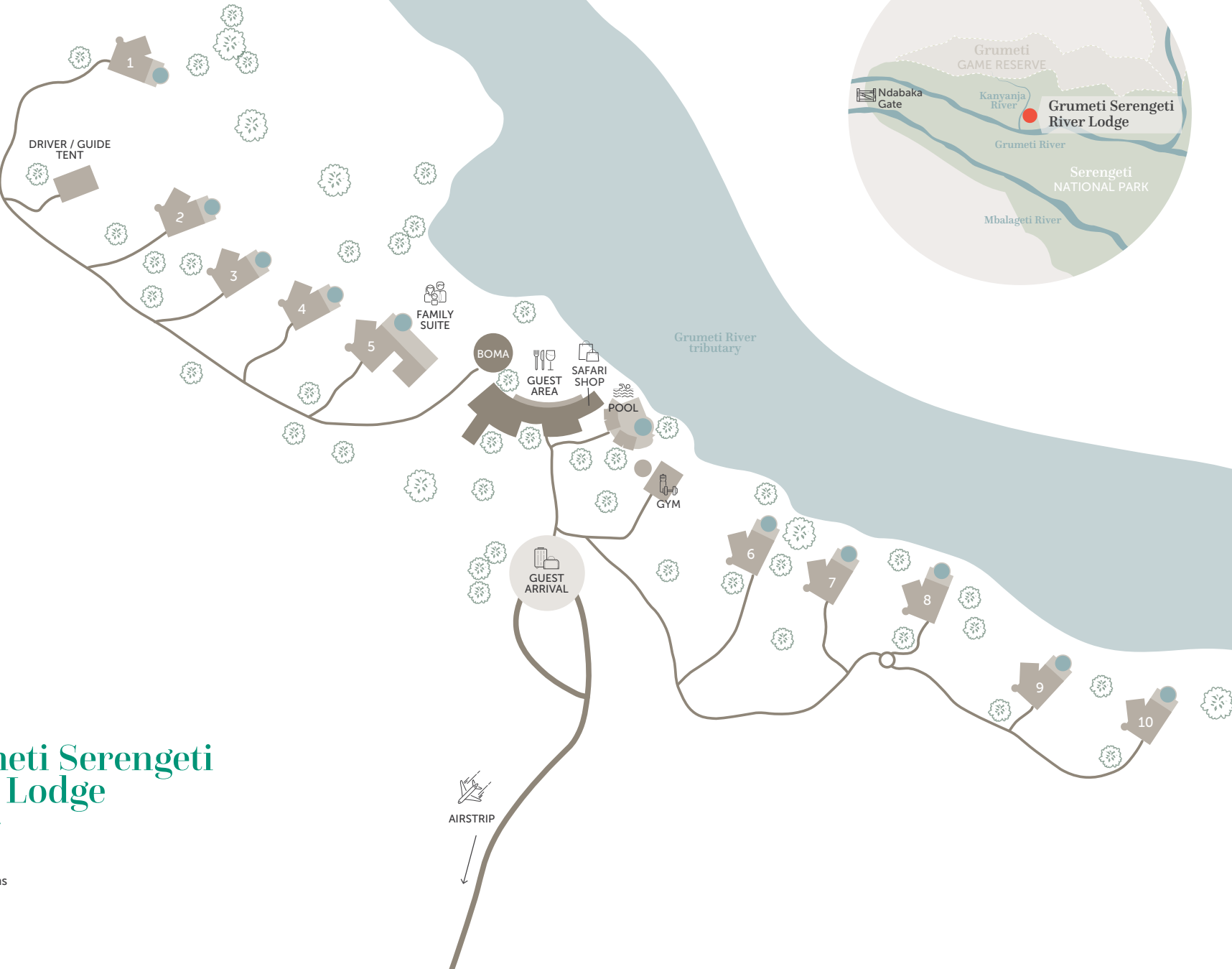

DISCOVER THE SERENGETI
Beyond Grumeti Serengeti River Lodge

Lodge overview

LODGE

Maximum number of guests	22
Number of rooms	10
Family accommodation	Children are welcome. 1 Family Suite consisting of two guest Suites with an interleading passage (max. 2 adults and 2 children)
WILDchild programme	Yes
Pilot / Guide accomodation	Yes
Room types	9 Suites and 1 Family Suite
Distance between rooms	Approx. 15 m (49 ft)
Lodge GPS Coordinates	02°09.479'S 034°13.151'E
Check-in / Check-out times	14h00 / 11h00, with early check-in and late check-out on request
Lodge closure	Open year-round

DINING

Food / Dietary options	Kosher food not available. Halaal and other special dietary requests available. Please book in advance
Private butler service	Yes
Plated service	Yes
Private dining	Yes

PAYMENT TYPES ACCEPTED

Credit cards accepted	Mastercard and Visa
Currency	USD are widely used, however, notes dated prior to 2006 are not accepted

FACILITIES

Power	Inverter system allows 24-hour lights and fans. With prior notice we are able to provide 24-hour electricity for guests with special medical requirements
Internet access	Yes, Wi-Fi in suites and guest area
Wine store or cellar	No
Outdoor dining	Yes, boma with outdoor pizza oven
Interactive kitchen	Yes
Bar	Yes
Swimming pool	Yes, main lodge pool and private plunge pools
Wellness offering	Healing Earth wellness treatments offered in-room
Fitness	On-site gym and yoga sessions available
Conference facilities	No
Weddings and blessings	Can be arranged, please consult your travel specialist
Wheelchair accessibility	Not suitable for those with mobility issues
Complimentary laundry service	Yes
Beyond Safari Shop	Yes

OTHER

Vehicle type	Open safari vehicle with canvas canopy
Private 4x4 safari vehicle	Depending on availability and at an additional cost
Private photographic vehicle	No

DISCOVER THE SERENGETI
Beyond Grumeti Serengeti River Lodge

Inclusions

RATE INCLUDES

Accommodation	✓
Three meals daily	✓
Soft drinks, house wines, local brand spirits and beers, teas and coffees and refreshments during activities	✓
Laundry	✓
Experiences: Safari game drives, nature walks, back-of-house sustainability tour	✓
WILDchild programme	✓
One complimentary pair of SWAROVSKI OPTIK CL Companion 8x30 binoculars per suite to share during your stay	✓
Guides' Journal with illustrations of fauna and flora to record your sightings	✓
Area map with Grumeti's illustrated Star Birds checklist	✓
Emergency medical evacuation insurance	✓
Transfers to and from the lodge airstrip	✓
VAT	✓

RATE EXCLUDES

Administration fee	✗
Telephone calls	✗
Gratuities	✗
All items of a personal nature	✗
Safari Shop purchases	✗
Champagne, cognac, fine wines, premium brand spirits and cigars	✗
Park and concession fees (and governmental charges)	✗
Airport taxes, safety fees and fuel surcharge	✗
Weddings and blessings	✗
Private vehicle (available at an additional cost)	✗
Experiences: Hot air balloon safari (seasonal), Healing Earth wellness treatments, private yoga sessions, Wild Impact community visit (private vehicle required)	✗

NOTE: Unmanned Aerial Vehicles: Please be advised that the use of unmanned aerial vehicles (drones) are prohibited in the conservation areas we manage, until such time as their impact on wildlife and anti-poaching initiatives can be assessed. This rule will apply throughout Africa, as our partners in various countries and regions have adopted a similar stance.



DISCOVER THE SERENGETI
Beyond Grumeti Serengeti River Lodge

WILDchild

The exciting Beyond Grumeti WILDchild Programme is filled with fun, interactive activities that allow children to flourish in an environment that advocates exploration, discovery and learning. Deeply rooted in a love for Africa, it not only creates a series of unforgettable moments for the whole family, but forges strong bonds between our young guests, our planet and its people.

WILDCHILD ADVENTURES

Children visiting the lodge can take advantage of the fun-filled and interactive WILDchild programme that offers various activities such as:

- Tracking animal footprints with a guide in the lodge surrounds
- Mouth-watering pizza making
- Playing volleyball with the staff
- Competitions to spot the elusive karamoja apalis, a local bird species
- 'Beyond sightings' conservation research (for older children)

FAMILY ACCOMMODATION

Suite	1 triple available
1 Family Suite (2 interleading suites)	<ul style="list-style-type: none">• Maximum 2 adults + 2 children (3rd child on special request)• An ideal option for family safaris

CHILDMINDING

While we don't have trained childminders, we can offer the services of certain staff members who are wonderful with children. This will be at an additional cost.

Please note: The lodge is not fenced off and children are required to have an adult accompanying them at all times

CHILD POLICY*

0-5 years	Game drives are permitted only on a private vehicle or a children's game drive (avoiding lion, leopard and elephants sightings), not during standard game drive time. No walks outside of the lodge.
6-11 years	Game drives permitted at the discretion of lodge manager and guides. No walks outside of the lodge.
12-15 years	Game drives permitted with expert guides. No walks outside of the lodge.
16-years and above	Game drives and nature walks permitted with expert guides.

**When staying at Beyond Grumeti Serengeti River Lodge, a private vehicle can be booked and children of any age may go on game drive, with access to sightings being at the discretion of the guide, based on the behaviour of both child and wildlife. (Subject to availability and at an additional cost.)*



&BEYOND GRUMETI SERENGETI RIVER LODGE

Overlooking hippo pods



&BEYOND

A wild and remote experience, &Beyond Grumeti Serengeti River Lodge is ideally situated on the banks of a tributary of the Grumeti River. All 10 of the tented Suites feature shaded private verandas that look out over the river frontage.



DISCOVER THE SERENGETI

&Beyond Grumeti Serengeti River Lodge Accommodation

Remote river tranquility

Situated on a river bank, in the secluded western parts of the park, &Beyond Grumeti Serengeti River Lodge offers guests nine air conditioned Suites, plus a Family Suite, boasting unparalleled views of the tributary and resident hippo pods.



LUXURIOUS GUEST SUITE INTERIOR



ENSUITE BATHROOM WITH INDOOR SHOWER AND BATH



GUEST SUITE EXTERIOR WITH GRUMETI RIVER VIEWS

DISCOVER THE SERENGETI
Beyond Grumeti Serengeti River Lodge Accommodation

SUITE

10 Suites / Max. 22 guests at the lodge



WARM AND INVITING
Sophisticated and secluded with spectacular views of the Grumeti River, 10 spacious Suites offer guests natural light, an enormous bed, bath, an indoor shower (with a spectacular view), and sparkling private plunge pool.

ROOM FACILITIES	
Room size	95 m ² (1 023 ft ²) under roof; 130 m ² (1 400 ft ²) including deck and pool
Private veranda	Yes, with private plunge pool
Private plunge pool	Yes
Personal bar	Yes
Personal coffee station	Yes
Air conditioning	Yes
Mosquito nets	Yes
JBL music player	Yes
Bath	Yes
Shower	Yes
Separate W.C	Yes
Telephone	Yes, intermittent GSM mobile reception
Hairdryer	Yes
In-room safe	Yes
Internet access	Yes
Plug type	220V AC Plug Type C, D, M, N Adapters available
Triple bed option	1, for children 16-years and younger only
Twin bed option	Yes, however, beds are within same bedframe
Double bed option	Yes
Interleading door	No
Wheelchair accessibility	Not suitable for those with mobility issues



Typical Suite layout

DISCOVER THE SERENGETI
Beyond Grumeti Serengeti River Lodge Accommodation

FAMILY SUITE

1 interleading Family Suite / Max. 2 adults & 2 children (3 children on request)



IDEAL FOR FAMILIES

The Family Suite features an additional, smaller bedroom. The suite itself is adorned in beautiful earthy hues and features a lovely ensuite bathroom, a private veranda with river views and a private plunge pool.

ROOM FACILITIES

Room size	134 m ² (1 442 ft ²) under roof; 195 m ² (2 100 ft ²) including deck and pool
Room configuration	A guest suite with an interleading passage to a smaller children's room
Private veranda	Yes, with private plunge pool
Private plunge pool	Yes
Personal bar	Yes
Personal coffee station	Yes
Air conditioning	Yes
Mosquito nets	Yes
JBL music player	Yes
Bath	Yes, in main suite only
Shower	Yes
Separate W.C	Yes
Telephone	Yes, intermittent GSM mobile reception
Hairdryer	Yes
In-room safe	Yes
Internet access	Yes, Wi-Fi throughout
Plug type	220V AC Plug Type C, D, M, N Adapters available
Triple bed option	Yes, on special request
Twin bed option	Yes, however, beds are within the same bedframe
Double bed option	Yes
Interleading door	Yes, 2 interleading rooms
Wheelchair accessibility	Not suitable for those with mobility issues

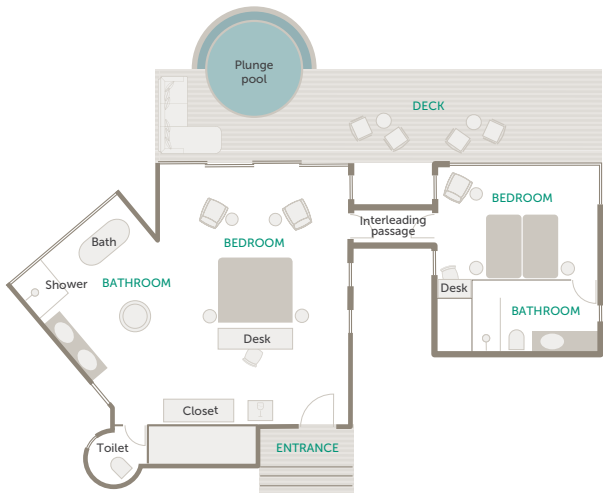

Typical Family Suite layout



&BEYOND

DISCOVER THE SERENGETI

&Beyond Klein's Camp

Secluded classic luxury, within a private concession bordering the Serengeti, steeped in Maasai heritage, and generously rich in spectacular views and captivating year-round safari adventure.

DISCOVER THE SERENGETI

&Beyond Klein's Camp

Why stay?

1 SWEEPING VIEWS OF THE KLEIN'S VALLEY

Situated on the only concession that borders on both the Serengeti and the Masai Mara national parks, &Beyond Klein's Camp offers some of the best panoramic views of these two iconic destinations, which also play host to one of the greatest wildlife migrations on earth. Perched on the edge of the Kuka Hills, this camp boasts magnificent views of wild Africa, an exquisite landscape of wooded hillsides, rolling grasslands and forested river banks, all teeming with rich wildlife.

2 PRIVATE CONCESSION EXPERIENCES

Blessed with an astounding year-round concentration of animals and the climax of the Great Migration, Serengeti National Park provides an unsurpassed wildlife experience. Sensitive off-road driving is permitted to allow for close wildlife viewing as well as bush walks and night drives. There are regular lion pride sightings, with no other vehicles around. Night drives and walking safaris in the private concession allow you the opportunity to explore the nocturnal world of the predators or to get an intimate glimpse into the details of the African bush.

3 MAASAI AND CULTURAL EXPERIENCES

Many of the &Beyond Klein's Camp staff are Maasai and over 90% hail from the surrounding communities. You will get a small taste of Maasai culture on your drives by merely speaking to your guide. Incredibly warm and friendly this camp inspires interaction and understanding more of this ancient and fascinating culture. For those with a deep interest in the Maasai traditions and ancient way of living, you can visit an authentic boma or take the opportunity to visit a local community, schools and clinic, understanding the real challenges and success of contemporary Maasai life.

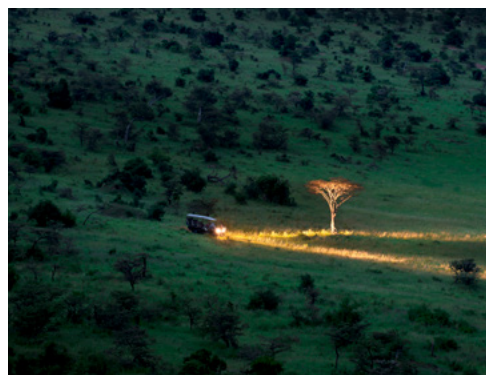

The private concession makes it special as you can get close to animals and do night safaris. View is wonderful and the team terrific!

&BEYOND GUEST



DISCOVER THE SERENGETI
Beyond Klein's Camp Experiences

Experiences and highlights

Extraordinary safari experiences on a private concession bordering the Serengeti National Park which the richly cultural Maasai call home.



1

EXCEPTIONAL GAME DRIVES

We offer twice-daily game drives on the concession, with welcome sunrise and sundowner stops. Beyond's professionally trained guides will ask you about your favourite wildlife and will do the very best to ensure that your preferences are met, whether it's tracking a particular species or spending more time enjoying sightings.



2

BUSH DINING IN THE SERENGETI

Revel in the wide open landscapes of Tanzania as you savour a meal served just like African explorers of old would have enjoyed. They say that everything tastes better in the open air and this is even truer when you are enjoying your meal surrounded by wildlife. Enjoy a bush dining experience with open-air breakfast, lunch or dinner out on the private Beyond Klein's Camp concession.

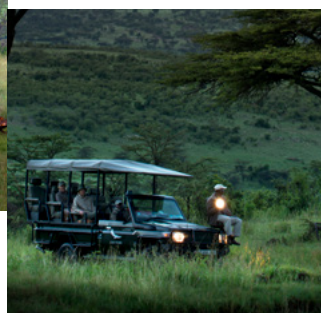

3

EXCLUSIVE NIGHT GAME DRIVES

Experience the remote 10 000 hectare (24 700 acre) wilderness concession after dark. The night sounds offer a unique view of the terrain, lit by the glowing eyes of nocturnal residents. Nighttime animals including aardvark, white-tailed mongoose, serval, caracal, large spotted genet and curious bush babies.



4

GUIDED BUSH WALKS ON THE CONCESSION

Examining the often-overlooked aspects of the natural world and unravelling its intricacies and simple truths, a nature walk allows you to experience Africa on-foot, free from the constraints of roads and vehicles. Watch birds, explore a dry river bed, walk in the footsteps of zebra or giraffe, sit in stillness in the shade of an ancient tree, unravel the stories behind animal tracks or simply stretch your legs.



5

VISIT TO AN AUTHENTIC MAASAI VILLAGE

Experience a-day-in-the-life-of an authentic Maasai on a village drive. Visit a boma not far from the camp to gain a unique understanding of the impact of the western world on this traditional culture and ancient way of living. Take the opportunity to visit a local community, schools and clinic, listen to the people, understanding the real challenges and success of contemporary Maasai life.

OTHER ACTIVITIES TO ENJOY

WILD IMPACT COMMUNITY VISIT

The Beyond Klein's Camp concession is leased from the Maasai people and local communities nearby play an integral part in the conservation of this natural area. Visit community-led projects in neighbouring communities, including a clinic and two schools.

WELLNESS TREATMENTS

Beyond Klein's Camp offers the perfect opportunity to simply unwind and reconnect after a long journey or safari. Pamper yourself with a soul-soothing wellness treatment using Healing Earth products, made from all-natural ingredients sourced in Africa.

Activities may incur an additional charge, are contingent to availability, and should be booked in advance. The price of each activity is available on request.

DISCOVER THE SERENGETI
&Beyond Klein's Camp Experiences

Seasonal highlights

TIMING IS EVERYTHING

	JAN	FEB	MAR	APR	MAY	JUN	JUL	AUG	SEP	OCT	NOV	DEC
Night drives for nocturnal animals	✓	✓	✓	✓	✓	✓	✓	✓	✓	✓	✓	✓
Guided bush walk	✓	✓	✓	✓	✓	✓	✓	✓	✓	✓	✓	✓
Maasai boma visit	✓	✓	✓	✓	✓	✓	✓	✓	✓	✓	✓	✓
Community development projects visit	✓	✓	✓	✓	✓	✓	✓	✓	✓	✓	✓	✓
Outdoor bush dining	✓	✓	✗	✗	✗	✓	✓	✓	✓	✓	✓	✓
To view migration in the northern Serengeti	✗	✗	✗	✗	✗	✓	✓	✓	✓	✓	✓	✓
More exclusive lion sightings	✓	✓	✓	✓	✓	✓	✓	✓	✓	✓	✓	✓
Big Five game viewing opportunities including big herds of buffalo, leopard sightings and elephant	✓	✓	✓	✓	✓	✓	✓	✓	✓	✓	✓	✓
SEASONAL RATES*	\$\$\$	\$	\$	\$	\$	\$\$\$	\$\$\$	\$\$\$	\$\$	\$\$	\$	\$\$\$

* The \$ / \$\$ / \$\$\$ references are used to indicate rate variation and are not associated with specific values.

** Climate varies regionally and according to altitude. Visit this [link](#) for more information - measured in Fahrenheit and inches.

Great location, incredible views, outrageous service and an awesome family!))

&BEYOND GUEST



DISCOVER THE SERENGETI

Beyond Klein's Camp

Camp amenities



1

BAR AREA

The camp has a large, beautifully furnished bar and sitting area, graced by a large open fireplace. The spectacular view over the Klein's valley and the social hub of the camp, make this a good place to spend an afternoon, playing board games, reading a book or sipping on a cocktail or cappuccino.



2

SWIMMING POOL

Tucked into the hillside, the sparkling swimming pool is a welcome reprieve after a day out on a game drive. Boasting fantastic views over the concession, this is the perfect place to refresh or while away an afternoon.



3

SAFARI SHOP

There is a small Safari Shop in the camp, which is a celebration of locally-made, hand-crafted Maasai artistries. Ensure to take home a piece of your journey with you, a beautiful keepsake for your enlightening Maasai experience; one that you will most likely not be able to forget.



4

CAMP SHAMBA

Fresh vegetables are picked daily from the camp's shamba, or organic African vegetable garden, and are used skilfully to create the wholesome and delicious dishes enjoyed during your stay. The shamba is about a 20-minute drive from the camp.



5

DINING LOCATIONS

Being on a private concession gives flexibility in terms of dining venues. Tuck into a delectable array of fresh produce and enjoy your meals as the dining room, bar area or the privacy of your verandah or out on the concession.

DISCOVER THE SERENGETI
&Beyond Klein's Camp

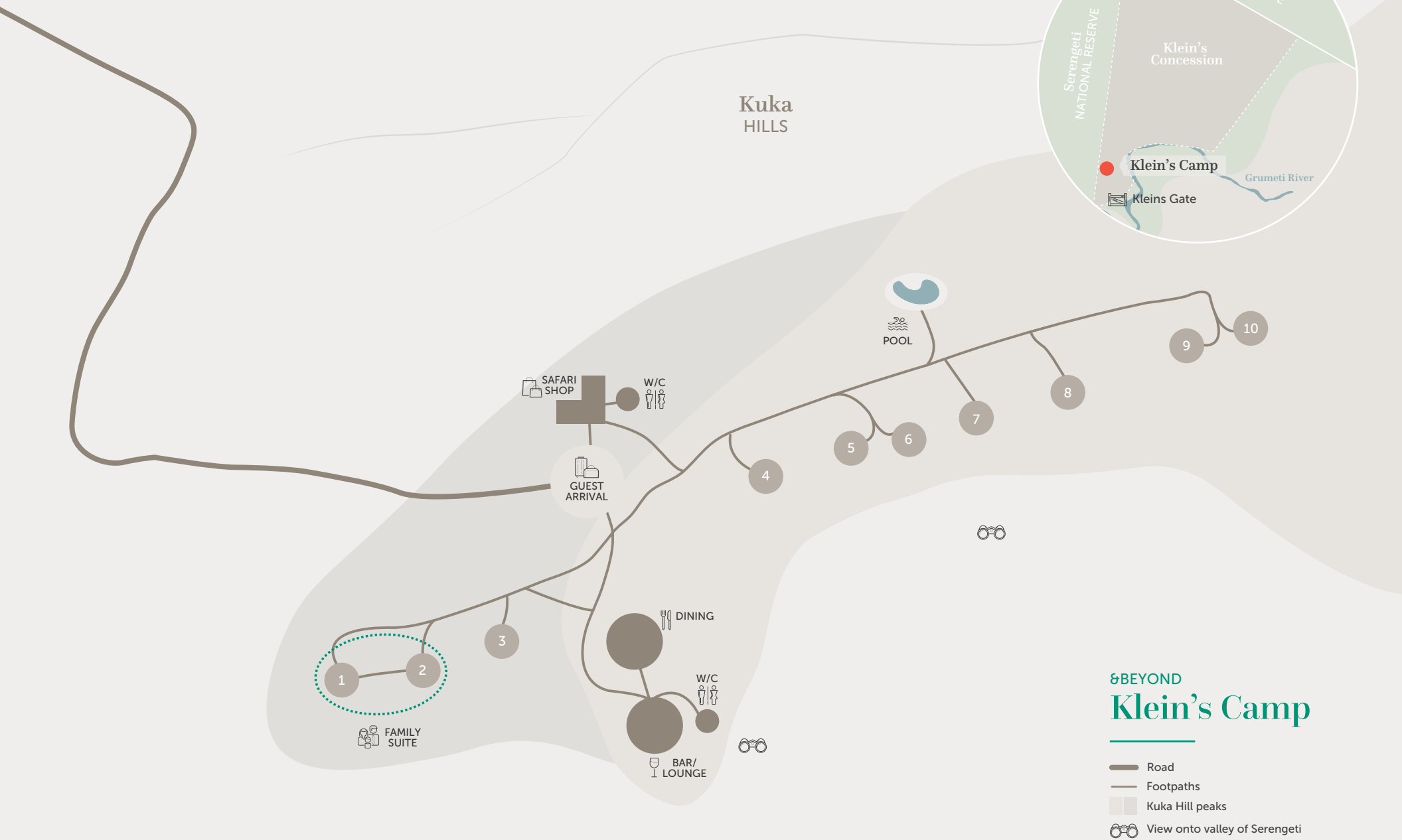

DISCOVER THE SERENGETI

♾️ Beyond Klein's Camp

Camp overview

CAMP

Maximum number of guests	20
Number of rooms	10, including a Family Cottage
Family accommodation	There is one Family Cottage (Two Cottages in close proximity linked by an enclosed walkway)
Pilot / Guide accomodation	Available
Room types	Cottage
Distance between rooms	10 – 15 m (33 – 50 ft)
Check-in / Check-out times	14h00 / 10h00
Camp GPS Coordinates	01°50.089'S 035°14.797'E
Camp Closure	Open year-round

DINING

Food / Dietary options	Kosher not available. Halaal and other special dietary requests available: please book in advance
Private butler service	Yes
Private dining	Yes

PAYMENT TYPES ACCEPTED

Credit cards accepted	Mastercard and Visa
Currency	USD are widely used, however, notes dated prior to 2006 are not accepted

FACILITIES

Power	Please note that ♾️Beyond Klein's Camp has an inverter system, so while the generator is switched off overnight; guests have electricity and power throughout the night
Wine store or cellar	No
Boma	Yes
Interactive kitchen	No
Swimming pool	Yes, camp swimming pool
Wellness offering	Healing Earth treatments offered in-room only
Fitness	Gym-in-a-Basket available in-room
Conference facilities	No
Weddings and blessings	Can be organised. Please consult your travel specialist
Wheelchair accessibility	Possible with assistance in certain cases
Complimentary laundry service	Yes
♾️Beyond Safari Shop	Yes

OTHER

Vehicle type	6-seater semi-open safari vehicle
Private 4x4 safari vehicle	Depending on availability and at an additional cost
Private photographic vehicle	No

DISCOVER THE SERENGETI
&Beyond Klein's Camp

Inclusions

RATE INCLUDES

Accommodation	✓
Three meals daily	✓
Soft drinks, house wines, local brand spirit and beers, teas and coffees	✓
Refreshments on game drives	✓
Laundry	✓
One complimentary pair of SWAROVSKI OPTIK CL Companion 8x30 binoculars per cottage to share during your stay	✓
Emergency medical evacuation insurance	✓
Transfers to / from the lodge airstrip	✓
WILDchild programme	✓
Twice-daily game drives	✓
Night drives	✓
Guided bush walks	✓
Bush meals	✓

RATE EXCLUDES

Administration fee	✗
Telephone calls	✗
Gratuities	✗
Personal items	✗
Safari Shop purchases	✗
Champagne, cognac, fine wines, premium brand spirits, cigars	✗
Park fees (and government charges)	✗
Hot air balloon safaris (seasonal)	✗
Authentic Maasai community visits	✗
Wild Impact community visits	✗
Weddings and blessings	✗
Healing Earth wellness treatments	✗

The deeply personal touches at the lodge and in the bush made our stay extraordinary. ”

&BEYOND GUEST

NOTE: Unmanned Aerial Vehicles: Please be advised that the use of unmanned aerial vehicles (drones) are prohibited in the conservation areas we manage, until such time as their impact on wildlife and anti-poaching initiatives can be assessed. This rule will apply throughout Africa, as our partners in various countries and regions have adopted a similar stance.



DISCOVER THE SERENGETI

♾️ Beyond Klein's Camp

WILDchild

Travel to Tanzania is recommended for children eight years or older.

WILDCHILD ADVENTURES AT KLEIN'S CAMP

Children visiting ♾️Beyond Klein's Camp can take advantage of the fun-filled and interactive WILDchild programme. Here, little ones can enjoy activities such as:

- Taking part in a Maasai obstacle course combining spear throwing, shooting bows and making a fire the Maasai way
- Embark on a nature walk with a ranger, identifying animal tracks
- Baking delicious biscuits with the camp's chefs

**A wonderful camp to
give children exposure
to wildlife and the iconic
Maasai culture.** ”

♾️ BEYOND GUEST

CHILD POLICY*

0-5 years	Game drives available only in a private vehicle or on a children's game drive (avoiding lion, leopard and elephants), outside of normal game drive time. No walks outside of the camp
6-11 years	Game drives and boating activities at discretion of camp manager, and at guides / rangers discretion during activity. No walks outside of the camp
12-15 years	Game drives and boating activities. Nature walks
16 years and above	All activities permitted

**When staying at ♾️Beyond Klein's Camp, a private vehicle can be booked and children of any age may go on game drive, with access to sightings being at the discretion of the guide, based on the behaviour of both child and wildlife. Subject to availability and at an additional cost.*

CHILDMINDING

While we don't have trained childminders, we can offer the services of certain staff members who are wonderful with children. This will be at an additional cost.

Please note: The camp is not fenced off and children are required to have an adult accompanying them at all times





&BEYOND

&BEYOND KLEIN'S CAMP

Secluded classic luxury

Majestically situated on the edge of the Kuka Hills, &Beyond Klein's Camp consists of just ten intimate Cottages made of local stone and makuti thatch, with rich wooden floors and classic interiors.



DISCOVER THE SERENGETI

&Beyond Klein's Camp

On the edge of exclusivity

Embodying the very soul of the Serengeti, &Beyond Klein's Camp exemplifies the spirit of wild Africa with 10 safari Cottages, including one Family Cottage, embracing unrivalled views of the sweeping plains below.



DISCOVER THE SERENGETI
&Beyond Klein's Camp Accommodation

COTTAGE

10 Cottages (including a Family Cottage) / Max. 20 guests



VINTAGE STYLE SAFARI
&Beyond Klein's Camp consists of just ten intimate Cottages made of local stone and makuti thatch, with rich wooden floors and classic interiors. Each Cottage has an ensuite bathroom and private veranda, where guests can marvel at extraordinary views down the valley while sipping on your favourite drink from your personal bar.

ROOM FACILITIES

Room size (square meters)	43 m ² (463 f ²)
Private veranda	Yes
Personal bar	Yes
Air conditioning / heating	No
Overhead fans	No
Mosquito nets	Yes
Bath	No
Shower	Yes, indoor
Separate W.C	Yes
Telephone	In-room telephones are available. Intermittent GSM mobile reception
Hairdryer	Yes
In-room safe	Yes
Internet access	Yes, Wi-Fi
Plug type	220V AC (plug points in rooms), Plug type G British – BS 1363
Triple bed option	2, for children 16 years and younger
Twin bed option	All beds are convertible into twin or double

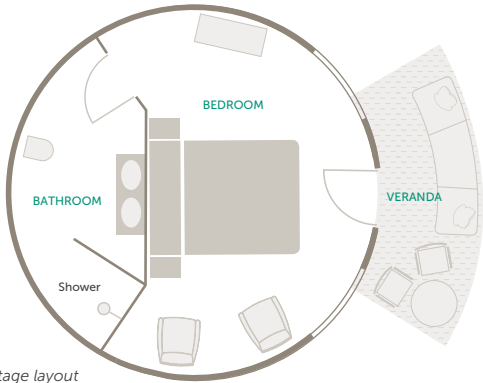

Typical Cottage layout

DISCOVER THE SERENGETI
& Beyond Klein's Camp Accommodation

FAMILY COTTAGE

1 interleading Family Cottage per camp / Max. of 2 adults & 2 children (3 children on request)



PERFECT FOR FAMILIES
The camp lends itself to group and family travel in the form of two Cottages that make up a Family Cottage. The Family Cottage is connected by an enclosed interleading passage, which allows easy access between the Cottages while maintaining complete privacy. Each Cottage has its own ensuite bathroom and a private veranda. The Family Cottage can accommodate two adults and two children (three children can be provided for on special request).

ROOM FACILITIES

Room size (square meters)	43 m ² (463 f ²)
Private veranda	Yes
Personal bar	Yes
Air conditioning / heating	No
Overhead fans	No
Mosquito nets	Yes
Bath	No
Shower	Yes, indoor
Separate W.C	Yes
Telephone	In-room telephones are available. Intermittent GSM mobile reception
Hairdryer	Yes
In-room safe	Yes
Internet access	Yes, Wi-Fi
Plug type	220V AC (plug points in rooms), Plug type G British – BS 1363
Triple bed option	2, for children 16 years and younger
Twin bed option	2, for children 16 years and younger

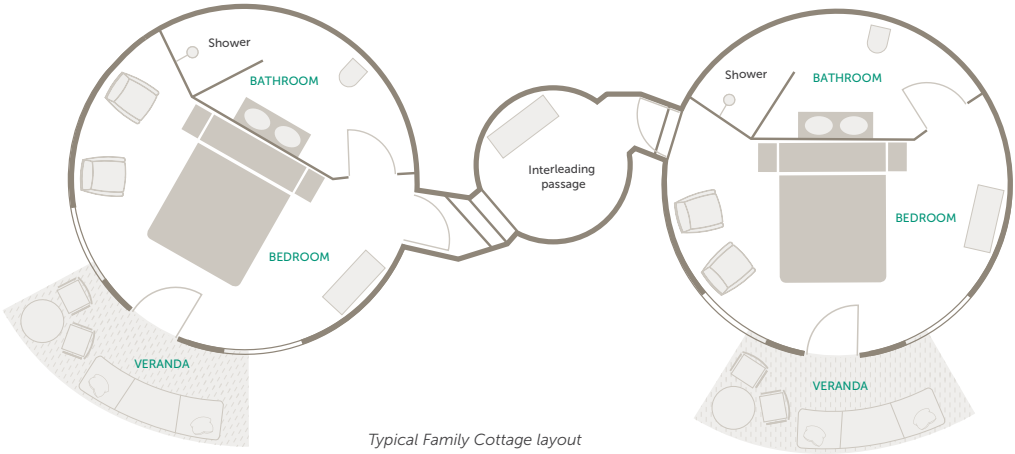

Typical Family Cottage layout



DISCOVER &BEYOND SERENGETI

Lodge comparison

Unique in look and experience; a quick highlight comparing Grumeti Serengeti River Lodge, Klein's Camp and Serengeti Under Canvas.

DISCOVER THE SERENGETI
Lodge Comparison

Lodge comparison

	SERENGETI UNDER CANVAS	KLEIN'S CAMP	GRUMETI SERENGETI RIVER LODGE
OVERVIEW			
Type of camp	Mobile tents	Permanent cottages	Permanent suites
Camp experience	Moves around the Serengeti 5 times a year in anticipation of the migration	Situated on a 10 000 hectare private concession	In the Serengeti National Park on the banks of a tributary of the Grumeti River
Maximum number of guests	21	20	22
Number of rooms	9 (per camp)	10	10
Family accommodation	1 Family Tent is available per camp	1 Family Suite consisting of 2 cottages with an interleading passage	1 Family Suite consisting of 2 guest suites with an interleading passage
Room types	Tented Suite	Cottage	Suite
Distance between rooms	Subject to camp location	10 m (33 ft)	Approx. 15 m (49 ft)
Pilot / Guide Accomodation	Available	Available	Available
Check-in / Check-out Times	14h00 / 10h00	14h00 / 10h00	14h00 / 11h00, with early check-in and late check-out on request
Camp GPS Coordinates	Dependent on current camp location	01°50.089'S 035°14.797'E	02°09.479'S 034°13.151'E
Camp Closure	Open year-round	Open year-round	Open year-round
FACILITIES			
Power	With prior notice we are able to provide 24-hour electricity for guests with special medical requirements	Please note that the camps have an inverter system, so while the generator is switched off overnight; guests have power for fans and lights. With prior notice we are able to provide 24-hour electricity for guests with special medical requirements	
Internet access	Yes, Wi-Fi throughout	Yes, Wi-Fi throughout	Yes, Wi-Fi throughout
Wine store or cellar	No	No	No
Boma	Camp fire	No	Yes
Interactive kitchen	Yes, outdoor kitchen	No	Yes, plus an outdoor pizza oven
Swimming pool	No	Yes, camp swimming pool (not heated)	Yes, main lodge pool and private plunge pools
Wellness offering	No	Offered in-room only	Offered in-room only
Fitness options	No	Gym-in-a-Basket in each room	On-site gym and yoga sessions available
Conference facilities	No	No	No
Weddings and blessings	No	Yes, consult travel specialist	Yes, consult travel specialist
Wheelchair accessibility	Possible with assistance in certain cases	Possible with assistance in certain cases	Not suitable for those with mobility issues
Complimentary laundry service	Yes, but limited (hand wash only)	Yes	Yes

DISCOVER THE SERENGETI
Lodge Comparison

Accommodation comparison

	SERENGETI UNDER CANVAS	KLEIN'S CAMP	GRUMETI SERENGETI RIVER LODGE
BEYOND Safari Shop	No	Yes	Yes
Room size (Square meters)	35 m² (376 ft²)	43 m² (462 ft²)	95 m² (1 023 ft²)
Private veranda	Yes, plus an enclosed sitting area	Yes	Yes, with private plunge pool
Personal bar	Yes	Yes	Yes
Air conditioning / heating	No	No	No
Overhead fans	No	No	Yes
Mosquito nets	No, sealed tent	Yes	Yes
Bath	No	No	Yes
Shower	Outdoor shower only with his-and-her showers	Yes, indoor	Yes
Separate W.C	Yes, without door in tent	Yes	Yes
Telephone	Intermittent mobile reception	In-room telephones are available Intermittent GSM mobile reception	In-room telephones are available Intermittent GSM mobile reception
Hairdryer	Available in central guest W.C tent	Yes	Yes
In-room safe	Yes	Yes	Yes
Plug type	220v AC in vehicles Central recharging station in camp Plug type G British – BS 1363	220V AC (plug points in rooms) Plug type G British – BS 1363	220V AC Plug Type C, D, M, N Adapters available
Triple bed option	1 triple per camp, please note that this is not available when the family tent is booked	2 Children 16-years and younger	1 Children 16-years and younger
Twin bed option	All convertible to twin or double	All convertible to twin or double	Yes, however, beds are within the same bedframe



andBEYOND



@andbeyondtravel
#seewhatliesbeyond

andBeyond.com

