

DISCOVER THE SERENGETI

&Beyond Serengeti Under Canvas

Follow the wildlife theatre of Serengeti's Great Migration, in unsurpassed under-canvas luxury. Dine under an African night sky, and live the adventure. Leave only footprints.



&BEYOND

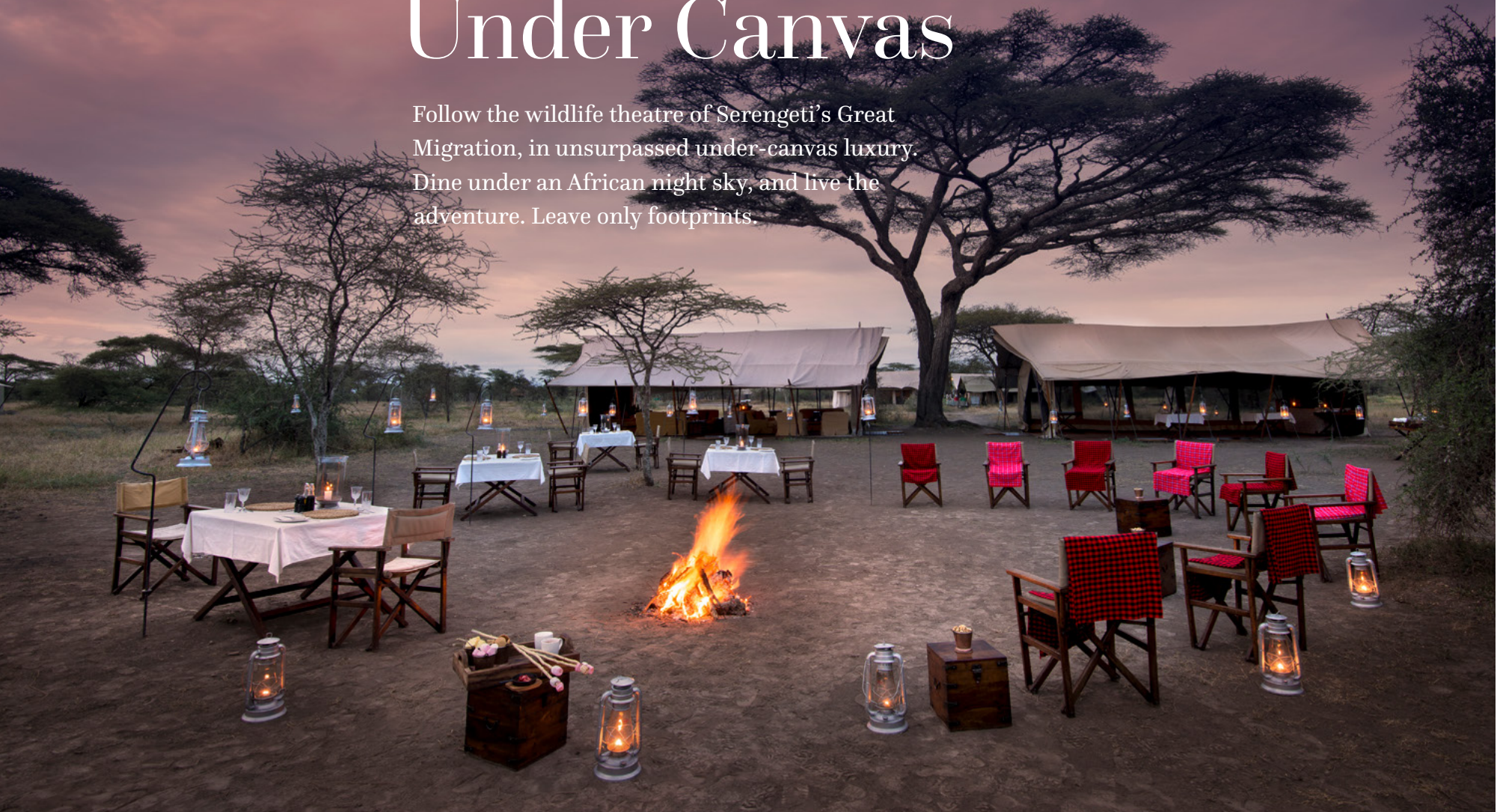

DISCOVER THE SERENGETI

8Beyond Serengeti Under Canvas

Why stay?

1 CLOSE TO THE ACTION OF THE GREAT MIGRATION

The 8Beyond Serengeti Under Canvas camps attempt to anticipate the movements of the Great Migration, bringing you as close as possible to the wildebeest action, as well as observing magnificent resident game. The campsites move five times a year providing you with the opportunity to enjoy a privately-guided Great Migration experience. Explore with our professionally trained guides, among the best in the industry and enjoy the opportunity to customise your daily game viewing activities according to your interests.

2 PRISTINE LANDSCAPES AND ICONIC WILDLIFE

The ultimate remote getaway in the midst of the vast herds. Enjoy seasonal sightings of the Grumeti and Mara River crossings in western and northern Serengeti respectively, and wildebeest calving season at Ndutu in southern Serengeti. There is exceptional resident game year-round, big cat sightings where lion and leopard are frequently seen and unique wildlife, including a topi migration near Grumeti, rhino in the north, excellent cheetah sightings in the south and big elephant herds throughout.

3 MOST LUXURIOUS TENTS IN THE SERENGETI

Old-world glamour with the elegance of classic safari. Unwind in the most extravagant mobile tents in the Serengeti, with sophisticated camping in private campsites close to the annual Great Migration. Experience the theatre and adventure of the African bush in comfort and luxury with a private butler, hot bucket shower, and crystal glassware. Enjoy evening drinks around the camp fire, before dining under the stars and falling asleep to the sounds of lions roaring.



**An out-of-this-world experience!
We ate dinner under the Milky Way
on fine China and crystal. A must
when visiting the Serengeti.** ”

8BEYOND GUEST

DISCOVER THE SERENGETI
&Beyond Serengeti Under Canvas

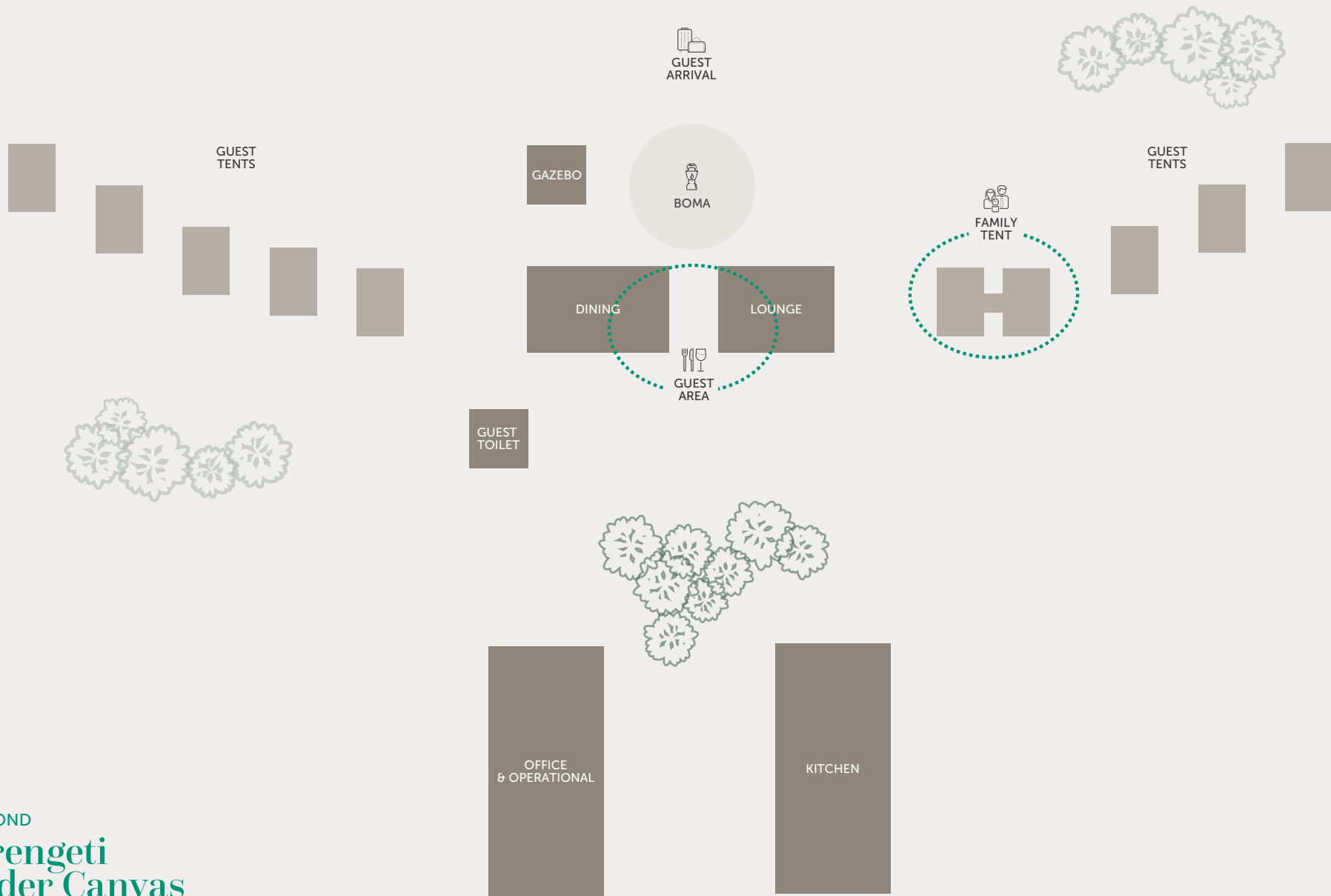

DISCOVER THE SERENGETI
&Beyond Serengeti Under Canvas

Camp overview

CAMP

Maximum number of guests	21 (per camp, including children)
Number of rooms	9 (per camp)
Family accommodation	1 Family Tent is available per camp
Pilot / Guide accomodation	Yes
Room type	Tent
Distance between rooms	Subject to camp location
Check-in / Check-out times	14h00 / 10h00

DINING

Food / Dietary options	Kosher not available. Halaal and other special dietary requests available: please book in advance
Private butler service	Yes
Private dining	Yes

PAYMENT TYPES ACCEPTED

Credit cards accepted	Mastercard and Visa
Currency	USD are widely used, however, notes dated prior to 2006 are not accepted

FACILITIES

Power	With prior notice we are able to provide 24-hour electricity for guests with special medical requirements
Wine store or cellar	No
Boma	Camp fire
Interactive kitchen	Yes
Swimming pool	No
Wellness offering	No
Fitness	No
Conference facilities	No
Wheelchair accessibility	Possible with assistance in certain cases
Complimentary laundry service	Yes
&Beyond Safari Shop	No

OTHER

Vehicle type	4 and 6-seater semi-open safari vehicle
Private 4x4 safari vehicle	Depending on availability and at an additional cost
Private photographic vehicle	No

&BEYOND SERENGETI UNDER CANVAS

A luxurious tented camp

This versatile camp moves around the park year-round, attempting to anticipate the movements of the Great Migration. Using only private campsites, these mobile camps are entirely intimate and exclusive.



&BEYOND



&BEYOND EAST AFRICA

DISCOVER THE SERENGETI

&Beyond Serengeti Under Canvas Accommodation

Under-canvas luxury

&Beyond Serengeti Under Canvas features nine elegant safari Tents per camp, including one Family Tent. Revel in a classic tented safari, with only the canvas walls separating you from the natural wonders of the Serengeti.



PRIVATE BATHROOM VANITY



TENT INTERIOR



HIS-AND-HER AL FRESCO BUCKET SHOWER

DISCOVER THE SERENGETI
Beyond Serengeti Under Canvas Accommodation

TENT

9 Tents per camp / Max. 21 guests per camp including children

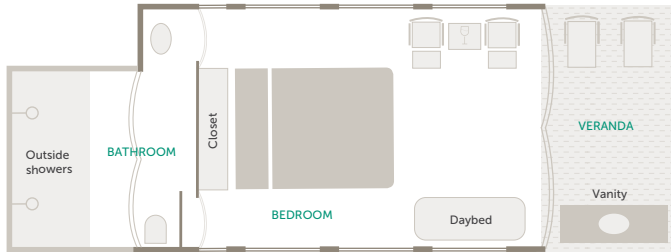

Typical Tent layout

ULTIMATE GLAMPING

Two private camps feature luxurious ensuite safari tents entirely intimate and exclusive, each with a double bed, bathroom and separate WC, as well as an indoor sitting area, personal bar and his-and-her al fresco bucket showers. Redolent of classic safari style, custom-made rugs, crisp linens, sparkling crystal and polished brass lend flair to the simplicity of camping.

ROOM FACILITIES

Room sizes (Square meters)	35 m ² (377 ft ²)
Private veranda	Yes
Personal bar	Yes
Air conditioning / heating	No
Overhead fans	No
Mosquito nets	No, sealed tent
Shower	Outdoor shower only, his-and-her bucket showers
Separate WC	Yes, inside tent without a door
Telephone	No, intermittent mobile reception
Hairdryer	Available in central guest WC tent
In-room safe	Yes
Internet access	Yes, Wi-Fi
Plug type	Plug type G British (220v AC) in tents and vehicles With prior notice we are able to arrange for a generator to provide 24-hour electricity for guests with special medical requirements
Triple tent option	1 Triple Tent available per camp 1 Family Tent with a triple that can be booked on request
Twin bed option	All beds are convertible into twin or double

DISCOVER THE SERENGETI
Beyond Serengeti Under Canvas Accommodation

FAMILY TENT

1 interleading Family Tent per camp / Max. 2 adults & 2 children (3 children on request)



PERFECT FOR FAMILIES
The camp lends itself to family travel in the form of two spacious Tents with an interleading passage that makes up a Family Tent. Each tent has its own ensuite bathroom and a private veranda and seating area.

ROOM FACILITIES

Room sizes (Square meters)	24 m ² and 35 m ² (258 ft ² and 377 ft ²)
Private veranda	Yes
Personal bar	Yes
Air conditioning / heating	No
Overhead fans	No
Mosquito nets	No, sealed room
Shower	Outdoor shower only, his-and-her bucket showers
Separate WC	Yes
Telephone	No, intermittent mobile reception
Hairdryer	Available in central guest WC tent
In-room safe	Yes
Internet access	Yes, Wi-Fi
Plug type	Plug type G British (220v AC) in tents and vehicles With prior notice we are able to arrange for a generator to provide 24-hour electricity for guests with special medical requirements
Triple bed option	Yes, triple available on request
Twin bed option	All beds are convertible into twin or double
Interleading walkway	Yes

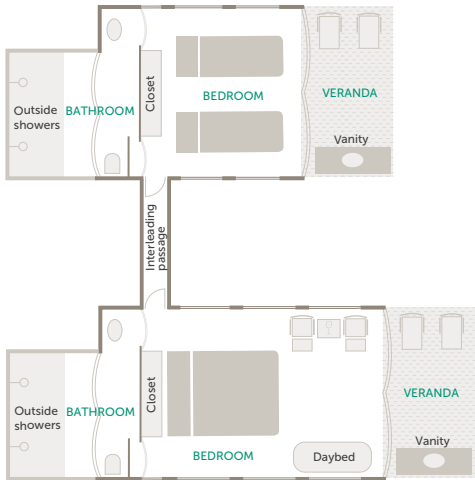

Typical Family Tent layout

DISCOVER THE SERENGETI

Beyond Serengeti Under Canvas Experiences

Experiences and highlights

Experience far beyond the expected in the Serengeti with adventures of a lifetime.



1

SAFARI GAME DRIVE

Game drives in the Serengeti are unforgettable due to the abundance of wildlife and the spectacular landscapes. Travellers can expect to encounter large numbers of animals year-round, with big herds of elephant, buffalo and other plains game. It is also common to see predator interaction. Game drives may last from a couple of hours to the whole day, with a picnic breakfast and lunch.

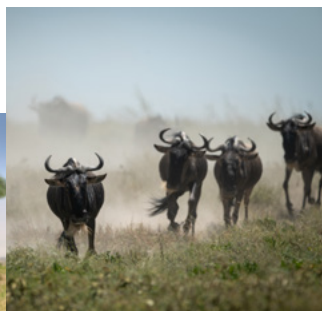

2

THE GREAT MIGRATION

The famous Great Migration is a year-round cycle in which 1.5 million wildebeest, 400 000 zebra, 300 000 Grant's and Thomson's gazelle, and 12 000 eland participate. These animals move from the dryer southern part of the ecosystem, the short-grass plains of the south eastern Serengeti, and head to the moister northern part, the northern Serengeti woodlands and the Masai Mara plains, and back again.



3

AL FRESCO DINING

Revel in the wide open landscapes of Africa as you savour a meal served outside (unless it is raining, in which case you are enjoying your meal in the dining tent). Your butler will always pick the perfect place for you, for example under a tree, next to the camp fire at night or the privacy of dinner for-two outside your tent.



4

HOT AIR BALLOON SAFARI*

Glide in a hot air balloon over the migration herds in the Serengeti on this captivating experience. Float in whichever direction the winds of the morning takes you. Marvel at the views of the sweeping plains below and wildlife dotted across the landscape. End off your experience with a delicious breakfast spread in the heart of the Serengeti plains.



5

STARGAZING

Explore the vast night sky and its stunning constellations gathered around a cosy campfire. Scan the velvet expanse and observe the northern and southern hemisphere stars in one place. Marvel at the infinite sky, which features the Big Dipper in the northern hemisphere and the Southern Cross and Pointers in the southern hemisphere.



6

OLDUVAI GORGE AND SHIFTING SANDS*

When the camp is in Ndutu, in the southern Serengeti, explore the breathtaking surrounds of the archaeological site of Olduvai Gorge, the cradle of mankind, best known as home of the earliest remains of Homo sapiens. Move on to the crescent-shaped volcanic ash dunes known as Shifting Sands, which slowly creep across the desert floor in response to prevailing winds.

DISCOVER THE SERENGETI
&Beyond Serengeti Under Canvas Experiences

Seasonal highlights

TIMING IS EVERYTHING

	JAN	FEB	MAR	APR	MAY	JUN	JUL	AUG	SEP	OCT	NOV	DEC
Big Five game viewing	✓	✓	✓	✓	✓	✓	✓	✓	✓	✓	✓	✓
Migration in the short grass plains of the southern Serengeti	✓	✓	✓	✗	✗	✗	✗	✗	✗	✗	✗	✗
Migration in the central Serengeti Plains	✗	✗	✗	✓	✓	✗	✗	✗	✗	✗	✗	✗
Migration in the Western Corridor / Grumeti River crossing	✗	✗	✗	✗	✗	✓	✓	✗	✗	✗	✗	✗
To view migration in the northern Serengeti	✗	✗	✗	✗	✗	✗	✓	✓	✓	✗	✗	✗
Migration makes the southward journey back to the Serengeti	✗	✗	✗	✗	✗	✗	✗	✗	✗	✓	✓	✓
To view baby animals and interesting predator-prey interaction	✓	✓	✓	✗	✗	✗	✗	✗	✗	✗	✓	✓
Hot air balloon safari	✗	✗	✗	✗	✗	✓	✓	✓	✓	✓	✗	✗
SEASONAL RATES*	\$\$\$	\$\$	\$\$	\$	\$	\$\$	\$\$\$	\$\$\$	\$\$\$	\$\$\$	\$\$\$	\$\$\$

* The \$ / \$\$ / \$\$\$ references are used to indicate rate variation and are not associated with specific values.

Absolutely the most exciting experience ever. Words can't express the magnificence of the landscape and animals. A bucket list trip.

&BEYOND GUEST



DISCOVER THE SERENGETI
&Beyond Serengeti Under Canvas

Inclusions

RATE INCLUDES

Accommodation	✓
Three meals daily	✓
Soft drinks, house wines, local brand spirit and beers, teas and coffees	✓
Refreshments on game drives	✓
Laundry (limited)	✓
One complimentary pair of SWAROVSKI OPTIK CL Companion 8x30 binoculars per tent to share during your stay	✓
Emergency medical evacuation insurance	✓
Transfers to / from the camp airstrip	✓
WILDchild programme	✓
Twice-daily game drives	✓

RATE EXCLUDES

Administration fee	✗
Telephone calls	✗
Gratuities	✗
Personal items	✗
Champagne, cognac, fine wines, premium brand spirits, cigars	✗
Park fees (and government charges)	✗
Hot air balloon safaris	✗
Cultural visits to Olduvai Gorge and Shifting Sands when camps are located at Ndutu	✗
Weddings and blessings	✗

Such care was taken with us and the level of authentic, personal attention made us feel so special.

&BEYOND GUEST

NOTE: Unmanned Aerial Vehicles: Please be advised that the use of unmanned aerial vehicles (drones) are prohibited in the conservation areas we manage, until such time as their impact on wildlife and anti-poaching initiatives can be assessed. This rule will apply throughout Africa, as our partners in various countries and regions have adopted a similar stance.



DISCOVER THE SERENGETI

Great Wildebeest Migration

1 ONE OF THE 7 NATURAL WONDERS OF THE WORLD

Considered the most thrilling spectacle in the animal kingdom, this epic journey migrates from Tanzania's Serengeti to Kenya's Masai Mara.

2 THE WORLD'S LARGEST OVERLAND MAMMAL MIGRATION

The annual movement of wildebeest and other herbivores across the Serengeti-Mara ecosystem consists of more than 1.5 million wildebeest, 500 000 zebra, 200 000 Thompson's gazelle and 18 000 eland.

3 THE ANIMALS MIGRATE OVER 800 KM (500 MI)

Due to the sheer size of the herd, the animals have to move to be able to survive. The herds generally follow the rain, as where there is rain, there is fresh grass. Once grass is depleted in one area, they will move to another grassy area.

It's estimated 500 000 wildebeest calves are born annually.

The annual movement of wildebeest and other herbivores across the Serengeti-Mara ecosystem is rarely the same in terms of precise timing and direction.

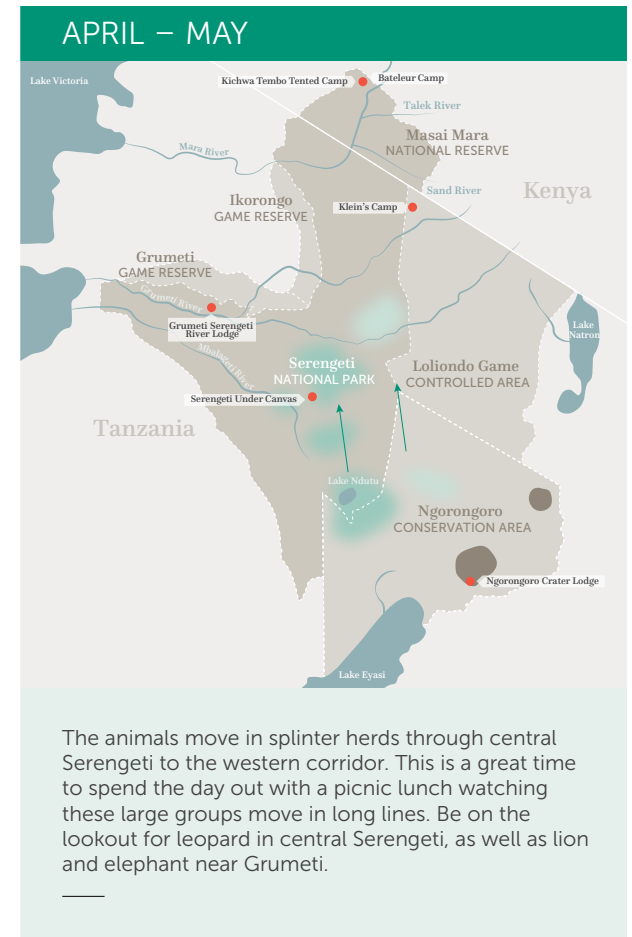
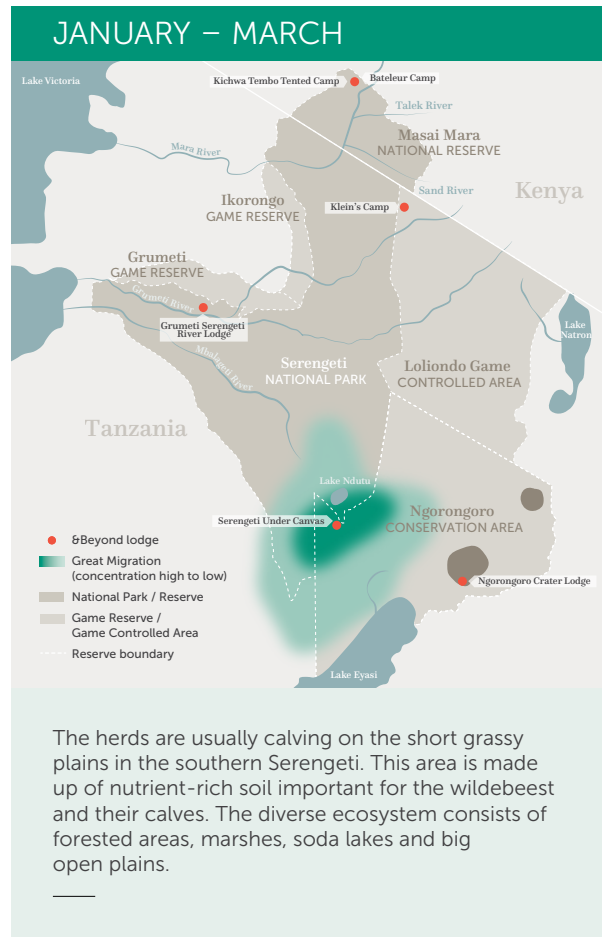

(continues on next page)

DISCOVER THE SERENGETI

Great Wildebeest Migration (cont.)

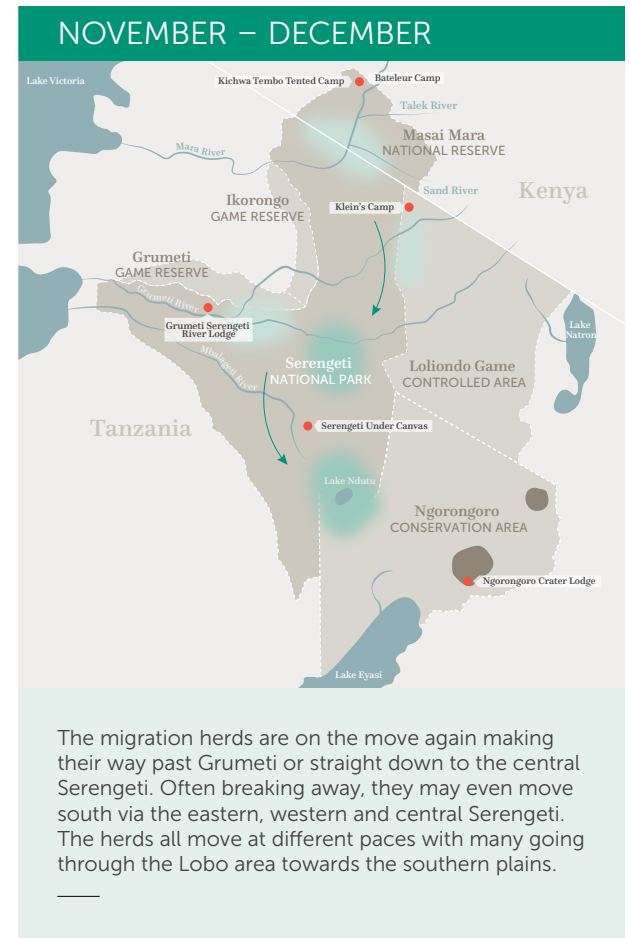
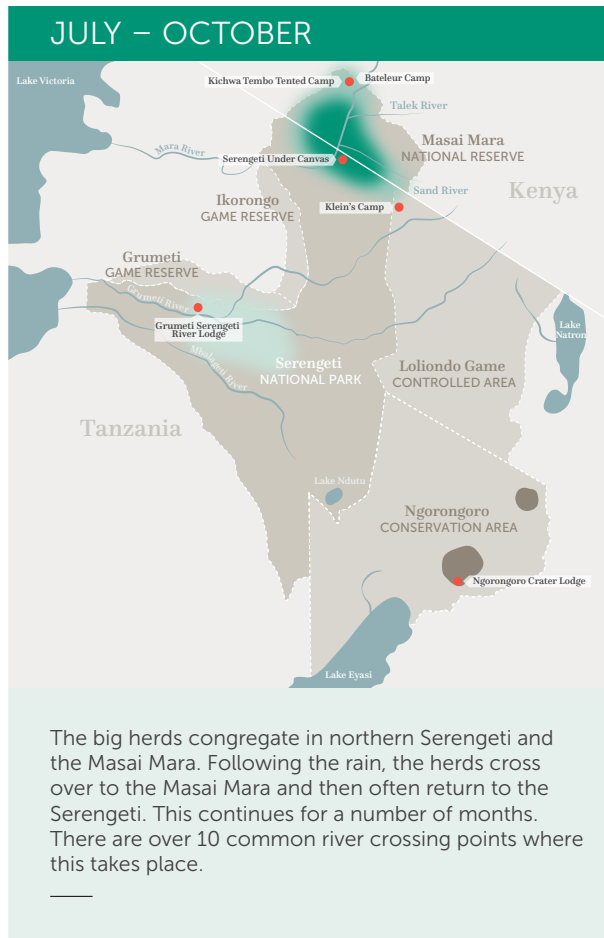
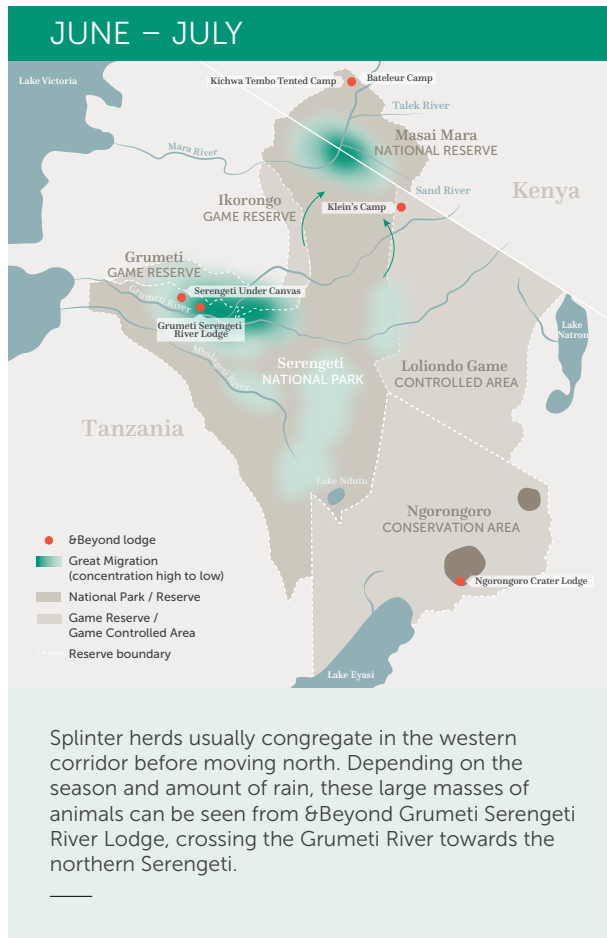

DISCOVER THE SERENGETI

BEYOND Serengeti Under Canvas

WILDchild

Travel to Tanzania is recommended for children eight years or older. Please note that due to the camp not being fenced off children are required to have an adult accompanying them at all times. Please note that no children under six years of age are allowed at BEYOND Serengeti Under Canvas.

BEYOND Serengeti Under Canvas cannot accommodate more than four children at the camp at any given time.

WILDCHILD ADVENTURES AT SERENGETI UNDER CANVAS

Children will have the opportunity to embark on our very exciting WILDchild programme, filled with fun, interactive activities that offer opportunities to learn and discover new experiences and cultures. Our adventures at BEYOND Serengeti Under Canvas include:

- Learn to play Bao
- Bush survival - like the Maasai
- Fashion a traditional Maasai bow and arrow and join a spear throwing competition
- Fire making the Maasai way
- Roasting marshmallows and stargazing

CHILD POLICY*

0 - 5 years	No children under six years of age
6 - 11 years	Game drives at the discretion of the camp manager. Shortened game drives available on request
12 - 15 years	Permitted on game drives
16 years and above	All activities permitted

**A private vehicle can be booked to accommodate families with children aged 6 to 11 years for game drives. Access to wildlife sightings is at the discretion of the guide, based on the behaviour of both the children and the animals. Private vehicles are subject to availability and incur an additional cost.*

Hot air balloon safari

Seronera / Serengeti South / Grumeti regions: Children seven years and older
Kogatende: Children six years and older

CHILDMINDING

While we don't have trained childminders, we can offer the services of certain staff members who are wonderful with children. This will be at an additional cost.

Please note: The camp is not fenced off and children are required to have an adult accompanying them at all times

FAMILY ACCOMMODATION

2 Family Tents, 1 at each campsite
(Two tents in close proximity linked by an enclosed walkway)

Get your children travelling early.
Expose them to the people, the food and
the real culture of your destination. ”

BEYOND GUEST



Sustainability initiatives

In partnership with Wild Impact*, our long-standing community and conservation development partner.



CARE OF Land

- 228 000 plastic bottles eliminated annually through on-site water bottling plants
- 684 000 litres of water saved (3 litres used to make a 1 litre plastic bottle)
- 4 265 kg plastic eliminated annually
- Zero plastic straws
- All guest amenities recyclable
- 728 000 kg CO₂ per year reduction in our Tanzanian carbon footprint since 2018
- Over 783 million TZS invested to ensure the minimum impact of our lodges



CARE OF Wildlife

- An average 2 100 community children per year receive conservation lessons, creating awareness through education
- USD 50 000 invested as a founding member of the Lionscape Coalition, a joint initiative between members of the ecotourism industry and the Lion Recovery Fund, in a collaboration dedicated to securing a future for Africa's wild lions
- USD 25 000 of the Lionscape Coalition investment has supported two powerful lion conservation programmes in Tanzania: KopeLion and the Serengeti De-Snaring Programme.



CARE OF People

- 101 Star-in-Training lodge trainees from the local community receive on-site training and workplace experience
- 78% of our Tanzania lodges' operational expenses support local procurement
- Over 1.5 billion TZS spent on community-led social infrastructure 2018 - 2020
- 124 tertiary education bursaries awarded to rural learners through Wild Impact's CLEF (Community Leaders Education Fund) programme since 2014
- Over 62.7 million TZS raised to provide COVID-19 support for rural schools and clinics

DISCOVER THE SERENGETI

Travel Tanzania and beyond

Visiting East Africa and travelling across this vast landscape requires much thought and attention. Contact your preferred travel specialist to assist with your travel plans.

GETTING TO THE SERENGETI

Coastal Aviation, Auric Air and Regional Air Services offer daily departures from Arusha and Dar es Salaam. These flight networks link all of the major parks, reserves and Beyond lodges.

Daily non-direct flights connect the same parks, reserves and Beyond lodges to Zanzibar.

Flight networks connect to the Masai Mara via two points, one via Kilimanjaro and Wilson Airport in Nairobi, and the other via Tarime and Migori.

The Serengeti, Tarangire and Lake Manyara are accessible by road from Arusha.

Flights connect to Kigali via Mwanza and to Entebbe via Musoma.

TRAVEL TIMES

ARUSHA		SERENGETI - KOGATENDE (FURTHEST POINT)		NGORONGORO		LAKE MANYARA		KILIMANJARO		SELOUS GAME RESERVE		TARANGIRE NATIONAL PARK		RUHAHA NATIONAL PARK		MAHALE MOUNTAINS AND KATAVI NATIONAL PARKS		DAR ES SALAAM AND COAST	
✈	Not advised 2hrs 40mins																		
✈	4hrs 30mins 30mins	6hrs 1hr 25mins																	
✈	2hrs 20mins	7hrs 1hr 25mins	2hrs Not advised*																
✈	2hrs 20mins	Not advised 2hrs 15mins	5hrs 2hrs 35mins	5hrs 35mins															
✈	Not advised 3hrs 15mins	Not advised 5hrs 15mins	Not advised 5hrs 50mins	Not advised 3hrs 50mins	Not advised*														
✈	2hrs 30mins 20mins	8hrs 20mins 1hr 35mins	4hrs Not advised*	2hrs Not available	3hrs 45mins Not advised*	Not advised 8hrs 25mins**													
✈	Not advised 2hrs	Not advised 4hrs 15mins	Not advised 4hrs 35mins	Not advised 2hrs 35mins	Not advised 2hrs 20mins	Not advised 1hr 45mins	Not advised 1hr 20mins												
✈	Not advised 5hrs 30mins	Not advised 5hrs 30mins	Not advised 7hrs 30mins	Not advised 5hrs 30mins	Not advised 5hrs 30mins	Not advised*	Not advised*	Not advised*											
✈	Not advised 2hrs 30mins	Not advised 4hrs 35mins	Not advised 4hrs 55mins	Not advised 2hrs 55mins	Not advised 2hrs 20mins	Not advised 50mins	Not advised 5hrs	Not advised 2hrs 5mins	Not advised*										

* Poor connection due to: Layover time / no connection / peak periods only / private charter required. ** Includes flight to Manyara and 2hr road transfer time. Disclaimer: All flights may include multiple stops and scheduling is a guideline – times will vary and scheduling is coordinated mainly by operations teams on the ground. Flight schedules are more limited in off-peak periods. Above times are based on best-practice logistics and exclude transfers to and from lodges.

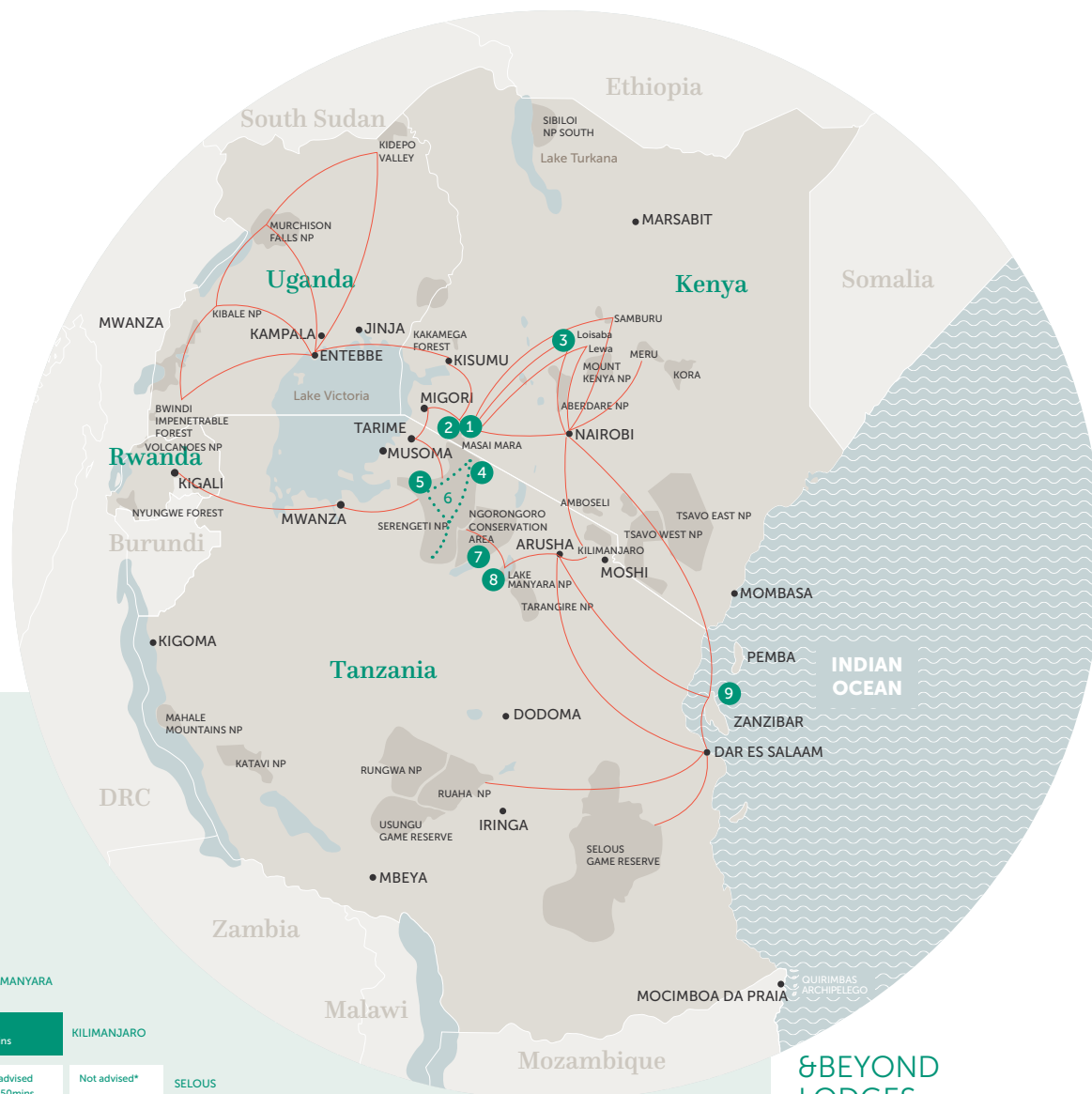

BEYOND LODGES

KENYA

- 1 Bateleur Camp
- 2 Kichwa Tembo Tented Camp
- 3 Suyian Lodge

TANZANIA

- 4 Klein's Camp
- 5 Grumeti Serengeti River Lodge
- 6 Serengeti Under Canvas
- 7 Ngorongoro Crater Lodge
- 8 Lake Manyara Tree Lodge
- 9 Mnemba Island



andBEYOND



@andbeyondtravel
#seewhatliesbeyond

andBeyond.com

