

MARA NYIKA CAMP

NABOISHO CONSERVANCY | MAASAI MARA



“Nyika” means “Large Plains or Great Plains.”

It rings with the romance of the vast open plains of East Africa from a time when light canvas flapped in the light breeze across those plains as wildebeest and zebras call to each other and at twilight, “Simba,” the great lion’s roar could be heard across the Nyika.

“I spent over three years circling the site of the camp, identifying one site and then another, looking for light or noise pollution and finally settling on an exceptional place,” says Dereck Joubert. “One where each time we visited, we saw a male leopard or a lioness and cubs. A site where no one else will see our lights or canvas. A safari is about creating a story, an ideal dream, and we want to create our own without eroding someone else’s.”

Typical of the Maasai Mara’s ancient Nyika is the flat-topped Acacia kirkii trees. The Dereck Joubert designed guest suites take advantage of these umbrella thorn trees’ shade. While the camp is in a valley, actually straddling a small seasonal stream, the suites are set up high under the tree’s canopy to offer guests awe-inspiring views out over the bush.

Many may think of Mara Nyika Camp as a treetop camp, with the suites’ walkways to the main area giving a feel of a treehouse under canvas. However, the camp’s ethic and inspiration are still one of exploration and adventure - a sense of impermanence in this ever-changing world. Privacy in this camp is the key to understanding it. Privacy to live, think, explore, be romantic, and be pampered – all the while with one of the most spectacular backdrops Africa can provide. The camp is a proud Relais & Châteaux member.

Mara Nyika Camp, located in the private and exclusive Naboisho Conservancy, is unique because it allows guests to explore the conservancy and further afield with safari drives into the Maasai Mara National Reserve. Guests’ stays enables us to support over 500 Maasai families with a sustainable livelihood through the payment of conservation fees, which ultimately ensures the conservation of the wildlife in this vital corridor of the Maasai Mara eco-system.

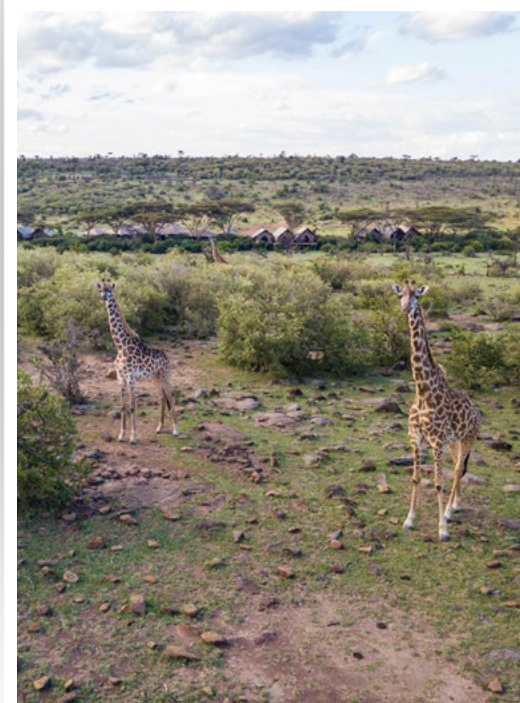

MARA NYIKA CAMP

NABOISHO CONSERVANCY | MAASAI MARA

Many Mara Nyika's guests spend a few days here before extending their safari to either our Mara Expedition, Mara Toto Tree Camp or Mara Plains Camps. Combining these camps ensures a more comprehensive wildlife experience as guests explore all three wildlife areas: the private Olare Motorogi and Naboisho Conservancies and Maasai Mara National Reserve. Each wildlife experience from our camps is unique and offers different Mara faces, which is an unbelievable bonus.

CAMP FEATURES

Mara Nyika Camp can accommodate up to 12 adult guests.

Total Number of Bedrooms:

- 4 double or twin configuration guest suites;
- One two-bedroom family suite;
- The two-bedroom private Sambuk Suite at Mara Nyika can accommodate a family of 5 with 2 adults and 3 children (aged 6 – 15 years), or 4 adults traveling together;
- 2 guide tents with a bed and bathroom

Type of Lodge:

Réserve-Collection Safari Camp

Lodge Season & Opening:

Year Round

Ideal length of stay:

3 / 4 Nights



CHECK OUT TIME

We maintain a high level of flexibility when it comes to check-out times at our camps. However, due to certain air transfer schedules, there are instances where we may kindly request guests to check out of their suites by 9:00am. In such situations, our lodges and camps are set up to ensure that guests can utilise the facilities located in the central area. This includes access to Wi-Fi, the provision of complimentary drinks and lunch in the event of any unexpected delays, and access to hides or other activities if available.

CAMP COORDINATES

1°22'30.6"S 35°17'24.6"E

ACCESS DIRECTIONS

- Scheduled aircraft transfers to the nearby Naboisho (ol Seki) airstrip, from Nairobi's Wilson domestic airport (flying time 1hr 15mins) and other locations in Kenya;
- Private air charter access is available;
- Mara Nyika Camp is an approximate 40-minute drive from the airstrip, often with wildlife viewing opportunities en route;
- ol Seki coordinates: S01°22.557', E035°17.649';
- ol Seki Airstrip length: 1,300 m.

MARA NYIKA CAMP

NABOISHO CONSERVANCY | MAASAI MARA



ACTIVITIES

Wildlife viewing

Early morning, late afternoon/ evening or even full day safari drives in some of the most luxurious wildlife-viewing vehicles are available. Each Toyota Land Cruiser is open-sided, canopied, and customised for photographers with fold-down screens, raised roofs, photographic bars, and multi-plug inverters, all in keeping with the origins of Dereck & Beverly Joubert as National Geographic photographers. We choose to accommodate four guests (or two couples) on a safari vehicle; however, if a family or group travels together, we would easily accommodate up to six guests.

Every day on safari brings a unique and distinct experience. Safari drives often start at sunrise, returning to camp for a late breakfast and departing again in the mid-afternoon after tea before returning just after sunset. However, we can often go out all day with a packed breakfast, lunch, and beverages, should you wish. For those guests that stay three nights or longer, a visit into the famous Maasai Mara National Reserve can be arranged.

Very often, our safaris will continue into the night, a possibility because of our location on the private Naboisho Conservancy. Night drives are incredibly prolific, and while they take patience, sightings often include lesser-known nocturnal species and sometimes even lion or hyena hunts.

Our schedule is flexible, and guests are encouraged to create their own itinerary according to their interests with guidance and recommendations from our professional guides.

Hot Air Ballooning

Hot air ballooning is available at an additional cost and should be booked in advance, subject to availability. Departures are very early in the morning to allow time to transfer to the nearest launching point.

Great Plains Foundation Guest Experiences

Mara Nyika Camp offers guests the opportunity to experience the Maasai Mara through community, conservation, and cultural connection. Spend time with the Naboisho Women's Group, a Great Plains-supported enterprise where women create beautiful beaded crafts, soaps and honey. Visit a Great Plains Bridge, built to connect villages during flood season, or a partner school, engaging with students and contributing to education programmes. Guests can also join Conservation Roots, planting an indigenous tree to leave a positive legacy in the Naboisho Conservancy.

MARA NYIKA CAMP

NABOISHO CONSERVANCY | MAASAI MARA

Photography

Each of Mara Nyika's guest suites comes with a pair of high-quality binoculars for guests to enjoy in addition to a professional camera set, including a camera body and 100-400mm and 24-70mm lenses. Our team will download guests' photos to a memory stick on departure.

Private vehicle option

Available for more flexibility upon request at extra cost; Not compulsory for families travelling with children.

Private Guides

Private guides are encouraged and welcomed.

CENTRAL FACILITIES

- Main lounge;
- Dining room, library, wine cellar, and bar;
- Coffee/tea station;
- Outdoor fire pit with seating;
- Great Plains Safari Boutique: Selling locally and regionally produced crafts, many of which support local community projects in the nearby Maasai communities. The Boutique also stocks the d&b clothing line: Dereck and Beverly Joubert have inspired this bespoke range of clothing they typically wear, and which is perfect and cool while on safari yet elegant when in the city. All materials are responsibly sourced. Visit dbexplorercollection.com

FOOD AND BEVERAGE

- Our world-class meals are Relais & Châteaux recognised;
- All meals included and prepared by our Executive Chefs and their teams in a state-of-the-art kitchen that guests are welcome to visit;
- All drinks and beverages are included, including imported spirits and champagnes;
- Group meals or individual tables, with à la carte menu options;
- Indoor and outdoor dining;
- Private dining on guests' verandah on request;
- All dietary requirements are catered for - from regular to vegan to children's meals - with prior notice required;
- We are extremely flexible on timings. Picnic breakfasts or lunch (or both) are the norm due to very active safari drives, often delivered to the bush!

ACCOMMODATION DETAILS

Bedroom features

- 4 Guest suites each measuring 1,000 sq. ft., with private verandah (of nearly equal size);
- The Family Suite enjoys a common lounge area, flanked by two bedrooms (one with a double bed and other with a twin-bed configuration), and two en-suite bathrooms (one with bath and shower and one with only shower);
- The two-bedroom private Sambuk Suite at Mara Nyika offers private wildlife viewing vehicle & guide - separate fact sheet available;



MARA NYIKA CAMP

NABOISHO CONSERVANCY | MAASAI MARA

- Customised, large, elevated, treehouse-styled canvas tented suites on raised wooden decking and linked to main area by raised wooden walkways;
- Desk and dressing area as well as small lounge;
- Bar fridge with drinks of choice;
- Tea and coffee station;
- Suites are light beige in colour with high ceilings and netted windows, making them airy and bright;
- Mosquito net;
- Overhead ceiling and standing fan;
- Either twin or double bed configuration.

Bathroom features

- En-suite with flush loo, shower (indoor), copper bathtub and double basins;
- Hot and cold running water.

ACCOMMODATING CHILDREN AND SHARING ACCOMMODATION

- We look forward to welcoming children aged 6 years and older;
- Triples for children sharing with adults may be arranged upon request;
- The Mara Nyika Family Suite is perfectly suited to accommodate a family of 4 guests;
- The private Sambuk Suite at Mara Nyika can cater for a maximum of four adults sharing or two adults and up to three children (aged 6 – 15), sharing in two separate bedrooms;
- Families with children may be accommodated in the same vehicle as other guests;

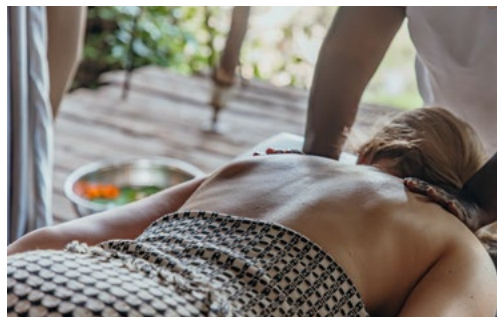

- Young children must be supervised as the camp is open, with high predator densities in and around camp and there is a river nearby;
- Great Plains Young Explorers Kids' programme is available – thoughtfully designed to explore various experiences and topics from birding to cooking to art to tracking wildlife.

SPA TREATMENTS

Locally inspired wellness spa treatments are available for in-room treatments.

FITNESS

Yoga mats, light weights and an exercise bike are provided in each suite.

LAUNDRY

Included in nightly tariff - next-day service, weather permitting.

POWER AND COMMUNICATION

Power

- The camp is run by an impressive solar farm;
- This system produces 240V, 24-hour electricity to the suites and main area;
- Plug points in each suite;
- Type of plug: large British three-pin; converters available for most international plugs;
- The power system does not support hairdryers, shavers or any high wattage device (low voltage hairdryers provided).

MARA NYIKA CAMP

NABOISHO CONSERVANCY | MAASAI MARA

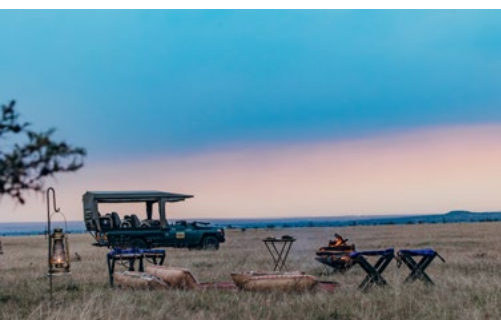

Internet & Mobile

- Mobile reception is generally reliable;
- Complimentary Wi-Fi is available in each guest suite;
- To maintain the peaceful safari atmosphere, we ask that cell phones and computers not be used in public areas or on safari vehicles. Phones may be used for photography only.

HEALTH AND SAFETY

Health

- Malaria: Minimal exposure risk– Malaria prophylaxis is recommended if guests are concerned; however, this is a remote area with little occurrence;
- Kenya is considered a Yellow Fever Zone. Consult your medical practitioner prior to travel.
- Guests must hold comprehensive medical insurance and emergency evacuation insurance;
- All senior staff have first aid training;
- Nearest decent medical facility is in Nairobi.

Possibility of Disabled Access

The camp layout is conducive to guests who use wheelchairs due to interconnected raised decking and pathways between suites and the main area. There are steps between the main entrance and arrival bridge, but our staff will be on hand to assist;

Safety

- The camp is unfenced, allowing wildlife to move through the property, especially at night. Security guards are armed with traditional spears;
- Fire extinguishers are available in each suite.

MONEY MATTERS

Safes

Safes are provided in every suite.

Accepted Payment on Location

- Staff gratuities can be paid in Kenyan Shillings, US Dollars, Euro and British Pounds - preferably in cash - to the staff member concerned who has truly exceeded expectations in terms of hospitality, service, and experience;
- Credit card facilities are available in camp (except American Express), subject to 3.5% charge, for payments of additional items such as boutique store purchases, spa treatments etc.

The Team

Lodge Owners

Great Plains Conservation

MARA NYIKA CAMP

NABOISHO CONSERVANCY | MAASAI MARA



FOUNDATION INITIATIVE

Naboisho Womens Group

Great Plains supports the Naboisho Women's Bead Group, based in the community of Nkoilale not far from Mara Nyika. Great Plains' support for the project helps the group to bulk purchase beads and other raw materials for their products and provides training, sales & marketing support. The project enables women in the local community to bolster household income, in turn supporting food security, education, health and more for their families. The project directly impacts the 105 households of the women in the group which means that nearly 1000 people are directly impacted by the money the programme generates.

In addition to our own programs Great Plains Foundation keeps a list of school needs in the countries where we work. Needed items can be hand-carried by travelers or we can help purchase them locally. To learn more or to help support students and educators as part of your trip please reach out info@greatplainsfoundation.com



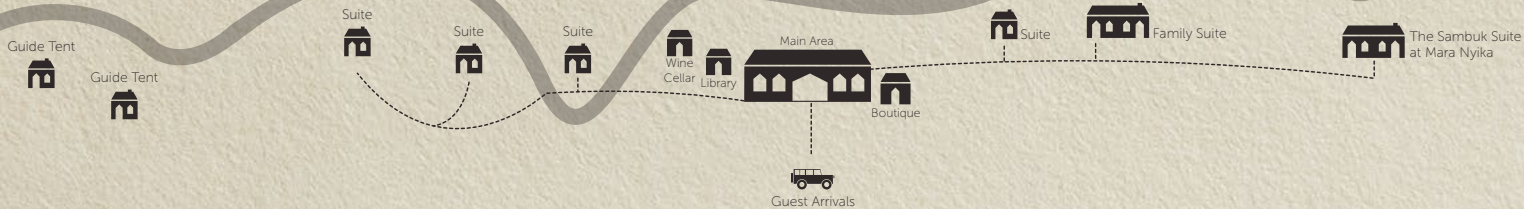

KENYA

GREAT PLAINS

MARA NYIKA

GUEST SUITE

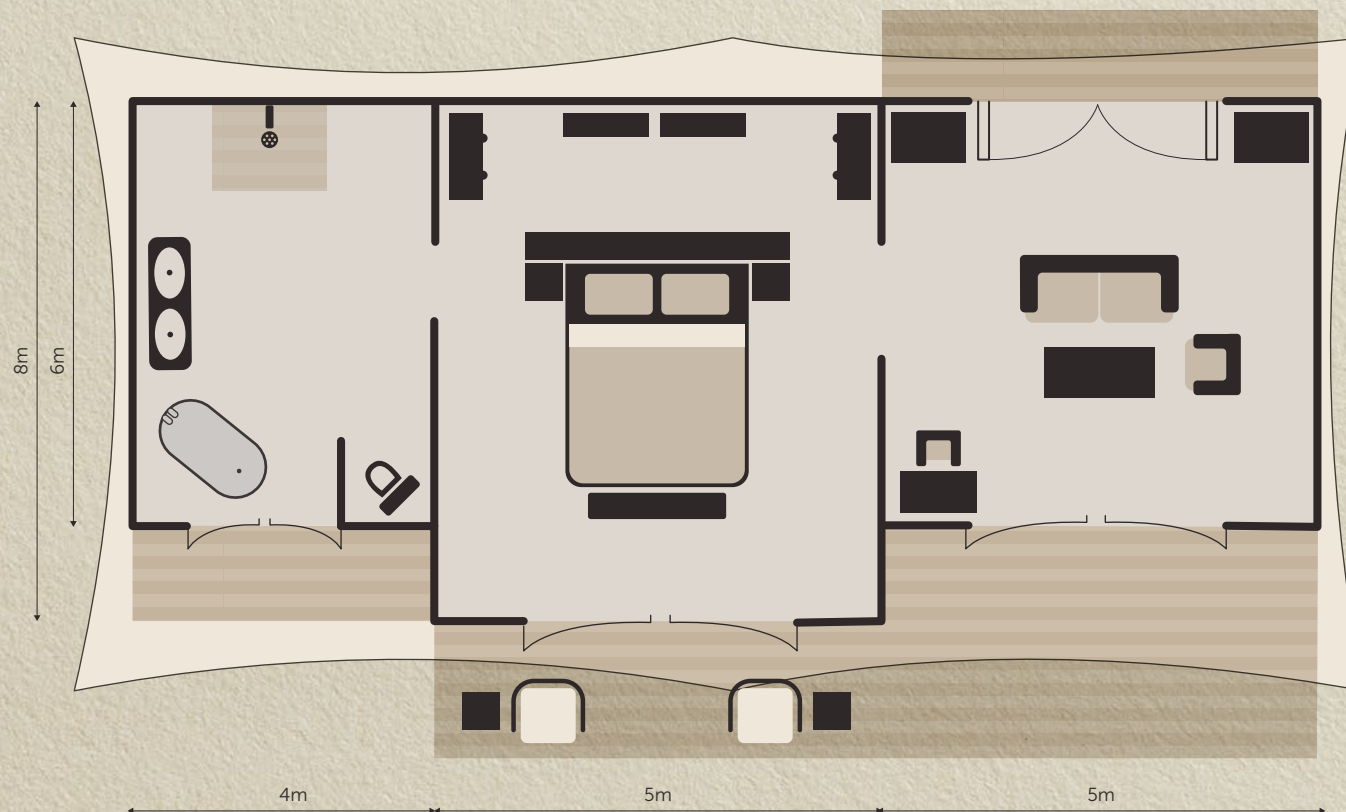

2 BEDROOM FAMILY SUITE

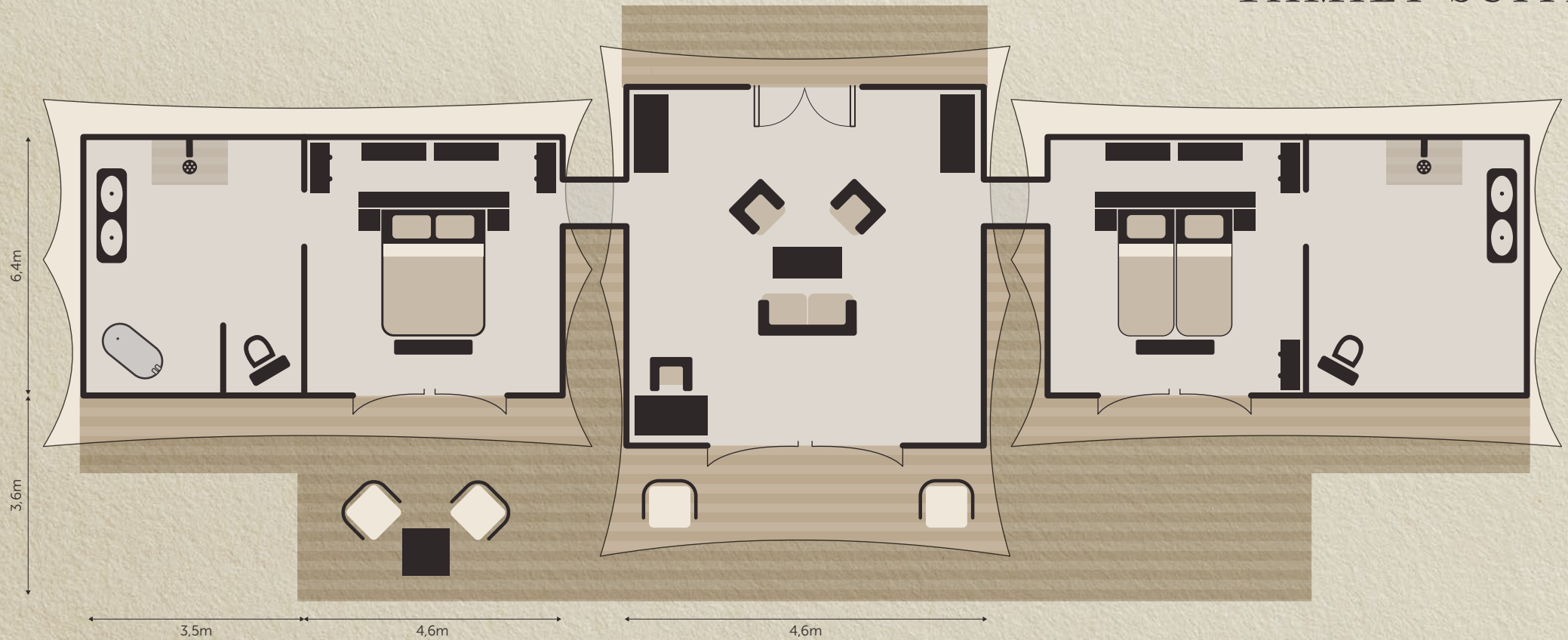



KENYA
GREAT PLAINS
 THE SAMBUK SUITE AT MARA NYIKA

THE SAMBUK SUITE AT MARA NYIKA

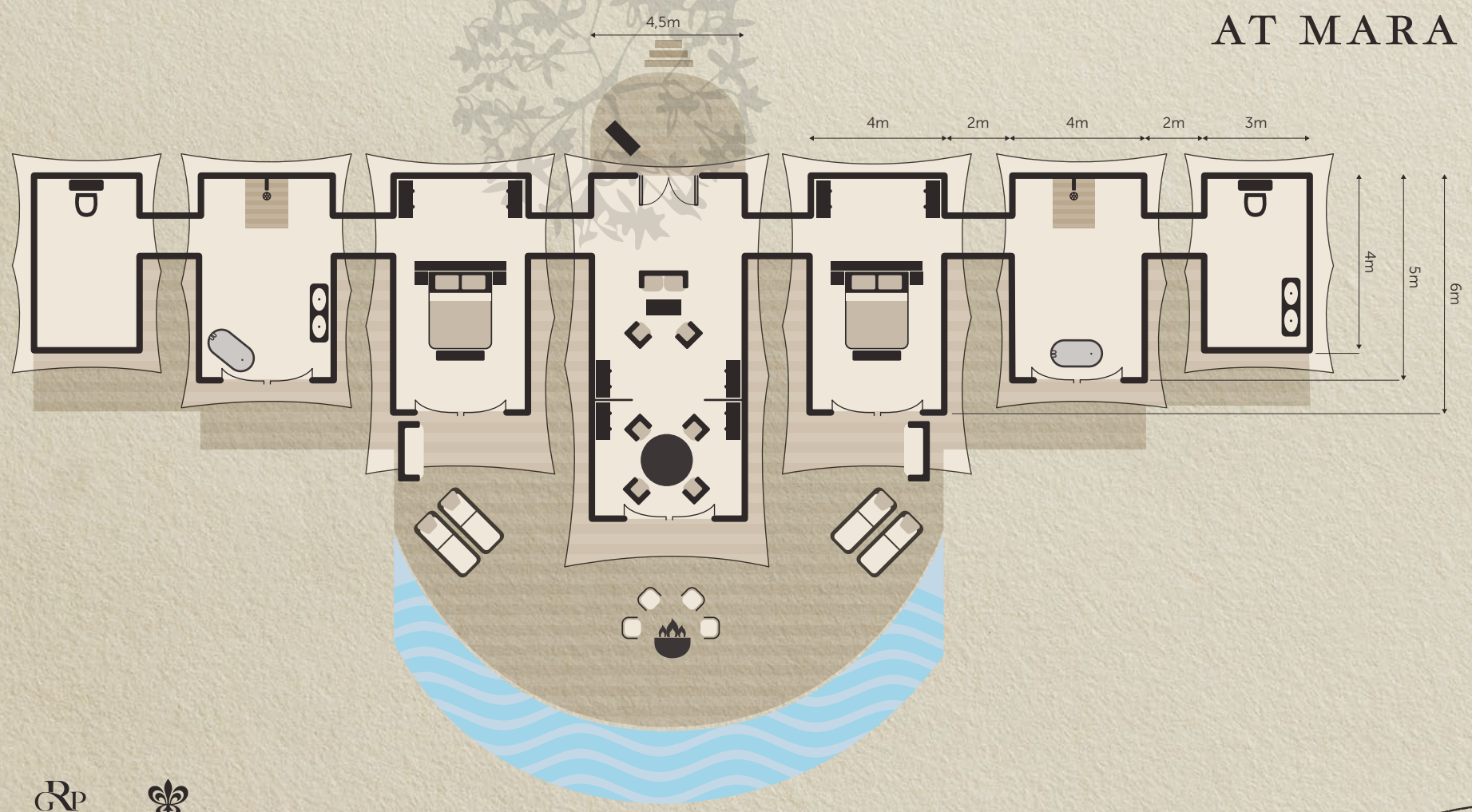

RP
 GREAT PLAINS
 RÉSERVE

**RELAYS &
 CHATEAUX**

WWW.GREATPLAINSCONSERVATION.COM / RESERVATIONS@GREATPLAINSCONSERVATION.COM

GREAT PLAINS
 CONSERVING AND EXPANDING NATURAL HABITATS

GREAT PLAINS

CONSERVING AND EXPANDING NATURAL HABITATS



GREAT PLAINS CONSERVATION
STIVES TO FIND THE RIGHT FORMULA OF
CONSERVATION, COMMUNITIES AND COMMERCE
THAT MAKES A LASTING, SUSTAINABLE DIFFERENCE
TO THE WORLD'S ICONIC WILDLIFE HABITATS

Mara Toto Tree Camp
Zamara Private
Mara Expedition Camp
Mara Triangle
Mara Plains Camp & The Jahazi Suite at Mara Plains
Mara Nyika Camp & The Sambuk Suite at Mara Nyika

Maasai Mara
Reserve

Serengeti
National Park

Shompole

ol Donyo Lodge

Tanzania

Mount Kilimanjaro

Kenya

Nairobi

GREAT PLAINS CONSERVATION

QUICK CAMP FACTS



KENYA CAMPS

ACTIVITY	OL DONYO LODGE	MARA PLAINS CAMP & THE JAHAZI SUITE AT MARA PLAINS	MARA NYIKA CAMP & THE SAMBUK SUITE AT MARA NYIKA
Camp Classification	Réserve-Collection	Réserve-Collection	Réserve-Collection
Location and size	Mbirikani Group Ranch	Olare Motorogi Conservancy	Naboisho Conservancy
Additional traversing area	n/a	Maasai Mara National Reserve	Maasai Mara National Reserve
Number of Suites / Tents	8 Suites	5 Suites	4 Suites
Family Accommodation	One 2-bedroom suite	The 2-bedroom Jahazi Suite at Mara Plains	The 2-bedroom Sambuk Suite at Mara Nyika. One two-bedroom family suite
Children can be accommodated from:	6 Years	6 Years	6 Years
Day Drives	Yes	Yes	Yes
Night Drives	Yes	Yes	Yes
Cultural Experience	Yes	Yes	Yes
Private Vehicle (at an additional charge)	Yes	Yes	Yes
Guided Walks (to be pre-booked)	Yes	n/a	n/a
Horseback Riding	Yes	n/a	n/a
Hot Air Ballooning (at an additional charge)	n/a	Yes	Yes
Mountain Biking	Yes	n/a	n/a
Hide	Yes	n/a	n/a
Main Swimming Pool / Private Plunge Pools	Yes (Main Pool & Private Plunge Pools)	Yes (Jahazi Suite only)	Yes (Sambuk Suite only)
Shower	Indoor & Outdoor	Indoor	Indoor
Bath	Yes	Yes	Yes
Hairdryers (low voltage)	Yes	Yes	Yes
Mosquito Nets	Yes	Yes	Yes
Fans	Standing fan	Overhead & standing fan	Overhead & standing fan
Wi-Fi – in-room (complimentary)	Yes	Yes	Yes
Safe - In-room	Yes	Yes	Yes
Spa treatments (at an additional charge)	Yes	Yes	Yes (In-room only)
Fitness	Gym & In-Room Equipment	In-room Equipment	In-room Equipment
Boutique on site	Yes	Yes	Yes

GREAT PLAINS CONSERVATION

QUICK CAMP FACTS



KENYA CAMPS

ACTIVITY	MARA TOTO TREE CAMP	ZAMARA PRIVATE	MARA EXPEDITION CAMP
Camp Classification	Réserve-Collection	Réserve-Collection	Explorers Collection
Location and size	Maasai Mara National Reserve	Maasai Mara National Reserve	Maasai Mara National Reserve
Additional traversing area	Mara North Conservancy	n/a	Mara North Conservancy
Number of Suites / Tents	4 Suites	6 Suites	5 Tents
Family Accommodation	n/a	Triple suites	One 2-bedroom family tent
Children can be accommodated from:	6 Years	6 Years	6 Years
Day Drives	Yes	Yes	Yes
Night Drives	Yes (water level dependent)	n/a	Yes (water level dependent)
Cultural Experience	Yes	Yes	Yes
Private Vehicle (at an additional charge)	Yes	n/a	Yes
Guided Walks (to be pre-booked)	n/a	n/a	n/a
Horseback Riding	n/a	n/a	n/a
Hot Air Ballooning (at an additional charge)	Yes	Yes	Yes
Bicycling	n/a	n/a	Yes
Hide	n/a	n/a	n/a
Main Swimming Pool / Private Plunge Pools	n/a	Main swimming pool and Private Plunge Pools at master suites	Main swimming pool
Shower	Indoor	Indoor & Outdoor	Indoor
Bath	Yes	Yes	n/a
Hairdryers (low voltage)	Yes	Yes	Yes
Mosquito Nets	Yes	Yes	Yes
Fans	Overhead & standing fan	Overhead	Standing fan
Wi-Fi – in-room (complimentary)	Yes	Yes	Yes
Safe - In-room	Yes	Yes	Yes
Spa treatments (at an additional charge)	Yes (In-room only)	Yes	Yes (In-room only)
Fitness	In-room equipment	Gym and in-room yoga mats	In-room equipment
Boutique on site	Yes	Yes	Yes