



OKAHIRONGO ELEPHANT LODGE

AN A&K SANCTUARY



Purros Conservancy, Namibia



Panoramic views from the pool at Okahirongo Elephant Lodge

A serene sanctuary in an otherworldly Namibian desert setting

Wildly remote and wonderfully unique, Okahirongo Elephant Lodge is set on the banks of the Hoarusib Riverbed in northern Namibia. Its inspired design, showcased by a central dome styled like the homes of the local Himba people, fits beautifully into the landscape of the Purros Conservancy. Interiors are pared back to let the views of rocky peaks and desert plains steal the show. Seven suites and one two-bedroom Family Villa give the lodge an intimate, hidden-away feel. Guests feel as if they're the only people on earth as they explore the area's clay castles and shifting dunes, with strolling giraffes, springbok, ostrich and, perhaps, desert-adapted elephants for company.

Six Reasons to Choose Okahirongo Elephant Lodge



01



The lodge's striking dome

The extraordinary, uplifting, Himba-inspired architecture of the lodge.

02



Desert plains stretch beyond the pool

A tranquil infinity pool with a spectacular view across the desert, where giraffes amble and springbok graze.

03



Himba display their rich culture

The chance for guests to immerse themselves in the lives and culture of the local Himba tribespeople.

04



Sundowners in the dunes

Marvel at a technicolor desert sunset from atop a dune with a sundowner.

05



Explore the landscape in a 4x4

Few people have set foot in this remote location – or experienced the extraordinary desert safaris.

06

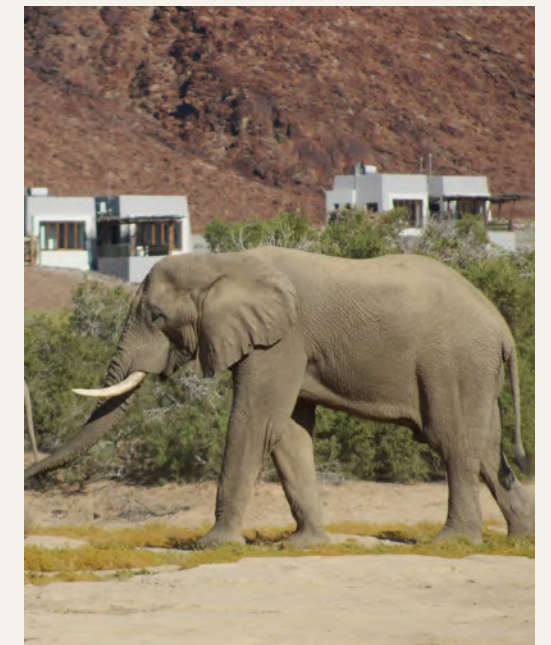

Namibia's desert-adapted elephant

This corner of Namibia is the habitat of unique desert-adapted species of elephant, lion and giraffe.

The Lodge



In a fitting tribute to the ethereal Namibian landscape in which it is set, Okahirongo Elephant Lodge has a pared-back and tactile design with colors and textures echoing the wide Kaokoland plains. At its center is a dramatic white dome, styled like the homes of the Himba people. The widescreen views of flat desert and rocky peaks – punctuated with iconic African wildlife grazing – are particularly spectacular from the sublime infinity pool.

Just seven suites and one two-bedroom Family Villa are planted into the elemental setting on the banks of the Hoarusib Riverbed – and they are the only buildings with doors. The rest, including the convivial dining room, comfortable lounges and driftwood pergola, are open-sided and positioned to frame different aspects of the awe-inspiring terrain. Adventures in this great beyond are what a stay here is all about: scenic drives in the desert with local guides, exploring the region's phenomenal clay castles, and sipping sundowners as the sun sets over the dunes. Topping it all off is the nightly display of stars in the inky-black Namibian skies.

The lodge's open-sided design



"The incredible terrain of this corner of northern Namibia is awe-inspiring."



Huge picture windows from the arid views

The Lodge



DISTINCT DESIGN

The signature forms of the homes of the local Himba people have inspired the striking architecture at Okahironko Elephant Lodge, cleverly designed as a soothing sanctuary in the rugged desert landscape.

SWIMMING POOL

Occupying center stage at Okahironko Elephant Lodge is the infinity-edge swimming pool with its enticing turquoise waters and never-ending views to the distant mountains.

BUSH BOUTIQUE

The Bush Boutique showcases local artistry in an array of distinctive styles, stocking sandals, shoes, baskets, Himba perfume, clothing, sunglasses, bracelets, backpacks, necklaces, hats and much more besides.

FAMILY-FRIENDLY ADVENTURES

Guests staying with children in the spacious Family Villa can avail of activities to keep everyone entertained, from excursions to see millennia-old “clay castles” and learning about desert life from the Himba people to e-bike rides and games in the library.

STARGAZING

As guests gather around the firepit each evening, they can take time to gaze up and admire the expanse of stars. Far from any light pollution and with a wide-open desert landscape, this remote corner of northwest Namibia is known for having some of the darkest skies on earth. Eyes peeled for the Milky Way.

ECO CREDENTIALS

Every drop of water used at the lodge is sustainably sourced from an underground borehole, ensuring a consistent and eco-friendly supply in the remote Kaokoland region. The lodge also has a solar plant supplying renewable energy.

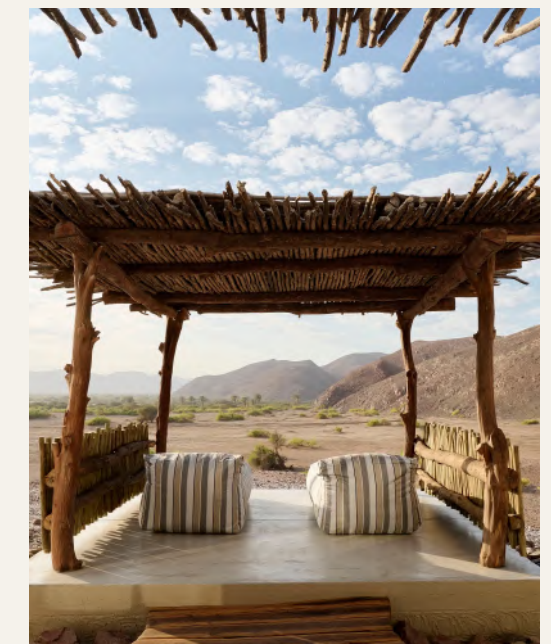

CLOCKWISE FROM LEFT

Welcome to big sky country

The pared-back bar is cooled by desert breezes

Relax in the driftwood pergola

The Lodge



The design echoes the rugged landscape

Night-time is magical at the lodge

GPS Coordinates	GPS -18° 46' 30.3342", 12° 55' 51.1248"
Open Year Round	Closed in February
Number of Rooms	7 Suites and 1 Family Villa
Maximum Number of Guests	18
Child Policy	Children of all ages are welcome. Children under 15 must share with an adult
Guide/Pilot Accommodation	Yes; 4
Wheelchair Accessible	No
Power Supply	Solar power with backup generator and inverter systems
WiFi Available	Yes, in all areas
Binoculars Provided	Yes; Leica binoculars provided for every guest
Lodge Fenced	No
Credit Cards Accepted	Visa, MasterCard
Currencies Accepted	USD, Pound, Euro, Namibian Dollars and South African Rands
Swimming Pool	Yes

The Suites



With sculptural white walls, artisanal decorations and a driftwood-chic feel, rooms here are a unique combination of timeless Himba architectural forms and 21st-century creature comforts. Each of the seven spacious suites and the two-bedroom Family Villa has been designed as a sanctuary from the harsh desert environment, dressed in soothing neutral tones and with a private terrace for lounging in the shade and taking in the panoramic views.

Cool white bathroom interiors



"Each suite is cleverly designed as a cool cocoon amid the bleakly beautiful desert landscape."



The suites have an elevated driftwood-chic feel

The Suites

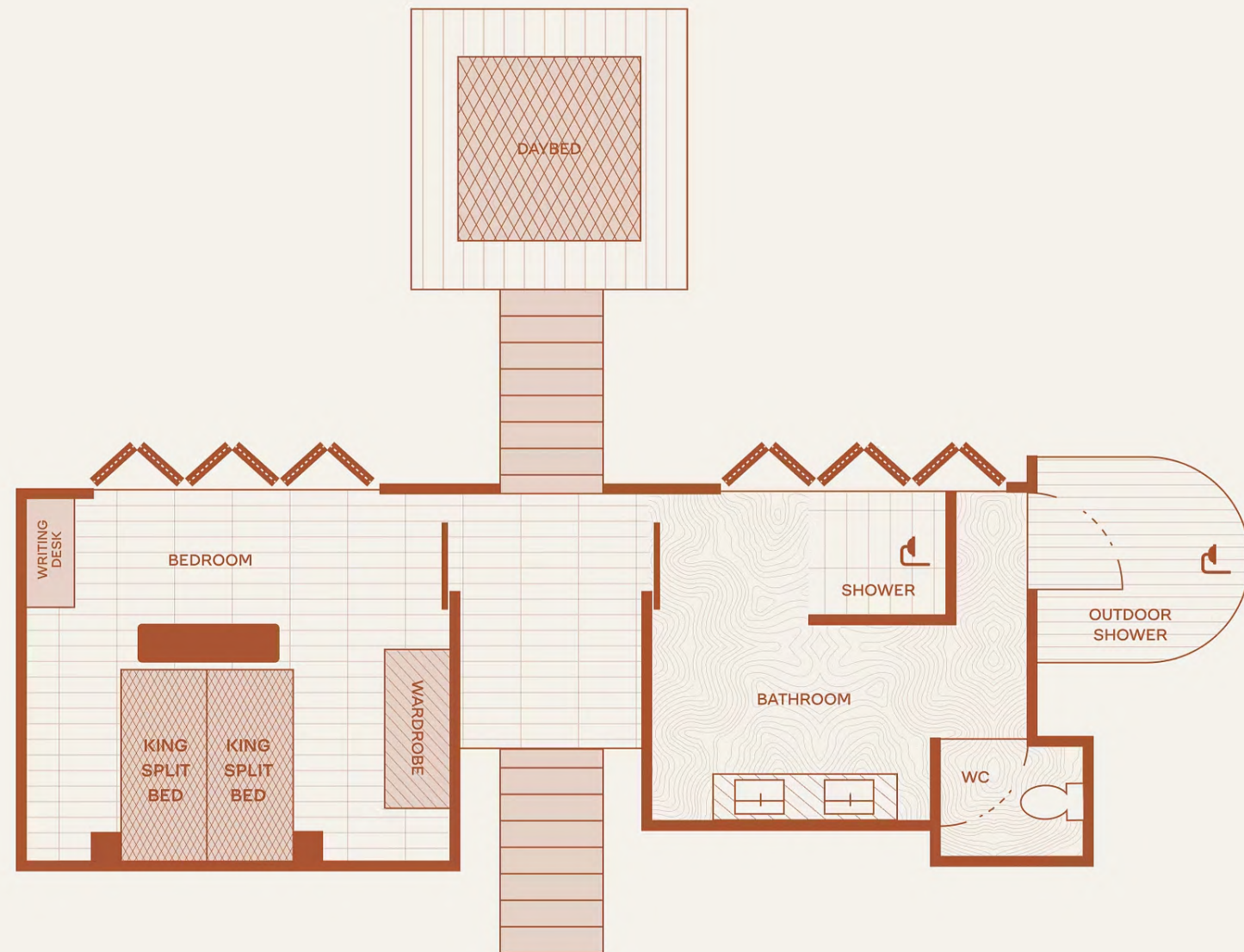

SUITE | SLEEPS 2 | 68 SQM

Each room has a king-size bed, air conditioning, a bathroom just down a corridor with indoor and outdoor showers, and a private terrace with a covered day bed overlooking the desert.

Room Size	68m2
Bed Configuration (King or Twin)	All rooms can be converted to a king or twins
Triple Rooms Available	No
Mini Bar	No
Tea and Coffee Station	Yes
Air Conditioning	Yes
Overhead Fan	Yes
Mosquito Net	No
Plug Type	Type G Plug, USB
Bath	No
Indoor Shower	Yes
Outdoor Shower	Yes
Hairdryer	Yes

The Family Villa



Room Size	152m2
Bed Configuration (King or Twin)	All rooms can be converted to a king or twins
Triple Rooms Available	No
Mini Bar	Yes
Tea and Coffee Station	Yes
Air Conditioning	Yes
Overhead Fan	Yes
Mosquito Net	No
Plug Type	Type G Plug, USB
Bath	Yes, for one suite
Indoor Shower	Yes, for one suite
Outdoor Shower	Yes
Hairdryer	Yes

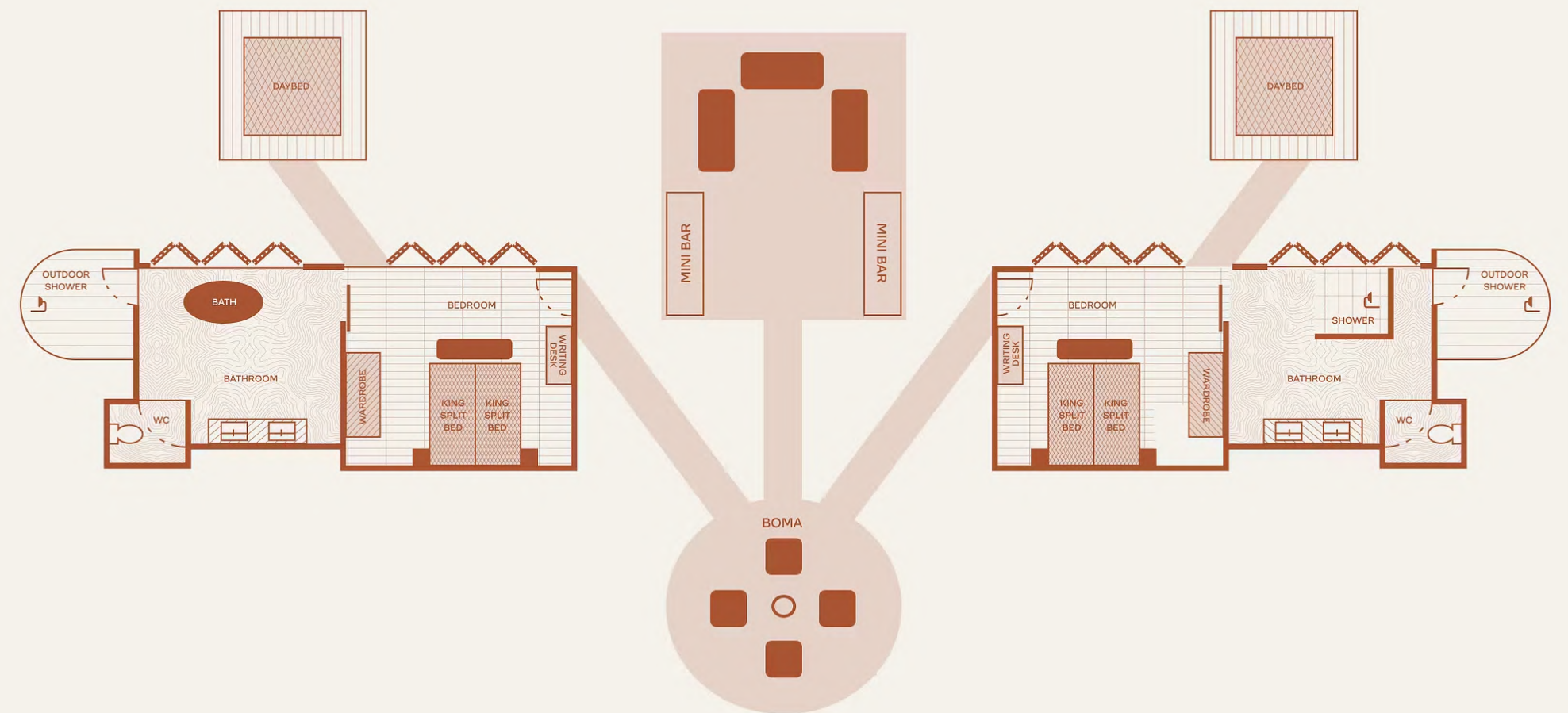

FAMILY VILLA | SLEEPS 4 | 152 SQM

This is the ideal option for families with its two spacious bedrooms, separated by a terrace with an open-air bar and private boma, plus two spectacular bathrooms, both with outdoor showers, and one with a freestanding bathtub and the other with an indoor shower.



Food & Drink



At such a boutique-sized lodge, guests can have each dining experience tailored to their preferences, benefiting from the brilliant kitchen team's personal approach. When dining at the lodge the open-sided dining area serves locally sourced menus with a Mediterranean edge, though the pan-seared oryx steak keeps things distinctly Namibian. While out exploring the desert on game drives, a bush brunch is an option; and a picnic lunch can be served in the Hoarusib Valley after exploring the iconic clay castles, perhaps followed later by snacks and sundowners on the sand dunes. Back at base, guests' drink of choice can be served in the open lounges as they marvel at the sunset. As with all A&K Sanctuary lodges and camps, food and drink is included.

- A continental or English breakfast is served at the lodge before the morning game drive.
- Coffee, tea, pastries and biscuits are a welcome pit-stop out in the bush.
- Lunch is served back at the lodge, or as a picnic if out exploring the clay castles.
- The dramatic dunes are the setting for memorable sundowners and canapés.
- Rounding off each day are pre-dinner drinks – perhaps a cocktail in a cosy corner of the lodge – followed by a three-course dinner.

One of the lodge's brilliant kitchen team



The open-sided dining area roots guests in the surroundings

Lodge Location



Kaokoland is a remote and rugged region in the northwest of Namibia. It is home to the Himba people, one of the last semi-nomadic tribes in Africa, who have managed to preserve their traditional way of life and cultural heritage amidst the vast and arid landscapes.

Known for its untouched, dramatic scenery, Kaokoland offers a unique and authentic experience for adventurous travellers. The region is characterized by vast desert plains, towering mountains, deep gorges, and dry riverbeds. In addition to its natural beauty, Kaokoland offers exceptional wildlife viewing opportunities. The region is home to a variety of desert-adapted species, including desert elephants, lions and giraffes.

Amid the raw splendor of such otherworldly landscapes, Okahirongo Elephant Lodge is situated on the banks of the Hoarusib River, within the Purros Conservancy – testament to Namibia’s rich biodiversity and a true haven for nature enthusiasts. Exploring this area often requires a 4x4 vehicle and a sense of adventure, as the roads can be challenging and the infrastructure is limited. However, the rewards are well worth the effort. Traveling through this remote region allows visitors to witness stunning sunsets, encounter traditional Himba villages, and immerse themselves in the untamed wilderness of Africa.

Setting off on an epic adventure



Okahirongo Elephant Lodge's wild setting

Getting There



Eyes peeled for passing wildlife



Windhoek Airport to Elephant Lodge Airstrip

2-hour 30-minute flight



Elephant Lodge Airstrip to the Lodge / Windhoek to the Lodge

30-minute drive / 12-hour drive

Please note, luggage restriction for light aircraft is 20kg/44lbs per person in a soft-sided bag, including hand-luggage.

Experiences



At Okahirongo Elephant Lodge twice-daily 4x4 drives into the extraordinary wilderness are likely to be the main focus, with expert Himba guides leading the search for desert-dwelling elephants, geological features known as “clay castles” and epic exploration of the ever-shifting dunes. But just being at the lodge also delivers immersion in the unbelievable landscape – guests can take in the panoramic views from their private deck and cool off with a dip in the pool. Sundowners back in the dunes are an appropriate wow-factor way to end the day.



Miles of rugged terrain to be explored

SCENIC DRIVES

The landscape in the Namibian desert puts on a daily show for guests at the lodge to marvel at, and photograph, on morning and afternoon drives. Expert Himba guides manoeuvre 4x4s past clay castles and over technicolor dunes, as the local wildlife – from Hartmann’s zebra to the swallow-tailed bee-eater – grazes and flitters all around.



The area is known for its unique geology

CLAY CASTLES EXCURSIONS

The Hoarusib River, which winds through the Puros Conservancy, has carved a path deep into the mountains, creating extraordinary geological features – including the towering yet fragile “clay castles”, thousands of years old and in some cases hundreds of feet high.



Toasting Namibia’s apricot skies

SUNDOWNERS ON THE DUNES

This experience is every bit as good as it sounds – a glass of something chilled and interesting as guests watch the sun set over one of the most hypnotically beautiful landscapes in Africa.

Experiences



At Okahirongo Elephant Lodge twice-daily 4x4 drives into the extraordinary wilderness are likely to be the main focus, with expert Himba guides leading the search for desert-dwelling elephants, geological features known as “clay castles” and epic exploration of the ever-shifting dunes. But just being at the lodge also delivers immersion in the unbelievable landscape – guests can take in the panoramic views from their private deck and cool off with a dip in the pool. Sundowners back in the dunes are an appropriate wow-factor way to end the day.



E-bikes make for a unique excursion

E-BIKE EXCURSIONS

A range of routes allows guests to explore the otherworldly landscape by eclectic bike. Do an 11-mile guided loop to take in sculptural rock formations and native birds; work up a sweat on a two-hour road cycle; or bike to visit a Himba village, perhaps passing desert-adapted animals along the way.



Learn about the Himba way of life

MEET THE NEIGHBORS

Guests at Okahirongo Elephant Lodge get the opportunity to learn about the lives and culture of the Himba, and discover how they have adapted to desert life.

Wildlife & Nature

While it might appear on first glance to be a bleakly beautiful but empty landscape, the Purros Conservancy is actually thrumming with life. The expert Himba guides escort guests on morning treks or afternoon game drives to encounter a range of wildlife, many of which are species that have uniquely adapted to the harsh desert conditions, making encounters with them even more special.

These include the lodge's emblematic elephants – rarely glimpsed and only occasionally spotted – iconic giraffe, as well as Hartmann's mountain zebra, baboons, ostrich, jackals, and a wide variety of antelope: gemsbok, springbok, steenbok and kudu, with their unusual striped flanks and distinctive spiral horns. Birdwatchers will keep binoculars primed for native and exotic species, from large and lethal vultures to delicate bee-eaters, the distinctive Rüppell's Korhaan and Monteiro's hornbill.

A dazzle of zebra at a water source



Giraffe have adapted to the harsh desert environment

Your Okahirongo Elephant Lodge Safari



Days at Okahirongo Elephant Lodge deliver pulse-quickening adventure as well as serene moments to simply soak up the incredible landscape all around. The lodge's expert team of guides and support staff cleverly choreograph every detail – from action-packed morning drives to sundowner drinks in the dunes and stargazing nights by the fire.

A TYPICAL DAY MIGHT INCLUDE:

- Wake-up Call — Enjoy a tea or coffee on your own deck as the desert sands turn from dusky pink to ochre and orange as the light changes.
- Breakfast — A fresh, hearty breakfast served at the lodge.
- Morning Activity — Set out with binoculars primed to spot desert-adapted animals, alongside the geological wonders of the Namibian desert.
- Lunch - Return to the lodge for a delicious lunch of locally sourced dishes.
- Afternoon Activity - Another opportunity to explore with the expert guides.
- Sundowners - An excursion back in the dunes for refreshing drinks and an unforgettable sunset.
- Dinner - The moment to sit back and swap stories of the day's adventures over a three-course dinner.

The Details



HONEYMOONS, ANNIVERSARIES & SPECIAL OCCASIONS

Romance and luxury are woven into each of our stays, but our Okahirongo Elephant Lodge team adds an extra sprinkling of magic when it comes to special occasions. From a private candle-lit dinner to memorable sundowners, the team creates once-in-a-lifetime experiences that celebrate a visit to the unique and cinematic setting of the Namibian desert.

FAMILIES WITH CHILDREN

Okahirongo Elephant Lodge welcomes children of all ages – the only requirements being that those aged 15 years and under share with an adult, and families with under-fives travel in their own private safari vehicle. Suites and villas are a good distance apart, affording seclusion for families, and all have lounges ideal for spending time together. Action-packed 4x4 desert drives, E-bike rides and other activities keep children entertained outdoors and various games are available in the library.

INCLUSIONS

- All meals, non-alcoholic and alcoholic beverages (including premium brands)
- Transfers to/from nearest local airstrip
- Twice daily activities including: scenic drives, clay castles visit, Himba visit, sundowners, guided e-bike excursion, local village tour, and stargazing
- Emergency medical evacuation
- Laundry services

EXCLUSIONS

- International and domestic flights
- Road transfers to and from other camps and lodges
- Travel insurance, boutique purchases, gratuities, and all other items of a personal nature





Expert guides share their local knowledge

Travel Tips



WHAT TO PACK

Clothing should be cool and comfortable; and colours should blend in with nature as much as possible. A fleece, sweater or warm jacket is advisable for morning and evening game drives. Sturdy and comfortable shoes are essential.

Accessories: Sunscreen, sunglasses and hats are essential. Binoculars and good cameras are an absolute must. The lodge provides a torch as well as complimentary mosquito repellent and toiletries.

HEALTH

Please discuss health precautions for your travel itinerary with a qualified health professional at least six weeks before departure.

MONEY & CREDIT CARDS

All extras can be paid for with Visa and Mastercard. Namibian dollars or South African rand are also accepted; however change will be given in the local currency.

GRATUITY GUIDELINES

Tipping and gratuities remain entirely at your discretion.

Driftwood-chic design detail

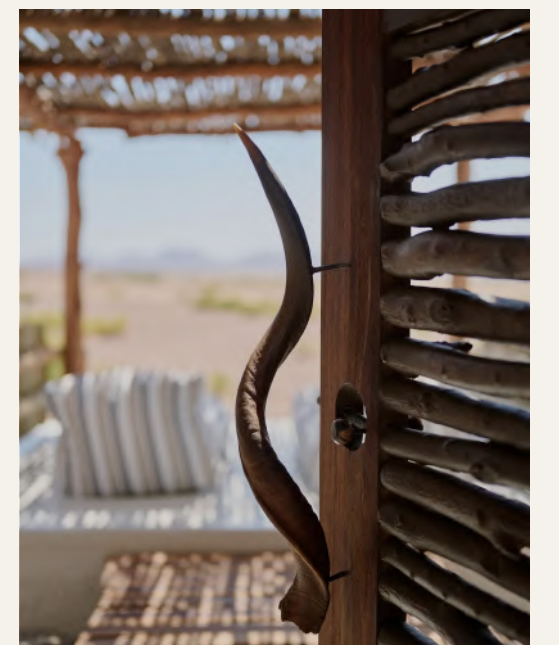

Climate



While it's impossible to predict the weather, guests might find it helpful to learn how a visit to Okahirongo Elephant Lodge might differ from one season to the next: from the months when predators and their prey will be most active to the best time to spot the abundant birdlife.



Geological wonders in the Namibian desert

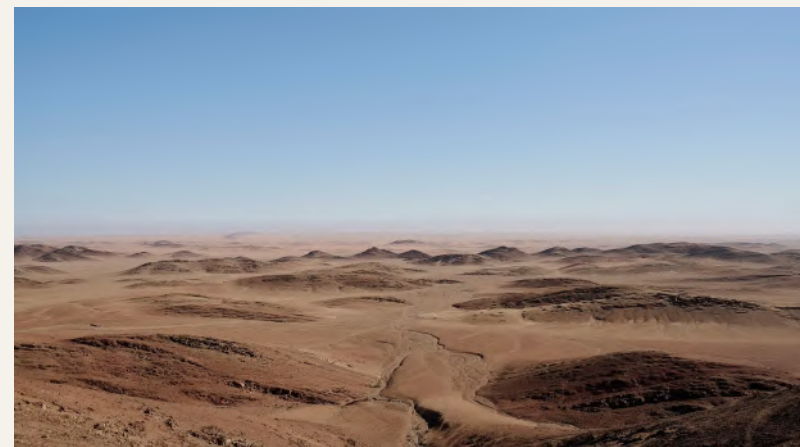

Kaokoland's never-ending plains



A trip to explore the natural clay castles

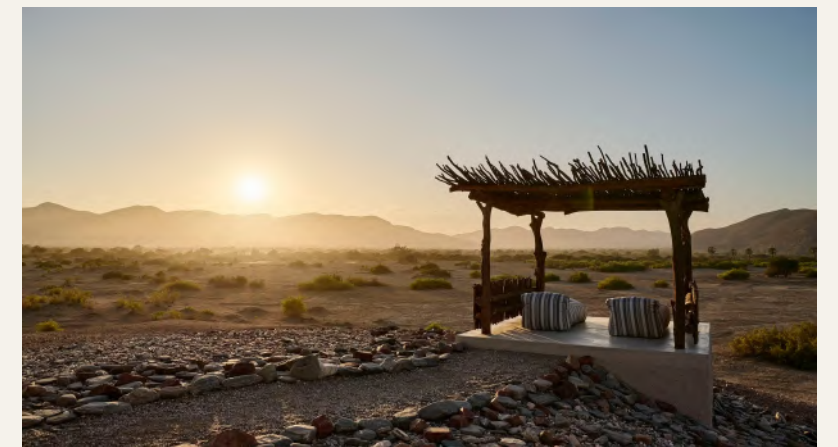

The shaded pergola at sunrise

JANUARY–MARCH

Birding is at its best at the start of the year as migratory species begin to arrive and the non-perennial river flows, attracting an array of wildlife. The lodge is closed in February but reopens in March when bird numbers have swelled – expect to see swallows, swifts, and bee-eaters.

APRIL–JUNE

April's clear skies make this a great time of year for photographers; the lack of light pollution also means astrophotography is possible. As the water sources start to dry up in May, wildlife gathers around the riverbeds, resulting in easier, more concentrated game viewing. The weather cools in June and the landscape appears more vibrant.

JULY–OCTOBER

With the dry season in full swing, the clear skies provide excellent lighting – particularly for capturing the unique features of the numerous clay castles that punctuate the otherworldly Namibian landscape.

NOVEMBER–DECEMBER

Things get humid as temperatures rise and the first summer rains begin to fall. As vegetation flourishes, the local desert-adapted wildlife gathers to feast on it – or to prey on those that do.

A&K Philanthropy Initiatives in Namibia



Community connection is at the heart of A&K Philanthropy

JOURNEYS WITH PURPOSE

The A&K Philanthropy nonprofit network now spans 24 countries on all seven continents, positively impacting hundreds of thousands of lives and helping preserve some of the world's most precious ecosystems. Our initiatives focus on education, enterprise, health and environment, aiming to support and empower local communities to facilitate the protection of their surroundings, and to ensure that the people in the places where we travel are also benefitting directly from tourism.

SCHOOL FEEDING PROGRAM

AKP has partnered with local communities throughout Namibia, Kenya, Uganda and Zambia to provide daily nutritious lunches to local students. Since the project began in 2017, it has provided daily lunches to more than 12,000 students in 16 schools spanning the communities from the Maasai Mara to Bwindi Impenetrable Forest National Park and from Mosi-oa-Tunya National Park to the Purros Conservancy. With support from our guests and local communities, AKP has also built 19 kitchens employing over 60 food service workers, improving the school facilities while providing much-needed job opportunities. These efforts have proven the power of school lunches, with one school seeing a staggering 270% increase in student enrollment since the program's inception.

"Our work keeps the needs of local communities at the forefront of every program."



A&K SANCTUARY